



PROPOSED COMMUNITY PARTNERSHIP

Between

Lexington Police

and

Bluegrass Community and Technical College



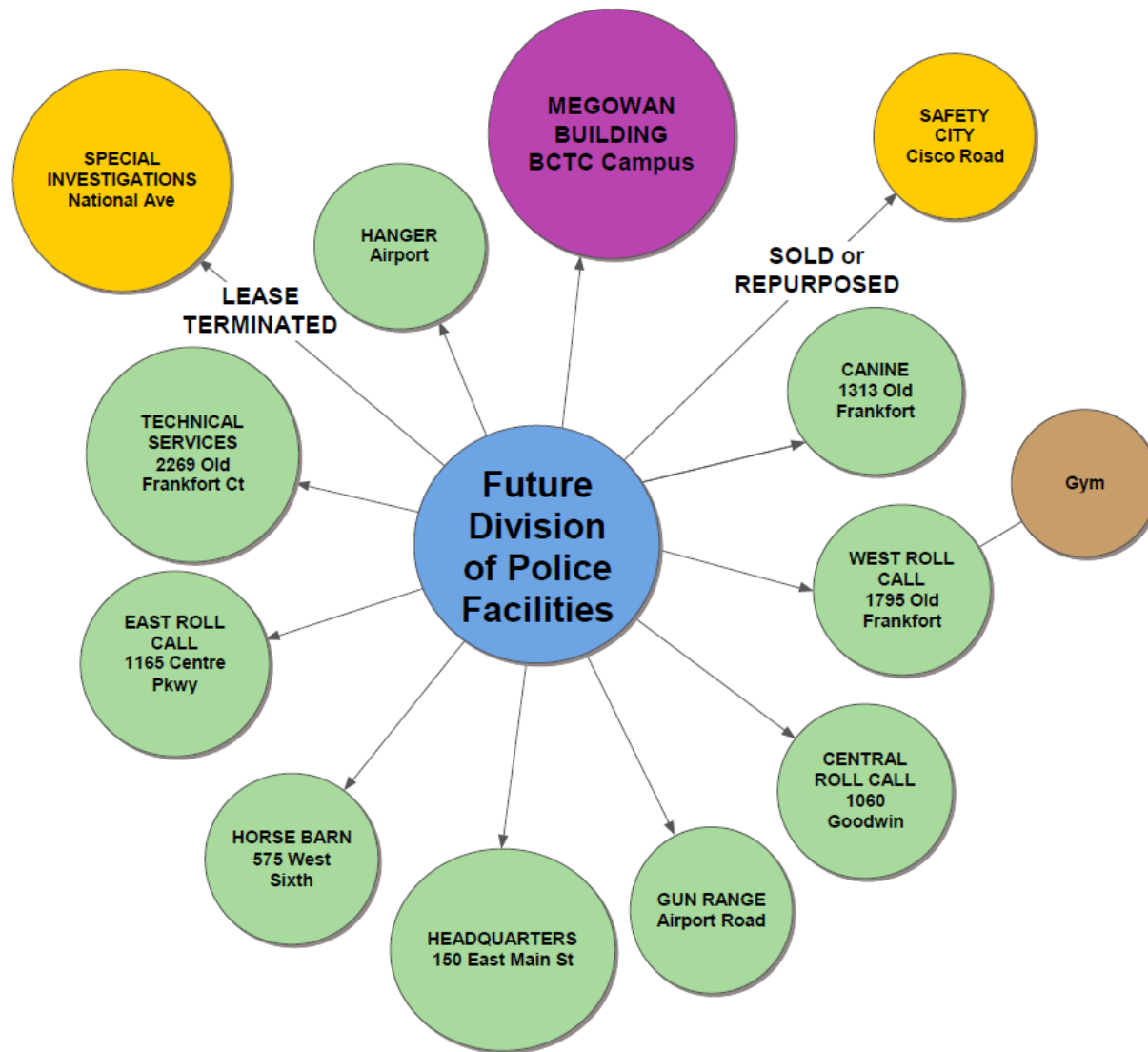

INTERNAL BENEFITS

- Larger, updated classroom space
- All training aids housed together
- Community Partnership with BCTC
- Allow for reorganization and allocation of personnel
- Reduction in the number of facilities maintained
- Larger facilities to host trainings and/or conferences leading to reduced travel costs
- Police recruits integrated with students and faculty as a reminder of their service to the community

EXTERNAL BENEFITS

- Integration in Newtown Pike Corridor
- Entrenched in emerging University District
- Community Partnerships with YMCA, Transylvania University and BCTC
- Promotion of wellness and healthy living due to close proximity to YMCA and Legacy Trail
- Part of the revitalization of the Downtown Area
- Police Department presence on BCTC campus

BUILDING SHARE ALLOCATION

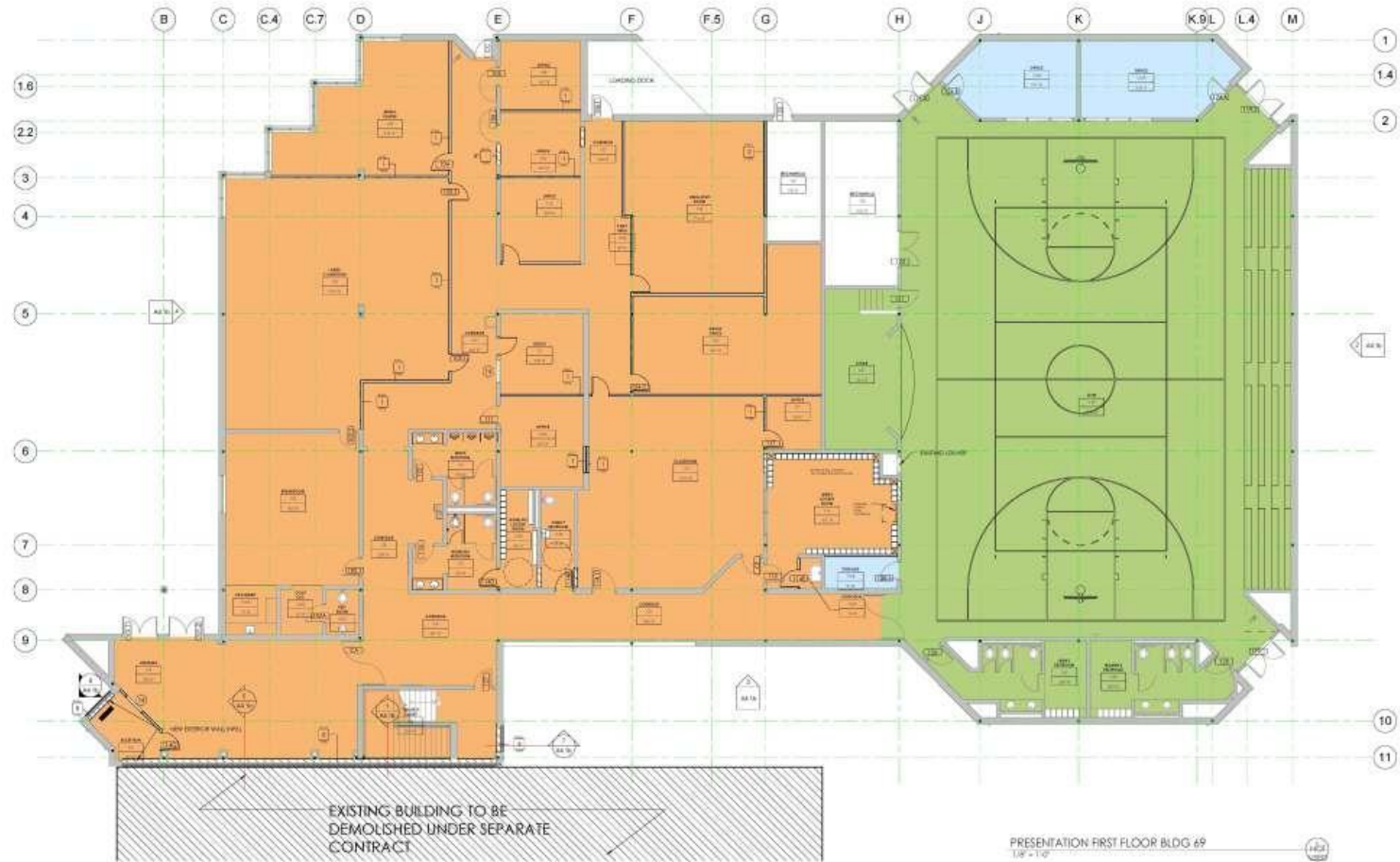

DEPARTMENT LEGEND

- 1,236 sf BCTC COLLEGE
- 12,461 sf POLICE TRAINING ACADEMY
- 6,454 sf SHARED SPACE

ESTIMATED YEARLY OPERATING COSTS

Based on 20,000 Square Feet

| | |
|----------------------|-----------|
| Utilities | \$ 60,000 |
| Mech Maint Contract | \$ 10,000 |
| BCTC Maintenance | \$ 3,000 |
| Major Repair Budget | \$ 7,000 |
| Custodial (< actual) | \$ 8,000 |
| Total | \$ 88,000 |

BCTC Share
21% Facility \$88000 X .21 = \$ 18,480

LPD Share
79% Facility \$88000 X .79 = \$ 69,520

Amortization of LPD Improvements
\$200,000 / 10 Year Amortization=\$20,000/yr

TOTAL LPD Estimated yearly cost \$89,520

Lexington Police Facility Reduction Comparison

| | FY 2012 | | | |
|---|--------------------|--------------------|--------------------|--------------------|
| | | | | |
| Safety City Total Cost | \$6,813.51 | | | |
| National Avenue Total Cost | \$46,915.10 | | | |
| Estimated Cost Savings | \$53,728.61 | | | |
| Megowan Building Yearly Operational Cost | | \$69,520.00 | | |
| Megowan Building 10 YR Amortization | | \$20,000.00 | | |
| Megowan Building Total Yearly Cost | | \$89,520.00 | | |
| Current Facility Reduction Cost | | | \$53,278.61 | |
| Proposed Yearly Expenditure | | | \$36,241.39 | |
| After 10 Year Amortization | | | | \$16,241.39 |

Fourth Street Strategic Area Plan

Commissioner of Planning

Dr. Derek Paulsen

Existing Zoning

ZONING

- A-U Agricultural Urban
- B-1 Neighborhood Business
- B-2 Downtown Business
- B-2A Downtown Frame Business
- B-2B Lexington Center Business
- B-4 Wholesale and Warehouse Business
- R-1C Single Family Residential
- R-1D Single Family Residential
- R-1E Single Family Residential
- R-1T Townhouse Residential
- R-2 Two-Family Residential
- R-3 Planned Neighborhood Residential
- R-4 High Density Apartment
- R-5 High Rise Apartment
- P-1 Professional Office
- I-1 Light Industrial

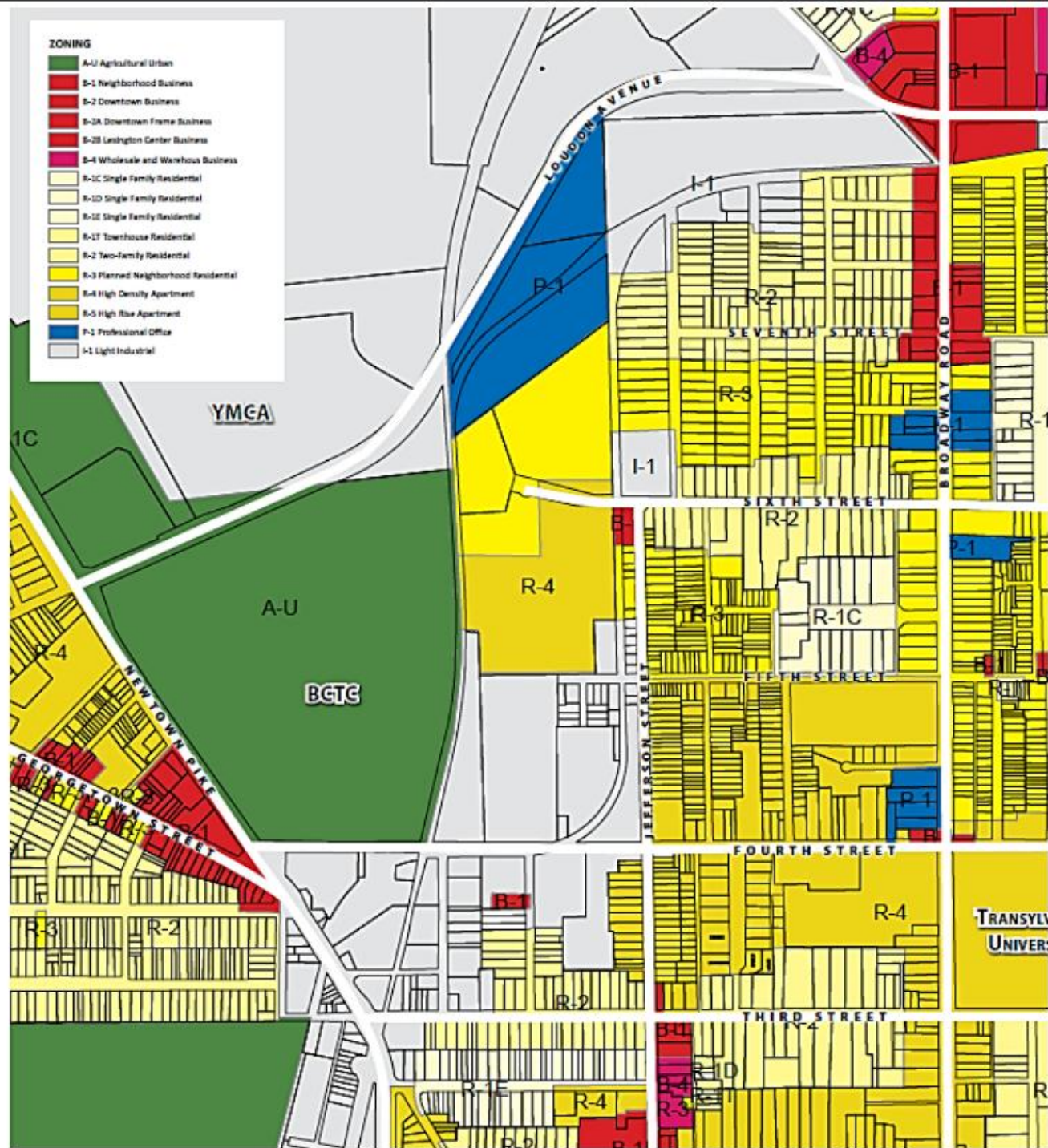

Goals of Project

- **Involve area property owners in discussions of future development plans.**
- **Create consensus on desired land use character to support the emerging University district.**
- **Identify potential development and public improvement projects**
- **Make recommendations on appropriate zoning to support desired land uses.**

| | | Month 1 | Month 2 | Month 3 | Month 4 | Month 5 | |
|-----------------|---|---------|---------|---------|---------|---------|--|
| TASK 1 | Project Organization Organize a "Working Group" Kick-off Meeting Identify Goals and Objectives | ■ | | | | | |
| TASK 2 | Issues and Opportunities Existing Condition Assessment Major Stakeholder Interviews Identify Issues and Opportunities Identify Potential Partnerships | | ■ | | | | |
| TASK 3 | Development Plan Alternatives Create Conceptual Development Plan Alternatives Develop Draft Development Plan | | | ■ | | | |
| TASK 4 | Final Plan and Implementation Strategy Finalize Development Plan Develop the Implementation and Zoning Strategy Identify Short- and Long-term Projects Community Input through Public Workshop Create a Final Report Final Recommendations Submission for Planning Commission Adoption | | | | ■ | | |
| MEETINGS | Working Group Meeting | * | * | | * | * | |
| | Public Workshop | * | | | | * | |