

- KEY NOTES:**
1. FULL ROAD CLOSURE SHALL NOT BE PERMITTED AT ANY TIME. STEEL PLATES MAY BE UTILIZED TO COVER EXISTING TRENCH DURING NON-WORKING HOURS AND TO MAKE INTERCEPTOR LINE CONNECTIONS.
  2. TRAFFIC SHALL BE SHIFTED TO MAINTAIN A MINIMUM OF ONE 12 FOOT LANE FOR TRAFFIC DURING CONNECTION OF INTERCEPTOR SEWER. CONTRACTOR TO INSTALL SIGNAGE AT THE TIME OF THE LANE SHIFT.
  3. TWO WAY TRAFFIC SHALL BE MAINTAINED ON ADJACENT ROADWAYS.
  4. TEMPORARILY CLOSE ON-STREET PARKING. POST SIGNAGE A MINIMUM OF 7 DAYS PRIOR TO CLOSURE. CLOSE ON-STREET PARKING SPACES A MINIMUM OF 48 HOURS PRIOR TO COMMENCING OF CONSTRUCTION ACTIVITY IN THE AREA OF THE ON-STREET PARKING.
  5. CHAIR AVENUE AND EMMALINE LANE SHALL NOT BE CLOSED AT THE SAME TIME. CONTRACTOR MAY NEED TO PROVIDE DETOUR ROUTES.
- NOTE: BARRICADE DETAILS ARE SHOWN ON SHEET T-00.

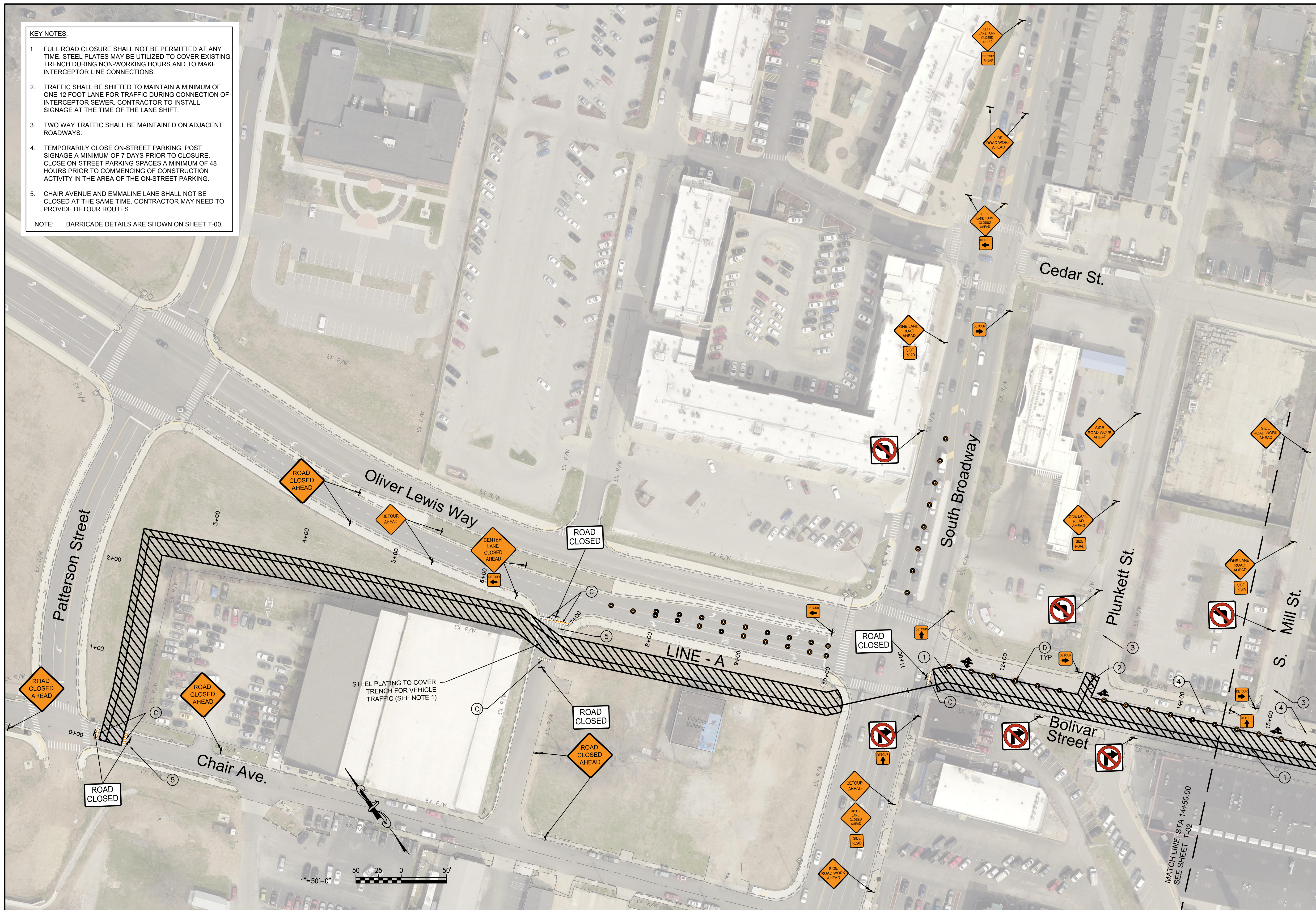

DATE	REVISION DESCRIPTION

**MAINTENANCE OF TRAFFIC PLAN**

LEXINGTON FAYETTE URBAN COUNTY GOVERNMENT  
 UK TRUNK C, D AND E  
 LFUCG Bid No. \_\_\_\_\_ ; RMP ID No. TB-6, TB-7 And TB-8

**Palmer ENGINEERING**  
 PALMER ENGINEERING  
 301 EAST MAIN STREET  
 SUITE 900  
 LEXINGTON, KY 40517  
 (609) 369-9293

JOB NUMBER: 11354.00    DATE: 04/30/2019    DRAWN: SIB  
 SHEET: T-01    SCALE: 1"=50'    CHECKED: WCE