

Jessica Walker

From: Margie Jacobs <margie@thjarch.com>
Sent: Monday, July 11, 2016 3:06 PM
To: 'Greg Meegan'; Jim Powell; Jessica Walker
Cc: Jamshid Baradaran; Mark Arnold; Louis Weckerling; John Kissell; lisa@thjarch.com
Subject: RE: Arts Place Extra - Retro Fit Roof Drain

GREG: The pricing to provide a new “retro-fit” drains at the Government Center as described below is acceptable to me. Based on a separate e-mail message from John Kissel confirming the new drain will be included in the Siplast 20-year warranty I also recommend approval of their use.

JIM/JESSICA: I recommend approval of a change order in the amount of \$1,344.00 to add (2) retro-fit roof drains at the government center. Please confirm this is approved and whether or not you have questions.

See everyone at our regular monthly meeting tomorrow.

margie

From: Greg Meegan [<mailto:gmeegan@tri-stateservice.com>]
Sent: Friday, July 08, 2016 9:47 AM
To: 'Margie Jacobs' <margie@thjarch.com>
Subject: Arts Place Extra - Retro Fit Roof Drain

Margie:

This extra request is based on the construction/condition of the roof drains on Mid Roof 1 & High Roof 1. After on-site inspections with both you and Jonathan Kissel, it was decided installing Siplast’s Paragaurd Retro-fit Roof Drain will be necessary.

The following is the material cost of the extra – there is no additional labor cost.

- (1) 6” Paragaurd Drain, (1) 4” Paragaurd Drain, Required Parapro material for flashing... \$1,344.00

Please let me know if you need any additional information.

Thanks,

Greg Meegan
Tri-State Roofing & Sheet Metal Company
1624 Old Frankfort Pike
Lexington, KY 40588

Phone: 859 233-4546
Cell: 859 338-9071

Jessica Walker

From: Greg Meegan <gmeegan@tri-stateservice.com>
Sent: Thursday, September 29, 2016 11:59 AM
To: Jessica Walker
Subject: Arts Place Parking
Attachments: Arts Place Parking Invoices.pdf

Jessica:

The following is a summary of the three invoices we received, and paid, from Standard Parking for the use of their lot during the project.

- Invoice 4122016 \$2,730.00
- Invoice 5172016 \$ 689.00
- Invoice 7262016 \$2,050.00

I've also attached a copy of each invoice.

Please let me know if you have any questions or if there is anything else I need to do.

Thanks,

Greg Meegan
Tri-State Roofing & Sheet Metal Company
1624 Old Frankfort Pike
Lexington, KY 40588

Phone: 859 233-4546
Cell: 859 338-9071



We fix leaks.
Call any time, any day:
859-233-4546
lexington@tri-stateservice.com

 **TRI-STATE** Roofing & Sheet Metal Company
Since 1923

This message is meant for the sole use of the intended recipient. If you received this transmission in error, please delete it and contact us by replying to this e-mail. This message may contain information that is proprietary, privileged and/or confidential and may be subject to protection under the law. Any other use, retention, distribution, or copying of the message is strictly prohibited.



250 W. Main Street
 Suite 110
 Lexington, KY 40507

Invoice No. 4122016

INVOICE

Customer
 Name Tri-State Roofing Attn. Greg Meegan
 Address 1624 Old Frankfort Pike
 City Lexington State KY Zip 40588
 Phone _____

Date 4/12/16
 Invoice # 4122016
 Rep _____
 FOB _____

| Qty | Description | Unit Price | TOTAL |
|-----|--|------------|------------|
| 26 | Reserve parking starting 4/12/16 for 6 weeks @ Location 61992 | \$105.00 | \$2,730.00 |

Please submit payment via check prior to event. Thank you

PLEASE SUBMIT UPON RECEIPT

Payment Details
 Cash
 Check
 Credit Card #1
 Name _____
 Expires _____

| | |
|---------------------|-------------------|
| | \$2,730.00 |
| Shipping & Handling | \$0.00 |
| Taxes State | |
| TOTAL | \$2,730.00 |

Office Use Only

250 West Main Street, Suite 110, Lexington, KY 40507
 8808 Fax:(859)253-1165

Tel:(859)255-



250 W. Main Street
Suite 110
Lexington, KY 40507

Invoice No. 5172016

INVOICE

Customer
 Name Tri-State Roofing Attn. Greg Meegan
 Address 1624 Old Frankfort Pike
 City Lexington State KY Zip 40588
 Phone _____

Date 5/17/16
 Invoice # 5172016
 Rep _____
 FOB _____

| Qty | Description | Unit Price | TOTAL |
|---|---|------------|----------|
| 26 | Reserve parking for week of 5/16/16-5/20/16 @ Location 61992 | \$26.50 | \$689.00 |
| Please submit payment via check prior to event. Thank you | | | |
| PLEASE SUBMIT UPON RECEIPT | | | |

Payment Details
 Cash
 Check
 Credit Card #1
 Name _____
 Expires _____

| | |
|---------------------|-----------------|
| Shipping & Handling | \$689.00 |
| Taxes State | \$0.00 |
| TOTAL | \$689.00 |

Office Use Only



250 W. Main Street
 Suite 110
 Lexington, KY 40507

Invoice No. 7262016

INVOICE

Customer
 Name Tri-State Roofing Attn. Greg Meegan
 Address 1624 Old Frankfort Pike
 City Lexington State KY Zip 40588
 Phone _____

Date 7/26/16
 Invoice # 7262016
 Rep _____
 FOB _____

| Qty | Description | Unit Price | TOTAL |
|-----|--|------------|------------|
| 10 | Reserve parking for week of 7/26/16-8/5/16 @ Location 61992 | \$205.00 | \$2,050.00 |

Please submit payment via check prior to event. Thank you

PLEASE SUBMIT UPON RECEIPT

Payment Details
 Cash
 Check
 Credit Card #1
 Name _____
 Expires _____

| | |
|---------------------|-------------------|
| | \$2,050.00 |
| Shipping & Handling | \$0.00 |
| Taxes State | |
| TOTAL | \$2,050.00 |

Office Use Only

Jessica Walker

From: Margie Jacobs <margie@thjarch.com>
Sent: Thursday, October 06, 2016 5:21 PM
To: 'Greg Meegan'; Jim Powell; Jessica Walker
Cc: 'Lisa Grober'
Subject: RE: Gov't Center Fire Escape Roof
Attachments: Fire Escape Siplast Parapro Details 10-6-16.pdf

Jim / Jessica: I recommend approval of Tri-States request for \$5,990,00 to perform the additional work enumerated in his message below.

Greg: Thanks.

margie

From: Greg Meegan [<mailto:gmeegan@tri-stateservice.com>]
Sent: Thursday, October 06, 2016 1:05 PM
To: 'Margie Jacobs' <margie@thjarch.com>
Cc: 'Lisa Grober' <lisa@thjarch.com>
Subject: Gov't Center Fire Escape Roof

Margie:

As we've discussed removing the existing roof on the Gov't Center fire escape platform and installing a new Siplast roof system is necessary.

Based on that, we suggest the following scope of work...

Remove the existing roof and safety screen, dry and prepare the deck before setting 1/8" tapered ISO in low rise adhesive, 1/4" Densdek prime in low rise adhesive, Siplast's P20 SA Base Sheet, followed by Siplast's Parapro Roof Membrane. Additionally, metal edge will be installed around the perimeter to cover the existing vertical wall flashing. If the existing wall height will allow, we will install a reglet mounted two piece wall flashing. If the existing wall height does not allow, we will work with Siplast on a detail that meets their 20 year roof warranty specification.

We can install this Siplast roof system for \$5,990.00

Attached are the manufacturer's roof details and system overview.

Please let me know if you have any questions and how you'd like to proceed.

Thanks,

Greg Meegan
Tri-State Roofing & Sheet Metal Company
1624 Old Frankfort Pike
Lexington, KY 40588

Phone: 859 233-4546
Cell: 859 338-9071

PARAPRO MEMBRANE SYSTEM

Insulation

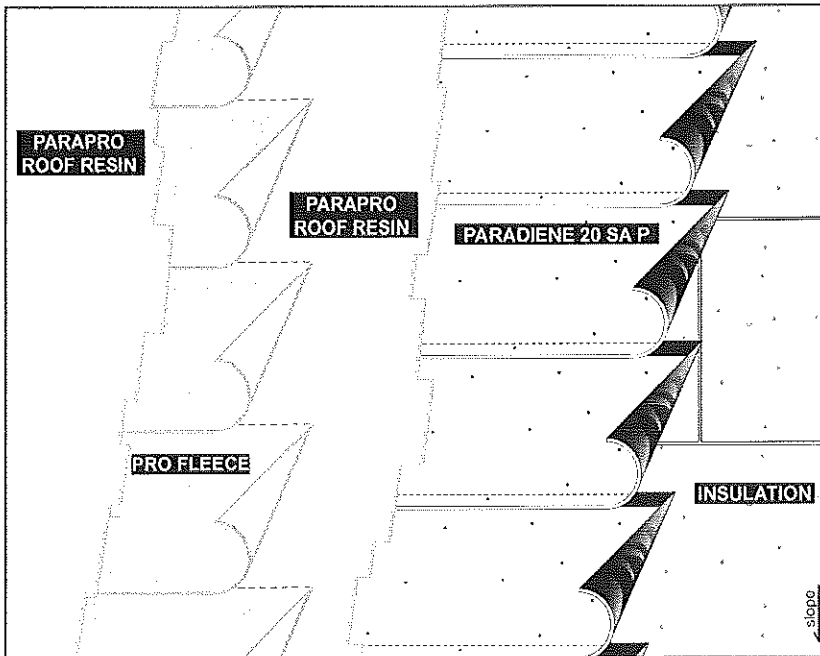

SLOPE MATERIAL 0 - 1" per foot*
per 100 sq ft

INSULATION
 PARADIENE 20 SA P 69 lb
 PARAPRO ROOF RESIN 19 kg
 PRO FLEECE
 PARAPRO ROOF RESIN 12 kg

SLOPE MATERIALS 0 - 8%*
per sq. meter

INSULATION
 PARADIENE 20 SA P 3.4 kg
 PARAPRO ROOF RESIN 2.0 kg
 PRO FLEECE
 PARAPRO ROOF RESIN 1.3 kg

n.t.s.

* Contact Siplast for higher slope requirements.

Specification: 2APPR-I

Requirements and recommendations detailed in the Siplast catalog and Siplast long form specifications shall apply in addition to the following recommendations and specifications.

Application

1. Install insulation panels according to manufacturer's recommendations and FM Global requirements, if applicable. The edges of insulation panels should be in moderate contact without forcing and cut to fit neatly against adjoining surfaces. The insulation layer should present a smooth surface to accept the roof membrane. Some insulation products may require priming.
2. Beginning at the low point of the roof, adhere the Paradiene 20 SA P to the approved insulation surface, lapping sides and ends a minimum of 3 inches. End laps require heat welding. Offset end laps a minimum of 3 feet.
3. Apply an even, generous base coat of catalyzed Parapro Roof Resin over the Paradiene 20 SA P surface using an approved roller at a rate of 19 kilograms per square.
4. While the previously applied catalyzed Parapro Roof Resin is still wet, install Pro Fleece reinforcement, embedding the fleece into the resin using a roller. Ensure that no air is trapped beneath the fleece. Lap the fleece a minimum 2 inches side and end, and apply an additional coat of catalyzed Parapro Roof Resin between layers of overlapping fleece.
5. Immediately following embedment of the Pro Fleece reinforcement, apply an even, generous top coat of catalyzed Parapro Roof Resin at a rate of 12 kilograms per square, ensuring full saturation of the fleece.

ROOF EDGE

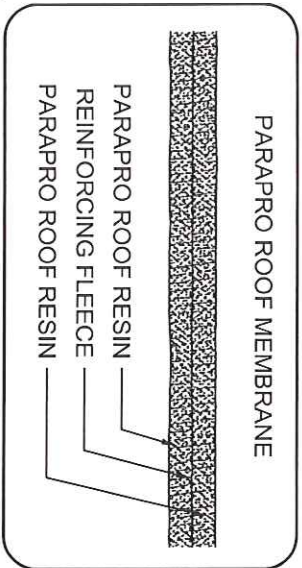
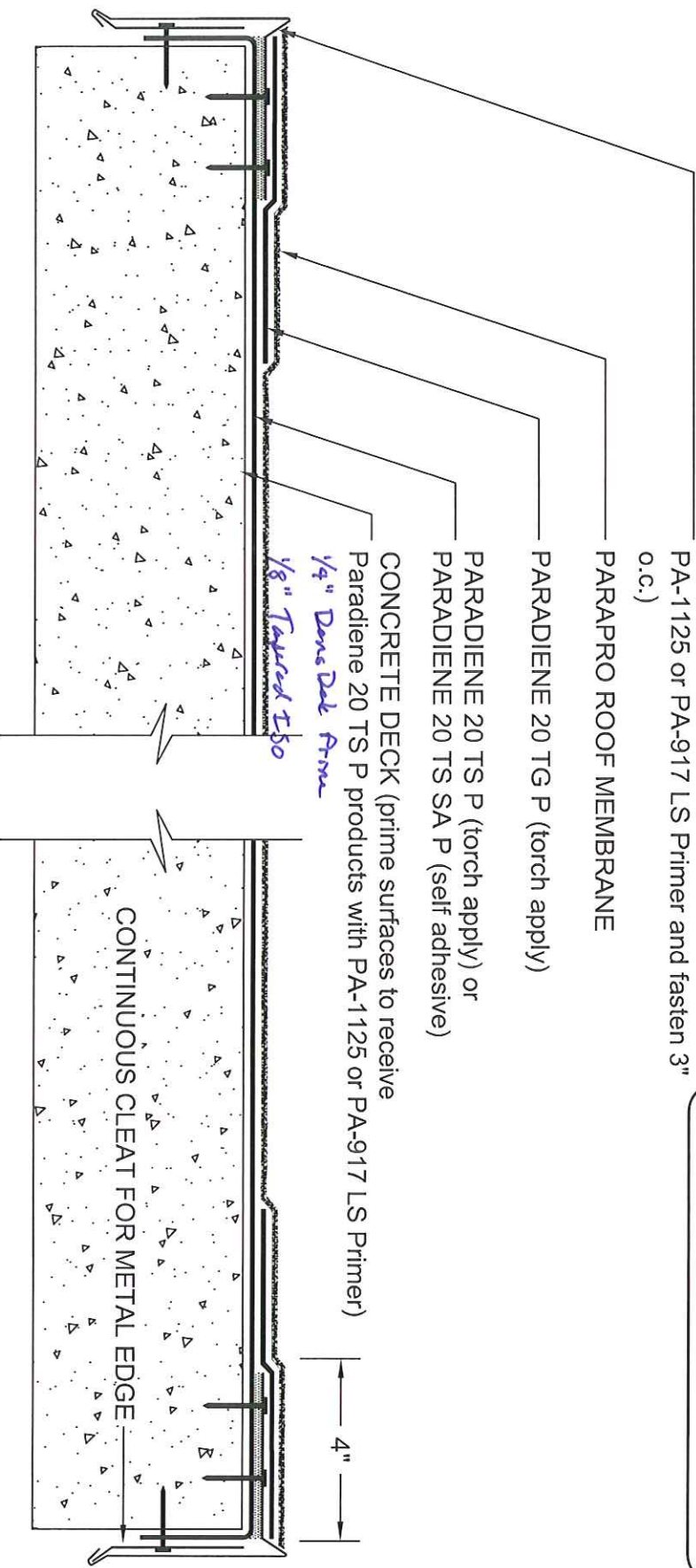

- NOTES:
1. REFER TO SIPLAST PREPARATION GUIDELINES FOR PROPER SURFACE TREATMENT OF ALL MATERIALS PRIOR TO APPLICATION OF PARAPRO MATERIALS.
 2. THE CARPENTRY AND METAL WORK SHOWN DEPICTS SHOP FABRICATION AND JOB-SITE ASSEMBLY. THESE COMPONENTS SHOULD BE DESIGNED/FABRICATED/INSTALLED ACCORDING TO GENERALLY ACCEPTED INDUSTRY PRACTICES, STANDARDS, AND APPROVALS.
 3. REQUIREMENTS AND RECOMMENDATIONS DETAILED IN CURRENT SIPLAST SPECIFICATIONS AND THE PARAPRO ROOF SYSTEM INSTALLERS GUIDE SHALL APPLY IN ADDITION TO THE ABOVE DRAWING.

CAUTION: SIPLAST RECOMMENDS THAT ALL PRACTICES PERTAINING TO NRCA CERTA GUIDELINES BE FOLLOWED WHEN TORCHING METHODS ARE EMPLOYED. THIS INCLUDES PERFORMING A FIRE WATCH FOLLOWING ANY TORCH APPLICATIONS. ALWAYS HAVE APPROVED FIRE-EXTINGUISHING EQUIPMENT NEARBY.

N.T.S.

WALL FLASHING

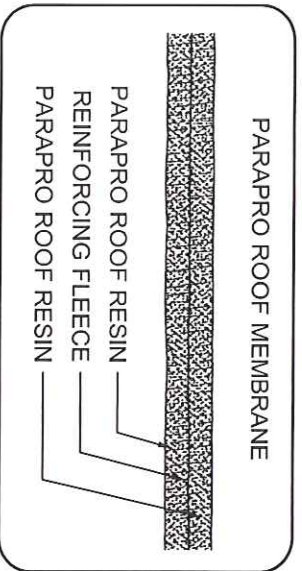
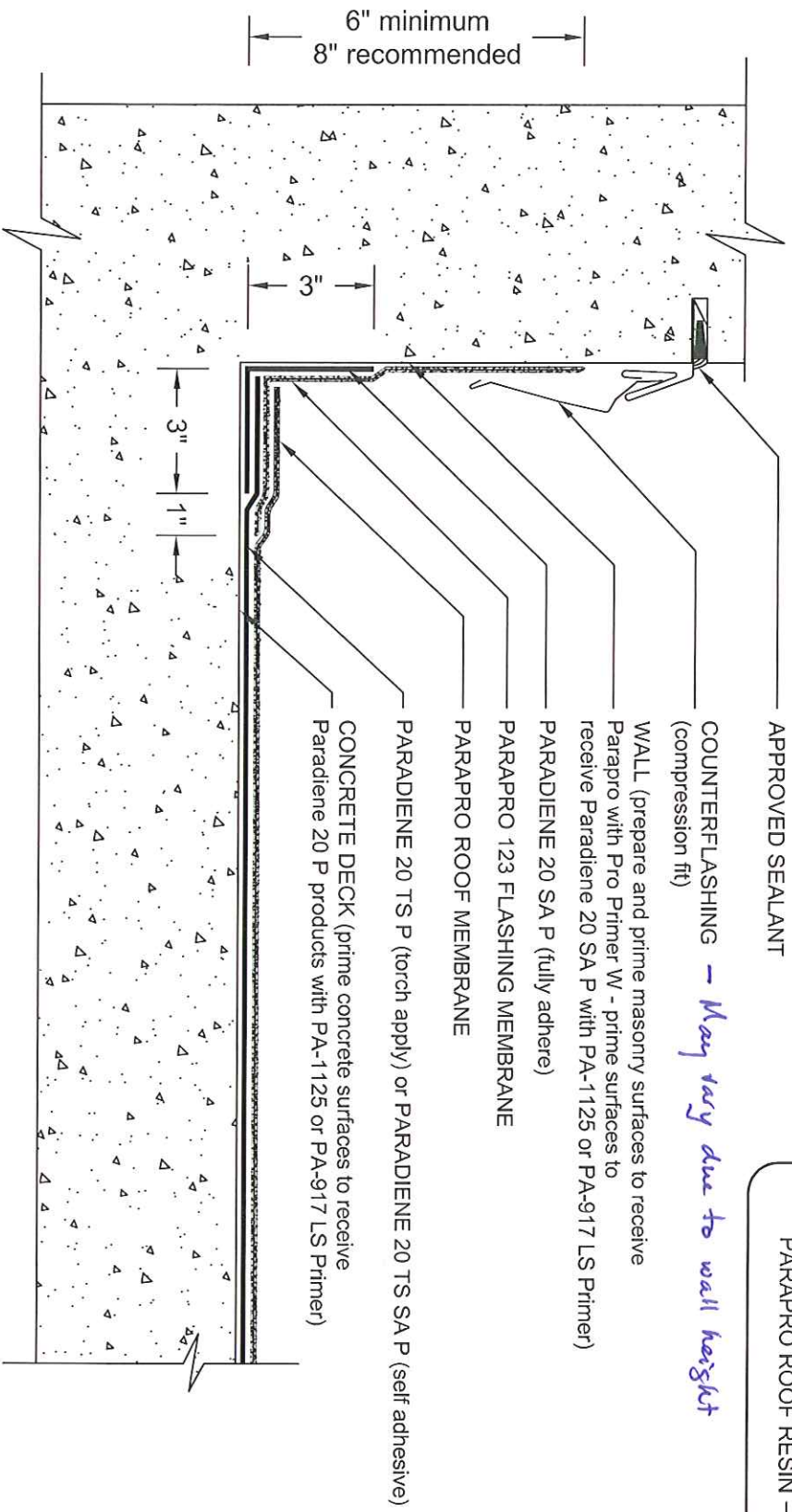

- NOTES:
1. REFER TO SIPLAST PREPARATION GUIDELINES FOR PROPER SURFACE TREATMENT OF ALL MATERIALS PRIOR TO APPLICATION OF PARAPRO MATERIALS.
 2. THE METAL WORK SHOWN DEPICTS SHOP FABRICATION AND JOB-SITE ASSEMBLY. THESE COMPONENTS SHOULD BE DESIGNED/FABRICATED/INSTALLED ACCORDING TO GENERALLY ACCEPTED INDUSTRY PRACTICES, STANDARDS AND APPROVALS.
 3. REQUIREMENTS AND RECOMMENDATIONS DETAILED IN THE CURRENT SIPLAST SPECIFICATIONS AND PARAPRO ROOF SYSTEM INSTALLERS GUIDE SHALL APPLY IN ADDITION TO THE ABOVE DRAWING.

CAUTION: SIPLAST RECOMMENDS THAT ALL PRACTICES PERTAINING TO NRCA CERTA GUIDELINES BE FOLLOWED WHEN TORCHING METHODS ARE EMPLOYED. THIS INCLUDES PERFORMING A FIRE WATCH FOLLOWING ANY TORCH APPLICATIONS. ALWAYS HAVE APPROVED FIRE-EXTINGUISHING EQUIPMENT NEARBY.

N.T.S.



1000 Rochelle Boulevard - Irving, Texas - 75062 (800) 922-8800 www.siplast.com

Ref: WALL P20TSP-PP concrete

Rev: 12.31.15