

CHANGE ORDER

No. 3

DATE OF ISSUANCE April 14, 2016 **EFFECTIVE DATE** April 14, 2016
OWNER Lexington-Fayette Urban County Government
CONTRACTOR Judy Construction Company
Contract: Wolf Run Wet Weather Storage Facility
Project: Wolf Run Wet Weather Storage Facility
OWNER'S Contract No. WR-8; Bid No. 21-2015 **ENGINEER'S Contract No.** 200-11681-14002
ENGINEER Tetra Tech, Inc.

You are directed to make the following changes in the Contract Documents:

Description: See Attached Part 1

Reason for Change Order: Item 1-1 was requested by Contractor due to changed site conditions. Items 1-2 and 1-4 were requested by LFUCG for architectural improvements and visual enhancement. Item 1-3 was requested by LFUCG to allow for future projects to connect to the Wolf Run WWS project without disturbing this site.

Attachments: (List documents supporting change) Part 1 – Contract Amount Changes; Part 2 – Time Extensions; Exhibit CO-2, Architectural Improvements (L-201, L-501, L-502), change order proposal letters from Judy Construction Company

| CHANGE IN CONTRACT PRICE: |
|---|
| Original Contract Price: \$ <u>4,740,000</u> |
| Net Increase (Decrease) from Previous Change Orders No. <u>1</u> to <u>2</u> : \$ <u>664,596.00</u> |
| Contract Price Prior to this Change Order: \$ <u>5,404,596.00</u> |
| Net Increase (Decrease) of this Change Order: \$ <u>182,763</u> |
| Contract Price with all Approved Change Orders: \$ <u>5,587,359</u> |

| CHANGE IN CONTRACT TIMES: |
|--|
| Original Contract Times: <u>365 Days – April 20, 2016</u> (days or dates) |
| Net Change from Previous Change Orders No. <u>1</u> to No. <u>2</u> : <u>163 days</u> (days) |
| Contract Times Prior to this Change Order: <u>528 Days – September 30, 2016</u> (days or dates) |
| Net Increase (Decrease) this Change Order: <u>0 days</u> (days) |
| Contract Times with all Approved Change Orders: <u>365 days – September 30, 2016</u> (days or dates) |

RECOMMENDED:
By: [Signature]
ENGINEER (Authorized Signature)

APPROVED:
By: [Signature]
OWNER (Authorized Signature)

APPROVED:
By: [Signature]
CONTRACTOR (Authorized Signature)

DATE: 4-14-2016

DATE: 5-3-16

DATE: 5/3/16

**Change Order No. 3
Lexington-Fayette Urban County Government
Wolf Run Wet Weather Storage Facility**

April 14, 2016

Part 1 – Contract Amount Changes

| Item | Description | Unit | Estimated Quantity | Unit Price | Total Price |
|--------------|---|-------------|---------------------------|-------------------|---------------------|
| 1-1 | Credit for DGA Fill around the wet well | LS | 1.0 | (\$11,486.00) | (\$11,486.00) |
| 1-2 | Running Conduits around top of tank to lights | LS | 1.0 | \$3,600.00 | \$3,600.00 |
| 1-3 | Additional 42" gravity sewer | LS | 1.0 | \$148,328.00 | \$148,328.00 |
| 1-4 | Architectural Improvements | LS | 1.0 | \$42,321.00 | \$42,321.00 |
| TOTAL | | | | | \$182,763.00 |

NOTES:

Item 1-1

The original contract listed DGA as backfill around the wet well, to the top of the rock surface. Due to groundwater conditions, concrete will be used as the backfill material around the wet well. Item 1-1 lists the credit amount of the labor, materials, and incidentals included in placing the DGA to the specifications.

Item 1-2

- A. Measurement and payment for this item shall be on a lump sum basis for work completed, tested and operational conduits and lighting.
- B. Item 1-2 includes the installation of the wiring around the top of the tank to the tank lights.

Item 1-3

- C. Measurement and payment for this item shall be on a lump sum basis for work completed, tested and operational piping.
- D. This item includes all materials, equipment, labor, hauling, testing and incidentals required for the Contractor to complete the work shown on exhibit CO-2. Work under this item includes the installation of 170 linear feet of 42-inch FRP gravity pipe, the installation of 49 linear feet of 30-inch FRP gravity pipe, the coring of the existing manhole, and the removal of an out of service manhole. Incidental to this item is bypass pumping, and required tree removal, the removal of any required utilities.

Item 1-4

- A. Measurement and payment shall be on a lump sum basis for the architectural improvements listed below.
- B. This item includes all materials, equipment, labor, hauling, and incidentals required for the Contractor to complete the architectural improvements shown on Sheets L-201, L-501 and L-502, attached. Work under this item includes replacing a portion of the original contract chain link fence with approximately 180 linear feet of a faux wrought iron fence, installing stone columns at the entrance and changes to the landscaping plan.

**Change Order No. 1
Lexington – Fayette Urban County Government**

April 14, 2016

Part 2 – Time Extensions

There are no time extensions requested.

JUDY Construction Co. GENERAL CONTRACTORS

P.O. BOX 457 CYNTHIANA, KENTUCKY 41031
Telephone (859) 234-6900 Fax (859) 234-3480
www.judyconstructionco.com

November 19, 2015

Tetra Tech
424 Lewis Hargett Circle, Suite 110
Lexington, KY 40503
Attn: Herb Lemaster, P.E.

Ref: Wolf Run Wet Weather Storage Facility
Tank Lighting Conduit
COP # 6

Dear Mr. Lemaster,

We have prepared the following proposal to reroute the electrical conduit for the tank lighting around the top of the tank.

| | |
|------------------------------------|------------|
| Reroute electrical conduit on tank | \$3,600.00 |
|------------------------------------|------------|

If this proposal is acceptable, please incorporate it into the next change order. If you have any questions, feel free to call me.

Sincerely,



Paul Lawrence

cc: Ben Williams
COP File

PL/lj



JUDY

Construction Co.
GENERAL CONTRACTORS

P.O. BOX 457 CYNTHIANA, KENTUCKY 41031
Telephone (859) 234-6900 Fax (859) 234-3480
www.judyconstructionco.com

March 17, 2016

Tetra Tech
424 Lewis Hargett Circle, Suite 110
Lexington, KY 40503
Attn: Herb Lemaster, P.E.

Ref: Wolf Run Wet Weather Storage Facility
42" Gravity Sewer Line
COP # 7

Dear Mr. Lemaster,

We have prepared the following proposal for the additional 42" gravity sewer line per your drawing CO-2. Our price includes provisions to remove the existing power pole, cable and phone lines, as well as a tree by the existing manhole. The base price includes using HOBAS piping with alternate pricing for Ductile Iron and PVC.

| | |
|-------------------------------------|-----------|
| Relocate existing 42" gravity sewer | \$148,328 |
| Add to use PVC | \$17,819 |
| Add to use Ductile Iron | \$32,035 |

We are concerned the existing 4' diameter manhole that we are tying the new 30" line into may need to be replaced. We have not included a new 4' diameter manhole in our price or any work associated with the existing gravity sewer line. If requested, we can provide a proposal to replace the existing manhole after it is exposed and inspected.

Per your request, we have sent a separate proposal requesting a time extension. If this is acceptable, please incorporate it into the next change order. If you have any questions, feel free to call me.

Sincerely,



Paul Lawrence

cc: Ben Williams
Darryl Wells
COP File



PL/lj

Celebrating 40 Years of Business



JUDY Construction Co.

GENERAL CONTRACTORS

P.O. BOX 457 CYNTHIANA, KENTUCKY 41031
Telephone (859) 234-6900 Fax (859) 234-3480
www.judyconstructionco.com

March 9, 2016

Tetra Tech
424 Lewis Hargett Circle, Suite 110
Lexington, KY 40503
Attn: Herb Lemaster, P.E.

Ref: Wolf Run Wet Weather Storage Facility
Architectural Improvements
COP # 9

Dear Mr. Lemaster,

We have prepared the following proposal for the architectural improvements to the landscaping and fence per your drawings L201, L501 and L502.

Fencing and landscaping improvements \$42,321.00

NOTE: The request for additional time related to this proposal will be issued in a separate proposal as directed by the owner.

If this proposal is acceptable, please notify us and add to the next change order. Feel free to contact me with any questions.

Sincerely,

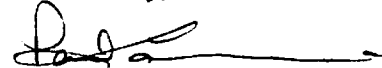

Paul Lawrence

cc: Ben Williams
Darryl Wells
COP File

PL/lj



Celebrating 40 Years of Business



LeMaster, Laura

From: Paul Lawrence <plawrence@judyconstructionco.com>
Sent: Friday, November 06, 2015 3:00 PM
To: LeMaster, Laura
Cc: Lemaster, Herbert; Ben Williams
Subject: Pump Station Backfill

Follow Up Flag: Follow up
Flag Status: Completed

Laura,

Here is a breakdown for the flowable fill that we poured around the pump station:

Flowable fill placed – 387CY @ \$189/CY = \$73,143
Credit for stone & difference in conc.
Unit price = \$11,486
TOTAL \$61,657

Do you want me to bill this to the change order concrete fill line in the pay estimate?

Paul Lawrence
Project Manager



PO Box 457
Cynthiana, KY 41031
Phone 859-234-6900
Fax 859-234-3480
www.judyconstructionco.com

LeMaster, Laura

From: Paul Lawrence <plawrence@judyconstructionco.com>
Sent: Friday, March 18, 2016 4:54 PM
To: Lemaster, Herbert; LeMaster, Laura
Cc: Ben Williams
Subject: FW: Wolf Run CO Breakdown

Herb,
Here is the cost breakdown for the 42" pipe relocation proposal.

| | |
|---------------------|-------------|
| Material | \$67,460.00 |
| Labor | \$38,694.00 |
| Subcontract | \$19,924.00 |
| Overhead and Profit | \$22,250.00 |

Let me know if you have any questions.

Paul Lawrence
Project Manager



PO Box 457
Cynthiana, KY 41031
Phone 859-234-6900
Fax 859-234-3480
www.judyconstructionco.com

LeMaster, Laura

From: Paul Lawrence <plawrence@judyconstructionco.com>
Sent: Friday, April 01, 2016 1:08 PM
To: Lemaster, Herbert; LeMaster, Laura
Cc: Ben Williams
Subject: Change Order Breakdown

Follow Up Flag: Follow up
Flag Status: Flagged

Herb/Laura,
Here is the breakdown you requested on the material for the 42" pipe relocation proposal.

| | |
|--|---------------|
| Demo, raise MH, pumping, erosion control | \$8,500 |
| 8' diameter MH | 7,200 |
| 6' diameter MH credit | (4,200) |
| HOBAS pipe | 37,050 |
| Credit for 42" DIP (pipe is already on site, credit Includes restocking fees) | (8,437) |
| Pipe bedding & pipe accessories | 5,200 |
| Sales tax, Travel Expenses, Supervision, Etc. | 5,300 |
| Equipment & Fuel | <u>16,847</u> |
| Total | \$67,460 |

Paul Lawrence
Project Manager



PO Box 457
Cynthiana, KY 41031
Phone 859-234-6900
Fax 859-234-3480
www.judyconstructionco.com

LeMaster, Laura

From: Paul Lawrence <plawrence@judyconstructionco.com>
Sent: Monday, March 14, 2016 10:16 AM
To: Lemaster, Herbert; LeMaster, Laura
Cc: Ben Williams
Subject: FW: Wolf Run

Here is the breakdown you requested. Let me know if you have any questions.

Fence 29,062.00
Landscaping 4,120
Masonry 4,998
Concrete/Excavation/Supervision 4,141

Total 42,321

Paul Lawrence
Project Manager



PO Box 457
Cynthiana, KY 41031
Phone 859-234-6900
Fax 859-234-3480
www.judyconstructionco.com

LeMaster, Laura

From: Paul Lawrence <plawrence@judyconstructionco.com>
Sent: Wednesday, April 13, 2016 3:10 PM
To: Lemaster, Herbert; LeMaster, Laura
Subject: FW: Fence Breakdown

Follow Up Flag: Follow up
Flag Status: Flagged

Here is the breakdown on the fence pricing

He didn't give a per foot price because the fence is panelized and has several components. He didn't want to price it by the foot because it wouldn't be accurate. There is a total of 136LF

| | |
|------------------------|----------------|
| New Fence Price: | \$37,425 |
| Credit for Chain-link: | <u>\$8,363</u> |
| Total Add | \$29,062.00 |

Paul Lawrence
Project Manager



PO Box 457
Cynthiana, KY 41031
Phone 859-234-6900
Fax 859-234-3480
www.judyconstructionco.com

21' 120' 11' 08.33' AM - P:\0811\0811030-1\08111402\CAMARDEL\FILESWOLF_RUR_CHANGE_ORDER_23-18.DWG - LEHMASTER, LAURA

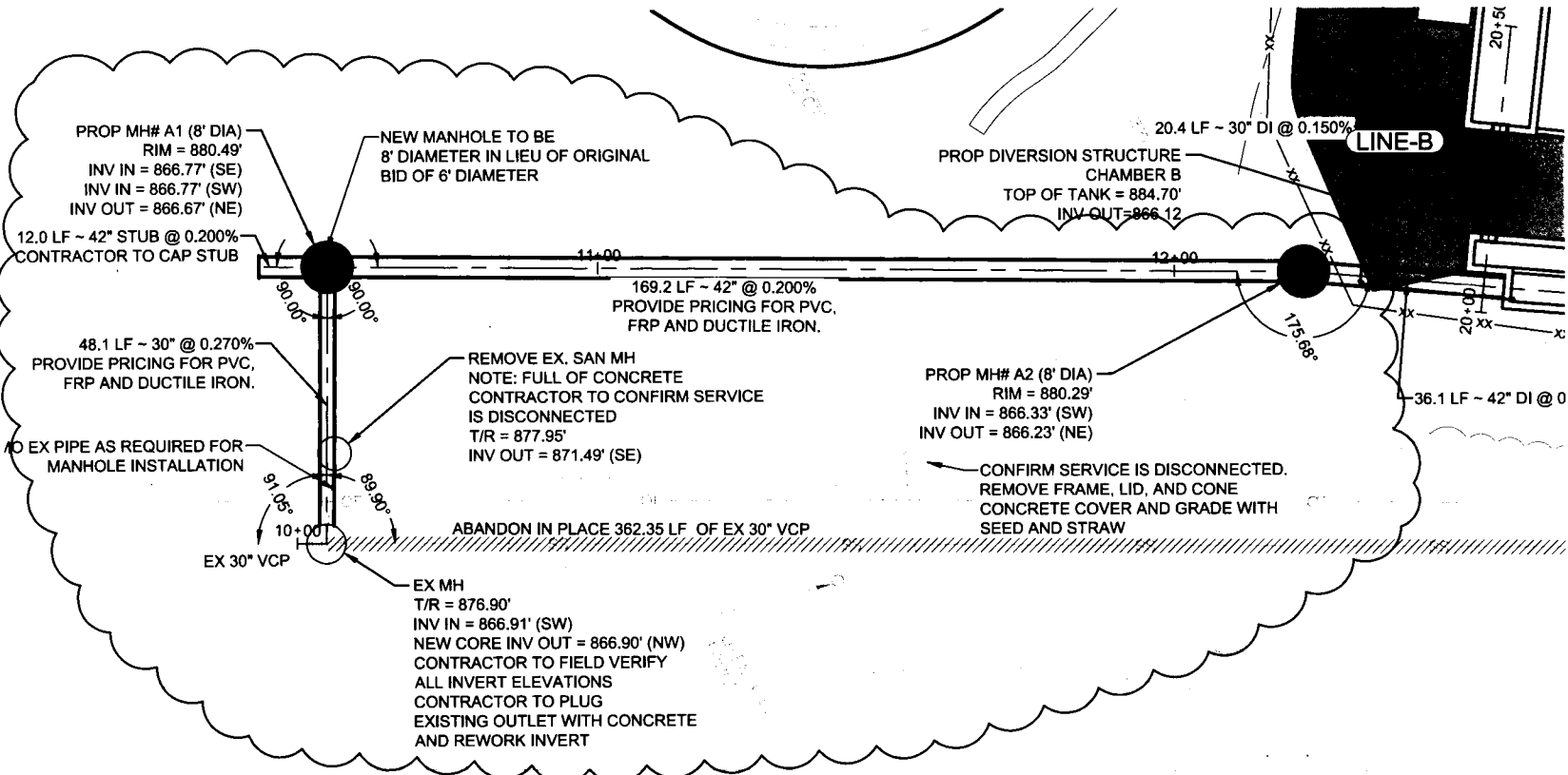

NOTE:

1. CONTRACTOR SHALL INSTALL SILT FENCE BETWEEN ANY OPEN EXCAVATION AND WOLF RUN CREEK.
2. THE CONTRACTOR SHALL SEED AND MULCH THE DISTURBED AREA WITHIN 25 FEET OF THE STREAM WITHIN 24 HOURS OF COMPLETING WORK.
3. CONTRACTOR SHALL NOT LEAVE OPEN EXCAVATION OVER NIGHT.
4. CONTRACTOR SHALL PROVIDE PRICING TO REPLACE THE EXISTING MANHOLE AS WELL AS A PRICE FOR PLUGGING THE EXISTING MANHOLE AND REWORKING THE INVERT.
5. ALL RIMS BELOW 100-YEAR FLOODPLAIN TO BE INSTALLED WITH INFILTRATION PAN.

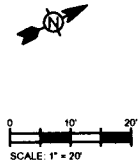

| MARK | DATE | DESCRIPTION |
|------|------|-------------|
| | | |
| | | |
| | | |
| | | |
| | | |
| | | |
| | | |
| | | |
| | | |
| | | |
| | | |
| | | |
| | | |
| | | |

Project No. 200-1981-14002
 Designed by: LEL
 Drawn by: WDV
 Checked by: HRL

Change Order
 PROPOSED RELOCATED 42"
 SEWER PIPE AND MANHOLE

CO-2

Copyright: Tetra Tech
 Bar Measures: 1 inch

www.tetra-tech.com
 424 LEWIS HARBETT CIRCLE, SUITE 110
 LEWISTON, NY 14608
 PH: (609) 754-0000 FAX: (609) 754-0002

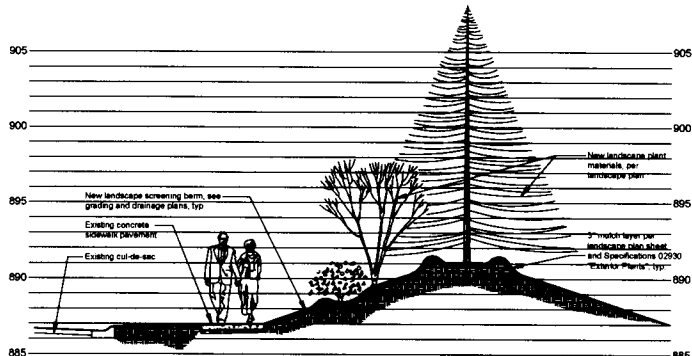

SECTION THROUGH BERM B
Scale: 1/4" = 1'-0" (A)

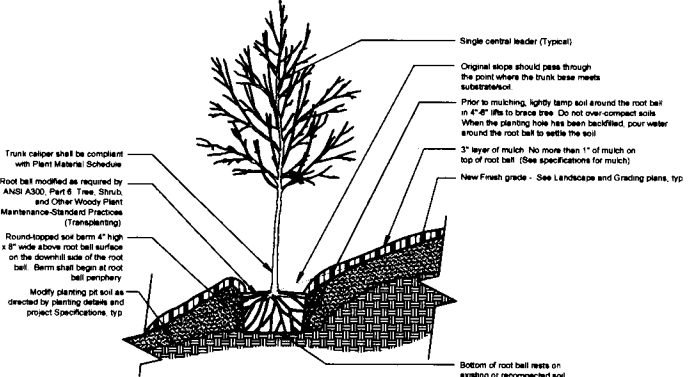

TYPICAL TREE PLANTING ON SLOPE 5% (20:1) TO 50% (2:1)
Not to Scale (B)

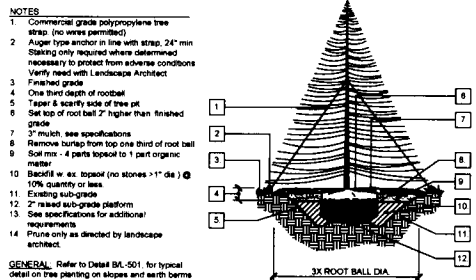

EVERGREEN TREE PLANTING & GUYING
Not to Scale (C)

- NOTES**
- Commercial grade polypropylene tree strap (no wires permitted)
 - Original grade
 - One third depth of rootball
 - Taper & scarify side of tree pit
 - Backfill w. ex. topsoil (no stones >1" dia.) @ 10% quantity or less
 - 2"x2"x8" untreated hardwood stake. Staking only required where determined necessary to protect from adverse conditions. Verify need with Landscape Architect
 - Set top of root ball 2" higher than finished grade
 - Remove burp from top one third of root ball
 - 3" mulch, see specifications
 - Soil mix - 4 parts topsoil to 1 part organic matter
 - Existing sub-grade
 - 2" raised sub-grade platform
 - See specifications for additional requirements
 - Prune only as directed by landscape architect

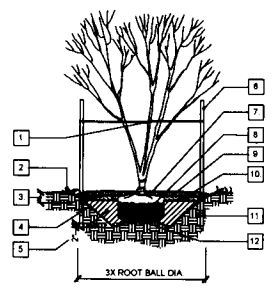

ORNAMENTAL TREE PLANTING DETAIL
Not to Scale (D)

- NOTES**
- Remove burp from top one third of root ball
 - Finished grade
 - Taper & scarify side of pit
 - 3" mulch, see specifications
 - Soil mix - 4 parts topsoil to 1 part organic matter (see specifications)
 - Existing sub-grade
 - See specifications for additional requirements
 - Prune only as directed by landscape architect

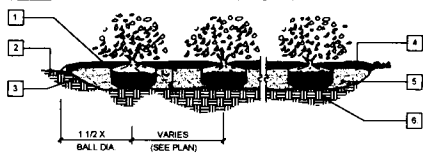

TYPICAL SHRUB MASS PLANTING
Not to Scale (E)

- NOTES**
- Commercial grade polypropylene tree strap (no wires permitted)
 - Finished grade
 - One third depth of rootball
 - Taper & scarify side of tree pit
 - 2"x2"x8" untreated hardwood stake. Staking only required where determined necessary to protect from adverse conditions. Verify need with Landscape Architect
 - Set top of root ball 2" higher than finished grade
 - 3" mulch, see specifications
 - Remove burp from top one third of root ball
 - Soil mix - 4 parts topsoil to 1 part organic matter
 - Backfill w. ex. topsoil (no stones >1" dia.) @ 10% quantity or less
 - Existing sub-grade
 - 2" raised sub-grade platform, compacted
 - See specifications for additional requirements
 - Prune only as directed by landscape architect

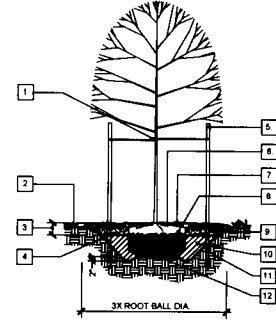

SHADE TREE STAKING & PLANTING
Not to Scale (F)

TETRA TECH
www.tetrattech.com
424 LEWIS HARGETT CIRCLE, SUITE 110
LEWISTON, KY 40303
PH: (606) 224-0001 FAX: (606) 224-1025

STATE OF KENTUCKY
LANDSCAPE ARCHITECT
P.L.A. peckins landscape architecture, llc
248 West Olive St. Ste. 108, Lexington, KY 40502
PH: (606) 253-1138
www.peckinslandscape.com

BY
DATE
DESCRIPTION
MARK

LANDSCAPE ARCHITECT
LUCIG Bld. No.
RMP ID No. WVR-B

PLANTING DETAILS

Project No. 208-1188-14022
Designed By JEP
Drawn By JEP
Checked By

L-501

Bar Measures 1 inch

2/17/2018 8:15 PM - C:\USERS\PERKINS\PIA\WORK\DRAWINGS\PLA_012916\MOL\RUN\STORAGE\ANKS.DWG - JONATHAN PERKINS

2/10/16 8:18:28 PM - C:\USERS\PERINOR\PIRO\WORK\FURN STORAGE - TANKS\DWG\MSP_A_121916_L\COLU\STORAGE-TANKS.DWG - JONATHAN PERINS

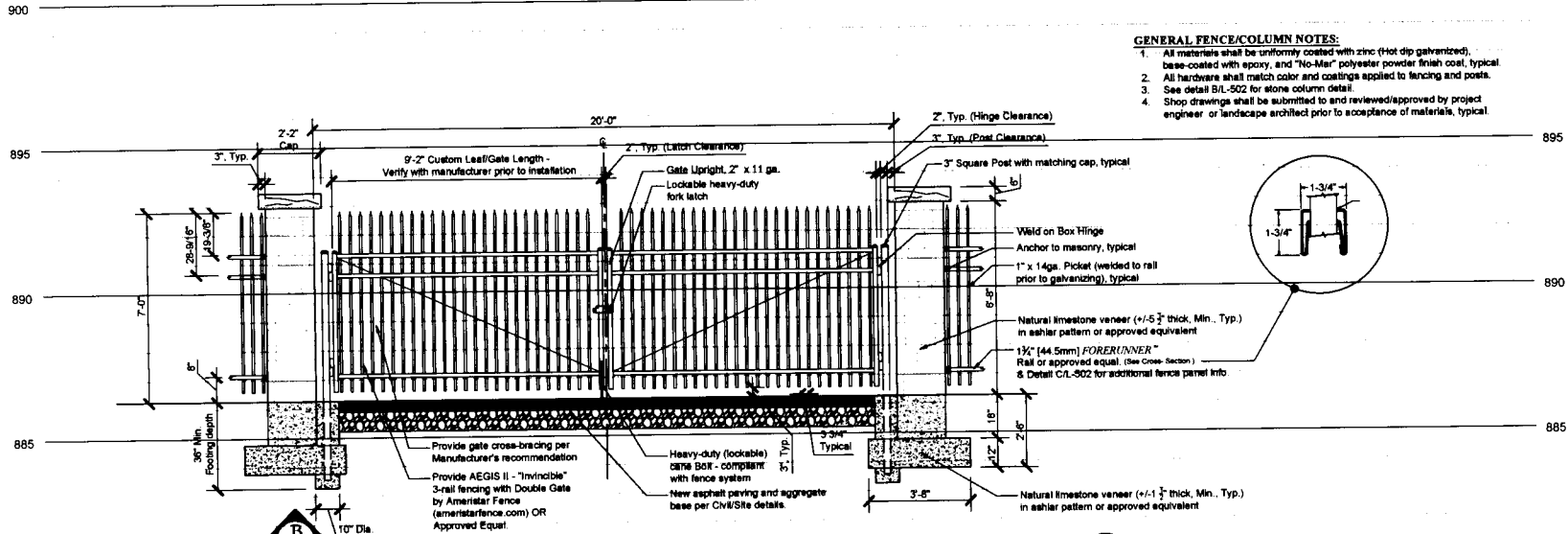

- GENERAL FENCE/COLUMN NOTES:**
- All materials shall be uniformly coated with zinc (hot dip galvanized), base-coated with epoxy, and "No-Mar" polyester powder finish coat, typical.
 - All hardware shall match color and coatings applied to fencing and posts.
 - See detail B/L-502 for stone column detail.
 - Shop drawings shall be submitted to and reviewed/approved by project engineer or landscape architect prior to acceptance of materials, typical.

NEW METAL DOUBLE-SWING GATE AND STONE COLUMN ELEVATION

Scale: 1/2" = 1'-0"

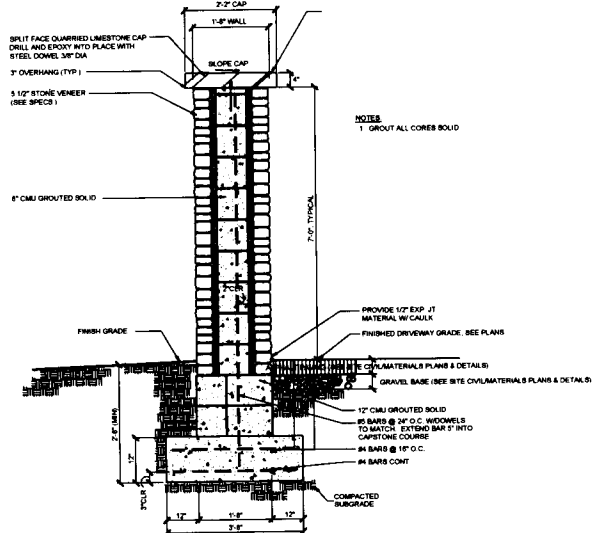

STONE VENEER COLUMN SECTION DETAIL

Not To Scale

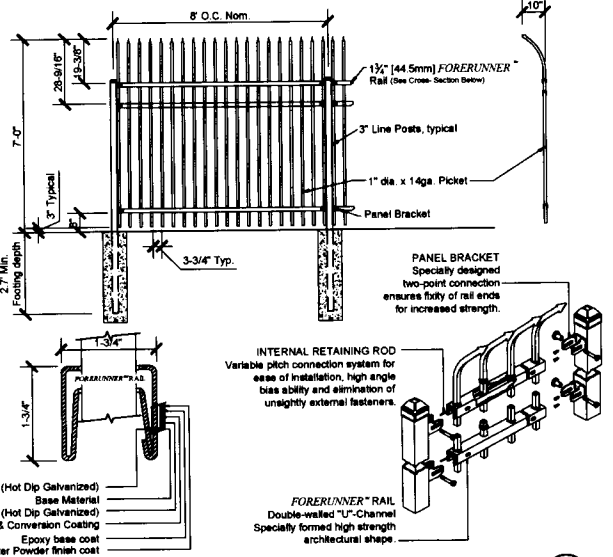

AEGIS II - "INVINCIBLE" 3-RAIL FENCE PANEL (BASIS OF DESIGN)

Not To Scale



PLA: Perkins landscape architecture, llc
18 West Street, Ste. 208 Lexington, KY 40501
Tel: 606.253.2000 Fax: 606.253.1025
www.perkinsla.com

| MARK | DATE | DESCRIPTION |
|------|------|-------------|
| | | |
| | | |
| | | |
| | | |
| | | |
| | | |

Project No.: 200-11683-14002
Designed By: JEP
Drawn By: JEP
Checked By: JEP

L-502

See Measures 1 inch

MAYOR JIM GRAY



LEXINGTON

CHARLES MARTIN
DIRECTOR
WATER QUALITY

TO: Mayor Jim Gray
Urban County Council

FROM: Vernon Azevedo, P.E.
Remedial Measures Program Manager

DATE: May 10, 2016

SUBJECT: Change Order #3 – Wolf Run Wet Weather Storage Facility

Request

The Division of Water Quality requests approval of Change Order #3 to Judy Construction Company increasing the cost of the Wolf Run Wet Weather Storage project, Resolution No. 170-2015 dated April 16, 2015.

Why are you requesting?

The requested change is for rerouting electrical conduit to allow for tank lighting, additional piping, architectural improvements, and a credit for backfill that is no longer needed.

What is the cost in this budget year and future budget years?

The cost for this FY is: \$182,763

The cost for future FY is: \$0

Are the funds budgeted?

The funds are budgeted or a budget amendment is in process: Yes

Account number: 4003-303408-3466-92811 2013 LFUCG WREQUALTNK_2013 CONSENT_DE

Director/Commissioner: Martin / Hoskins-Squier





TETRA TECH

April 14, 2016

Vernon Azevedo, PE
Division of Water Quality
125 Lisle Industrial Avenue, Suite 180
Lexington, Kentucky 40511

Re: *Wolf Run Wet Weather Storage Facility
Lexington-Fayette Urban County Government*

Dear Mr. Azevedo:

Tetra Tech has reviewed the attached change order proposed by Judy Construction Company (Judy). Following is a description of the change order items and our recommendation for each item. Documentation and breakdowns of the change order requests are attached.

Item 1-1

Judy has provided a credit of **\$11,486.00** to LFUCG for the DGA that was removed from the Contract Documents as backfill around the wet well. The wet well is to be backfilled with lean concrete, due to the wet site conditions that have been encountered during construction. Based on Tetra Tech's estimates, this equates to approximately **\$29.68** per ton for DGA. Tetra Tech recommends LFUCG approve this portion of the change order, as DGA will no longer be used as a backfill around the wet well.

Item 1-2

Judy has provided a lump sum cost of **\$3,600.00** dollars for the Tank Conduit Lighting. The cost is for rerouting the electrical conduit to allow for the tank lighting.

Item 1-3

Judy has provided a lump sum cost of **\$148,328.00** for the additional 42-inch and 30-inch piping requested by LFUCG. Tetra Tech requested that Judy provide a price for FRP piping, PVC, and Ductile Iron. The price of \$148,328.00 is for the installation of FRP. PVC and ductile iron increase the lump sum cost \$17,819.00 and \$32,035.00 respectively. The additional piping is currently included in a future Remedial Measures Program project. LFUCG requested Judy to provide a price for the additional piping at this time to avoid disturbing the Wolf Run Wet Weather Storage Facility site with future projects. Tetra Tech recommends LFUCG approve this portion of the work, at the price given for FRP to avoid disturbing a recently finished project with future construction. The material cost for the additional piping, manholes, erosion control, pipe bedding, etc. is \$67,460.00. This material cost includes a credit to LFUCG of \$12,637.00 for the 8 foot diameter manhole and the 50 linear feet of 42-inch ductile iron pipe included in the original contract documents. The lump sum price submitted by Judy also includes \$38,694.00 in labor cost, \$19,924.00 in subcontracting cost and \$22,250.00 in overhead and profit. The subcontract costs include the cost of bypass pumping, temporary fencing, seeding and manhole coring. The overhead and profit is at the Contract Document approved fifteen percent (15%).

Item 1-4

Judy has provided a lump sum cost of **\$42,321.00** for the architectural improvements to the original contract documents that were requested by Council Member Henson to improve the aesthetics of the tank to the surrounding neighborhood. The project sets within the Cardinal

Tetra Tech, Inc.

424 Lewis Hargett Circle, Suite 110, Lexington, KY 40503
Tel: 859.223.8000 Fax: 859.224.1025 www.tetrattech.com



TETRA TECH

Valley neighborhood. Council Member Henson requested changes including modifications to the proposed landscaping, installation of a faux wrought iron fence in lieu of the proposed chain link fence, only for the visible portion of the proposed fence, and installing stone columns and an architectural gate in lieu of the proposed gate. Per Judy, the additional faux wrought iron fence has a lump sum cost of \$29,062.00, the modified landscaping will cost \$4,120.00 and the Masonry for the stone columns will cost approximately \$4,998. Judy provided a credit of \$8,363.00 for the material cost of the chain link fence included in the original contract documents, which is approximately \$61.50 per linear foot of fence base on 136 linear feet of fence. The material cost for the new faux wrought iron fence is \$37,425.00, approximately \$275.20 per linear foot. Tetra Tech recommends LFUCG approve this portion of the change order, as it was requested by Council Member Henson to approve the aesthetics of the tank for the surrounding neighborhood.

The total estimated cost of the change order is **\$182,763.00.00**. Please see the attached Change Order No. 3 provided for a unit price and quantity breakdown. The approved contract amount with this change order will be **\$5,587,359.00**.

Please call myself, or Laura LeMaster, at 859-223-8000 if you have any questions or need additional information.

Sincerely,

Herbert R. Lemaster, P.E.
Herb.lemaster@tetrattech.com

cc: Laura LeMaster, Tt

lsl;P:\NER\11681\200-11681-14002\Construction\Change Orders\Change Order 3\LTR WVA Proposed Change Order 3.doc