

LEGEND

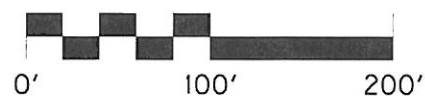

EXISTING RIGHT OF WAY
TO BE CLOSED

VICINITY MAP

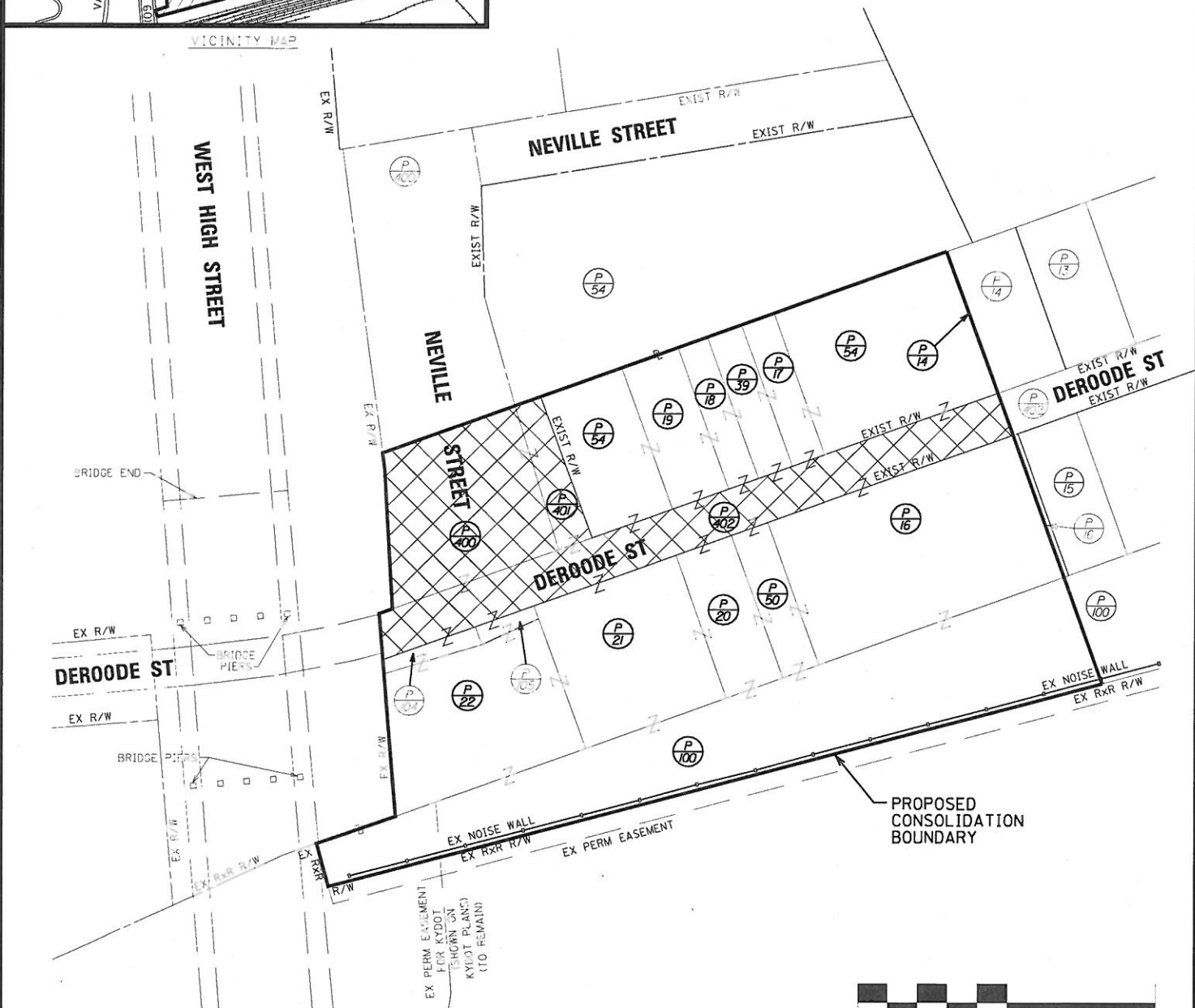

SCALE: 1"=100'



HALL-HARMON ENGINEERS, INC.
1081 DOVE RUN ROAD
SUITE 203
LEXINGTON, KENTUCKY 40502
(859) 269-3150
(859) 269-3079 FAX

**EXHIBIT OF EXISTING LFUGG
RIGHT OF WAY TO CLOSE**

LEXINGTON-FAYETTE URBAN
COUNTY GOVERNMENT
FAYETTE COUNTY
LEXINGTON, KENTUCKY
MARCH 6, 2014



DeRoode St right-of-way to close

HIGH

HIGH

NEVILLE

WHITMER

DEROODE

