

LOWER CANE RUN WET WEATHER STORAGE

DESIGN UPDATE

DECEMBER 8, 2015

THE PROBLEM:

- 1/ The Consent Decree requires LFUCG to abate Recurring Sanitary Sewer Overflows (SSOs).**
- 2/ Lower Cane Run Pump Station is defined as a Recurring SSO.**
- 3/ Lower Cane Run Pump Station sits next to the Legacy Trail.**
- 4/ Recurring SSO solution - a “big” storage tank sitting at ground level.**

CHALLENGE

What can be done to minimize the negative impact this tank will have on one of Lexington's signature recreational amenities?

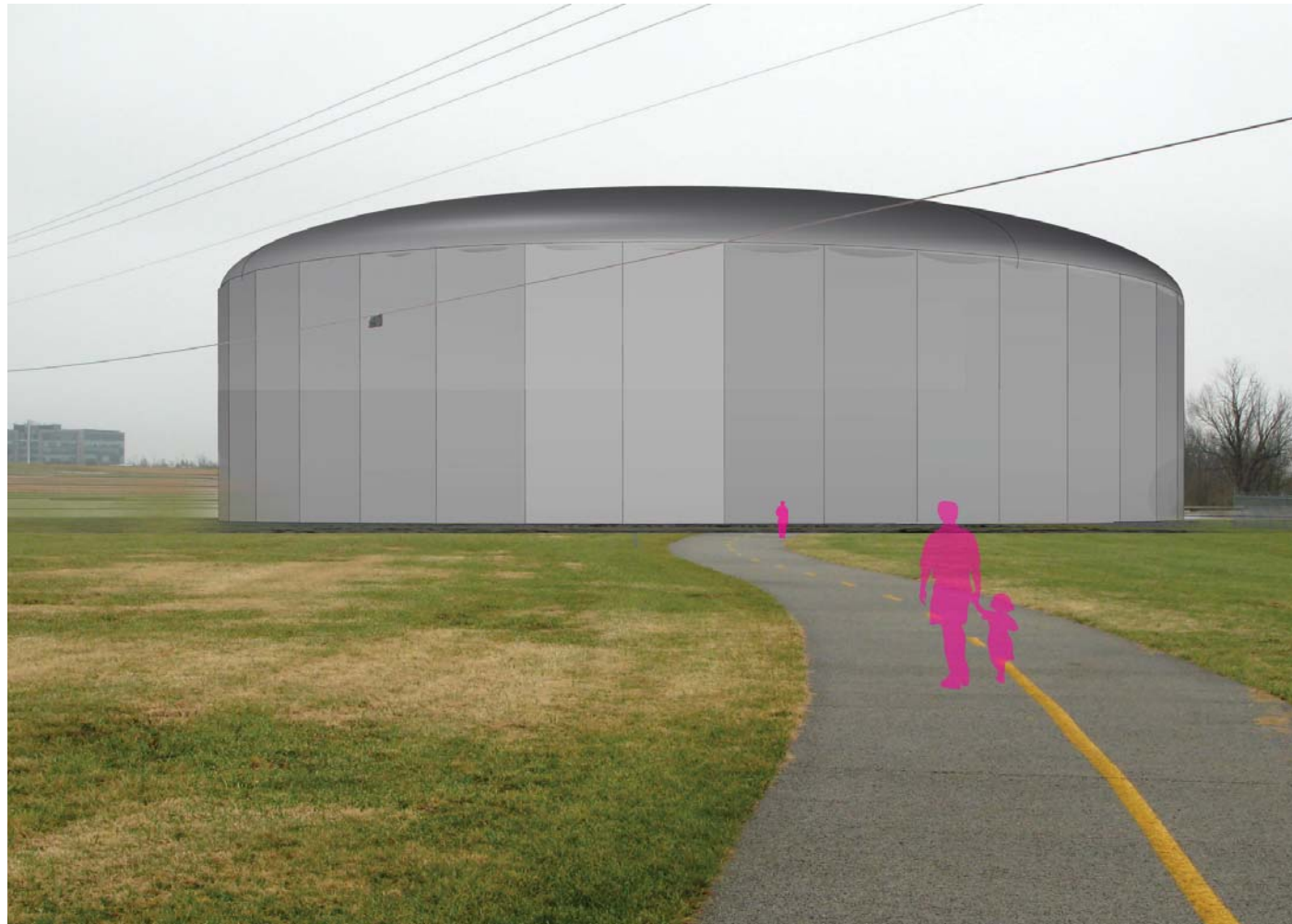

VIEW APPROACHING FROM NORTH ON LEGACY TRAIL

Approx. Tank Dimensions
70 feet tall

200 feet in diameter

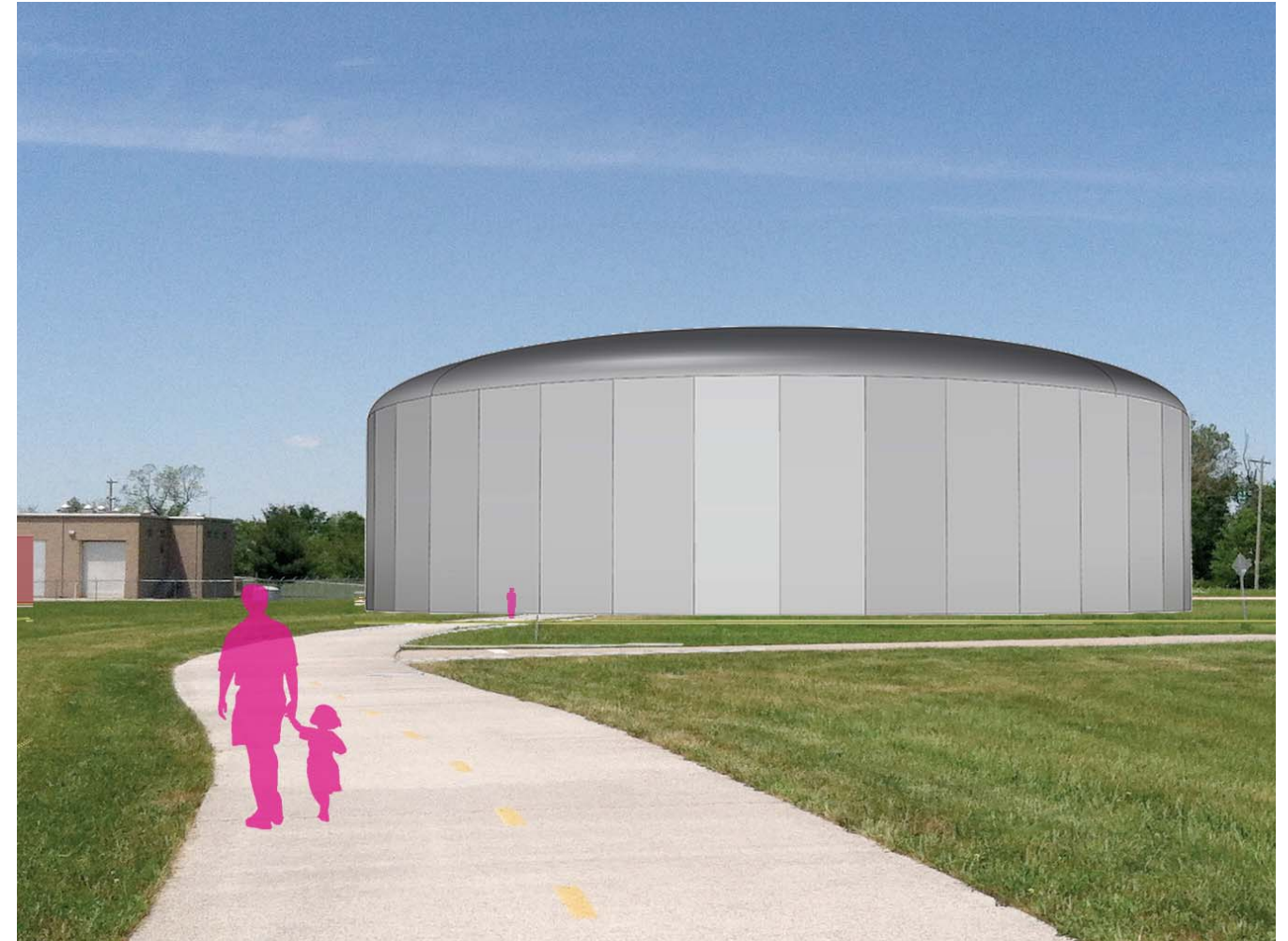

VIEW APPROACHING FROM SOUTH ON LEGACY TRAIL



VISUAL REFERENCE -TOWN BRANCH WET WEATHER STORAGE TANK UNDER CONSTRUCTION

BASE DESIGN COMPONENTS:

Presented and approved by Council
9/15/2015 with \$1.75 M
construction budget.

1/ RESTROOM AND WATER FOUNTAIN

2/ REST AREA WITH BENCHES AND BIKE RACKS

3/ LANDSCAPING

including trees for screening the tank and meadow
mixes for low-maintenance groundcover

4/ BYPASS TRAIL

to provide a fast-track bypass for through-traffic

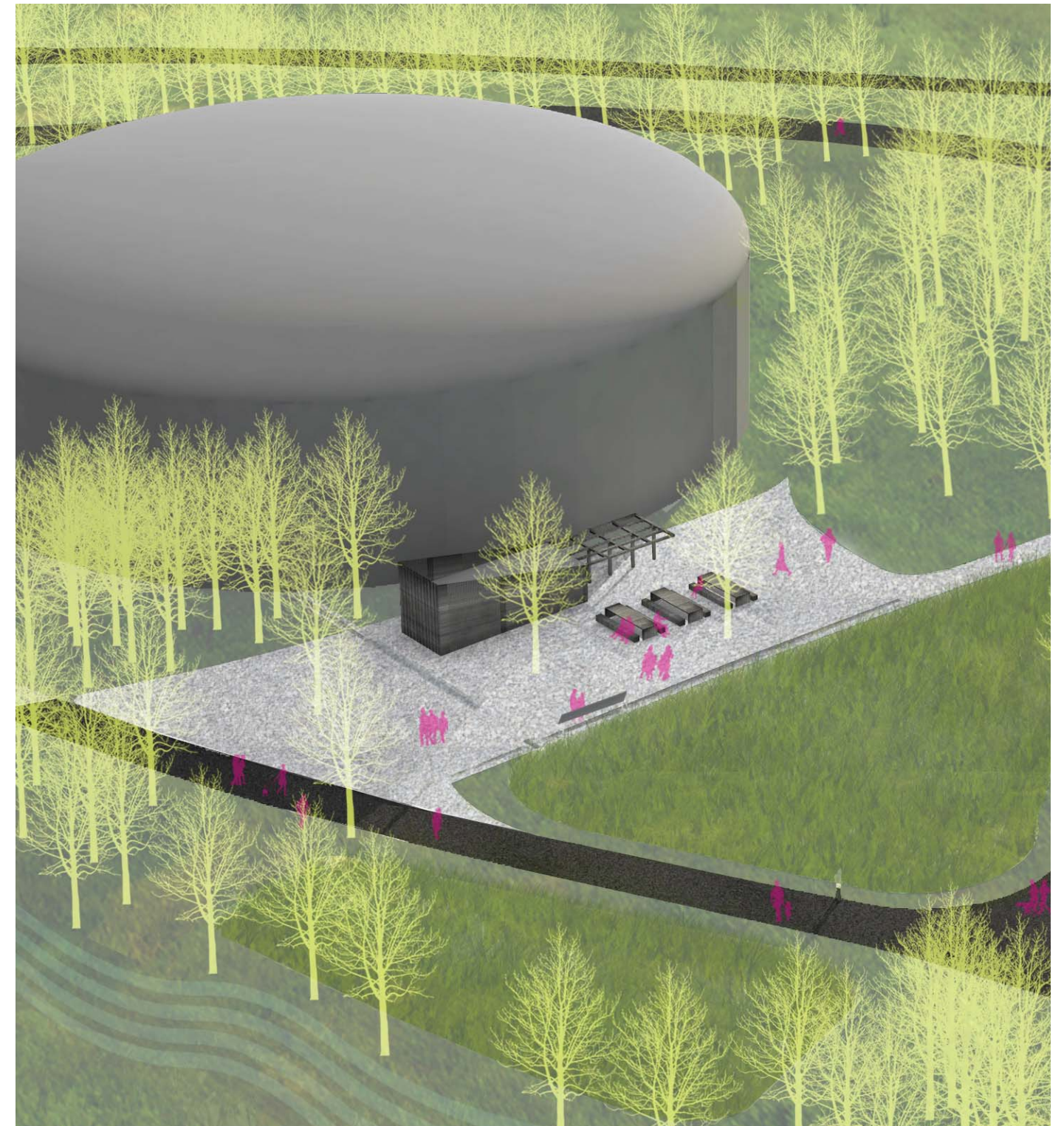

STAKEHOLDERS:

TENANTS / OWNER - COLDSTREAM RESEARCH PARK

BLUEGRASS COMMUNITY FOUNDATION

CANE RUN WATERSHED COUNCIL

LEXINGTON VISITORS CENTER

LEGACY TRAIL ADVISORS AND ADVOCATES

LEXINGTON ART LEAGUE

COUNCIL MEMBERS (2ND AND 12TH)

PARKS AND RECREATION

OTHER DIVISIONS / DEPARTMENTS

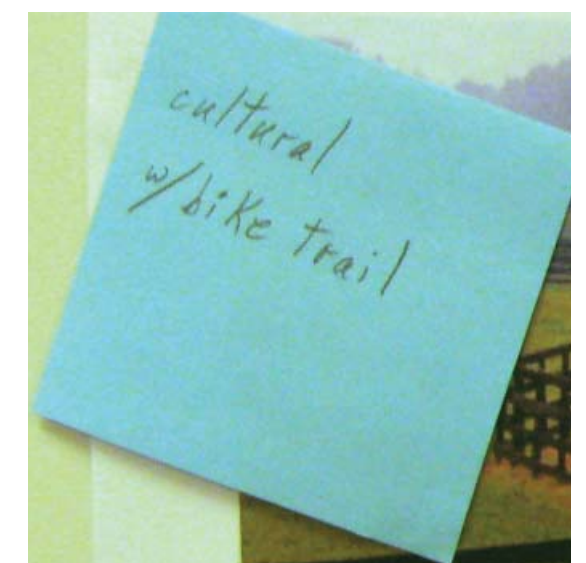
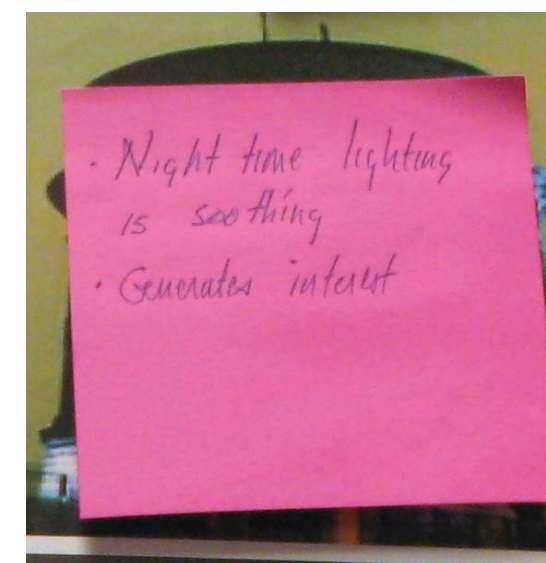
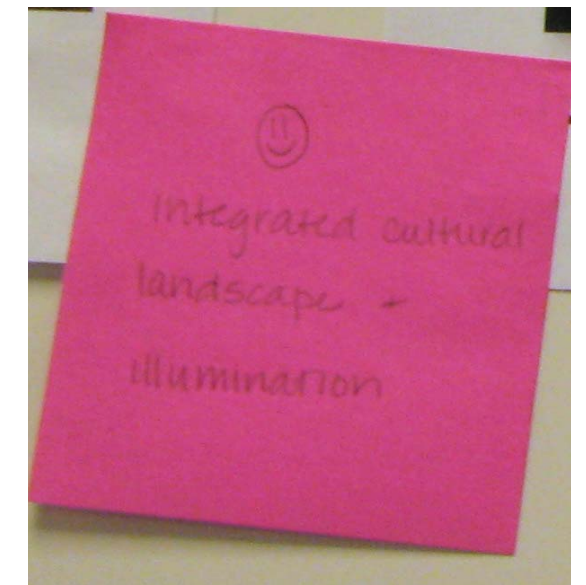
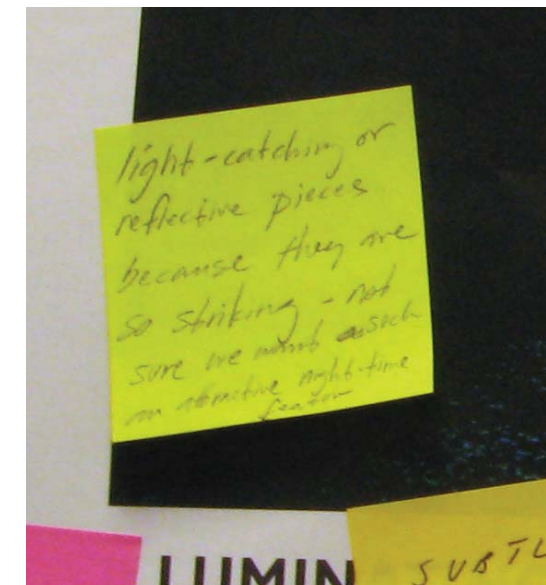
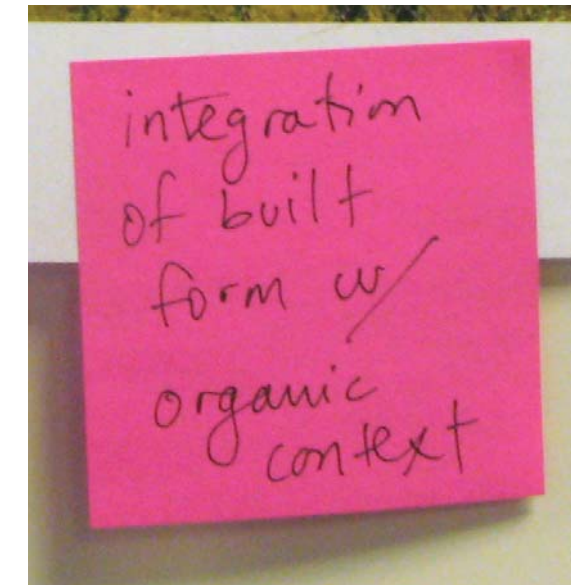
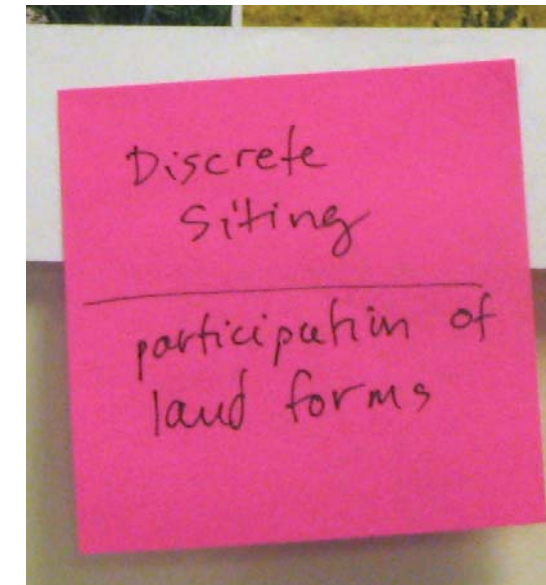

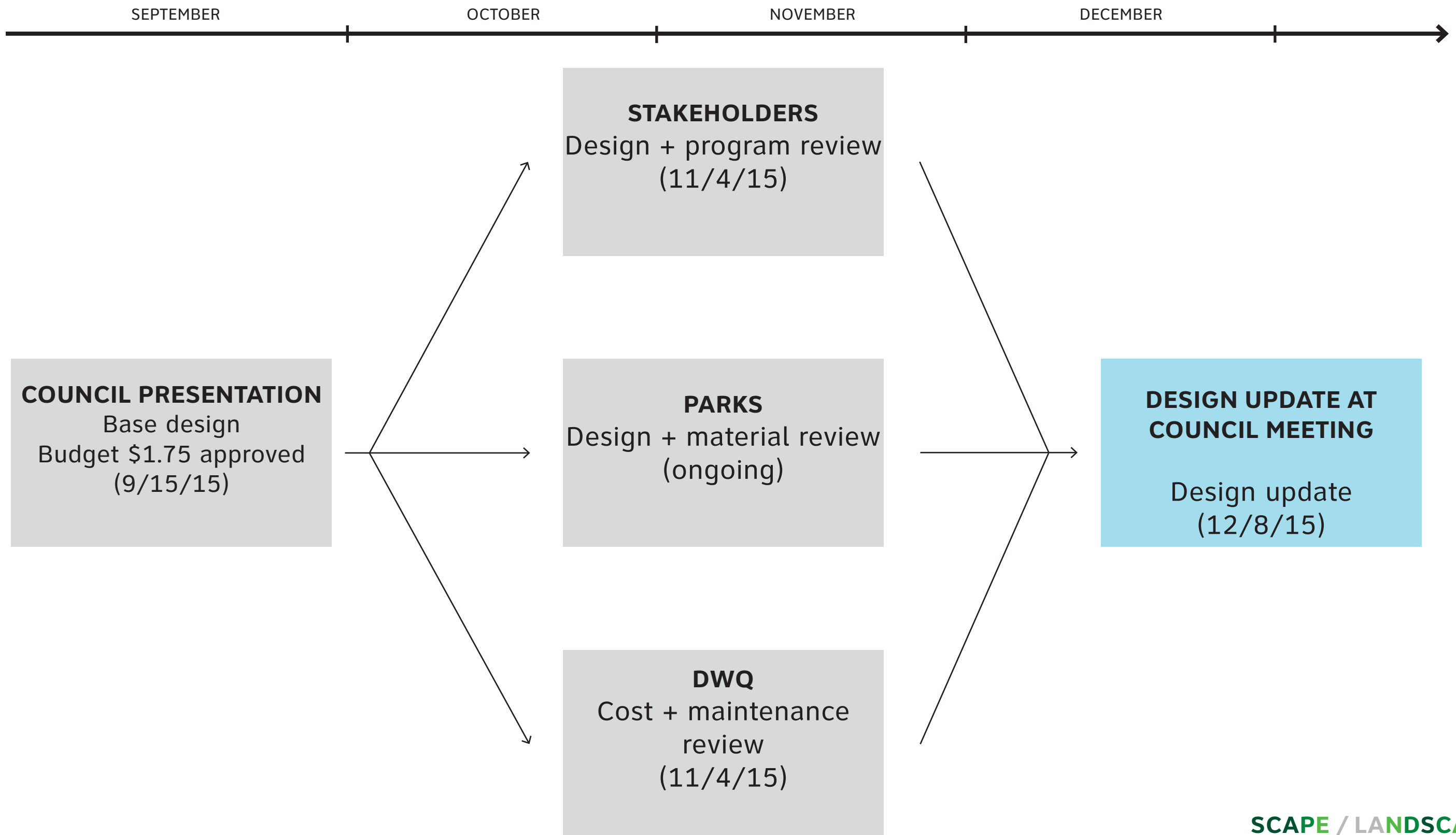

PROCESS



“The trail will be a place for the community to learn about its culture, environment and heritage. As people pass through this landscape, its features, history and processes should be elucidated by the artworks sited along the trail.”

- Legacy Trail PAMP





 **LEGACY TRAIL
PUBLIC ART MASTER PLAN**

LEGACY TRAIL PUBLIC ART CONSORTIUM
April, 2010

Todd W. Bressi
Urban Design
Place Planning
Public Art

Stacy Levy
Artist

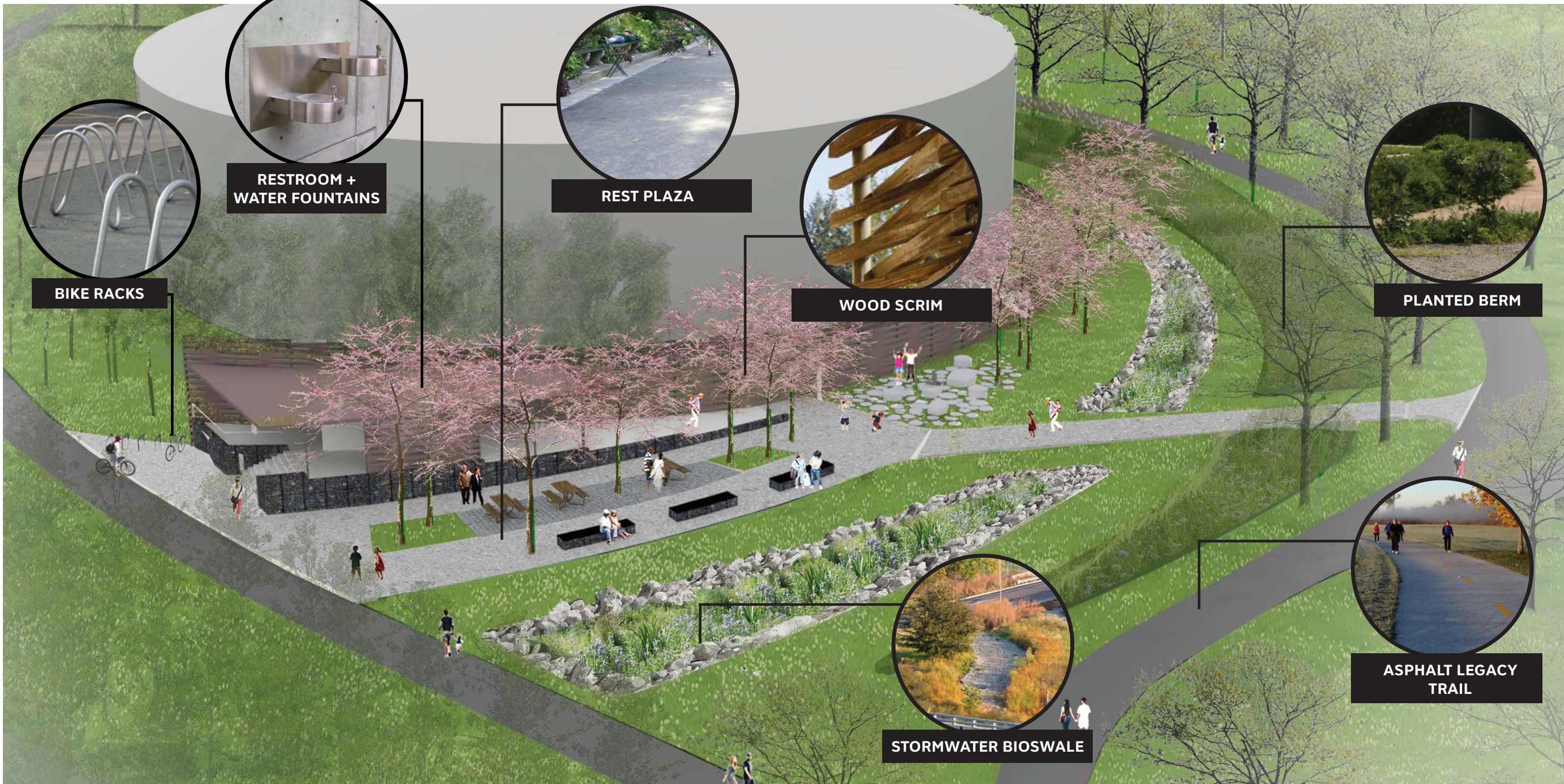

PROGRAM + MATERIALS DIAGRAM



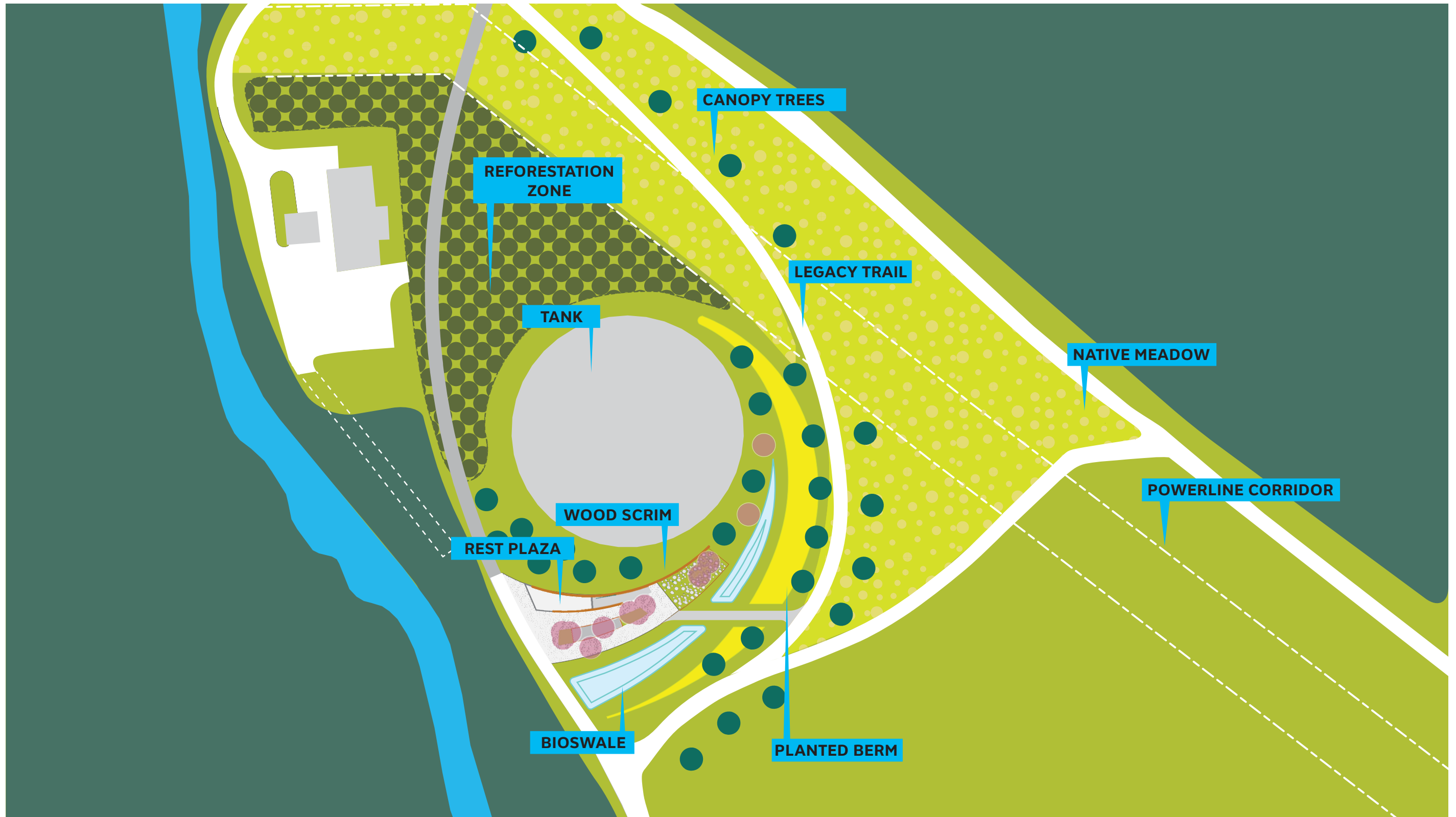

VIEW HEADED NORTH ON LEGACY TRAIL



VIEW OF RESTROOM FACILITY AND REST STOP



VIEW HEADED SOUTH ON LEGACY TRAIL

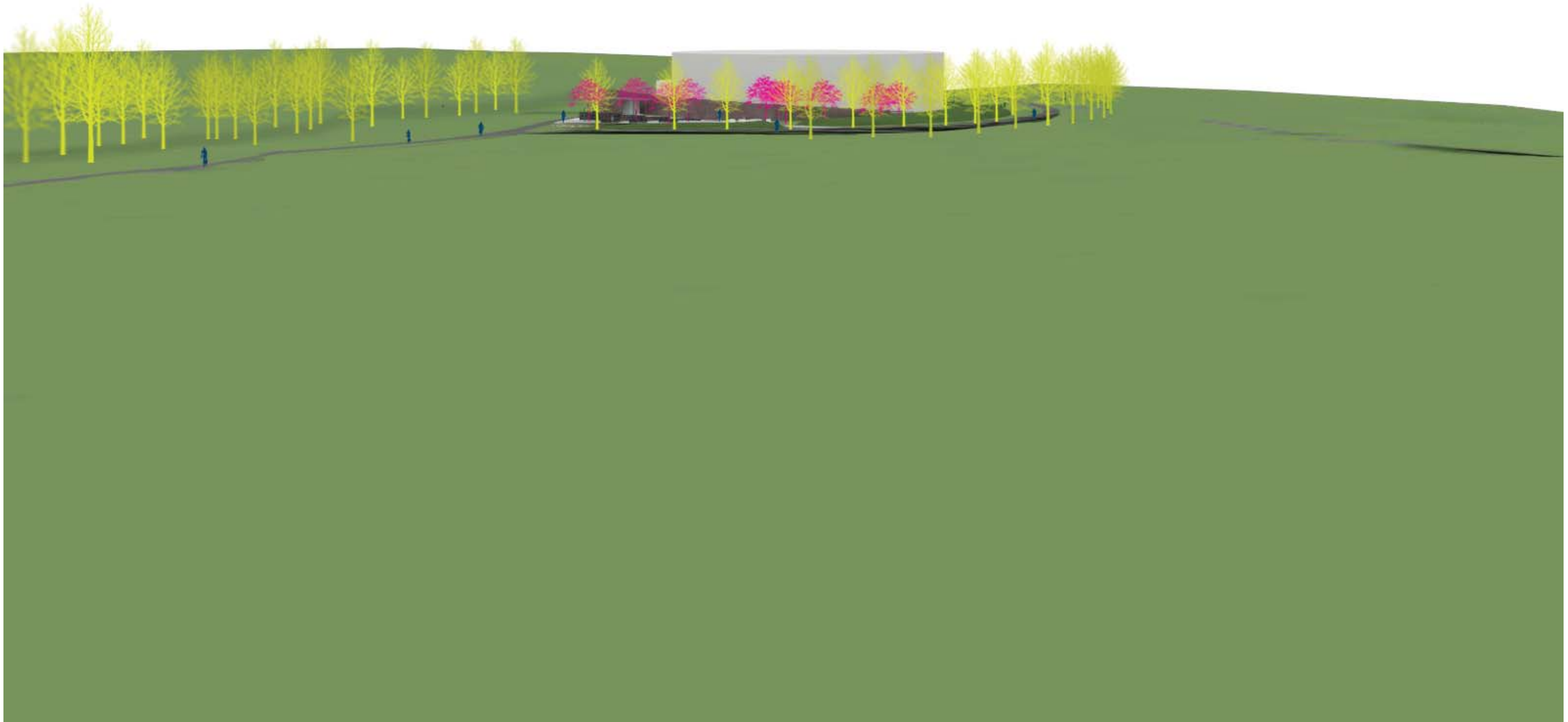

VIEW FROM COLDSTREAM

COUNCIL ACTION REQUESTED TODAY

Endorse design team to proceed with detailed design based upon the revised conceptual design shown today, while maintaining the previously approved Concept Opinion of Cost for construction: \$1,750,000.

BEFORE:

Eye sore
No shade
Fully visible from interstate + Coldstream Park
Interrupts flow of bikes + pedestrians

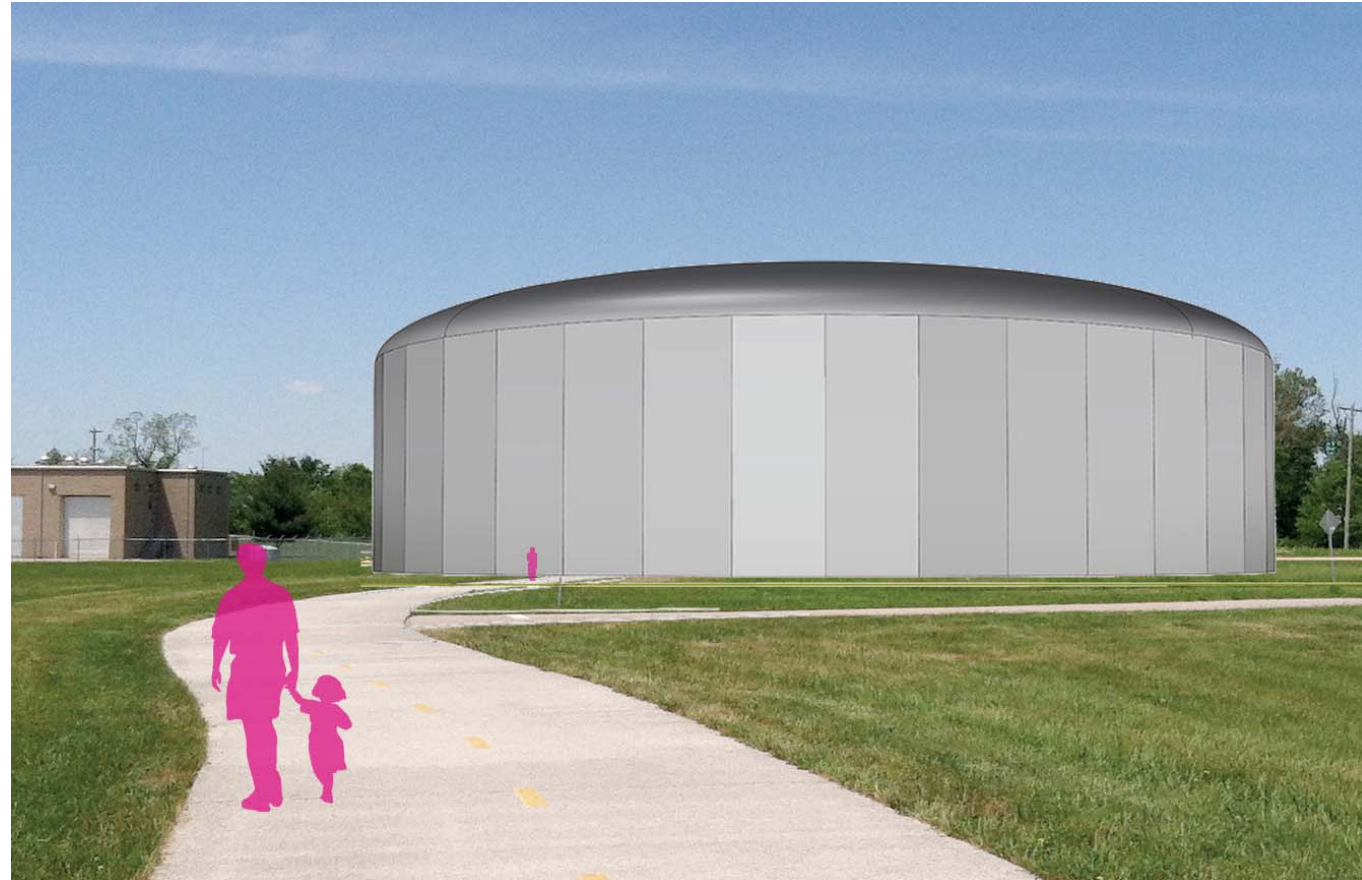

AFTER:

Amenity to Legacy Trail
Shady stopping point
Screens view from interstate + Coldstream Park
Accommodates flow of bikes + pedestrians



VIEW FROM LEGACY TRAIL HEADED NORTH