

RESOLUTION NO. 308-2013

A RESOLUTION DECLARING AS SURPLUS AND AUTHORIZING THE MAYOR, ON BEHALF OF THE LEXINGTON-FAYETTE URBAN COUNTY GOVERNMENT, TO EXECUTE QUIT-CLAIM DEEDS AND ANY OTHER NECESSARY DOCUMENTS FOR THE TRANSFER OF .093 ACRES OF PROPERTY LOCATED AT 946 WHITNEY AVENUE AND .093 ACRES OF PROPERTY LOCATED AT 948 WHITNEY AVENUE TO THE PURCHASER OF AN ADJACENT PARCEL WHICH SHOULD HAVE BEEN INCLUDED IN THE ORIGINAL PURCHASE.

BE IT RESOLVED BY THE COUNCIL OF THE LEXINGTON-FAYETTE URBAN COUNTY GOVERNMENT:

Section 1 - That the Mayor, on behalf of the Lexington-Fayette Urban County Government, be and hereby is authorized to declare as surplus and execute quit-claim deeds and any other necessary documents for the transfer of .093 acres of property located at 946 Whitney Avenue and .093 acres of property located at 948 Whitney Avenue to the purchaser of an adjoining parcel which should have been included in the original purchase.

Section 2 - That this Resolution shall become effective on the date of its passage.

PASSED URBAN COUNTY COUNCIL: June 20, 2013

MAYOR

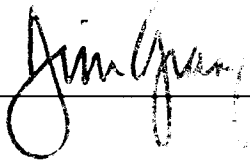

ATTEST:

CLERK OF URBAN COUNTY COUNCIL

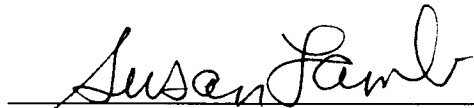



Lexington-Fayette Urban County Government
DEPARTMENT OF GENERAL SERVICES

Jim Gray
Mayor

Geoff Reed
Commissioner

MEMORANDUM

TO: Mayor Jim Gray
Sally Hamilton, CAO
Urban County Council

FROM: 
Geoff Reed
Commissioner of General Services

DATE: May 15, 2013

RE: Request for Declaration as Surplus and Quit Claim of Properties

It is our request that Urban County Council grant approval for authorization of the disposal of the following two parcels of land, where LFUCG is shown as the owner in the PVA records. The parcels are listed as follows:

NO	Street Name	Parcel ID	Acres	Square Ft	Council Dist	Owner
946	Whitney Ave	38245230	0.093	4,050	2	LFUCG
948	Whitney Ave	38245250	0.093	4,050	2	LFUCG

In December, 2010 the Department of General Services disposed of 950 Whitney Avenue as surplus property through the bid process. The disposal was intended to alleviate ongoing maintenance of the parcel and place the property back onto the tax roll. General Services represented to potential buyers that the entire open area was being purchased and has since learned that two additional small parcels were not included in the sale. General Services now seeks Council approval to declare the remaining small parcels as surplus and Quit Claim the property to the purchaser of the 950 Whitney Avenue parcel.

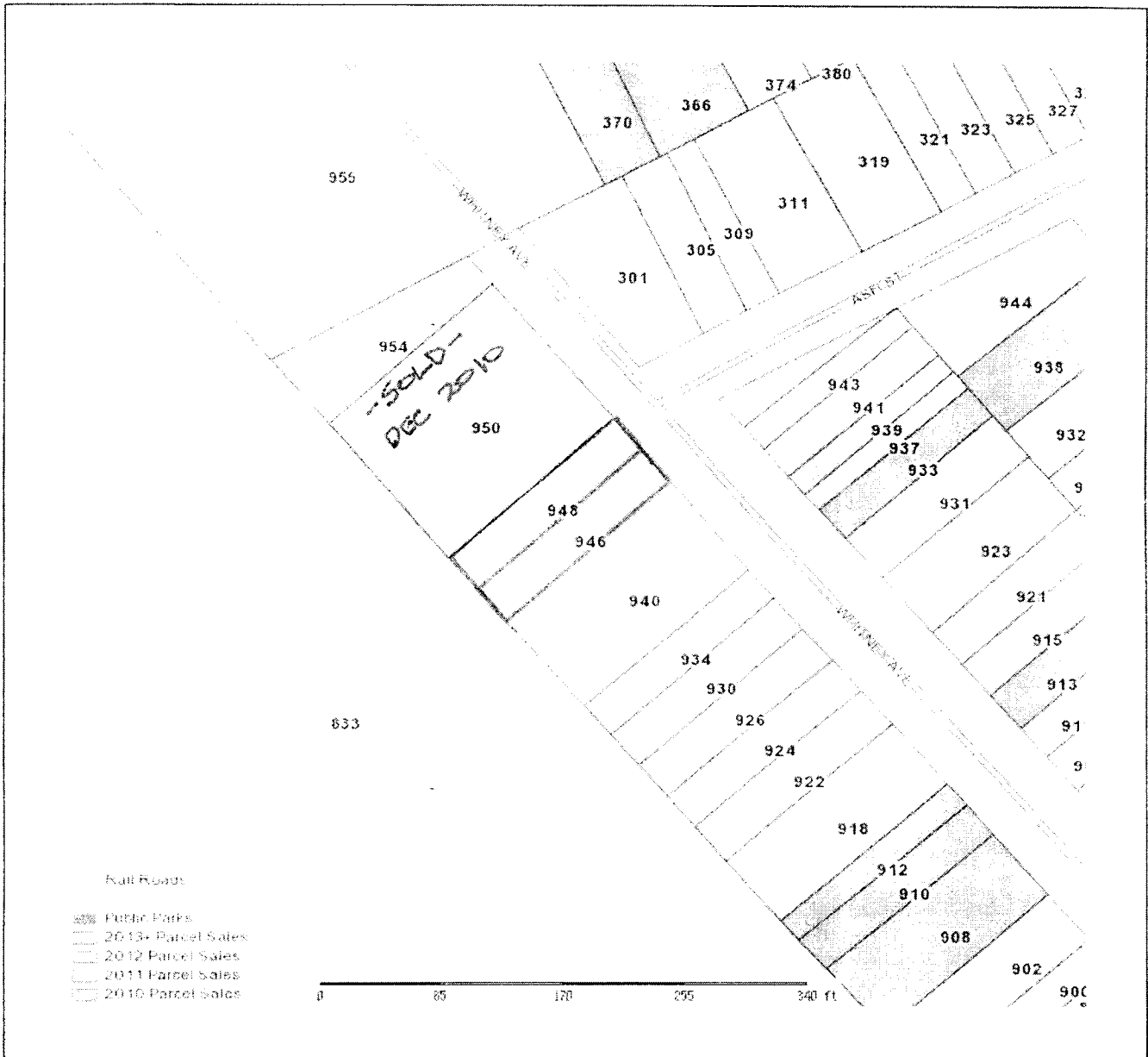

Fayette County Property Valuation Administrator			
Parcel: 38245230 Acres: 0.093 Book: 0194 Page: 238			
LEXINGTON FAYETTE URBAN CO GOVT	Assessed Value		\$ 2,200
946 WHITNEY AVE	Assessed Value		0
0 on 1919-06-28 Reason=U Qual=05	Assessed Value		0
200 E MAIN ST	Assessed Value		0
LEXINGTON, KY 40507	Assessed Value		

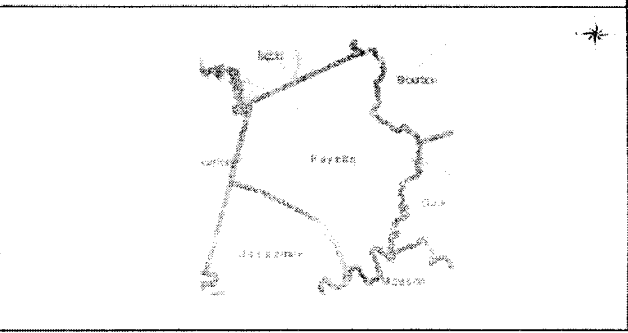

The Fayette County Property Valuation Administrator's Office makes every effort to produce the most accurate information possible. No warranties, expressed or implied are provided for the data herein, its use or interpretation. The assessment information is from the last certified taxroll. All data is subject to change before the next certified taxroll. PLEASE NOTE THAT THE PROPERTY APPRAISER MAPS ARE FOR ASSESSMENT PURPOSES ONLY NEITHER FAYETTE COUNTY NOR ITS EMPLOYEES ASSUME RESPONSIBILITY FOR ERRORS OR OMISSIONS ---THIS IS NOT A SURVEY---

Date printed: 05/15/13 11:48:55