

NOT FOR CONSTRUCTION

COUNTY OF	ITEM NO.	SHEET NO.
FAYETTE	07-9012.50	6

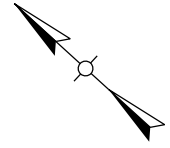

400+00

405+00

LAKESIDE GOLF COURSE
SIGN BETWEEN TWO
STONE COLUMNS

LEXINGTON RESERVOIR NUMBER 4

EXIST. R/W

MATCHLINE STA. 399+00

MATCHLINE STA. 408+00

KY 418

EXIST. R/W

LEXINGTON RESERVOIR NUMBER 4

RT. STA. 399+00 TO STA. 407+08
REMOVE 808 LF EXISTING GUARDRAIL

RT. STA. 399+00 TO STA. 407+10 CONST. 797 LF STEEL "W" BEAM
GUARDRAIL SINGLE FACE WITH I-GUARDRAIL END TREATMENT TYPE 2A

SCALE: 1" = 100'

KY 418
PLAN SHEET
STA. 399+00 TO STA. 408+00

FILE NAME: C:\PWORKING\EAST01\DI64109A\PLAN_06.DGN

USER: AWESTCOT
DATE PLOTTED: July 13, 2021

MicroStation v8.11.7.443

NOT FOR CONSTRUCTION

COUNTY OF	ITEM NO.	SHEET NO.
FAYETTE	07-9012.50	7

STA. 409+70 TO STA. 413+75
CONST. 248 SQYD OF
STANDARD BARRIER MEDIAN TY 2

LT. STA. 413+75 TO STA. 414+50 CONST.
76 LF STANDARD HEADER CURB

LT. STA. 408+00 TO STA. 417+00
CONSTRUCT 24 S.Y. OF SHARED USE PATH

STA. 413+75 TO STA. 417+00 CONST.
326 LF STANDARD HEADER CURB

410+00

415+00

BEGIN CONSTRUCTION
STA. 408+92

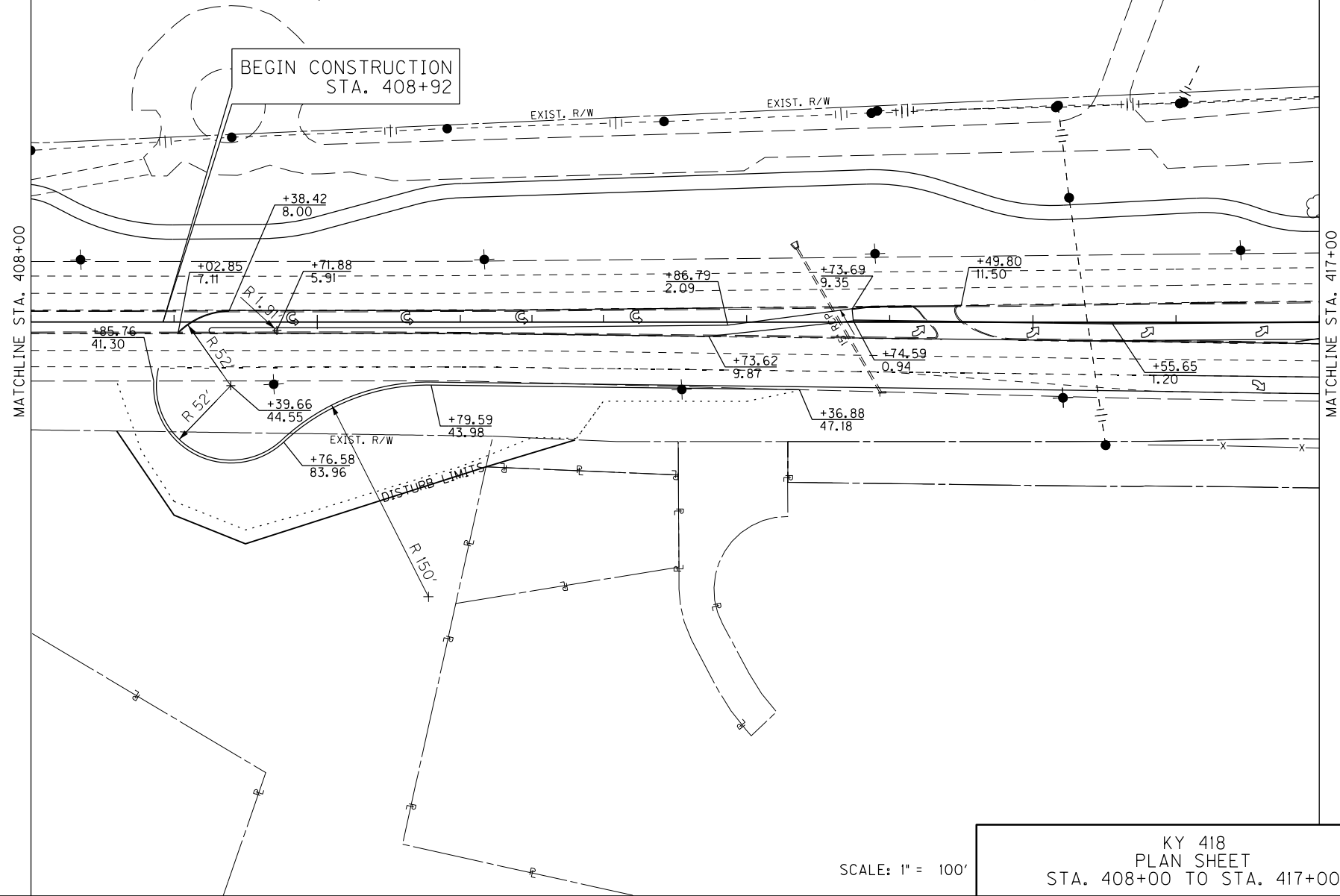
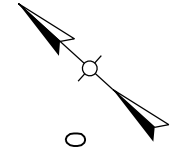

FILE NAME: C:\PWORKING\EASTON\DI64109A\PLAN_07.DGN

USER: AUECKER
DATE PLOTTED: July 13, 2021

MicroStation v8.11.9.919

SCALE: 1" = 100'

KY 418
PLAN SHEET
STA. 408+00 TO STA. 417+00

LT. STA. 417+00 TO LT. STA. 418+89 CONST.
262 LF STANDARD HEADER CURB

LT. STA. 419+53 TO STA. 426+00
REMOVE 647 LF EXISTING GUARDRAIL

LT. STA. 419+69 TO STA. 426+00
CONSTRUCT 24 S.Y. OF SHARED USE PATH

COUNTY OF	ITEM NO.	SHEET NO.
FAYETTE	07-9012.50	8

NOT FOR CONSTRUCTION

RT. STA. 27+67 TO STA. 29+30 JACOBSON PARK ENTRANCE
CONSTRUCT 109 S.Y. OF CONCRETE SIDEWALK

RT. STA. 29+27 JACOBSON PARK ENTRANCE
CONSTRUCT RAMP TYPE 1
WITH 11 S.F. OF DETECTABLE WARNINGS

LT. STA. 419+72 CONSTRUCT RAMP TYPE 4
WITH 22 S.F. OF DETECTABLE WARNINGS

STA. 27+87 TO LT. STA. 29+14 JACOBSON PARK ENTRANCE CONST.
273 LF STANDARD CURB AND GUTTER

LT. STA. 422+72 TO STA. 426+00 CONST. 345 LF STEEL "W" BEAM
GUARDRAIL SINGLE FACE WITH I-GUARDRAIL END TREATMENT TYPE 2A

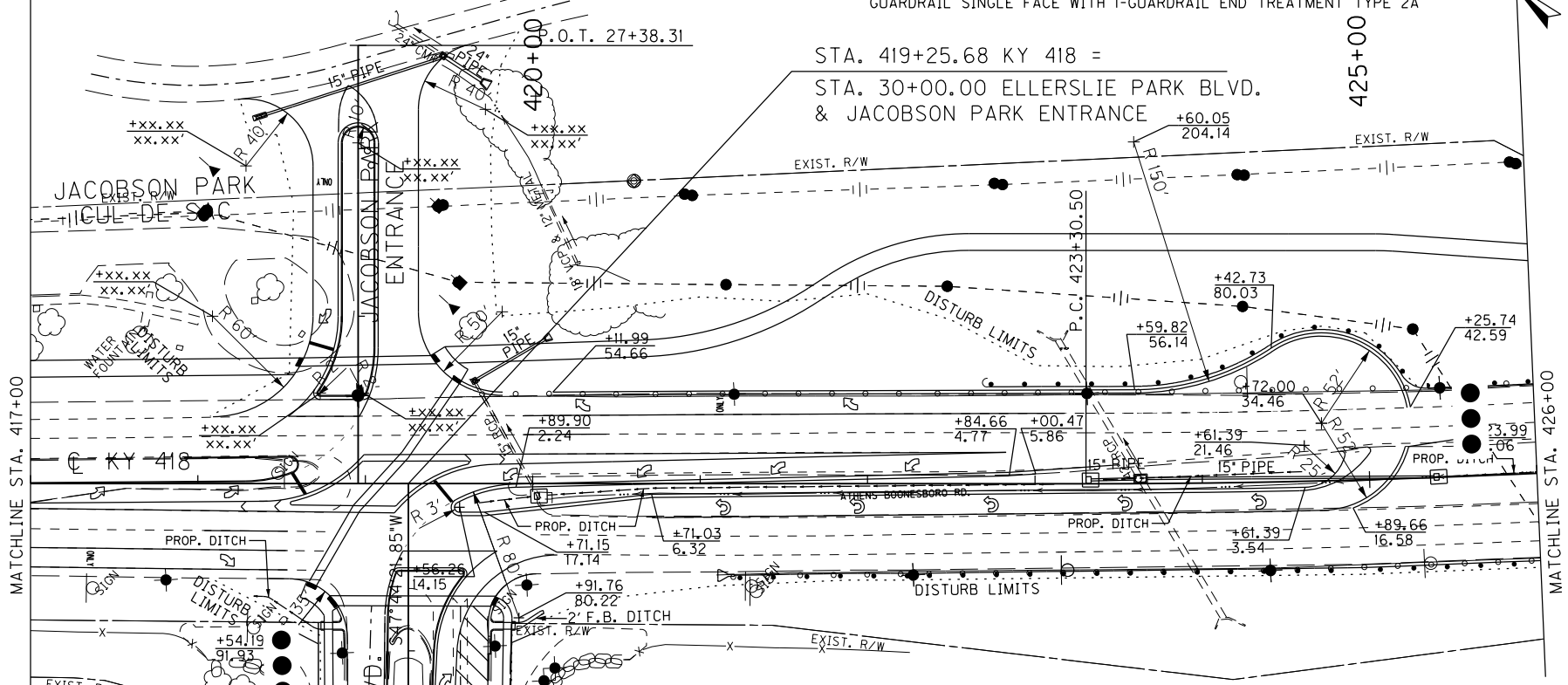

STA. 419+25.68 KY 418 =
STA. 30+00.00 ELLERSLIE PARK BLVD.
& JACOBSON PARK ENTRANCE

LT STA. 30+85 ELLERSLIE BLVD.
CONSTRUCT 1-SIDEWALK FLUME INLET
RT. STA. 30+68 TO STA. 31+65 ELLERSLIE BLVD.
CONSTRUCT 73 S.Y. OF CONCRETE SIDEWALK
LT. STA. 30+70 ELLERSLIE BLVD. CONSTRUCT
RAMP TYPE 1 WITH 11 S.F. OF DETECTABLE
WARNINGS

RT. STA. 30+61 ELLERSLIE BLVD. CONSTRUCT
RAMP TYPE 4 WITH 26 S.F. OF DETECTABLE WARNINGS
LT. STA. 30+68 TO STA. 31+25 ELLERSLIE BLVD.
CONSTRUCT 33 S.Y. OF CONCRETE SIDEWALK

STA. 418+84 TO STA. 419+62
CONST. 81 SOYD OF
STANDARD BARRIER MEDIAN TY 4
RT. STA. 421+10 TO STA. 426+00
REMOVE 490 LF EXISTING GUARDRAIL
RT. STA. 421+10 TO STA. 426+00 CONST. 490 LF STEEL "W" BEAM
GUARDRAIL SINGLE FACE WITH I-GUARDRAIL END TREATMENT TYPE 1

DITCH CONSTRUCTION NOTES								
STATION RANGE	TYPE	BOTTOM WIDTH (FT.)	CHANNEL LINING			BLANKET		
			CLASS	D (FT.)	T (FT.)	ONT (TONS)	TYPE	D (FT.)
418+33 TO 418+74 RT	V	0				ECB	1.0	41
419+90 TO 420+07 RT	FB	2				ECB	1.0	18
419+68 TO 419+99	V	0				ECB	1.0	38
420+09 TO 423+12	V	0				ECB	1.0	271
423+38 TO 424+60	V	0				ECB	1.0	109
425+46 TO 426+00	V	0				ECB	1.0	48

FILE NAME: G:\PWORKING\EASTON\1641094\PLAN_08.DGN
 USER: AMESTCOT
 DATE PLOTTED: July 13, 2021
 MicroStation v8.11.9.919

KY 418
 PLAN SHEET
 STA. 417+00 TO STA. 426+00

SCALE: 1" = 100'

NOT FOR CONSTRUCTION

COUNTY OF	ITEM NO.	SHEET NO.
FAYETTE	07-9012.50	9

DITCH CONSTRUCTION NOTES									
STATION RANGE	TYPE	BOTTOM WIDTH (FT.)	MATERIAL						
			CHANNEL LINING			BLANKET			
			CLASS	D (FT.)	T (FT.)	ONT (TONS)	TYPE	D (FT.)	ONT (S.Y.)
426+00 TO 2+41	V	0					ECB	2.0	557
168+12 TO 168+55	V	0					ECB	2.0	39
3+44 TO 5+00	V	0					ECB	2.0	140

LT. STA. 426+00 TO STA. 429+10
REMOVE 310 LF EXISTING GUARDRAIL

LT. STA. 426+00 TO STA. 429+10 CONST. 272 LF STEEL "W" BEAM GUARDRAIL SINGLE FACE WITH I-GUARDRAIL END TREATMENT TYPE 4A

STA. 427+67 TO STA. 2+89
REMOVE 841 OF SOYD PAVEMENT

LT STA. 429+81 TO STA. 2+89
SAWCUT 371 LF OF PAVEMENT

LT. STA. 426+00 TO STA. 430+35
CONSTRUCT 574 S.Y. OF SHARED USE PATH

LT. STA. 0+32 TO STA. 5+00
CONSTRUCT 574 S.Y. OF SHARED USE PATH

430+00

JACOBSON PARK

MATCHLINE STA. 426+00

MATCHLINE STA. 5+00

FILE NAME: C:\PWORKING\EASTON\1641094\PLAN_09.DGN

USER: AWESTCOT
DATE PLOTTED: July 13, 2021

MicroStation v8.11.9.919

RT. STA. 426+00 TO STA. 201+74 OLD RICHMOND RD.
REMOVE 521 LF EXISTING GUARDRAIL

RT. STA. 426+00 TO STA. 427+85 CONST. 185 LF STEEL "W" BEAM GUARDRAIL SINGLE FACE WITH I-GUARDRAIL END TREATMENT TYPE 2A

KY 418 STA. 428+05 RT. TO
OLD RICHMOND RD. STA. 202+47 RT.
REMOVE 1115 SOYD OF PAVEMENT

RT STA. 427+68 TO STA. 0+40
SAWCUT 337 LF OF PAVEMENT

RT. STA. 428+03 TO STA. 202+46 OLD RICHMOND RD.
SAWCUT 485 LF OF PAVEMENT

EONBK 430+63.68
EONAH 0+00.00

SCALE: 1" = 400'

KY 418
PLAN SHEET
STA. 426+00 TO STA. 5+00

