

PARTIAL RELEASE OF SANITARY SEWER EASEMENT

This Partial Release ("Release") is executed this the ____ day of _____, 2012, by the Lexington-Fayette Urban County Government, Division of Sanitary Sewers, having an address of 200 East Main Street, Lexington, KY 40507 ("LFUCG") in favor of Patchen Wilkes Realty, LLC, a Kentucky limited liability company, having an address of 1811 Winchester Road, Lexington, KY 40509 ("Owner").

WHEREAS, pursuant to the Final Record Plat of the Patchen-Wilkes Subdivision, Unit 1-C (the "Plat"), recorded in the Fayette County Clerk's Office at Plat Cabinet M, Slide 639, Owner did dedicate an off-site sanitary sewer easement to the LFUCG (the "Easement"), which Easement is located immediately south of Patches Wilkes Drive; and

WHEREAS, the Owner has been required to relocate a portion of said Easement, the location of which relocated portion is depicted on Exhibit "A" attached hereto; and

WHEREAS, Owner and LFUCG desire to release that portion of the Easement as is shown by crosshatching on Exhibit "A" attached hereto and said released portion is more fully described on Exhibit "B" attached hereto (the "Released Portion"); and

WHEREAS, the Owner intends to record an "Easement Minor Amended Subdivision Plat for Patchen-Wilkes Subdivision, Unit 1-D," in order to reflect the location of the Released Portion and relocated portion of the Easement.

WHEREFORE, for good and valuable consideration, including Owner's agreement to relocate a portion of the Easement and dedicate said relocated portion to the LFUCG, the sufficiency of which consideration is hereby acknowledged, LFUCG does hereby release from the Easement and

terminate that portion of the Easement as is depicted on Exhibit "A" attached hereto and as is described on Exhibit "B" attached hereto, said Exhibits being incorporated herein by reference.

No other easements set forth or depicted on the Plat are affected by this Release.

IN WITNESS WHEREOF, LFUCG has executed this Release on the year and date first above stated.

Lexington-Fayette Urban County Government

By: _____

Its: _____

COMMONWEALTH OF KENTUCKY

COUNTY OF FAYETTE

The foregoing was acknowledged before me by _____ as _____ of the Lexington-Fayette Urban County Government, for and on behalf of the Lexington-Fayette Urban County Government, on this ____ day of _____, 2012.

My commission expires: _____.

Notary Public

Prepared by:



John R. Rhorer, Jr.
Dinsmore & Shohl LLP
250 West Main Street, Suite 1400
Lexington, KY 40507
Telephone: (859) 425-1000



4

FARM ACCESS

PROPOSED HOUSE

S59°51'31"E
15.70'

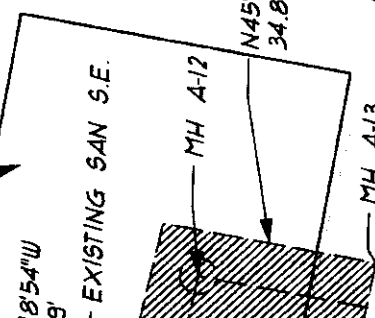

S47°18'54"W
83.09'

S45°17'34"E
20.20'

N45°17'34"W
34.86'

PROPOSED SAN. S.E.

N47°18'54"E
64.13'

POINT OF BEGINNING

PROPOSED SANITARY SEWER RELOCATION

N45°58'32"E
500'

PATCHEN WILKES DRIVE

POINT OF COMMENCEMENT

67a

EXHIBIT A
PATCHEN WILKES
SANITARY SEWER
EASEMENT RELEASE
JULY, 2012
SCALE: 1"=30'

Sa Partners, PLLC



CIVIL ENGINEERS • LAND SURVEYORS • LANDSCAPE ARCHITECTS
311 8TH STREET
LEXINGTON, KENTUCKY 40513
PHONE (606) 796-3449
FACSIMILE (606) 796-3461



CIVIL ENGINEERS • LAND SURVEYORS • LANDSCAPE ARCHITECTS
3111 WALL STREET
LEXINGTON, KENTUCKY 40513

October 18, 2012

Exhibit B
Sanitary Sewer Easement Release
Patchen Wilkes
Lexington, Fayette County, Kentucky

COMMENCING at a point in the southeastern corner of Lot 67a, as shown on the Final Record Plat of Patchen Wilkes, Unit 1-C and recorded in Plat Cabinet "M", Slide 639 in the Fayette County Clerks Office, said point also lying in the northern right-of-way of Patchen Wilkes Drive; thence along a line bearing South 19 degrees 8 minutes 25 seconds East, 93.95 feet, to point on an existing sanitary sewer easement, to the **TRUE POINT OF BEGINNING**; thence along existing sanitary sewer easement to be released South 45 degrees 17 minutes 34 seconds East, 20.20 feet; thence North 47 degrees 18 minutes 54 seconds East, 64.13 feet; thence South 59 degrees 51 minutes 37 seconds East, 15.70 feet; thence South 47 degrees 18 seconds 54 seconds West, 83.09 feet; thence North 45 degrees 17 minutes 34 seconds West, 34.86 feet; thence 45 degrees 58 minutes 32 seconds East, 15.00 feet to **THE POINT OF BEGINNING** and containing 3,426 square feet.