



Lexington-Fayette Urban County Government
DEPARTMENT OF GENERAL SERVICES

TRANSMITTAL

Date: October 29, 2015

Contract Number: 227-2014

Purchase Order Number: LF00120278

Bid Package Number: 99-2014

Capital Project Number: TBD

Work Order Number: N/A

Building: Senior Citizen Center

Project Description: Replacement Senior Citizen Center Construction

To: Josh Marrillia, Marrillia Design & Construction RE: Change Order #25

CC: Harding Dowell, EOP Architects
Martha Allen, Council Clerk
Trina Brown, Social Services (2604-606101-6001-90511 SR_CITIZEN_2015)

From: Joyce Thomas, General Services *JT*

We Are Sending You:

- | | |
|--|--|
| <input type="checkbox"/> Contract | <input type="checkbox"/> Operation and Maintenance Manuals |
| <input type="checkbox"/> Warranties | <input checked="" type="checkbox"/> Change Order |
| <input type="checkbox"/> Payment Application | <input type="checkbox"/> Plans |

Item	Copies	Description	Pages	Date
1.	1	Change Order #25 fully executed per R #602-2014	20	10/29/2015

THESE ARE TRANSMITTED AS INDICATED BELOW:

- | | |
|--|--|
| <input type="checkbox"/> FOR APPROVAL | <input type="checkbox"/> FOR ACTION |
| <input type="checkbox"/> FOR YOUR USE | <input checked="" type="checkbox"/> FOR FILE |
| <input type="checkbox"/> FOR YOUR REVIEW AND COMMENT | <input type="checkbox"/> FOR SIGNATURE |
| <input type="checkbox"/> OTHER: | |

REPLY BY _____ TO AVOID DELAY IN CONSTRUCTION

Remarks:

LEXINGTON-FAYETTE URBAN COUNTY GOVERNMENT CONTRACT CHANGE ORDER Page 1 of 2		Date:	October 28, 2015
		Project:	Senior Citizen Center Constructio
		Location:	Lexington
To (Contractor): Marrillia Design & Construction 259 West Short Street Suite 325 Lexington, KY 40507	Contract No.	227-2014	
	Original Contract Amt.	\$8,882,900.00	
	Cumulative Amount of Previous Change Orders	\$1,293,446.24	
	Percent Change - Previous Change Orders	14.56%	
	Total Contract Amount Prior to this Change Order	\$10,176,346.24	
	Change Order No.	25	
	You are hereby requested to comply with the following changes from the contract plans and specification;		
Current Change Order			
Item No.	Description of changes-quantities, unit prices, change in completion date, etc.	Decrease in contract price	Increase in contract price
1	Add framing & drywall to complete shaft enclosure per PR #36 (2 working days)		\$2,235.00
2	Relocate 1 roof drain & add one roof drain per PR #37		\$2,786.00
3	Extend framing & drywall to deck & add acoustic insulation @ Mechanical Room per PR #39 (1 working day)		\$2,364.00
	Total decrease	\$0.00	
	Total increase		\$7,385.00
	Net Amount of this Change Order	\$7,385.00	
	New Contract Amount Including this Change Order	\$10,183,731.24	
	Percent Change - This Change Order		0.08%
	Percent Change - All Change Orders		14.64%
The time provided for the completion in the contract and all provisions of the contract will apply hereto.			
Recommended by	<i>Joyce Thomas</i>	(Project Manager)	Date 10/28/15
Accepted by	<i>Jack Marrillia</i>	(Contractor)	Date 10/29/15
Approved by	<i>[Signature]</i>	(Director)	Date 10-29-15
Approved by	<i>[Signature]</i>	(Commissioner)	Date 10/29/15
Approved by	<i>Billy Hunt</i>	(Mayor or CAO)	Date 10/29/15

JUSTIFICATION FOR CHANGE

PROJECT: Senior Citizen Center Construction

CONTRACT NO. 227-2014

CHANGE ORDER NO. 25

1. Necessity for change: Enclosure of rated shaft is needed to comply with code and was missed in design. One of the Roof Top Units (RTU) is placed directly in front of one roof drain. Relocating this drain plus adding another will help to prevent standing water on the flat roof at this location. Extending walls to deck will reduce sound transfer from Mechanical room.
2. Is proposed change an alternate bid? ___ Yes X No
3. Will proposed change alter the physical size of the project? ___ Yes X No
If "Yes", explain. This change order expands the current limits of construction.
4. Effect of this change on other prime contractors: N/A
5. Has consent of surety been obtained? ___ Yes X Not Necessary
6. Will this change affect expiration or extent of insurance coverage? ___ Yes X No
If "Yes", will the policies be extended? ___ Yes ___ No
7. Effect on operation and maintenance costs: Roof will drain more efficiently at the Roof Top Units with this change.
8. Effect on contract completion date: 3 working days

Salv Hantk
Mayor

10/29/15
Date

Martilla

Alternates
LFUGG Replacement Senior Citizen Center
Lexington, KY

10/24/2014
4:17 PM

Pending Owner Approval

Additional Framing and Drywall for the Additional Horizontal 1-hr Rated Partition to Complete the Rated Shaft Enclosure per Proposal Request No. 36

Additional Framing and Drywall for the Additional Horizontal 1-hr Rated Partition to Complete the Rated Shaft Enclosure per Proposal Request No. 36

Martilla Out-of-Pocket Expenses for Additional General Conditions

Quantity	Units	Hr.	Rate	Labor	Materials	Subcontractor	Other
1	Is			1,218.00		1,024	
2	day			448.20		896	
				0		0	
						1,914	

Cost of In-Place Construction (Labor, Materials and Equipment) 1,914

Martilla Design and Construction Overhead Percentage 16.75

Overhead - Martilla Design and Construction 319.33

Martilla Design and Construction Profit Percentage 4.00%

Profit - Martilla Design and Construction 127.73

General Liability Insurance (Construction) 7

Builder's Risk Insurance 7

Performance and Payment Bond (Rate of \$9.40 per \$1000 of Cost for \$1,924,000) 17.72

Performance and Payment Bond (Rate of \$8.15 per \$1000 of Cost for \$2,500,000) 204.33

Performance and Payment Bond (Rate of \$7.20 per \$1000 of Cost for \$1,600,000) and 115.20

KY Surcharge on Project Bonds (1.8% of Bond Costs) 29.86

Local Municipality Tax on Project Bonds (0% of Bond Costs) 0

Total Construction Cost 2,735



Proposal Request Transmittal

10/8/2015 10:51 AM

EOP Architects | 201 W. Street St. Suite 200 | Englewood, CO 80110 | 303.733.0700

PROJECT	LFUCG Senior Citizens' Center 201333	DATE SENT	10/8/2015
SCOPE	Mechanical Chase Enclosure	PROPOSAL REQUEST #	PR-036
TITLE	Proposal Request	PROPOSAL ID	00669
PURPOSE	For Review and Response	TYPE	Info Exchange

FROM

NAME	COMPANY	EMAIL	PHONE
Harding Dowell	EOP Architects	hdowell@eopa.com	(859) 231-7538

TO

NAME	COMPANY	EMAIL	PHONE
Travis Harris	Marrillia Design and Construction	tharris@marrillia.com	

COMMENTS

Created by: Harding Dowell

Description:

Travis,

Please see the attached sketches for the addition of a horizontal 1-hr rated partition to complete the rated shaft enclosure.

Best,

Harding

Proposal Request Transmittal

DATE 10/8/2015
10 00669

DESCRIPTION OF CONTENT

QTY	DATED	TITLE	NUMBER	SCALE	SIZE	NOTES
1	10/8/2015	151008_PR-036_SKA-086.pdf				
1	10/8/2015	151008_PR-036_SKA-087.pdf				

COMPS

Brian Gravitt	(Marrillia Design and Construction)
Jim Martin	(Marrillia Design and Construction)
Josh Marrillia	(Marrillia Design and Construction)
Jessica Walker	(LFUCG)
Joyce Thomas	(LFUCG)
Martin Woodford	(LFUCG)

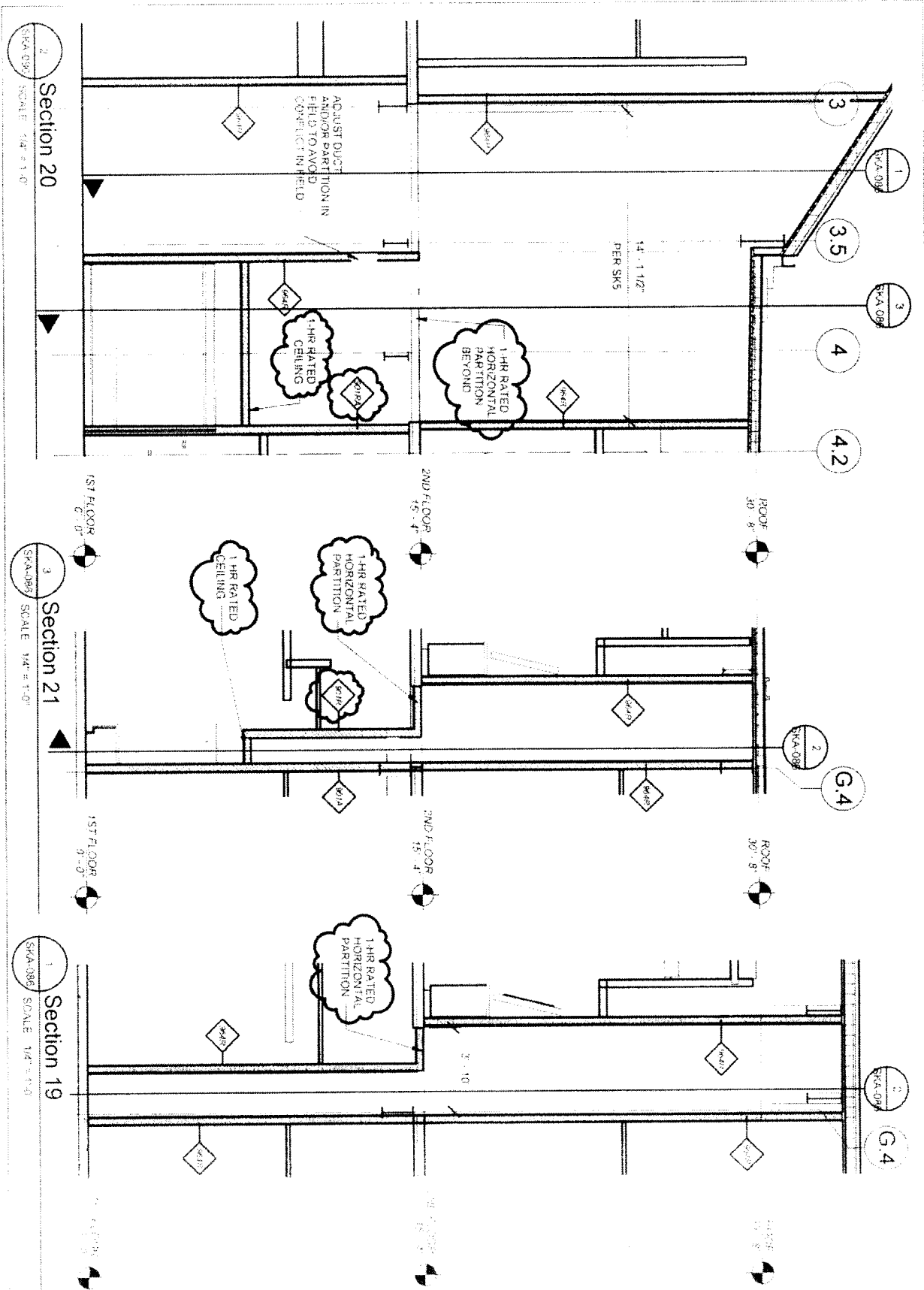

2 Section 20
SKA-086 SCALE 1/4" = 1'-0"

3 Section 21
SKA-086 SCALE 1/4" = 1'-0"

1 Section 19
SKA-086 SCALE 1/4" = 1'-0"



LEXINGTON SENIOR CENTER

PR-036

185 LIFE LANE LEXINGTON, KY 40503

SKA-086

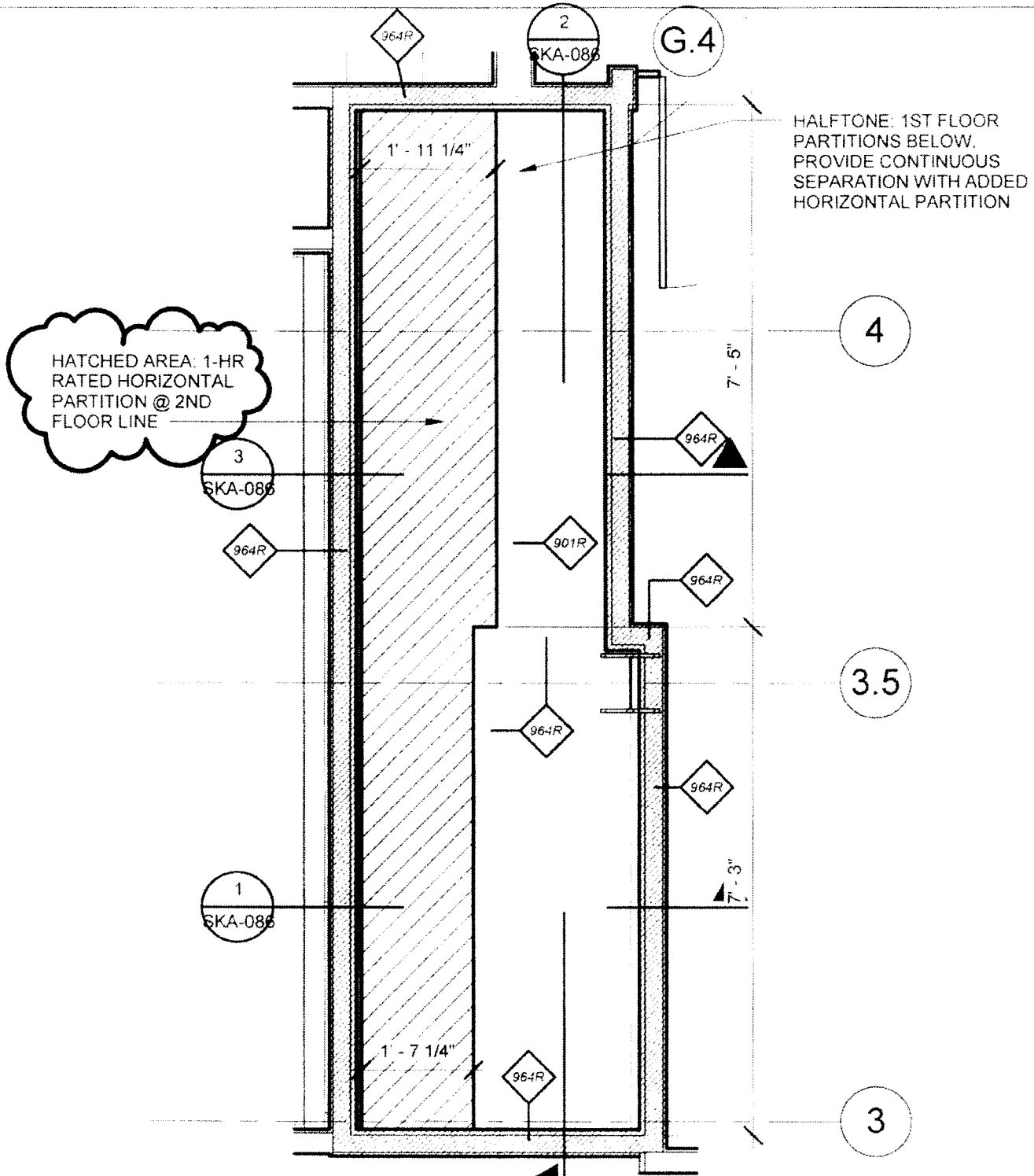

HATCHED AREA: 1-HR RATED HORIZONTAL PARTITION @ 2ND FLOOR LINE

HALFTONE: 1ST FLOOR PARTITIONS BELOW. PROVIDE CONTINUOUS SEPARATION WITH ADDED HORIZONTAL PARTITION

1 Callout (4) of SECOND FLOOR PLAN - AREA B
 SKA-087 SCALE: 1/2" = 1'-0"



LEXINGTON SENIOR CENTER
 195 LIFE LANE
 LEXINGTON, KY 40502

PR-036

Proj. No.	201333	Date	10/09/15
Drawn by	Author	Checked by	Checker

SKA-087

1/2" = 1'-0"



Bennett's Carpets, Inc.
 149 Steve Drive
 Russell Springs, KY 42642
 (270) 866-6930
 Fax (270) 866-6200

QUOTATION • PROPOSAL

TO:	Marrilla Construction	DATE:	02/08/13
ATT:	Travis		
RE:	Lexington Senior Citizens PR 36		

Description of Work: We hereby submit this estimate for furnishing and installing the following in accordance with plans and specifications including insurance:

Material \$425.00

Labor \$600.00

Total Quotation \$1,025.00

Note: This quotation will become void if not accepted within 30 days.

We include no demolition unless stipulated. _____
 Reggie Roy

Acceptance: _____ Date: ____/____/____

Company Title: _____

This Quotation Proposal is to become a part of the contract documents. Payment to be made within 30 days from billing date with retainage held only as a part of original documents and previous to agreed. Payment in full within 30 days upon completion and acceptance of this project.

Joyce Thomas

From: Harding Dowell <hdowell@eopa.com>
Sent: Monday, October 12, 2015 1:33 PM
To: Joyce Thomas
Subject: RE: Proposal Request Sent and Closed: Mechanical Chase Enclosure - LFUCG Senior Citizens' Center - ProposalRequest:PR-036:zL0JA

Hi Joyce,

During design, we provided a mechanical chase for HVAC ductwork to move between floors. The size of the chase was different on each floor. When we created the openings in the slab, we used the larger, 2nd floor chase to determine the opening. This decision left some 1st floor chase walls without a top enclosure. The solution proposed is to build a horizontal partition (essentially, a ceiling with GWB on both sides at the floor line) to provide that top enclosure and retain a continuous 1-hour rated enclosure for the chase.

Best,

Harding

J Harding Dowell, AIA
Project Manager



EOP Architects

LEXINGTON • LOUISVILLE

t: 859-231-7538 | m: 859-297-5515

for more information, visit the.new.EOPA.COM



From: Joyce Thomas [mailto:jthomas@lexingtonky.gov]
Sent: Monday, October 12, 2015 1:06 PM
To: Harding Dowell <hdowell@eopa.com>
Subject: RE: Proposal Request Sent and Closed: Mechanical Chase Enclosure - LFUCG Senior Citizens' Center - ProposalRequest:PR-036:zL0JA

Harding,

is this section of partition was missed in design or something else?

Joyce

From: Harding Dowell [mailto:hdowell@eopa.com]
Sent: Thursday, October 08, 2015 4:43 PM
To: Joyce Thomas
Subject: Proposal Request Sent and Closed: Mechanical Chase Enclosure - LFUCG Senior Citizens' Center - ProposalRequest:PR-036:zL0JA



Alternates
 LFUGG Replacement Senior Citizen Center
 Lexington, KY

11/10/2011
 10:41 AM

Pending Owner Approval

PR-48 Relocate (1) Roof Drain and Add (1) Roof Drain per Proposal Request No. 37

Relocate (1) Roof Drain and Add (1) Roof Drain per Proposal Request No. 37

Relocate (1) Roof Drain and Add (1) Roof Drain - TECO Mechanical

Marrilia Budget to Patch Roof Decking

Quantity	Units	Hr.	Rate	Labor	Sub	Materials	Subcontractor	Total
	1	fs		2197.00			1.40	
	1	fs		209.00			209	
				0			2397	2397

Cost of In-Place Construction (Labor + Materials + Equipment)	2397
Marrilia Design and Construction Overhead Percentage	414
Overhead - Marrilia Design and Construction	414
Marrilia Design and Construction Profit Percentage	719
Profit - Marrilia Design and Construction	719
General Liability Insurance (Construction)	100
Builder's Risk Insurance	100
Performance and Payment Bond (Rate of \$9.40 per \$1000 of Cost for \$0 - \$2,500,000)	24
Performance and Payment Bond (Rate of \$8.15 per \$1000 of Cost for \$2,500,000 - \$5,000,000)	20
Performance and Payment Bond (Rate of \$7.20 per \$1000 of Cost for \$5,000,000 and up)	17
KY Surcharge on Project Bonds (1.8% of Bond Cost)	3
Local Municipality Tax on Project Bonds (5% of Bond Cost)	1
Total Construction Cost	2789

TECO

MECHANICAL CONTRACTOR, INC.

837 FLOYD DRIVE
LEXINGTON, KY 40505
PHONE (859) 255-6893

P.O. BOX 5043
LEXINGTON, KY 40505
FAX (859) 233-3430

October 16, 2015

Marrillia Design & Construction
259 West Short Street, Suite 325
Lexington, Kentucky 40507
Attn.: Josh Marrillia

Re: **Lexington Senior Center - PR-037 Relocate & Add Roof Drain**

Josh,

We offer the following price to relocate one roof drain, approximately 10 feet from it's current location & provide & install an additional roof drain as requested in PR-037:

Material:

1 - 3" Roof drain w/accessories

20 ft - 3" PVC pipe

2 - 3" PVC couplings

1 - 4" PVC coupling

1 - 4"x 3" PVC reducing tee

2 - 3" PVC 90 degree ells

1 - LOT Hanger material

MATERIAL SUBTOTAL \$ 469.00

6% SALES TAX \$ 28.00

LABOR: 20 HOURS \$ 1,700.00

TOTAL \$ 2,197.00

If you have any questions, or require further assistance, please call.

Scott Hedger

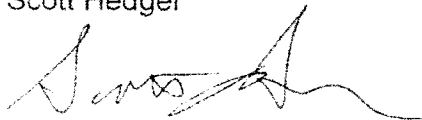

Project Manager



Proposal Request Transmittal

10/15/2015 10:01:00 AM EST 0107015

2100 W. Harris Blvd. Suite 700 Lexington, KY 40502 United States

PROJECT	LFUCG Senior Citizens' Center 201333	DATE SENT	10/15/2015
SUBJECT	Relocate Roof Drain	PROPOSAL REQUEST	PR-037
TYPE	Proposal Request	TRANSMITTAL ID	00684
STATUS	For Review and Response	TYPE	Info Exchange

FROM:

NAME	COMPANY	EMAIL	PHONE
Harding Dowell	EOP Architects	hdowell@eopa.com	(859) 231-7538

TO:	COMPANY	EMAIL	PHONE
Travis Harris	Marrillia Design and Construction	tharris@marrillia.com	

DESCRIPTION:

Created by: Harding Dowell

Description:

Please provide pricing to relocate (1) roof drain and add (1) roof drain per the attached sketch to improve drainage. This proposal was submitted by Nu-Way roofing out of concern for ponding at RTU curbs during heavy rains. Roof drains shall be connected to leaders as indicated in the contract documents.

Thanks,

Harding

Proposal Request Transmittal

DATE: 10/15/2015
ID: 00684

COPIES

Brian Gravitt	(Marrillia Design and Construction)
Jim Martin	(Marrillia Design and Construction)
Josh Marrillia	(Marrillia Design and Construction)
Rob Price	(Marrillia Design and Construction)
Jessica Walker	(LFUCG)
Joyce Thomas	(LFUCG)
Martin Woodford	(LFUCG)
Sam Claxton	(CMTA)

G.2

G.4

6
A4.15

Sim

H

J

5

4.2

4

3.5

3' - 7 1/2"



ADD ROOF DRAIN

1/2" x 12" CRICKETS
PER ASI-052

1' - 7 1/2"



RELOCATE
ROOF DRAIN

1/4" / 12"



DOWNSPOUT &
SPLASH BLOCK

RTU-1

3
A4.15

PR-037

SKA-90

LEXINGTON SENIOR CENTER

195 LIFE LANE
LEXINGTON, KY 40502



1
SKA-90

CA-PARTIAL ROOF PLAN

SCALE: 1/4" = 1'-0"



Alternates
 LFUCG Replacement Senior Citizen Center
 Lexington, KY

10/23/2016
 1:14:17

Pending Owner Approval

PR-50 Extend Framing and Gypsum Board Drywall to the Deck and Add Acoustic Batt Insulation Within the Wall Cavity at the Partitions per Proposal Request No. 39

Extend Framing and Gypsum Board Drywall to the Deck and Add Acoustic Batt Insulation Within the Wall Cavity at the Partitions per Proposal Request No. 39

	Quantity	Units	Hr	Rate	Labor	Mat	Materials	Subcontract	Total
Additional Framing, Gypsum Board Drywall and Acoustic Batt - Bennett's Carpets	1	ls				1,085.00		1,085	
General Trades Acoustical Sealing at Penetrations - Marrilia BUDGET	1	ls			500.00			500	
Marrilia Out-of-Pocket Expenses for Additional General Conditions	1	day			449.25			449	
					0	0		2,034	2,034

Cost of In-Place Construction (Labor, Materials and Equipment) =	2,034
Marrilia Design and Construction Overhead Percentage =	10.0%
Overhead - Marrilia Design and Construction =	203
Marrilia Design and Construction Profit Percentage =	5.0%
Profit - Marrilia Design and Construction =	102
General Liability Insurance (Construction) =	0
Builder's Risk Insurance =	0
Performance and Payment Bond (Rate of \$9.40 per \$1000 of Cost for \$0 - \$2,500,000) =	19
Performance and Payment Bond (Rate of \$8.15 per \$1000 of Cost for \$2,500,000 - \$5,000,000) =	16
Performance and Payment Bond (Rate of \$7.20 per \$1000 of Cost for \$5,000,000 and up) =	14
KY Surcharge on Project Bonds (1.8% of Bond Cost) =	3
Local Municipality Tax on Project Bonds (5% of Bond Cost) =	7
Total Construction Cost =	2,385



Proposal Request Transmittal

10/21/2015 10:11:01 AM

EOP Architects | 201 W. Short St. Suite 700 Lexington KY 40507 United States

PROJECT	LFUCG Senior Citizens' Center 201333	DATE SENT	10/21/2015
PROJECT	Mechanical Room Partition Framing	PROPOSAL REQUEST	PR-039
TYPE	Proposal Request	TRANSMITTAL ID	00701
STATUS	For Review and Response	NOTE	Info Exchange

OWNER

NAME	COMPANY	EMAIL	PHONE
Harding Dowell	EOP Architects	hdowell@eopa.com	(859) 231-7538

DESIGNER

NAME	COMPANY	EMAIL	PHONE
Travis Harris	Marrillia Design and Construction	tharris@marrillia.com	

DETAILS

Created by: Harding Dowell

Description:

Please provide pricing to extend framing and gypsum board drywall to the deck, and to add acoustic batt insulation within the wall cavity, at the partitions shown in the attached sketch. Partition framing depth and module of framing members shall remain as originally designed. Penetrations in partitions shall be acoustically sealed. Please provide the following details for pricing:

- Material cost of additional framing (LF and unit costs above what was originally bid)
- Material cost of insulation (SF and unit costs)
- Material cost of additional gypsum board (SF and unit costs)

Proposal Request Transmittal

DATE 10/21/2015
REV 00701

- Labor for additional framing, insulation, and gypsum board (hours and rate)
- Overhead and profit claimed by the subcontractors

Thanks,

Harding

DESCRIPTION OF CONTENTS

REV	DATED	TITLE	NUMBER	SCALE	SIZE	NOTES
1	10/21/2015	151021_PR-039_SKA-091.pdf				

Copies

Brian Gravitt	(Marrillia Design and Construction)
Jim Martin	(Marrillia Design and Construction)
Josh Marrillia	(Marrillia Design and Construction)
Rob Price	(Marrillia Design and Construction)
Jessica Walker	(LFUCG)
Joyce Thomas	(LFUCG)
Martin Woodford	(LFUCG)

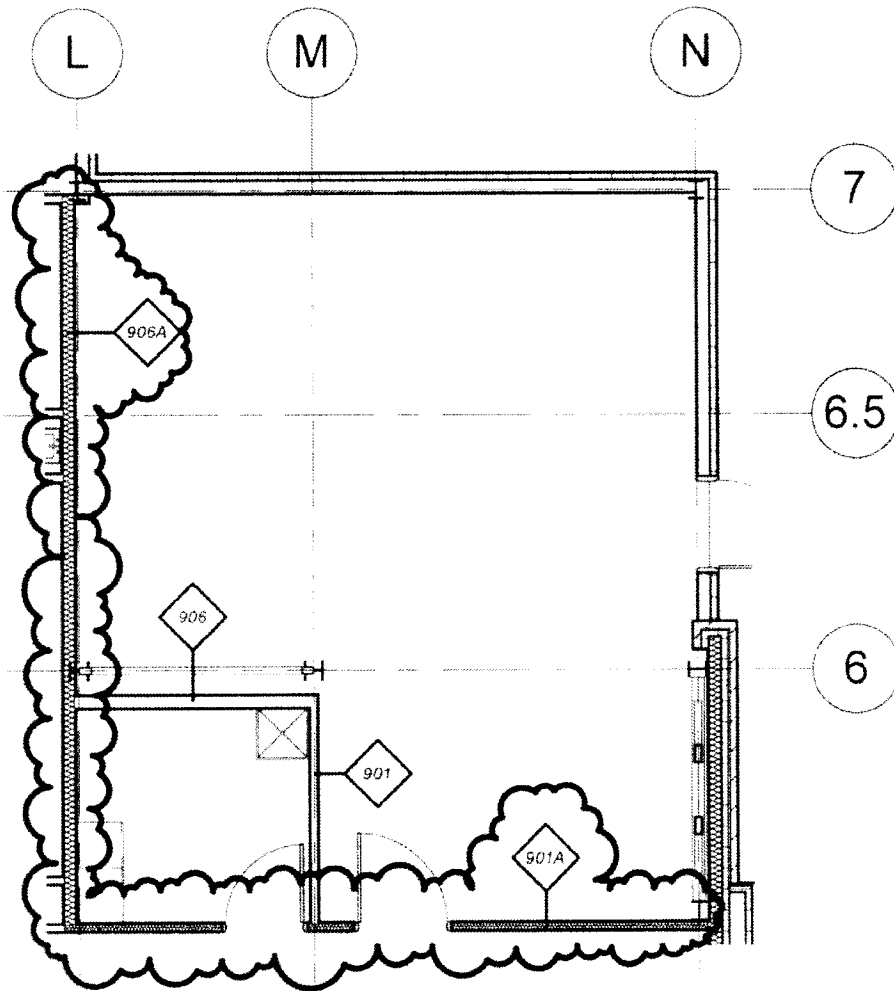

1 CA-FIRST FLOOR PLAN - AREA C
 SKA-091 SCALE: 1/8" = 1'-0"



LEXINGTON SENIOR
 CENTER

195 LIFE LANE
 LEXINGTON, KY 40502

PR-039

REV	DATE	BY	CHK

SKA-091

SCALE: 1/8" = 1'-0"

2021 JUN 11 10:48 AM



Bennett's Carpets, Inc.
 149 Steve Drive
 Russell Springs, KY 42642
 (270) 866-6930
 Fax (270) 866-6200

QUOTATION • PROPOSAL

TO:	Marrilla	DATE:	10-23-15
ATT:	Travis		
RE:	Lexington Senior Citizens PR 039		

Description of Work: We hereby submit this estimate for furnishing and installing the following in accordance with plans and specifications including insurance:

Material \$475.00

Labor \$610.00

Total Quotation \$1,085.00

Note: This quotation will become void if not accepted within 30 days.

We include no demolition unless stipulated.

Reggie Roy

Acceptance: _____ Date: ____/____/____

Company/Title: _____

This Quotation Proposal is to become a part of the contract documents. Payment to be made within 30 days from billing date with retainage held only as a part of original documents and previously agreed. Payment in full within 30 days upon completion and acceptance of this project.

Joyce Thomas

From: Harding Dowell <hdowell@eopa.com>
Sent: Friday, October 23, 2015 3:28 PM
To: Joyce Thomas
Subject: FW: LFUCG Senior Center - Proposal Request No. 39
Attachments: PR-50 per Proposal Request No. 39.pdf

Hi Joyce,

Please find the attached pricing to extend the mechanical room partitions to the deck. The price shifted upward from our last discussion due to an allowance (which may not be entirely used, in which case it would be credited) for acoustical sealing of mechanical and electrical penetrations, a reasonable expectation. I find the time extension, when you consider the additional drywall work, to be appropriate. Please let me know if you have any questions about the proposal.

Thanks,

Harding

J Harding Dowell, AIA
Project Manager



EOP Architects

LEXINGTON • LOUISVILLE
☎ 859-231-7538 | 📠 859-257-5515
[For more information, visit the new EOPA.COM](#)



From: Josh Marrillia [<mailto:jmarrillia@marrillia.com>]
Sent: Friday, October 23, 2015 1:21 PM
To: Harding Dowell <hdowell@eopa.com>
Cc: Jim Martin (jmartin@marrillia.com) (jmartin@marrillia.com) <jmartin@marrillia.com>; 'tharris@marrillia.com' <tharris@marrillia.com>; Brian Gravitt <bgravitt@marrillia.com>
Subject: LFUCG Senior Center - Proposal Request No. 39

Harding,

Please find attached a detailed cost estimate to *Extend Framing and Gypsum Board Drywall to the Deck and Add Acoustic Batt Insulation Within the Wall Cavity at the Partitions per Proposal Request No. 39*. The total cost to complete this work is **\$2,364**. Please send confirmation via e-mail if the Owner would like to proceed with this additional work.

Sincerely,

Josh Marrillia