

| INLET # | DBI CBI | TYPE | LT/RT/MED | STA. | TOP/GRATE THROAT | INVERT |
|---------|---------|------|-----------|--------|------------------|--------|
| 152 | CBI | A | LT | 118+72 | 988.38 | 984.00 |
| 153 | CBI | A | LT | 120+27 | 988.21 | 983.24 |
| 157 | CBI | A | RT | 120+27 | 988.29 | 982.96 |

| LT OR RT | STATION TO STATION | SY |
|----------|-----------------------|----|
| RT | 118+00.00 - 118+67.26 | 37 |
| LT | 118+00.00 - 118+91.98 | 50 |
| RT | 118+91.63 - 119+24.75 | 18 |
| LT | 119+17.95 - 119+46.60 | 15 |
| RT | 119+46.80 - 121+00.16 | 84 |
| LT | 120+07.56 - 121+17.50 | 64 |

| LT OR RT | STATION TO STATION | LF |
|----------|-----------------------|-----|
| RT | 118+00.00 - 118+67.26 | 71 |
| LT | 118+00.00 - 118+91.98 | 95 |
| RT | 118+91.63 - 119+24.75 | 41 |
| LT | 119+17.95 - 119+46.60 | 76 |
| RT | 119+46.80 - 121+06.49 | 175 |
| LT | 120+02.43 - 121+21.22 | 146 |

RT. STA. 118+00 TO 121+23
SAWCUT 323 LF EXISTING PAVEMENT
CONSTRUCT LONGITUDINAL EDGE KEY

LT. STA. 118+00 TO 121+23
SAWCUT 323 LF EXISTING PAVEMENT
CONSTRUCT LONGITUDINAL EDGE KEY

STA. 121+22.70
CONSTRUCT 99 LF EDGE KEY

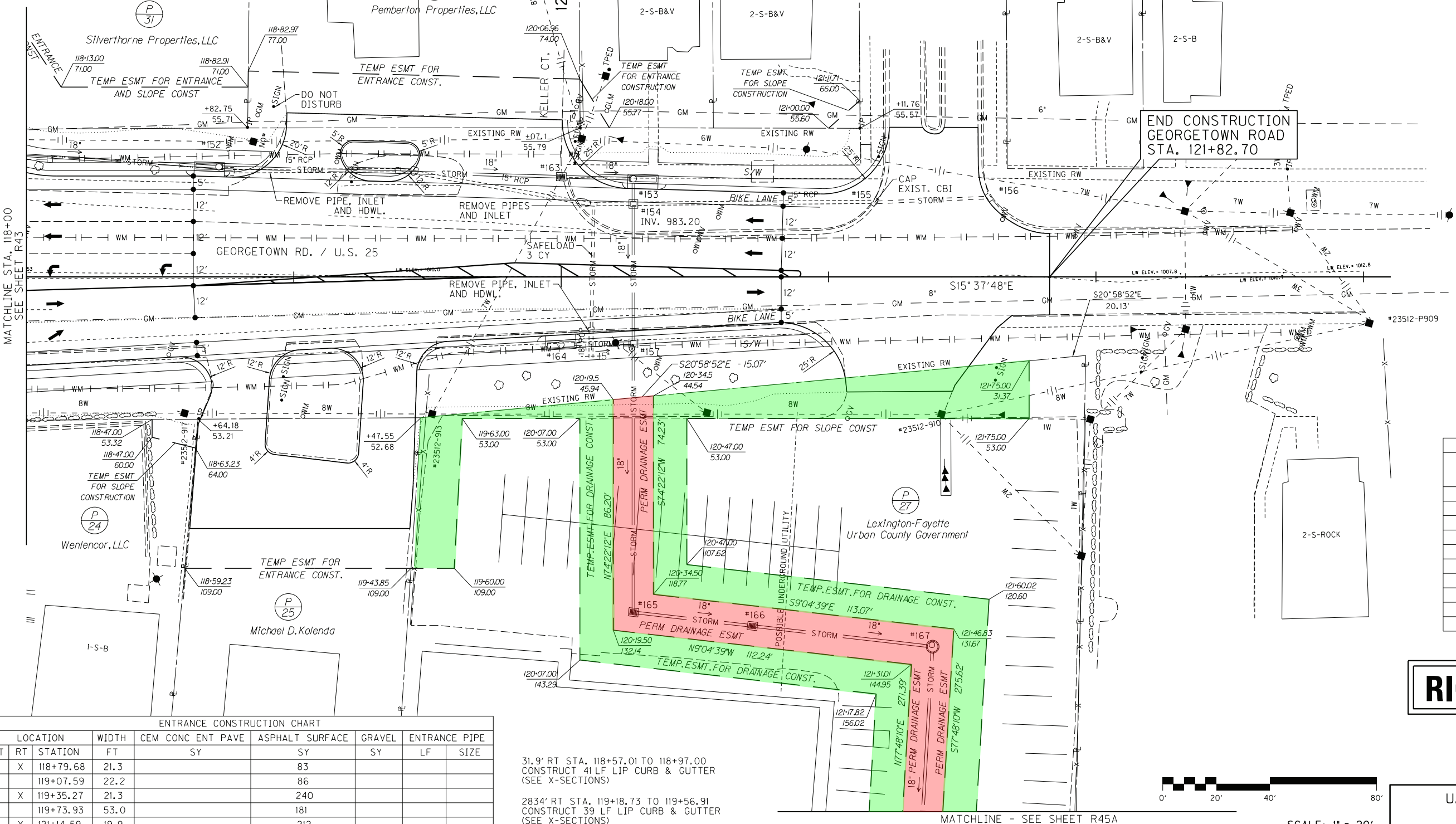

END CONSTRUCTION
GEORGETOWN ROAD
STA. 121+82.70

FILE NAME: V:\1785\ACTIVE\178562020\TRANSPORTATION\DESIGN\ROADWAY PLANS\PLAN_US_25_11800.DGN
 USER: gshnarp
 DATE PLOTTED: January 11, 2016
 E-SHEET NAME:
 MicroStation v8.11.7.443

| LOCATION | WIDTH | CEM CONC ENT PAVE | ASPHALT SURFACE | GRAVEL | ENTRANCE PIPE |
|----------|-----------|-------------------|-----------------|--------|---------------|
| LT RT | STATION | FT | SY | SY | LF SIZE |
| X | 118+79.68 | 21.3 | | 83 | |
| X | 119+07.59 | 22.2 | | 86 | |
| X | 119+35.27 | 21.3 | | 240 | |
| X | 119+73.93 | 53.0 | | 181 | |
| X | 121+14.59 | 19.9 | | 212 | |

31.9' RT STA. 118+57.01 TO 118+97.00
CONSTRUCT 41 LF LIP CURB & GUTTER
(SEE X-SECTIONS)

2834' RT STA. 119+18.73 TO 119+56.91
CONSTRUCT 39 LF LIP CURB & GUTTER
(SEE X-SECTIONS)

| LOCATION | TYPE | WARNING (SF) |
|------------------------|------|--------------|
| 36.7' RT STA. 118+65.9 | 1 | 12 |
| 44.2' LT STA. 118+89.6 | 1 | 15 |
| 35.2' RT STA. 118+92.7 | 1 | 12 |
| 43.4' LT STA. 119+18.7 | 1 | 12 |
| 33.4' RT STA. 119+23.4 | 1 | 12 |
| 32.0' RT STA. 119+47.8 | 1 | 12 |
| 42.9' LT STA. 119+46.6 | 1 | 12 |
| 40.8' LT STA. 120+10.3 | 1 | 16 |
| 23.4' RT STA. 120+97.2 | 1 | 16 |
| 39.7' LT STA. 121+14.4 | 3 | 20 |

RIGHT OF WAY PLANS

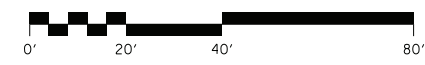

SCALE: 1" = 20'

U.S. 25 - GEORGETOWN ROAD
PLAN SHEET
STA. 118+00 TO P.O.E.