



BUILDING CRAFTS, INC.
Contractors | Engineers

PC # 1

2 Rosewood Drive
Wilder, KY 41076

Phone: (859) 781-9500
Fax: (859) 781-9505

www.buildingcrafts.com

Tuesday, August 04, 2015

Tiffany Rank, PE
Municipal Engineer Senior
859-425-2406
tiffanyr@lfugc.com

Re: Town Branch Solids Processing Project Furnish and install curb in containment area proposal

Tiffany,

Building Crafts is pleased to offer you this proposal to pour a curb around the edge of the exterior walls of the containment area 6"x6" the curb will be doweled. This is to bridge an expansion joint and some deteriorated wall that was discovered during demo. This proposal is good for 7 days and if accepted in that time will not affect schedule. The proposal includes all labor material and equipment to perform the work. The cost would be:

Furnish and install curb in containment area \$1,150.00

Best regards,

Dan Breetz PE
Project Manager
Building Crafts, Inc.

Cc: File, Engineer



BUILDING CRAFTS, INC.
Contractors | Engineers

Proposal Summary

Job#: 0618

Date: 8/4/2015

Job Name: Town Branch WWTP Solids Processing Improvements

Work Description: 15.08.04 curb at containment area Estimate

LABOR			
	Hrs	Rate	Total Cost
Supt.	1	100.00	100.00
Labor	2	47.77	95.54
Welder	0	100.00	-
PM Time	2	150.00	300.00
Carpernter	0	55.00	-
Labor Total			495.54

Equipment			
	Weeks	Rate	Total Cost
		0.00	-
Field Office	1	150.00	150.00
Backhoe	0	450.00	-
Pickup	0	300.00	-
			-
			-
Equipment Total			150.00

Materials			
	Qty	Unit	Total Cost
concrete	1	325.00	325.00
	0	0.00	-
		0.00	-
Materials Total			325.00

Subcontractors		Cost
		-
Subcontractor Total		-

Total of All Cost Categories 970.54

Contractor's Markup 145.58
(15% on L,E & M; 5% on S)

3% Bond 33.98

Total of All Costs with Markup \$ 1,150

PC # 2

RFI009 Pad Removal.xlsx

Building Crafts, Inc.



Contractors & Engineers

**LFUGC Town Branch Solids
Improvements**

R.F.I.

Request for Clarification

To: Mark Stephens	Company: HDR	Phone Number:	Fax Number:
From: Dan Breetz	Company: BCI	Phone Number: 859-781-9500	Fax Number: 859-781-9505
CC:	Company:	Phone Number:	Fax Number:
RFI No: 9	Spec. Section: 0	Drawing No: D-2	Date: 09/11/15
Related Items:			

INFORMATION REQUESTED:

BCI proposes removal of concrete pad shown on attached. We see it as a tripping hazard. Removal will ease future access to centrifuges. BCI proposes to remove slab for \$1,536.00. We would like to remove the slab before we move the centrifuge into place next week. Thank you.

RESPONSE:

BY:	DATE:
------------	--------------

P.O. BOX 286
Highland Heights, Ky 41076

2 Rosewood Drive
Wilder, Ky 41076

Phone # (859) 781-9500
Fax # (859) 781-9505

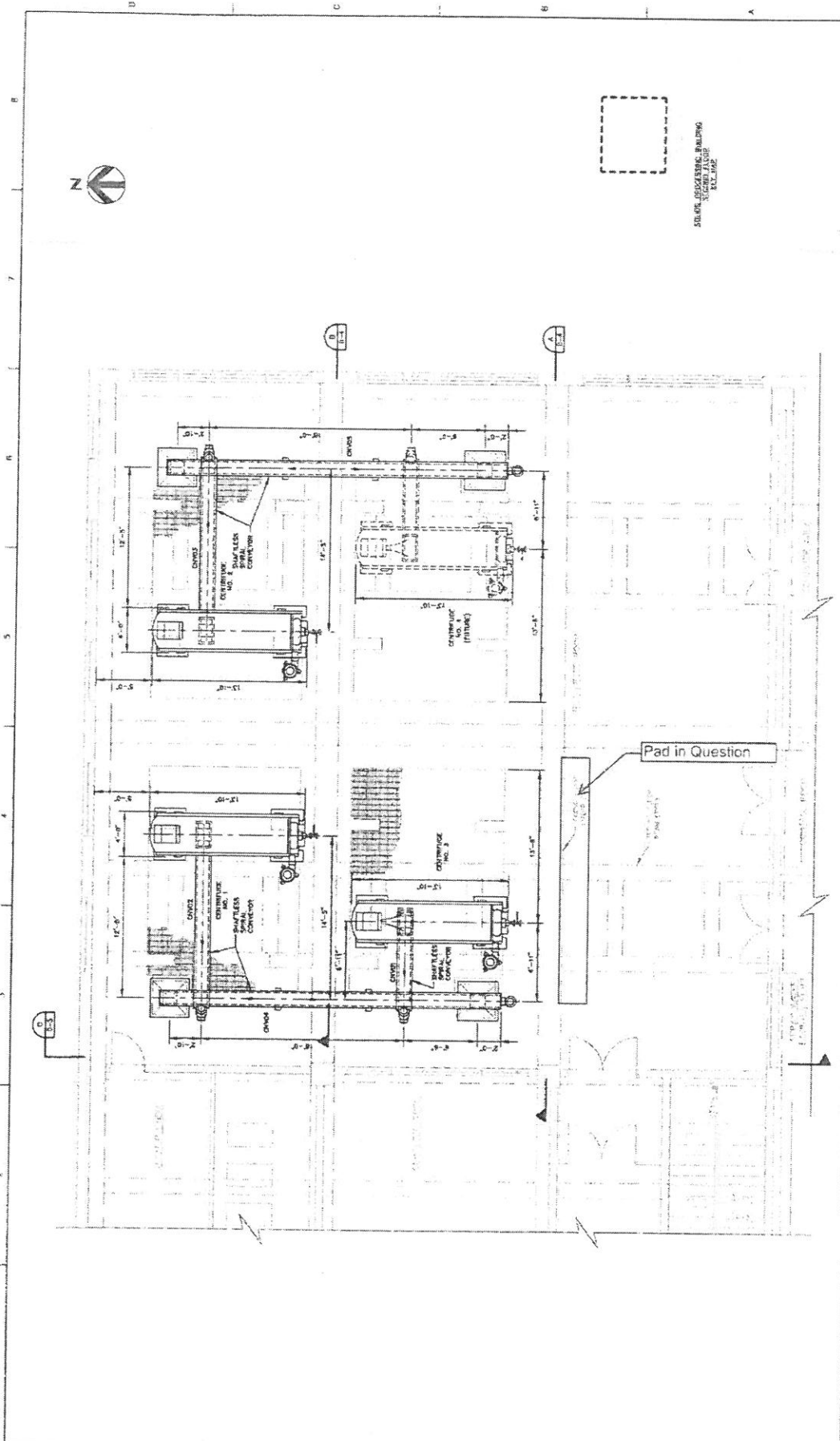

50.00' (15.24m) BUILDING
 10.00' (3.05m) HOUSE
 8.00' (2.44m) PAD

CENTRIFUGE LAYOUT PLAN

DATE: 01/11/15
 SCALE: 1/8" = 1'-0"

PROJECT NUMBER: 120179

DATE: 01/11/15

PROJECT NUMBER: 120179

DATE: 01/11/15

PROJECT NUMBER: 120179

TOWN BRANCH WWTP SOLIDS PROCESSING IMPROVEMENTS

PROJECT MANAGER: JPM	DESIGNED BY: CHW	DATE: 01/11/15
CHECKED BY: CHW	DRAWN BY: CHW	PROJECT NUMBER: 120179

NO.	DATE	DESCRIPTION



BUILDING CRAFTS, INC.
Contractors | Engineers

Proposal Summary

Job#: 0618

Date: 1/13/2016

Job Name: Town Branch WWTP Solids Processing Improvements

Work Description: 16.01.13 Slab Estimate

LABOR

	Hrs	Rate	Total Cost
Supt.	2	100.00	200.00
Labor	16	47.77	764.32
Welder	0	100.00	-
PM Time	0	150.00	-
Carpenter	0	55.00	-
Labor Total			964.32

Equipment

	Weeks	Rate	Total Cost
		0.00	-
Field Office	0	150.00	-
Backhoe	0	450.00	-
Pickup	0	300.00	-
Misc	1	332.00	332.00
Equipment Total			332.00

Materials

	Qty	Unit	Total Cost
	0	0.00	-
	0	0.00	-
		0.00	-
Materials Total			-

Subcontractors

	Cost	
	-	
Subcontractor Total		-

Total of All Cost Categories **1,296.32**

Contractor's Markup **194.45**
(15% on L,E & M; 5% on S)

3% Bond 45.22

Total of All Costs with Markup **\$ 1,536**



December 17th, 2015

Mr. Dan Breetz PE
Project Manager
Building Crafts, Inc.
P: 859.781.9500
M: 859.240.9593
dbreetz@buildingcrafts.com
www.buildingcrafts.com

Subject: Quotation and Scope for SCADA Addition for Solids Improvement Project at Town Branch WWTP
ControlTouch Proposal Number: P15190

Dear Mr. Breetz;

This letter is in response to your request to provide a project scope and quotation to modify and integrate the new solids improvement equipment into the existing Town Branch plant wide SCADA system. These additions are part of the Solid Improvement Project currently underway at the Town Branch WWTP in Lexington, Kentucky.

The proposed scope of work provided by ControlTouch Systems involves modifying the existing SCADA system to incorporate the new centrifuge and polymer systems. ControlTouch shall provide an Allen-Bradley 1783-MX08T eight port Stratix Ethernet module to be added to the DCU-F Stratix switch. This will provide eight additional ports for the centrifuge and polymer PLC equipment to interface to the SCADA system. All Ethernet cabling and termination shall be provided by others. The SCADA electrical drawing shall be updated by ControlTouch to reflect this addition.

ControlTouch shall select input points within the PLC-F system for the polymer tank level sensor and leak detect sensor to be wired by TEM. All wiring and terminations to be provided by others. The existing SCADA electrical drawings shall be updated to reflect all removed equipment and to included equipment added to DCU-F/PLC-F. As agreed to during the controls meeting on December 7th, 2015, all operational control of the centrifuges, polymer pumps and screw conveyors shall be handled outside of the SCADA PLC and is not part of this proposal. The goal is to have the centrifuge system not require the SCADA system to run.

The SCADA screens and operator interface shall be modified to incorporate the new centrifuge system. ControlTouch will remove the old belt filter press equipment, screens and faults, as well as its associated polymer system from the SCADA system. The new centrifuges and polymer systems shall be monitored via the Ethernet connections to their associated PLC's. The screw conveyors shall be monitored via hardwired connections to the MCC's. The new screens shall be

Control System Integration and Automation Solutions

3101 Breckenridge Lane - Louisville, KY 40220
(502) 452-9397 - (800) 928-7287 - Fax (502) 452-9373

3-D graphics that will fit seamlessly into the existing SCADA system. The SCADA centrifuge screen will show the needed status and control information that is displayed locally on each centrifuge main control panel. The polymer pump status, recirculation pump and tank level shall be displayed on their corresponding graphic screens. All system alarms and faults shall be added to the existing SCADA alarming system. Two trends per centrifuge has also been included.

ControlTouch has included field integration of the SCADA modification as well as debug and testing to ensure proper operation and monitoring of the SCADA system. ControlTouch has not included any programming, startup, debug or troubleshooting of the centrifuge, polymer or conveyor systems. This work shall be provided and performed by the equipment suppliers or others. ControlTouch has also included four trips to site for meetings and project review.

All field equipment, field wiring and field mounting are provided by others. Due to the rising cost of labor and materials, we reserve the right to adjust this proposal if not accepted within thirty (30) days from the above date.

PRICING:

TB Solids Improvement SCADA Integration	Price
Hardware – Stratix 8-Port Ethernet Switch	\$ 1,215
Project Management and General Conditions	3,760
Drawing and Documentation Labor	1,850
SCADA Screen Development Labor	6,250
Modification and Integration of Tags, Alarms and Trends	7,500
Field Startup and Debug Labor	7,875
Field Travel Time and Expenses	2,800
Total for TB Solids Improvement SCADA Integration	\$ 31,250

Note: The above pricing does not include any sales tax, performance bond, permits, or special insurance requirements. If these items are required, they will be borne by the purchaser.

I hope this quotation meets your requirements and answers any questions you may have. If you need further clarification on any aspects of our proposed design or how the pricing was derived please feel free to contact us.

Thank you for the opportunity to quote this project.

Sincerely,

Michael Harris
Vice President of Operations

Control System Integration and Automation Solutions

3101 Breckenridge Lane - Louisville, KY 40220
(502) 452-9397 - (800) 928-7287 - Fax (502) 452-9373



BUILDING CRAFTS, INC.
Contractors | Engineers

Proposal Summary

Job#: 0618

Date: 1/13/2016

Job Name: Town Branch WWTP Solids Processing Improvements

Work Description: 15.12.24 Control Touch

LABOR			
	Hrs	Rate	Total Cost
Supt.	0	100.00	-
Labor	0	47.77	-
Welder	0	100.00	-
PM Time	0	150.00	-
Carpenter	0	55.00	-
Labor Total			-

Equipment			
	Weeks	Rate	Total Cost
		0.00	-
Field Office	0	150.00	-
Backhoe	0	450.00	-
Pickup	0	300.00	-
			-
			-
Equipment Total			-

Materials			
	Qty	Unit	Total Cost
	0	0.00	-
	0	0.00	-
		0.00	-
Materials Total			-

Subcontractors		Cost
Control Touch Per attached scope		31,250.00
Subcontractor Total		31,250.00

Total of All Cost Categories **31,250.00**

Contractor's Markup **1,562.50**
(15% on L,E & M; 5% on S)

3% Bond **984.88**
Allowance \$ (20,000.00)

Total of All Costs with Markup **\$ 13,797**

PC # 5



BUILDING CRAFTS, INC.
Contractors | Engineers

2 Rosewood Drive
Wilders, KY 41076

Phone: (859) 781-9500
Fax: (859) 781-9505

www.buildingcrafts.com

Wednesday, January 13, 2016
Tiffany Rank, PE
Municipal Engineer Senior
859-425-2406
tiffanyr@lfugc.com

Re: Town Branch Solids Processing Project Panelview upgrade proposal

Tiffany,

This proposal is to upgrade the three polymer pumps to panel view displays. I have omitted mark-up and bond as we had already agreed on this price.

The cost would be: \$6,115.00

Best regards,

Dan Breetz PE
Project Manager
Building Crafts, Inc.

Cc: File, Engineer



BUILDING CRAFTS, INC.
Contractors | Engineers

Proposal Summary

Job#: 0618

Date: 1/13/2016

Job Name: Town Branch WWTP Solids Processing Improvements

Work Description: 16.01.13 add panelview

LABOR

	Hrs	Rate	Total Cost
Supt.	0	100.00	-
Labor	0	47.77	-
Welder	0	100.00	-
PM Time	0	150.00	-
Carpenter	0	55.00	-
Labor Total			-

Equipment

	Weeks	Rate	Total Cost
Field Office	0	0.00	-
Backhoe	0	0.00	-
Pickup	0	0.00	-
Misc	0	0.00	-
Equipment Total			-

Materials

	Qty	Unit	Total Cost
Upgrade Screen	1	6,115.00	6,115.00
	0	0.00	-
		0.00	-
Materials Total			6,115.00

Subcontractors

	Cost	
	-	
Subcontractor Total		-

Previously Committed to cost **Total of All Cost Categories** 6,115.00

~~Contractor's Markup~~ 917.25
(15% on L,E & M; 5% on S)

~~3% Bond~~ 211.47

~~Total of All Costs with Markup~~ **\$ 7,244**

PC # 6



BUILDING CRAFTS, INC.
Contractors | Engineers

2 Rosewood Drive
Wilders, KY 41076

Phone: (859) 781-9500
Fax: (859) 781-9505

www.buildingcrafts.com

Wednesday, January 13, 2016

Tiffany Rank, PE
Municipal Engineer Senior
859-425-2406
tiffanyr@lfugc.com

Re: Town Branch Solids Processing Project Bulk Polymer proposal-Revise w/tax

Tiffany,

Building Crafts is pleased to offer you this proposal to provide 5,000 gallons (43,350 pounds) of FBS C1286 Polymer. Delivery coordination and unloading is by LFUGC. This proposal is good for 2 weeks.

The cost would be:

5,000 gallons (43,350 pounds) of FBS C1286 Polymer-\$61,505.00

Best regards,

Dan Breetz PE
Project Manager
Building Crafts, Inc.

Cc: File



BUILDING CRAFTS, INC.
Contractors | Engineers

Proposal Summary

Job#: 0618

Date: 1/13/2016

Job Name: Town Branch WWTP Solids Processing Improvements

Work Description: 15.12.30 Bulk Polymer Estimate-With Tax

LABOR			
	Hrs	Rate	Total Cost
Supt.	0	100.00	-
Labor	2	47.77	-
Welder	0	100.00	-
PM Time	0	150.00	-
Carpenter	0	55.00	-
Labor Total			-

Equipment			
	Weeks	Rate	Total Cost
		0.00	-
Field Office	0	150.00	-
Backhoe	0	450.00	-
Pickup	0	300.00	-
			-
			-
Equipment Total			-

Materials			
	Qty	Unit	Total Cost
Polyier (lbs)w/tax	43350	1.13	51,924.63
	0	0.00	-
		0.00	-
Materials Total			51,924.63

Subcontractors		Cost
		-
		-
		-
Subcontractor Total		-

Total of All Cost Categories **51,924.63**

Contractor's Markup **7,788.69**
(15% on L,E & M; 5% on S)

3% Bond 1,791.90

Total of All Costs with Markup **\$ 61,505**