

Notification Map

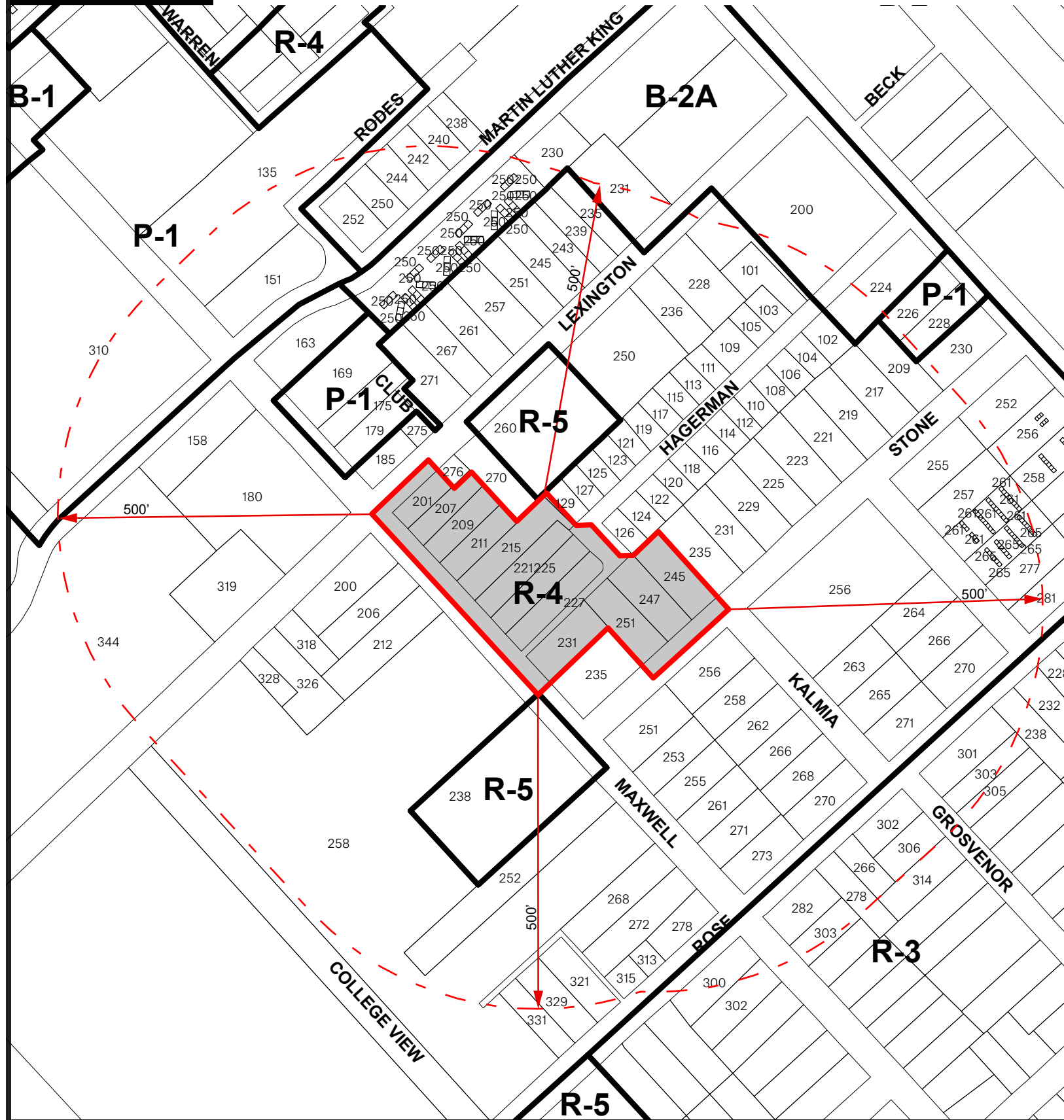

1"=200'

NORTH



Property Map



1"=100'

NORTH

- ① N46°21'28"E 121.79'
- ② S42°36'27"E 60.49'
- ③ N46°22'09"E 37.50'
- ④ S42°36'27"E 106.50'
- ⑤ N46°22'09"E 65.30'
- ⑥ S42°36'27"E 71.14'
- ⑦ N83°11'42"E 22.81'
- ⑧ S42°36'27"E 77.00'
- ⑨ N63°48'04"E 19.29'
- ⑩ N46°16'11"E 52.70'
- ⑪ S42°04'20"E 167.28"
- ⑫ S47°48'24"W 162.18'
- ⑬ N42°04'20"W 107.49'
- ⑭ S46°14'09"W 152.30'
- ⑮ N42°29'46"W 390.54'

201, 207, 209, 211, 215, 221, 225, 227, 231 East Maxwell & 245, 247, 251 Stone Ave.

2.2898 AC GROSS
1.8139 AC NET
CHANGE REQUESTED
FROM: R-4
TO: B-2A

LAND SURVEYORS CERTIFICATION

I, Kenneth Jason Graves, hereby certify that I am a Licensed Professional Land Surveyor in compliance with the laws of the Commonwealth of Kentucky, and I further certify that this plot of survey was completed by me, or persons under my supervision. This survey was completed by the method of random traverse with sideshots. The unadjusted precision ratio of said traverse loop was 1:90,383 and was not adjusted. The directional and linear measurements, as witnessed by the monuments shown hereon, are true and correct to the best of my knowledge and belief. This plot meets or exceeds the standards of governing authorities for an URBAN survey per 2017 KAR-18:150.

Kenneth Jason Graves 08/02/2019
 Date
 Licensed Professional Land Surveyor No. 4010

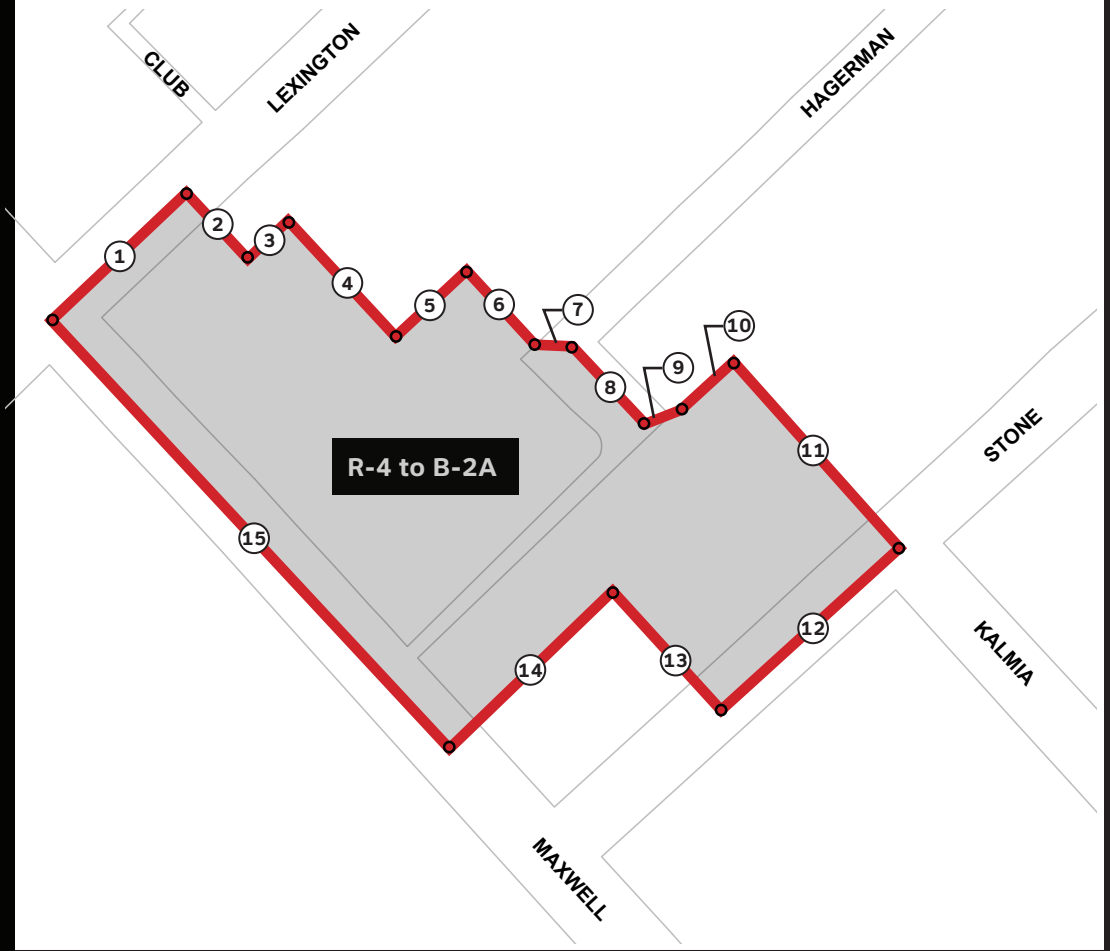
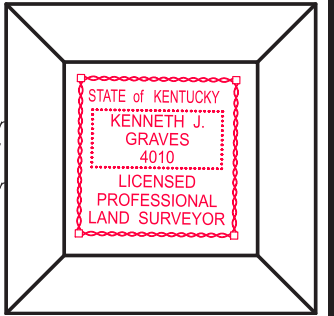

PROJECT DETAILS

PROJECT TITLE: The Marshall Lexington
PROPERTY ADDRESSES: 201, 207, 209, 211, 215, 221, 225, 227, 231 East Maxwell & 245, 247, 251 Stone Ave.
APPLICANT NAME/ADDRESS: Aptitude Development - 669 River Drive, Suite 402 Elmwood Park, NJ 07407
OWNER NAME/ADDRESS: Aptitude Development - 669 River Drive, Suite 402 Elmwood Park, NJ 07407
PREPARED BY: Gresham Smith
DATE FILED OR AMENDED: Aug. 5th, 2019 **REVISED:**

FROM	TO	NET	GROSS
R-4	B-2A	1.8139 AC	2.2898 AC

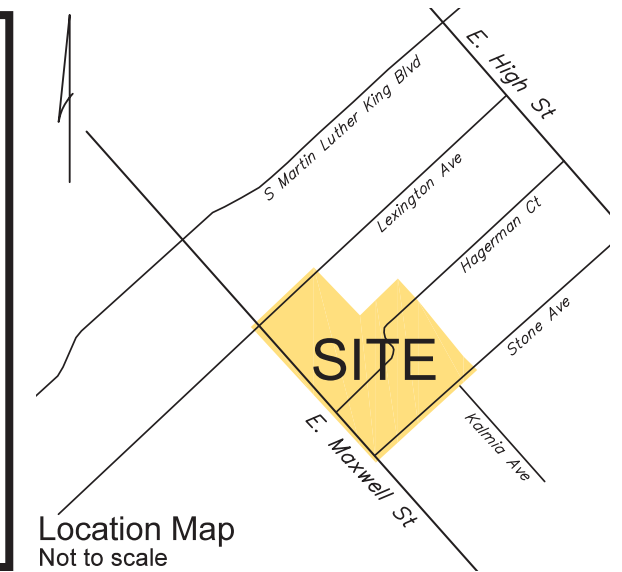

Location Map
Not to scale