

LINE TABLE

LINE	BEARING	DISTANCE	LINE	BEARING	DISTANCE
L1	S 54°58'13" E	50.72'	L8	S 42°08'51" E	36.95'
L2	S 54°49'52" E	99.20'	L9	S 42°01'25" E	39.20'
L3	S 60°43'07" E	94.34'	L10	S 47°45'45" W	7.37'
L4	N 08°35'10" W	34.37'	L11	S 47°39'52" E	37.81'
L5	S 53°47'07" E	120.89'	L12	S 47°39'52" E	22.75'
L6	S 54°58'13" E	15.58'	L13	S 48°14'31" W	141.81'
L7	S 42°08'51" E	12.40'			

CURVE TABLE

CURVE	ARC LENGTH	RADIUS	DELTA ANGLE	CHORD BEARING	CHORD LENGTH
C1	49.48'	50.00'	56°42'05"	N 19°45'52" E	47.49'

STATE OF KENTUCKY
KEVIN M. PHILLIPS
 3350
 LICENSED PROFESSIONAL LAND SURVEYOR
 08-08-2016

FROM	TO	NET	GROSS
I-1	B-1	0.3511	0.5354
I-1	B-2A	2.3773	3.9536

TITLE: Community Ventures, LLC Properties
 ADDRESS: 225, 261 & 265 Midland Avenue; 561, 563, 565, 556 & 576 E. Third Street & 250 Lewis Street
 APPLICANT: Community Ventures, LLC
 OWNER: Community Ventures, LLC
 DATE FILED OR AMENDED: August 8th, 2016

NOTIFICATION AREA MAP
 PREPARED BY:

EE ENDRIS engineering
 Land Surveyors • Construction Layout • GPS

771 ENTERPRISE DRIVE
 LEXINGTON, KY 40510
 PH: 859 253-1425
 FAX: 859 233-1436

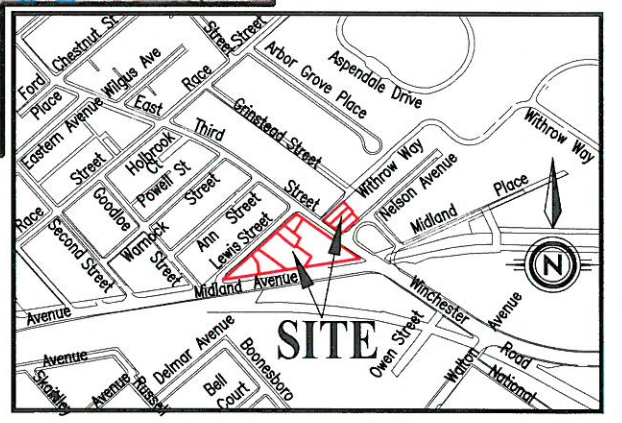
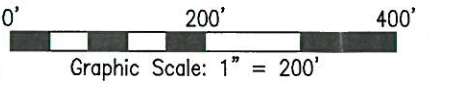

VICINITY MAP
 Graphic Scale: 1" = 1,000'

1:36:00 Boundary & Topographic Survey - Midland Ave, Lewis St and E Third St Zone Change/Seu Notification Map.dwg, 8/8/2016 7:35:06 AM, T.T. Endris Engineering, KMP