

Attachment A, March 2021

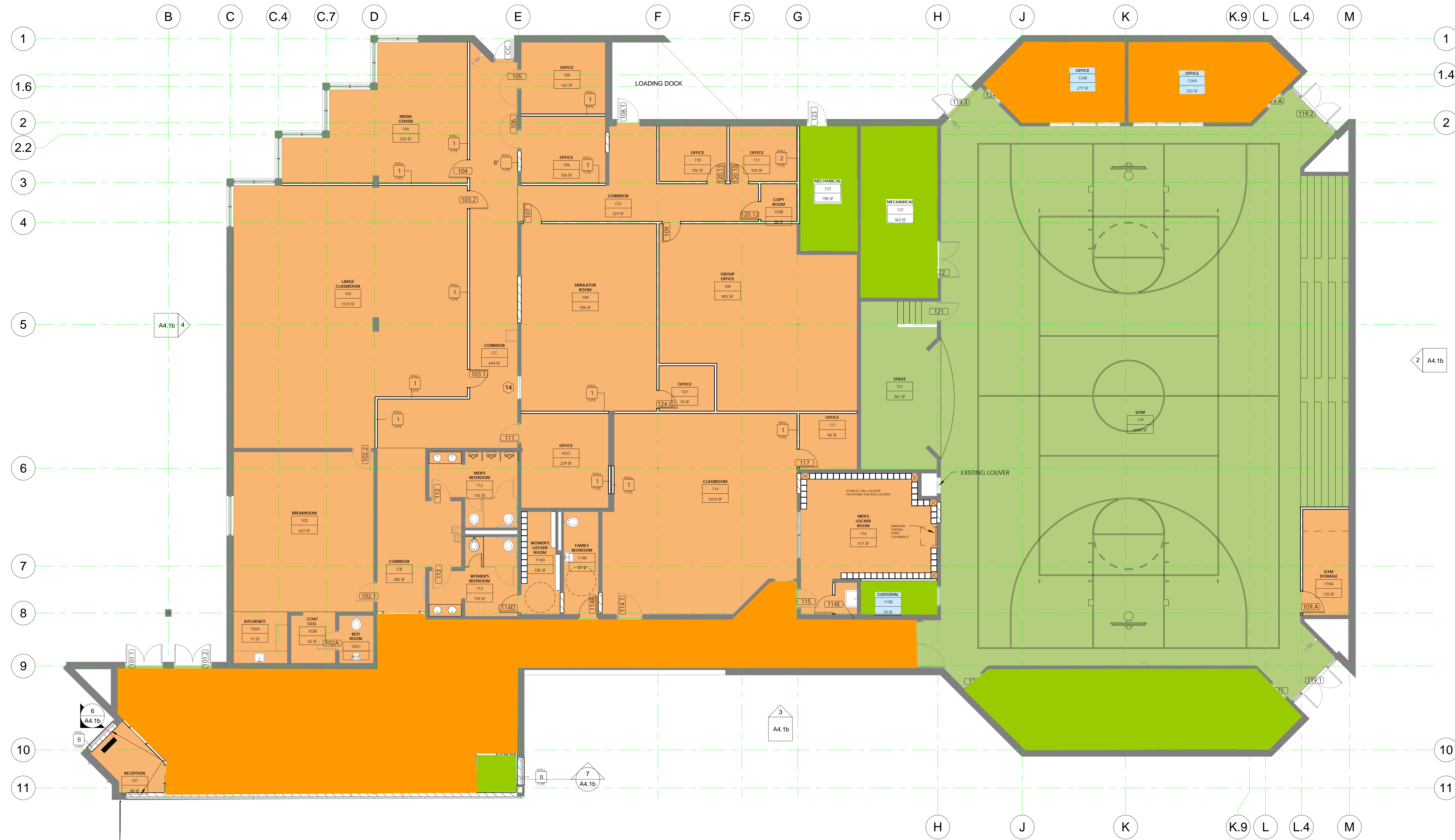

PRESENTATION FIRST FLOOR BLDG 69
1/8" = 1'-0"

NOT USED

DEPARTMENT LEGEND

- 0 sf BCTC COLLEGE
- 13,098 sf POLICE TRAINING ACADEMY
- 7,602 sf SHARED SPACE

MATERIAL REFERENCE NOTES:

02000.2	EXTERIOR CONCRETE
02100.A	BUILDING DEMOLITION
02419.A	SELECTIVE DEMOLITION
DIVISION 3 - CONCRETE	
03000.A	FOOTING
03000.B	FOUNDATION WALL
03000.C	SLAB ON GRADE
03000.E	CONCRETE JOINT MATERIAL
DIVISION 4 - MASONRY	
04000.A	CONCRETE MASONRY UNIT (CMU)
04000.B	FACTORY FINISH
04000.C	STAIN & WEAR
04000.D	BRICKWORK
04000.E	MORTAR DETECTOR MATERIAL
04000.F	CONCRETE REINFORCEMENT
04000.G	MASONRY ANCHORS
04000.H	CONCRETE JOINTS
DIVISION 5 - METALS	
05100.A	ROOF DECK
DIVISION 6 - WOOD, PLASTIC, & COMPOSITES	
06100.A	WOOD BLOCKING, P.I. & N.O.
DIVISION 7 - THERMAL & MOISTURE PROTECTION	
07100.C	THERMAL BATT INSULATION
07100.D	SHIMMED/PLACED THERMAL INSUL.
07200.A	VAPOUR BARRIER
07300.B	AIR FILTRATION BARRIER
07300.C	SEMI-RIGID BARRIER MEMBRANE
07300.D	ROOFING SYSTEM
07400.A	EASCA
07400.B	ROOF/CEILING FLASHING
07500.A	JOINT SEALANT
DIVISION 8 - OPENINGS	
08113.A	STEEL DOORS & FRAMES
08141.A	FLUSH WOOD DOORS
08200.A	ACCESS DOORS & FRAMES
08413.C	ALUMINUM DOOR
08500.A	WOOD HINGES & FRAMING
08700.A	DOOR HARDWARE
08800.A	GLAZING
08800.A	MIRRORS
DIVISION 9 - FINISHES	
09116.A	CORPUS BOARD ASSEMBLIES
09116.B	METAL CORPUS AND FINISHES
09116.C	CORPUS BOARD REGULARITY "K"
09116.D	FIBERGLASS FACELINE C/P. RD.
09116.E	IMPACT RESISTANT C/P. RD.
09116.F	ACRILIC RESISTANT C/P. RD.
09116.G	MOLDED RESISTANT C/P. RD.
09116.H	CORPUS BOARD
09116.I	CORPUS BOARD
09116.J	CORPUS BOARD
09116.K	FRP PANELS
09300.A	CERAMIC TILE
09300.A	ACCOMMODATION PANEL C/LG. SYSTEM
09500.A	RESILIENT FLOORING
09600.A	WALL BASE & ACCESSORIES
09645.A	LINOLEUM FLOOR COVERING
09645.A	CARPET TILE & CARPET BASE
09600.A	PAINT
DIVISION 10 - SPECIALTIES	
10101.A	VISUAL DISPLAY SURFACES
10142.A	SCANS
10142.A	POST AND PANEL SIGNS
10143.A	STAFFIC SIGNAGE
10200.A	CORNER GUARD
10200.B	WALL GUARD
10300.A	TOILET & BATH ACCESSORIES
10400.A	FIRE EXTINGUISHER & BRACKET
10400.B	FIRE EXTINGUISHER & CABINET
10500.A	METAL LOCKERS
DIVISION 11 - EQUIPMENT	
11100.A	MICROWAVE OVEN
11100.B	REFRIGERATOR
11200.A	UNDERCOUNTER REFRIGERATOR
11212.A	PROJECTION SCREEN
DIVISION 12 - FURNISHINGS	
12413.A	MANUALLY OPERATED WINDOW SHADE
12450.A	WOOD LABORATORY CASEWORK
12500.A	RECREATIONAL CASEWORK
12913.A	BICYCLE RACKS
12946.13.A	SEE BENCHES
12946.3.A	SEE BENCHES

REVISIONS		DATE
1		
2		
3		
4		
5		
6		
7		
8		

BID PACKAGE #6A: BUILDINGS 15, 59 & 69 RENOVATIONS

PHASE 'B' SUBMITTAL

CLASSROOM/STUDENT SERVICES BUILDING
NEWTOWN PIKE CAMPUS
BLUEGRASS COMMUNITY & TECHNICAL COLLEGE
KENTUCKY COMMUNITY & TECHNICAL COLLEGE SYSTEM
LEXINGTON, KY
(LEXINGTON COMM. COLLEGE - CLASSROOM BLDG. - ORIGINAL AUTHORIZED NAME)

AS BUILT DATE	FLOOR PLAN MEGOWAN	DRAWING NO.
DRAWN BY PBF/SRJ CHECKED BY RB	COMMONWEALTH OF KENTUCKY FINANCE AND ADMINISTRATION CABINET DEPARTMENT FOR FACILITIES AND SERVICES REPORT DIVISION OF ENGINEERING AND CONTRACT ADMINISTRATION FRANKFORT, KENTUCKY	NOT USED
A & E FILE NO. RTA 0931	rosstarrant architects	SEVERED OFF OF BLDG.
DATE AUGUST 15, 2012	101 040 Lafayette Avenue, Lexington, Kentucky 40502 © 2012 ROSSTARRANT ARCHITECTS 1-800-233-5986	SEVERED OFF OF BLDG. 470-C143-LX02-00
AGENCY AUTHORIZED AGENT	APPROVED FOR PROGRAM CONCEPT ONLY	DATE
DIVISION OF ENGINEERING	APPROVED FOR PROGRAM CONCEPT ONLY	DATE