

Date Issued: 02/24/2016

Murphy + Graves Project No. 1316

Project: LFUCG PSOC

Attachments: PR 46 Sketch

Issued by: Steve Cherry via Andrea Bradford

Subject: New Sill Flashing at Existing Penthouse Louvers

Refer to attached sketch.

- Provide new metal sill flashing along the top surface of the bottom louver blade at each of the existing penthouse louvers. Extend the new flashing profile up the existing louver blade, and turn it vertically up to the bottom of the next blade above.
- Provide concealed cleat & fasteners at the bottom of the new sill flashing.
- Provide exposed fasteners through the new flashing into the existing louver assembly as close to the top edge of the new flashing as possible, to minimize its exposure to weather. Provide sealant closure at each exposed fastener.
- Provide a "corner flashing" piece on top of this new sill flashing at the 90 degree corners of penthouses, where the existing louver blades and the new sill flashing are mitered. This "cap flashing" is meant to flash that exposed miter joint at the corners.
- Provide a metal cover plate on top of each existing drilled or cut opening of various louver blades.
- Where former mechanical units (fans, etc.) have been removed from exterior faces of existing louvers, leaving gaps in continuity of the louver blades, provide new louver blade sections, matching profile of existing blades, as infill in these areas, overlapping adjacent louver blades by approximately 4".
- Provide electrostatic paint coating on all louver surfaces, existing and new, per construction documents (A3.0, A3.1, A4.0) at no additional cost.

Provide a proposal for the scope of work described in these documents, complete with breakdown.

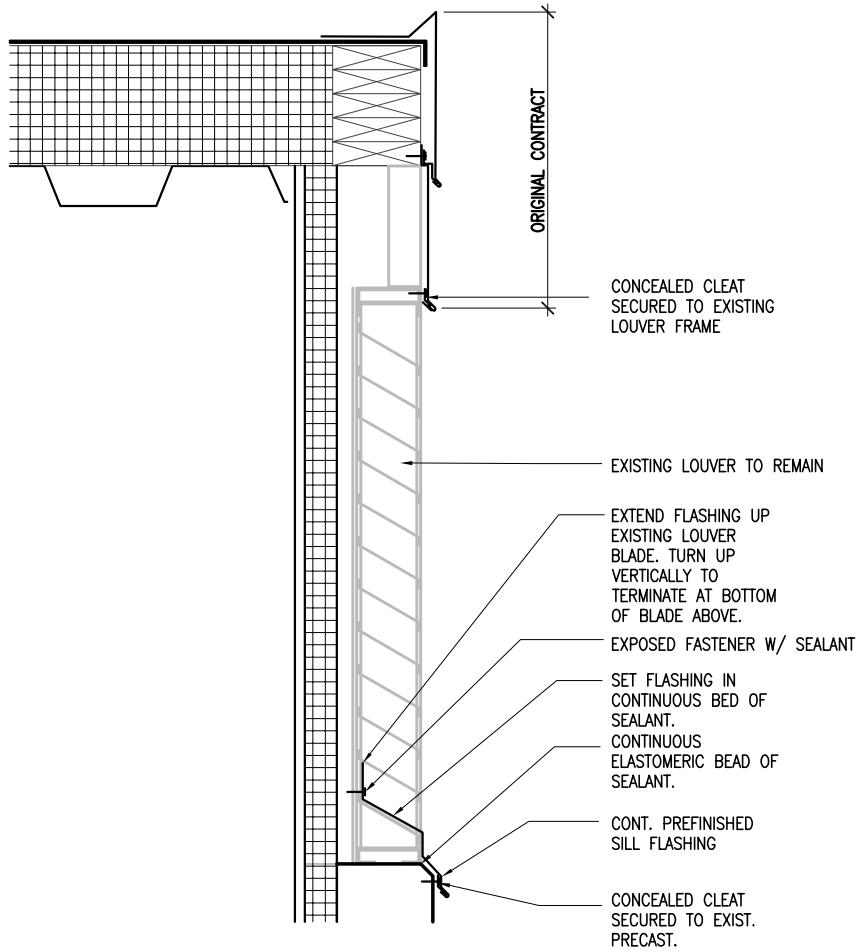

SECTION DETAIL

1"=1'-0"

PR DESCRIPTION: _____

FLASHING AT EXISTING LOUVER

JOB NAME _____

LFUCG PUBLIC SAFETY OPERATIONS CENTER - PHASE I

PR NO. _____

PR 46

JOB NO. 1316

DATE FEBRUARY 17, 2016

PRODUCED BY AS

NOTES:

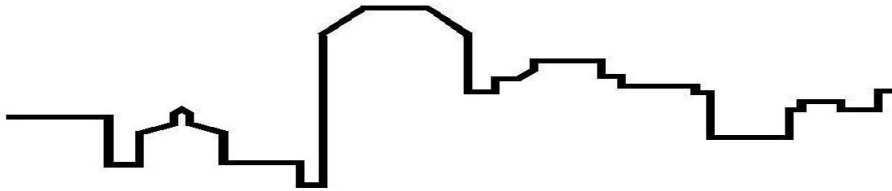

CHURCHILL McGEE, LLC

1315-C West Main Street
phone (859) 389-6976

Lexington, Kentucky 40508
fax (859) 389-6986

Change Order Proposal PR #46

Project: Public Safety Operations Center	4/1/2016																																								
Project Number: MGT 1316																																									
You are authorizing us to perform the following additional work:																																									
Provide and install flashing on the existing penthouse louvers as per details on PR #46																																									
Provide and install 2" rigid insulation and gypsum board over interior of penthouse louvers																																									
Credit for blank off panels on interior of louvers																																									
	<table style="width: 100%; border-collapse: collapse;"> <thead> <tr> <th style="width: 60%;"></th> <th style="width: 20%;">Drywaller</th> <th style="width: 20%;">DMC</th> <th style="width: 20%;">Total</th> </tr> </thead> <tbody> <tr> <td>Materials</td> <td style="text-align: right;">\$4,674.00</td> <td style="text-align: right;">\$2,242.00</td> <td style="text-align: right;">\$6,916.00</td> </tr> <tr> <td>Labor</td> <td style="text-align: right;">\$5,776.00</td> <td style="text-align: right;">\$9,086.25</td> <td style="text-align: right;">\$14,862.25</td> </tr> <tr> <td>Equipment</td> <td></td> <td></td> <td></td> </tr> <tr> <td>Mark Up</td> <td style="text-align: right;">\$550.00</td> <td style="text-align: right;">\$1,699.24</td> <td style="text-align: right;">\$2,249.24</td> </tr> <tr> <td colspan="3" style="text-align: right;">Total</td> <td style="text-align: right;">\$24,027.49</td> </tr> <tr> <td colspan="3" style="text-align: right;">CM Mark up</td> <td style="text-align: right;">\$2,402.75</td> </tr> <tr> <td colspan="3" style="text-align: right;">Total</td> <td style="text-align: right;">\$26,430.24</td> </tr> <tr> <td colspan="3" style="text-align: right;">Credit for Interior Louver Panels (Per Addendum #5)</td> <td style="text-align: right;"><u>-\$18,963.04</u></td> </tr> <tr> <td colspan="3" style="text-align: right;">Total Change Order</td> <td style="text-align: right;">\$7,467.20</td> </tr> </tbody> </table>		Drywaller	DMC	Total	Materials	\$4,674.00	\$2,242.00	\$6,916.00	Labor	\$5,776.00	\$9,086.25	\$14,862.25	Equipment				Mark Up	\$550.00	\$1,699.24	\$2,249.24	Total			\$24,027.49	CM Mark up			\$2,402.75	Total			\$26,430.24	Credit for Interior Louver Panels (Per Addendum #5)			<u>-\$18,963.04</u>	Total Change Order			\$7,467.20
	Drywaller	DMC	Total																																						
Materials	\$4,674.00	\$2,242.00	\$6,916.00																																						
Labor	\$5,776.00	\$9,086.25	\$14,862.25																																						
Equipment																																									
Mark Up	\$550.00	\$1,699.24	\$2,249.24																																						
Total			\$24,027.49																																						
CM Mark up			\$2,402.75																																						
Total			\$26,430.24																																						
Credit for Interior Louver Panels (Per Addendum #5)			<u>-\$18,963.04</u>																																						
Total Change Order			\$7,467.20																																						
We hereby authorize the above change order to be completed																																									
Additional work is to be performed under the same conditions as specified in the original contract unless stipulated otherwise.																																									
Date: _____	Owners Signature: _____																																								
Churchill McGee LLC																																									
Date: _____	Authorized Signature: _____																																								

NOTE: The above referenced change order revisions will only modify the original contract scope of work as specifically addressed in this change order. All other terms and conditions of the original contract will not change.

DMC

Darell Motley 1-859-539-2637
P.O. Box 1288
Lexington, KY 40588

3/20/2016

Estimate

Qty	Description of work	Price	Total
1	Install close off panels on exterior penthouse louvers at PSOC project as per PR #46. Color selection from standard color chart. Materials to be painted by others.		
	Materials		
20	Rolls Coil Stock Black	\$90.00	\$1,800.00
1	Miscellaneous screws , fastners	\$250.00	\$250.00
24	Tubes caluking	\$8.00	\$192.00
	Labor		
125	Hours Sheetmetal Worker	\$41.59	\$5,198.75
125	Hours laborer	\$31.10	\$3,887.50
Full Payment Due Upon Completion This estimate is good for 30 days from time written			

Customer		Subtotal	\$11,328.25
Name	Churchill McGee	Profit	\$1,699.24
Address			
Phone Number	606-316-0895	Total	\$13,027.49



ESTIMATE

1315C W Main Street
 Lexington, KY 40508
 859-475-6946
jmefford@d9interiors.com

ESTIMATE NO. 2016 - 0105
 DATE January 5, 2016
 CUSTOMER ID Churchill McGee
 EXPIRATION DATE 2/5/2016

TO Churchill McGee
 1315C W Main Street
 Lexington, KY 40508

JOB NAME	ESTIMATOR	PREPARED FOR	BID DATE
Penthouse Change Order	Jordan Mefford	Jeff Griffith	1/5/16

ITEM	DESCRIPTION	LINE TOTAL
Material	Material to Complete Rigid Metal Framing, 2" Insulation and Drywall with all Accessories	\$ 4,674.00
Labor	Labor to Complete Rigid Metal Framing, 2" Insulation and Drywall with Accessories	5,776.00
Markup	5% Profit Markup	550.00

SUBTOTAL	\$ 11,000.00
ADDS	
TOTAL	\$ 11,000.00

Quotation prepared by: _____
 This is a quotation on the goods named, subject to the conditions noted below:
 Estimate excludes all permits.
 To accept this quotation, sign here and return: _____

Date Issued: 02/29/2016

Murphy + Graves Project No. 1316

Project: LFUCG PSOC

Attachments: RFP Marcum Engineering

Issued by: Johnny Baucum via Andrea Bradford

Subject: Exterior Data Cabling for Camera

See attached RFP from Marcum Engineering.

Provide a proposal for the scope of work described in these documents, complete with breakdown.

PUBLIC SAFETY OPERATIONS CENTER PHASE 2
LEXINGTON FAYETTE URBAN COUNTY GOVERNMENT
LEXINGTON, KENTUCKY
MURPHY GRAVES TRIMBLE ARCHITECTS NO. 1316
MARCUM NO. 13618

MPE REQUEST FOR PROPOSAL

TO: Andrea Bradford, Murphy Graves Trimble

CC: Steve Cherry, Murphy Graves Trimble
Perry Warren, Murphy Graves Trimble
Jim Leake, Murphy Graves Trimble
Pat McFeely, Mission Critical Partners
Robert Lafaye, Mission Critical Partners
Jim Krebs, Mission Critical Partners
Baccus L. Oliver, Marcum Engineering

FROM: Johnny Baucum, Marcum Engineering

DATE: January 5, 2016

SUBJECT: RFP 8 Response to RFI 87 – Exterior Data Cabling for Camera

RATIONALE:

The Installing Contractor has suggested to install indoor/outdoor rated CAT6 cabling for the exterior camera at the pedestal. The Owner has requested a price for this work to evaluate.

INSTRUCTIONS:

The Contractor shall provide a proposal to install indoor/outdoor CAT6 cable to the exterior camera pedestal. The proposal shall be broken down to reflect a credit for the per foot cost and total footage of the specified CAT6 cabling as well as the ad for the per foot cost and total footage for the indoor/outdoor CAT6 cabling requested. Labor cost shall remain the same.

ATTACHMENTS:

1. RFI 87 (Churchill McGee)

END OF DOCUMENT

Request For Information (RFI)

Requested Reply Date

Project Name: PSOC

RFI Number 87	Submitted To: M&G&T	Submitted By: Churchill McGee	Copies To:
Date 2-15-16			

Subject Camera Gate wiring	Discipline Electrical / Security	Co-Author

REFERENCE ATTACHMENTS: (List specific documents researched when seeking the information requested.)

Specification Section 280513	Drawing Reference NA	Other

RFI DESCRIPTION: (Fully describe the question or type of information requested.)

There is no specific type of cabling called out for on the outside mounted cameras in the gate pedestals. Even though they are in conduit, Arrow Electric and Voitress are recommending that an indoor /outdoor cable be used instead of normal CAT6. They say the upgrade will add a small cost, but be much more effective

SENDER'S RECOMMENDATION: (if RFI concerns a site or construction condition, the sender may provide a recommendation, including cost and/or schedule considerations.)

Response:

Date Answered: _____ Answered By: _____

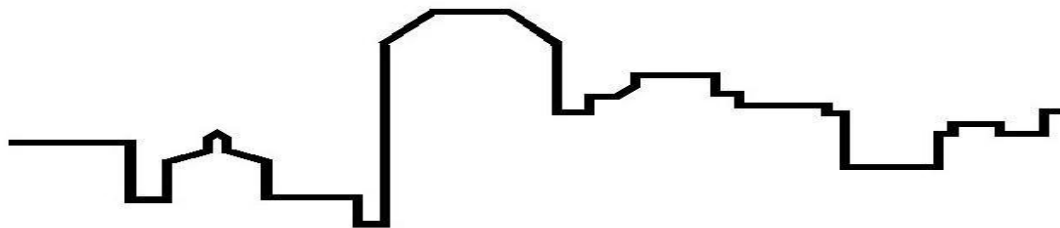

CHURCHILL McGEE, LLC

1315-C West Main Street
phone (859) 389-6976

Lexington, Kentucky 40508
fax (859) 389-6986

Change Order Proposal PR #48

Project: Public Safety Operations Center		4/1/2016
Project Number: MGT 1316		
You are authorizing us to perform the following additional work:		
Provide indorr / outdoor rated cable to gate cameras in lieu of standard indoor cable		
	Arrow	Total
Materials	\$339.20	\$339.20
Labor		\$0.00
Equipment		
Mark Up	\$50.88	\$50.88
	Total	\$390.08
	CM Mark up	\$39.01
	Total	\$429.09
	Total Change Order	\$429.09
We hereby authorize the above change order to be completed		
Additional work is to be performed under the same conditions as specified in the original contract unless stipulated otherwise.		
Date: _____ Owners Signature: _____		
Churchill McGee LLC		
Date: _____ Authorized Signature: _____		

NOTE: The above referenced change order revisions will only modify the original contract scope of work as specifically addressed in this change order. All other terms and conditions of the original contract will not change.



Change Proposal

Client Address:

Churchill McGee, LLC
 1315-C West Main Street
 Lexington, Kentucky 40508
 Telephone: (859) 389-6976
 Fax: (859) 389-6986
 Contact: Jeff Griffith

Ref #1 CE # 14
Date: 3/7/2016
Project Name: LFUCG Public Safety Operations Center
Project Number: 20-10-2109 LFUCG Public Safety Operations Center
Contract #: Dated Feb., 4th, 2015
Page Number: 1

Work Description

With Respect to PR # 48, Arrow Electric offers the following for your consideration:

Credit standard cable for two outdoor camera's.
 Provide Indoor/Outdoor rated cable for two outdoor camera's.

We reserve the right to correct this quote for errors and omissions.

This quote covers direct costs only and we reserve the right to claim for impact and consequential costs.
 This price is good for acceptance within **10** days from the date of receipt.
 We request a time extension of **0** days.
 We will supply and install all materials, labor, and equipment as per your instructions on **PR # 48**.

Item Description

Description	Qty	Total Mat.	Total Hrs.
Standard Cable	-1,000	-360.00	-0.00
Indoor/Outdoor Rated Cable	1,000	680.00	0.00
Totals	0	320.00	0.00

Summary

MATERIAL		
Material Tax	(@ 6.000 %)	19.20
Material Total		339.20
Markup	(@ 15.000 %)	50.88

Final Amount **\$390.08**

CLIENT ACCEPTANCE

CCN #: 14	_____
Final Amount: \$390.08	_____
Name:	_____
Date:	_____
Signature:	_____
Change Order #:	_____

I hereby accept this quotation and authorize the contractor to complete the above described work.



April 8, 2016

Mr. Steve Cherry
Murphy Graves Trimble
3399 Tates Creek Road, STE 250
Lexington, KY 40502

Re: Proposal Review
MGT PR 48 – Outdoor Data Cabling Change
Emergency Operations Center Phase 1B
Lexington Fayette Urban County Government
Lexington, Kentucky
Marcum No. 13618

Steve,

Marcum has reviewed Proposal Request 48 in the amount of \$429.09 and find it to be representative of the work requested and would recommend acceptance.

Please let me know if you have any questions.

Sincerely,

MARCUM ENGINEERING, LLC

A handwritten signature in black ink, appearing to read 'Johnny Baucum', with a long horizontal flourish extending to the right.

Johnny Baucum, Construction Administrator

Cc: Chuck Trimble, MGT
Andrea Bradford, MGT
Jim Leake, MGT
Baccus Oliver, Marcum Engineering

Date Issued: 03/03/2016

Murphy + Graves Project No. 1316

Project: LFUCG PSOC

Attachments: RFP Marcum Engineering

Issued by: Johnny Baucum via Andrea Bradford

Subject: AI Phone

See attached RFP from Marcum Engineering.

Provide a proposal for the scope of work described in these documents, complete with breakdown.

PUBLIC SAFETY OPERATIONS CENTER PHASE 2
LEXINGTON FAYETTE URBAN COUNTY GOVERNMENT
LEXINGTON, KENTUCKY
MURPHY GRAVES TRIMBLE ARCHITECTS NO. 1316
MARCUM NO. 13618

MPE REQUEST FOR PROPOSAL

TO: Andrea Bradford, Murphy Graves Trimble

CC: Steve Cherry, Murphy Graves Trimble
Perry Warren, Murphy Graves Trimble
Jim Leake, Murphy Graves Trimble
Pat McFeely, Mission Critical Partners
Robert Lafaye, Mission Critical Partners
Jim Krebs, Mission Critical Partners
Baccus L. Oliver, Marcum Engineering

FROM: Johnny Baucum, Marcum Engineering

DATE: February 29, 2016

SUBJECT: RFP 9 Response to RFI 88 – AI Phone Modification.

RATIONALE:

Modification required for proper operation and integration of the AI Phone and Access Control Systems.

INSTRUCTIONS:

The Contractor shall provide a proposal to locate the AI Phone controller at the pedestrian gate as shown on Sketch XE05, in lieu of Vestibule 100V entrance as shown on the original Contract Documents. Exterior exposed wiring shall be in rigid conduit with the wall mounted AI Phone unit as depicted in Sketch XE05 (24" East of gate and 48" above finish sidewalk grade.)

Trigger wiring for gate control shall be routed back to the South West corner of Electrical Room 142 and terminated at the security access control panel to log activity. The Contractor shall also price furnishing and installing (1) additional (22/6 exterior) wire form each of the (2) gates to facilitate access controller communication.

ATTACHMENTS:

1. RFI 88 (Churchill McGee)
2. Sketch XE05

END OF DOCUMENT

Request For Information (RFI)

Requested Reply Date

Project Name: PSOC

RFI Number
88
Date
2-15-16

Submitted To:
M&G&T

Submitted By:
Churchill McGee

Copies To:

Subject	Discipline	Co-Author
Airphone Door Controller	Electrical / Communications/ Security	

REFERENCE ATTACHMENTS: (List specific documents researched when seeking the information requested.)

Specification Section	Drawing Reference	Other
282310	NA	

RFI DESCRIPTION: (Fully describe the question or type of information requested.)

The Airphone door controller needs to be tied into the security system. Can you please tell us where to run the door release trigger wiring to unlock the doors.

SENDER'S RECOMMENDATION: (if RFI concerns a site or construction condition, the sender may provide a recommendation, including cost and/or schedule considerations.)

Response:

Date Answered: _____ Answered By: _____

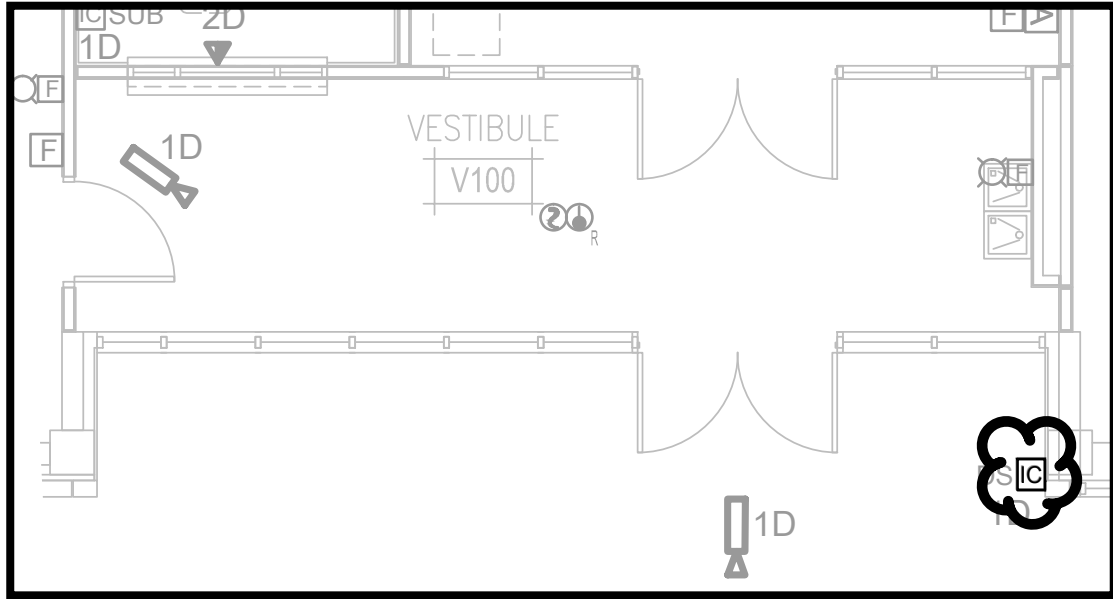

RELOCATE AI PHONE
FROM VESTIBULE V100
ENTRY TO PEDESTRIAN
GATE

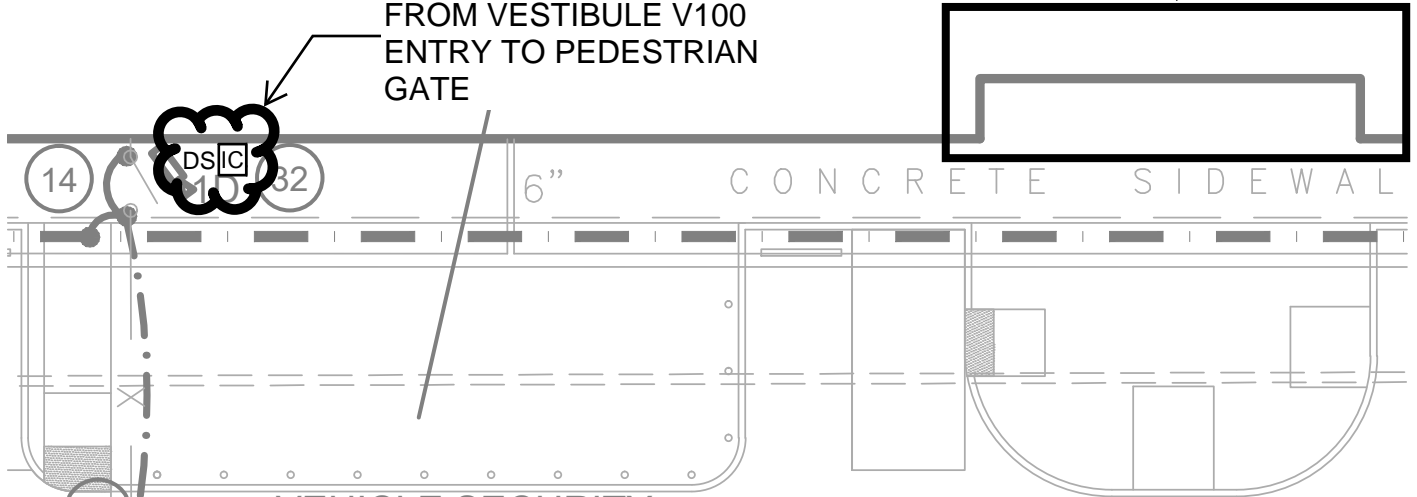

MARCUM
ENGINEERING, LLC

500 SOUTH 17th STREET
PADUCAH, KENTUCKY 42002-0120
PHONE - 270.444.9274 FAX - 270.443.1904

COPYRIGHT ©, 2016 - MARCUM ENGINEERING, LLC

PROJECT NO.
13618

DATE:
2/29/2016

DRAWN BY:
JOHNNY

SCALE:
NONE

AI PHONE INNERCOM RELOCATION
VESTIBULE V100 ENTRY

LFUCG OPERATIONS CENTER
PHASE 2
LEXINGTON KENTUCKY

REFERENCE DRAWING
U1.1, E1.6

SKETCH NO.

XP04

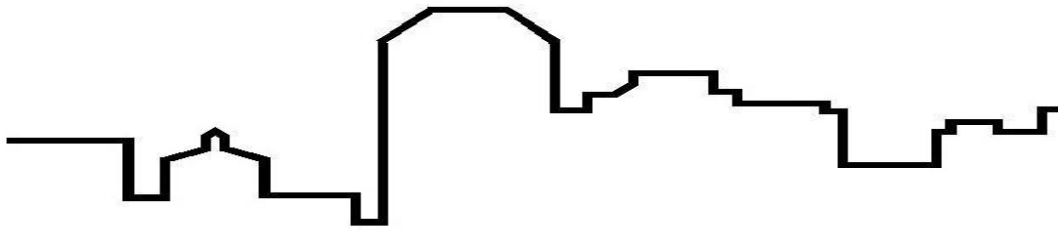

CHURCHILL McGEE, LLC

1315-C West Main Street
phone (859) 389-6976

Lexington, Kentucky 40508
fax (859) 389-6986

Change Order Proposal PR #49

Project: Public Safety Operations Center	4/1/2016	
Project Number: MGT 1316		
You are authorizing us to perform the following additional work:		
Relocate A Phone as per PR #49 details		
	Arrow	Total
Materials	\$768.70	\$768.70
Labor	\$1,162.20	\$1,162.20
Equipment		
Mark Up	\$289.64	\$289.64
Total		\$2,220.54
CM Mark up		\$222.05
Total		\$2,442.59
Total Change Order		\$2,442.59
We hereby authorize the above change order to be completed		
Additional work is to be performed under the same conditions as specified in the original contract unless stipulated otherwise.		
Date: _____	Owners Signature: _____	
Churchill McGee LLC		
Date: _____	Authorized Signature: _____	

NOTE: The above referenced change order revisions will only modify the original contract scope of work as specifically addressed in this change order. All other terms and conditions of the original contract will not change.



Change Proposal

Client Address:

Churchill McGee, LLC
 1315-C West Main Street
 Lexington, Kentucky 40508
 Telephone: (859) 389-6976
 Fax: (859) 389-6986
 Contact: Jeff Griffith

Ref #1 CE # 15
Date: 3/25/2016
Project Name: LFUCG Public Safety Operations Center
Project Number: 20-10-2109 LFUCG Public Safety Operations Center
Contract #: Dated Feb., 4th, 2015
Page Number: 1

Work Description

With Respect to PR # 49, Arrow Electric offers the following for your consideration:

Relocate the AI phone from Vestibule 100V to pedestrian gate per sketch XP04.
 Provide a stainless steel back box for the AI phone at new location.
 Provide conduit and wiring, also an additional 22/6 cable from gate controller.
 Price does not include any lightning arresters. None called for in Proposal request.

We reserve the right to correct this quote for errors and omissions.

This quote covers direct costs only and we reserve the right to claim for impact and consequential costs.
 This price is good for acceptance within **10** days from the date of receipt.
 We request a time extension of **0** days.
 We will supply and install all materials, labor, and equipment as per your instructions on **PR # 49 dated 3/3/16.**

Item Description

Description	Qty	Total Mat.	Total Hrs.
3/4" CONDUIT - EMT	20	15.88	0.80
3/4" CONN COMP STL INSUL - EMT	1	3.59	0.16
3/4" INSULATING BUSHING - EMT	1	0.21	0.05
3/4" CONDUIT - RMC - GALV	10	26.47	0.63
3/4" 3-PC UNION (ERICKSON) COUPLING - RMC - MALL OR STL	1	5.30	0.53
3/4" ENTRANCE FITTING - THREADED - RMC	1	20.41	0.44
3/4" TYPE LB STD CONDUIT BODY - RMC - MALL	1	12.17	0.63
3/4" 2-H STRAP - RMC - STEEL	3	1.07	0.23
3/4" 2-H STRAP - EMT - STEEL	3	0.85	0.23
3/4" SPRING STL CONDUIT CLAMP W/ BOLT	4	1.55	0.30
#22/7C CTRL-AUDIO-INST CBL	1,500	277.50	15.95
3/16x 1 3/4 CONCRETE SCREW HEX HEAD - BLUE	6	1.74	0.57
2x2 CEILING TILE	10	160.00	1.00
STAINLESS SBX-DVF	1	198.45	0.85
Totals	1,562	725.19	22.35

Summary

MATERIAL		
Material Tax	(@ 6.000 %)	43.51
Material Total		768.70
JOURNEYMAN	(22.35 Hrs @ \$52.00)	1,162.20
Markup	(@ 15.000 %)	289.64

Final Amount **\$2,220.54**

Change Proposal

Client Address:

Churchill McGee, LLC
1315-C West Main Street
Lexington, Kentucky 40508
Contact: Jeff Griffith

Date: 3/25/2016
Project Name: LFUCG Public Safety Operations Center
Project Number: 20-10-2109 LFUCG Public Safety Operations Center
Contract #: Dated Feb., 4th, 2015
Page Number: 2

CLIENT ACCEPTANCE

CCN #: 15 _____
Final Amount: \$2,220.54 _____
Name: _____
Date: _____
Signature: _____
Change Order #: _____

I hereby accept this quotation and authorize the contractor to complete the above described work.



April 8, 2016

Mr. Steve Cherry
Murphy Graves Trimble
3399 Tates Creek Road, STE 250
Lexington, KY 40502

Re: Proposal Review
MGT PR 49 – AI Phone Changes
Emergency Operations Center Phase 1B
Lexington Fayette Urban County Government
Lexington, Kentucky
Marcum No. 13618

Steve,

Marcum has reviewed Proposal Request 49 in the amount of \$2,442.59 and find it to be representative of the work requested and would recommend acceptance.

Please let me know if you have any questions.

Sincerely,

MARCUM ENGINEERING, LLC

A handwritten signature in black ink, appearing to read 'Johnny Baucum', with a long horizontal flourish extending to the right.

Johnny Baucum, Construction Administrator

Cc: Chuck Trimble, MGT
Andrea Bradford, MGT
Jim Leake, MGT
Baccus Oliver, Marcum Engineering

Date Issued: 03/03/2016

Murphy + Graves Project No. 1316

Project: LFUCG PSOC

Attachments: RFP Marcum Engineering

Issued by: Johnny Baucum via Andrea Bradford

Subject: Data Drops Communications Cabling Room 140

See attached RFP from Marcum Engineering.

Provide a proposal for the scope of work described in these documents, complete with breakdown.

PUBLIC SAFETY OPERATIONS CENTER
LEXINGTON FAYETTE URBAN COUNTY GOVERNMENT
LEXINGTON, KENTUCKY
MURPHY GRAVES TRIMBLE ARCHITECTS NO. 1316
MARCUM NO. 13618

MPE REQUEST FOR PROPOSAL

TO: Andrea Bradford, Murphy Graves Trimble

CC: Steve Cherry, Murphy Graves Trimble
Perry Warren, Murphy Graves Trimble
Jim Leake, Murphy Graves Trimble
Pat McFeely, Mission Critical Partners
Robert Lafaye, Mission Critical Partners
Jim Krebs, Mission Critical Partners
Baccus L. Oliver, Marcum Engineering

FROM: Johnny Baucum, Marcum Engineering

DATE: March 2, 2016

SUBJECT: REVISED RFP 6 – Communications Cabling Communications Room 140

RATIONALE:

Owner/MCP requested changes to the communications cabling in Communications Room 140.

INSTRUCTIONS:

The Contractor shall provide a proposal to make the following changes and additions. The Owner requested that approximately 66 data drops located in rooms 148, 150, 153, 154, 155, 132, 138, 139, F101A, F101B, 143 and 144; be terminated in a separate Cabinet (provided by LFUCG) located on the west side of Room 140 located in Row 2 Cabinet 1 (See Attached Layout). Two patch panels are required for these terminations. Relocate one 48 port patch panel from the data cabinet that was previously serving the drops.

The Contractor shall furnish and install one (1) additional 48 port patch panel in the newly designated data rack. The Contractor shall install the Owner furnished rack as well as furnish and install the rack mounted ground bar (RGB) and grounding connections in accordance with Construction Note 16 on Drawing E1.7.

ATTACHMENTS:

1. MCP Data Rack Layout

END OF DOCUMENT

Yellow line is chain link fence

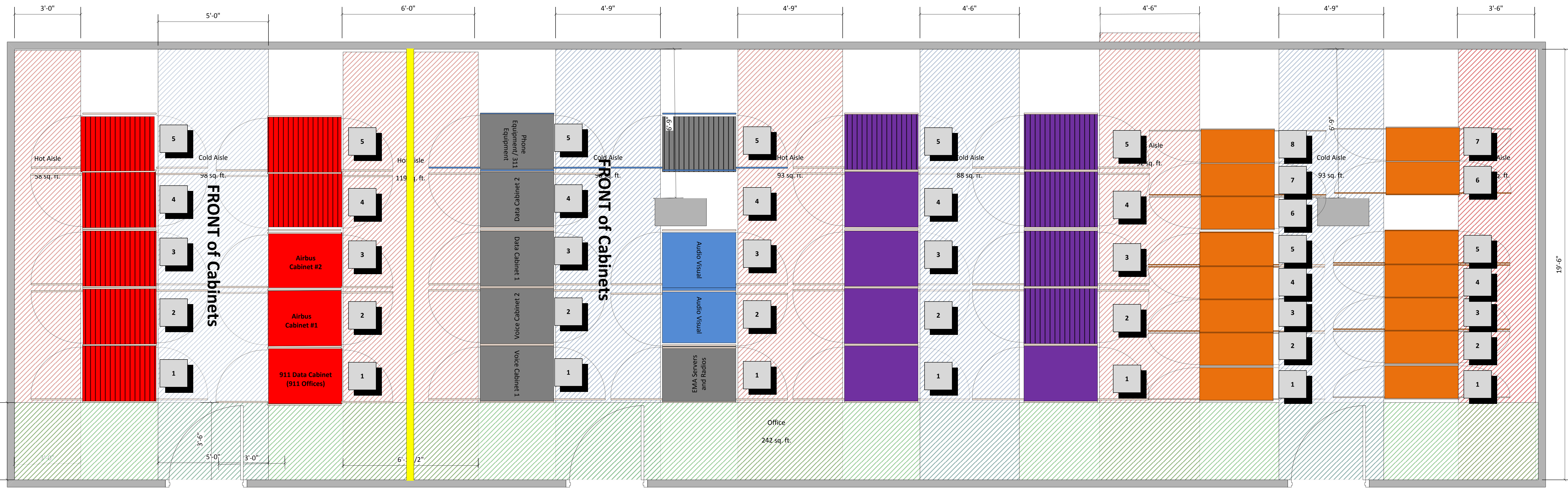

ROW #1 ROW #2 ROW #3 ROW #4 ROW #5 ROW #6 ROW #7 ROW #8

- Dispatch (Fire and PD)
- TMC Back-Up System
- Building Network (Voice and Data - including Dispatch)
- Building Audio Visual
- 7th Floor Equipment
- Future Use (Black is general)

Yellow: chain link fence.

3'-6"

19'-6"

30'-0"

30'-0"

Office
242 sq. ft.

Hot Aisle
58 sq. ft.

Cold Aisle
98 sq. ft.

Hot Aisle
119 sq. ft.

Cold Aisle
58 sq. ft.

Hot Aisle
93 sq. ft.

Cold Aisle
88 sq. ft.

Aisle
72 sq. ft.

Cold Aisle
93 sq. ft.

Aisle
41 sq. ft.

FRONT of Cabinets

FRONT of Cabinets

Phone Equipment/ 311 Equipment

Data Cabinet 2

Data Cabinet 1

Voice Cabinet 2

Voice Cabinet 1

EMA Servers and Rados

Audio Visual

Audio Visual

911 Data Cabinet (911 Offices)

Airbus Cabinet #1

Airbus Cabinet #2

1

2

3

4

5

1

2

3

4

5

1

2

3

4

5

1

2

3

4

5

1

2

3

4

5

6

7

8

1

2

3

4

5

6

7

1

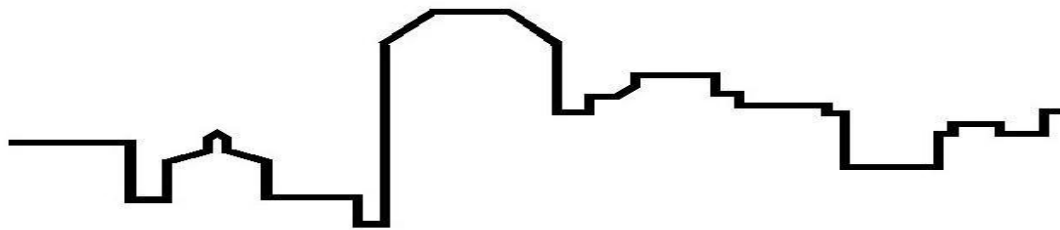

CHURCHILL McGEE, LLC

1315-C West Main Street
phone (859) 389-6976

Lexington, Kentucky 40508
fax (859) 389-6986

Change Order Proposal PR #50

Project: Public Safety Operations Center		4/1/2016
Project Number: MGT 1316		
You are authorizing us to perform the following additional work:		
Owner requested cabling changes in Communications room as per PR #50		
	Arrow	Total
Materials	\$821.63	\$821.63
Labor	\$880.21	\$880.21
Equipment		
Mark Up	\$255.28	\$255.28
Total		\$1,957.12
CM Mark up		\$195.71
Total		\$2,152.83
Total Change Order		\$2,152.83
We hereby authorize the above change order to be completed		
Additional work is to be performed under the same conditions as specified in the original contract unless stipulated otherwise.		
Date: _____		Owners Signature: _____
Churchill McGee LLC		
Date: _____		Authorized Signature: _____

NOTE: The above referenced change order revisions will only modify the original contract scope of work as specifically addressed in this change order. All other terms and conditions of the original contract will not change.



Change Proposal

Client Address:

Churchill McGee, LLC
 1315-C West Main Street
 Lexington, Kentucky 40508
 Telephone: (859) 389-6976
 Fax: (859) 389-6986
 Contact: Jeff Griffith

Ref #1 CE # 16
Date: 3/7/2016
Project Name: LFUCG Public Safety Operations Center
Project Number: 20-10-2109 LFUCG Public Safety Operations Center
Contract #: Dated Feb., 4th, 2015
Page Number: 1

Work Description

With Respect to PCO # 50, Arrow Electric offers the following for your consideration:

Provide changes and additions as described in PCO.
 Proposal is based on cables being long enough to re-route as described.
 Detailed breakdown attached.

We reserve the right to correct this quote for errors and omissions.

This quote covers direct costs only and we reserve the right to claim for impact and consequential costs.
 This price is good for acceptance within **10** days from the date of receipt.
 We request a time extension of **0** days.
 We will supply and install all materials, labor, and equipment as per your instructions on **PCO # 50**.

Item Description

Description	Qty	Total Mat.	Total Hrs.
SUBCONTRACTOR MATERIALS	1	821.63	0.00
SUBCONTRACTOR LABOR	1	880.21	0.00
Totals	2	1,701.84	0.00

Summary

MATERIAL		
Material Total		1,701.84
Markup	(@ 15.000 %)	255.28

Final Amount **\$1,957.12**

CLIENT ACCEPTANCE

CCN #: 16	_____
Final Amount: \$1,957.12	_____
Name:	_____
Date:	_____
Signature:	_____
Change Order #:	_____
I hereby accept this quotation and authorize the contractor to complete the above described work.	



Proposal for PR 50

At

LFUCG PSOC

Voitress will provide materials, labor, and testing for the following, all as per PR 50:

Re-route 70 cables, as outlined in PR 50 to cabinet in second row of MDF (Room 140).

One new patch panel, wire manager, and ground bus will be furnished and mounted in cabinet. Attaching ground bus grounding wire by others.

All of these cables were roughed in before this PR was issued. Quote is based on the cables being long enough to reach new cabinet.

Materials..... \$ 775.12

Tax..... \$ 46.51

Labor..... \$ 880.21

Total..... \$ 1,701.84

Labor breakdown is as follows:

Mount equipment..... 1 hour

Sort and re-route cables..70 cables @ 7 minutes each = 8.17 hours

Administration 1 hour

Total hours..... 10.17

For any questions, please contact:

Chuck Schweinhart

cschweinhart@voitress.com

888-955-5155 x115



April 8, 2016

Mr. Steve Cherry
Murphy Graves Trimble
3399 Tates Creek Road, STE 250
Lexington, KY 40502

Re: Proposal Review
MGT PR 50 – Communication Cabling Communications Room 140
Emergency Operations Center Phase 1B
Lexington Fayette Urban County Government
Lexington, Kentucky
Marcum No. 13618

Steve,

Marcum has reviewed Proposal Request 50 in the amount of \$2,152.83 and find it to be representative of the work requested and would recommend acceptance.

Please let me know if you have any questions.

Sincerely,

MARCUM ENGINEERING, LLC

A handwritten signature in black ink, appearing to read 'Johnny Baucum', with a long horizontal flourish extending to the right.

Johnny Baucum, Construction Administrator

Cc: Chuck Trimble, MGT
Andrea Bradford, MGT
Jim Leake, MGT
Baccus Oliver, Marcum Engineering

Date Issued: 04/01/2016

Murphy + Graves Project No. 1316

Project: LFUCG PSOC

Attachments: N/A

Issued by: Jim Leake via Andrea Bradford

Subject: Epoxy Flooring

Contractor to add manufacturer's specified clear coat and flake to all floors designed to receive epoxy coating in PR 41. For this PR, Contractor shall include corridor 105 and Corridor 103 from column line 7-11, Breakroom 149 and adjacent corridor C103. (Contractor shall refer to A8.0 where original epoxy coat was to be terminated in Corridor C103, per PR 41.

Provide a proposal for the scope of work described in these documents, complete with breakdown.

Jeff Griffith

From: Stacy Martina [stacy@martinabros.com]
Sent: Thursday, March 31, 2016 1:43 PM
To: jgriffith@churchillmcgee.com; Dino Martina; Mario Martina
Subject: LFUCG Cisco rd Decorative Mosaic Floor

Jeff

Revised Quote with large flakes

Material: \$8,844.00

Labor: \$11,792.00

Total: \$20,636.00

Quote for ramps and added area

Material: \$3,000.00

Labor: \$4,000.00

Total: \$7,000.00

Respectfully submitted

Stacy Martina
Martina Bros.Co.,Inc.
(859)255-3602