

**LEXINGTON-FAYETTE URBAN COUNTY
GOVERNMENT CONTRACT CHANGE ORDER**
Page 1 of 2

Date:	May 19, 2016
Project:	Senior Citizen Center Construction
Location:	Lexington
Contract No	227-2014
Original Contract Amt.	\$8,882,900.00
Cumulative Amount of Previous Change Orders	\$1,455,536.37
Percent Change - Previous Change Orders	16.39%
Total Contract Amount Prior to this Change Order	\$10,338,436.37
Change Order No.	43

To (Contractor):
Marrillia Design & Construction
259 West Short Street
Suite 325
Lexington, KY 40507

You are hereby requested to comply with the following changes from the contract plans and specification;

Current Change Order

Item No.	Description of changes-quantities, unit prices, change in completion date, etc.	Decrease in contract price	Increase in contract price
1	Modify detention basin per ASI 91		\$1,801.00
2	Extend soffit across north flight of west stair per PR 73		\$930.00
3	Install 1" PVC water line for Park exterior drinking fountain per PR 44		\$16,629.00
4	Rock excavation allowance for line #3 to be paid for on a T&M basis if needed		\$4,067.00
	Total decrease	\$0.00	
	Total increase		\$23,427.00
	Net Amount of this Change Order	\$23,427.00	
	New Contract Amount Including this Change Order	\$10,361,863.37	
	Percent Change - This Change Order		0.26%
	Percent Change - All Change Orders		16.65%

The time provided for the completion in the contract and all provisions of the contract will apply hereto.

Recommended by <i>Joyce Thomas</i>	(Project Manager)	Date <i>5/19/16</i>
Accepted by <i>John Marrillia</i>	(Contractor)	Date <i>5/19/16</i>
Approved by <i>[Signature]</i>	(Director)	Date <i>5-19-16</i>
Approved by <i>[Signature] (for Comm Recd)</i>	(Commissioner)	Date <i>5-19-16</i>
Approved by <i>[Signature]</i>	(Mayor or CAO)	Date <i>5-19-16</i>

R-602-2014
Original: R-548-2014
Contract #: 227-2014

JUSTIFICATION FOR CHANGE

PROJECT: Senior Citizen Center Construction

CONTRACT NO. 227-2014

CHANGE ORDER NO. 43

1. Necessity for change: It was discovered that Columbia Gas holds an easement in the vicinity of the planned detention basin. This easement was not reflected on the site survey. CG is not allowing this easement to be encroached upon necessitating a change in the basin design. Soffit in west stair is needed to conceal exposed steel. The water line for the Parks drinking fountain was affected during Senior Center design/construction and is being replaced. A separate allowance is provided for rock excavation to be billed on a T&M basis if needed.
2. Is proposed change an alternate bid? ___ Yes X No
3. Will proposed change alter the physical size of the project? ___ Yes X No
If "Yes", explain.
4. Effect of this change on other prime contractors: N/A
5. Has consent of surety been obtained? ___ Yes X Not Necessary
6. Will this change affect expiration or extent of insurance coverage? ___ Yes X No
If "Yes", will the policies be extended? ___ Yes ___ No
7. Effect on operation and maintenance costs:
8. Effect on contract completion date: 0 working days

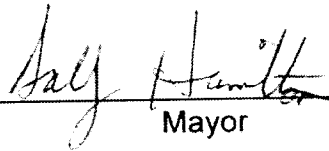

Mayor

5-19-16

Date



Lexington-Fayette Urban County Government
DEPARTMENT OF GENERAL SERVICES

TRANSMITTAL

Date: May 19, 2016

Contract Number: 227-2014

Purchase Order Number: LF00120278

Bid Package Number: 99-2014

Capital Project Number: TBD

Work Order Number: N/A

Building: Senior Citizen Center

Project Description: Replacement Senior Citizen Center Construction

To: Josh Marrillia, Marrillia Design & Construction RE: Change Order #43 fully executed

CC: Harding Dowell, EOP Architects
Sharon Jones, Deputy Council Clerk
Trina Brown [2600-606101-6001-90511 SR_CITZN2_2015]

From: Joyce Thomas, General Services *JT*

We Are Sending You:

Contract

Operation and Maintenance Manuals

Warranties

Change Order

Payment Application

Plans

Item	Copies	Description	Pages	Date
1.	1	Change Order #43 fully executed	21	5/19/2016

THESE ARE TRANSMITTED AS INDICATED BELOW:

FOR APPROVAL

FOR ACTION (Trina Brown)

FOR YOUR USE

FOR FILE

FOR YOUR REVIEW AND COMMENT

FOR SIGNATURE

OTHER:

REPLY BY _____ TO AVOID DELAY IN CONSTRUCTION

Remarks:



Alternates
 LFUCG Replacement Senior Citizen Center
 Lexington, KY

4/27/2016
 4:52 PM

Pending Owner Approval

PR-83 Complete the Detention Basin Design Modifications per ASI No. 91 - Revision #1

Complete the Detention Basin Design Modifications per ASI No. 91

Complete the Detention Basin Design Modifications per ASI No. 91 - Croucher Excavating
 Additional Construction Staking - Endris Engineering

Quantity	Units	Hr	Rate	Labor	UP	Materials	Subcontractor	Total
1	1S				1286.00		1,200	
1	1S				350.00		350	
			0				1,550	1,550

Cost of In-Place Construction (Labor, Materials and Equipment) = 1,550

Marrilla Design and Construction Overhead Percentage =	10.0%
Overhead - Marrilla Design and Construction =	155
Marrilla Design and Construction Profit Percentage =	5.0%
Profit - Marrilla Design and Construction =	78
General Liability Insurance (Construction) =	2
Builder's Risk Insurance =	2
Performance and Payment Bond (Rate of \$9.40 per \$1000 of Cost for \$0 - \$2,500,000) =	N/A
Performance and Payment Bond (Rate of \$8.15 per \$1000 of Cost for \$2,500,000 - \$5,000,000) =	N/A
Performance and Payment Bond (Rate of \$7.20 per \$1000 of Cost for \$5,000,000 and up) =	12
KY Surcharge on Project Bonds (1.8% of Bond Cost) =	0
Local Municipality Tax on Project Bonds (.5% of Bond Cost) =	4
Total Construction Cost =	1,831



ASI Transmittal

ASITRANSMITTAL

EOP Architects - 201 W. South St. Suite 700 Lexington MA 01845 United States

PROJECT	LFUCG Senior Citizens' Center 201333	DATE SENT	4/22/2016
SUBJECT	Revision to Detention Basin	ASI ID	ASI-091
TYPE	ASI	TRANSMITTAL ID	00970
PURPOSE	For Construction	VR	Info Exchange

FROM

NAME	COMPANY	EMAIL	PHONE
Harding Dowell	EOP Architects	hdowell@eopa.com	(859) 231-7538

TO

NAME	COMPANY	EMAIL	PHONE
Travis Harris	Marrillia Design and Construction	tharris@marrillia.com	

REMARKS

Created by: Harding Dowell
Description:

To avoid the high pressure gas line easement, please revise grading for the detention basin as described in the attached sketch.

ES-22-04-01-01-01-01

NO.	DATE	DESCRIPTION
1	4/22/2016	ASI-091- Element- Sketch.pdf

ASI Transmittal

DATE

4/22/2016

IF

00970

COPIES

Brian Gravitt	(Marrillia Design and Construction)
Jim Hayes	(Marrillia Design and Construction)
Jim Martin	(Marrillia Design and Construction)
Josh Marrillia	(Marrillia Design and Construction)
Rob Price	(Marrillia Design and Construction)
Jessica Walker	(LFUCG)
Joyce Thomas	(LFUCG)
Martin Woodford	(LFUCG)
Ramona Fry	(Element Design)
Vaughan Adkins	(Element Design)

A

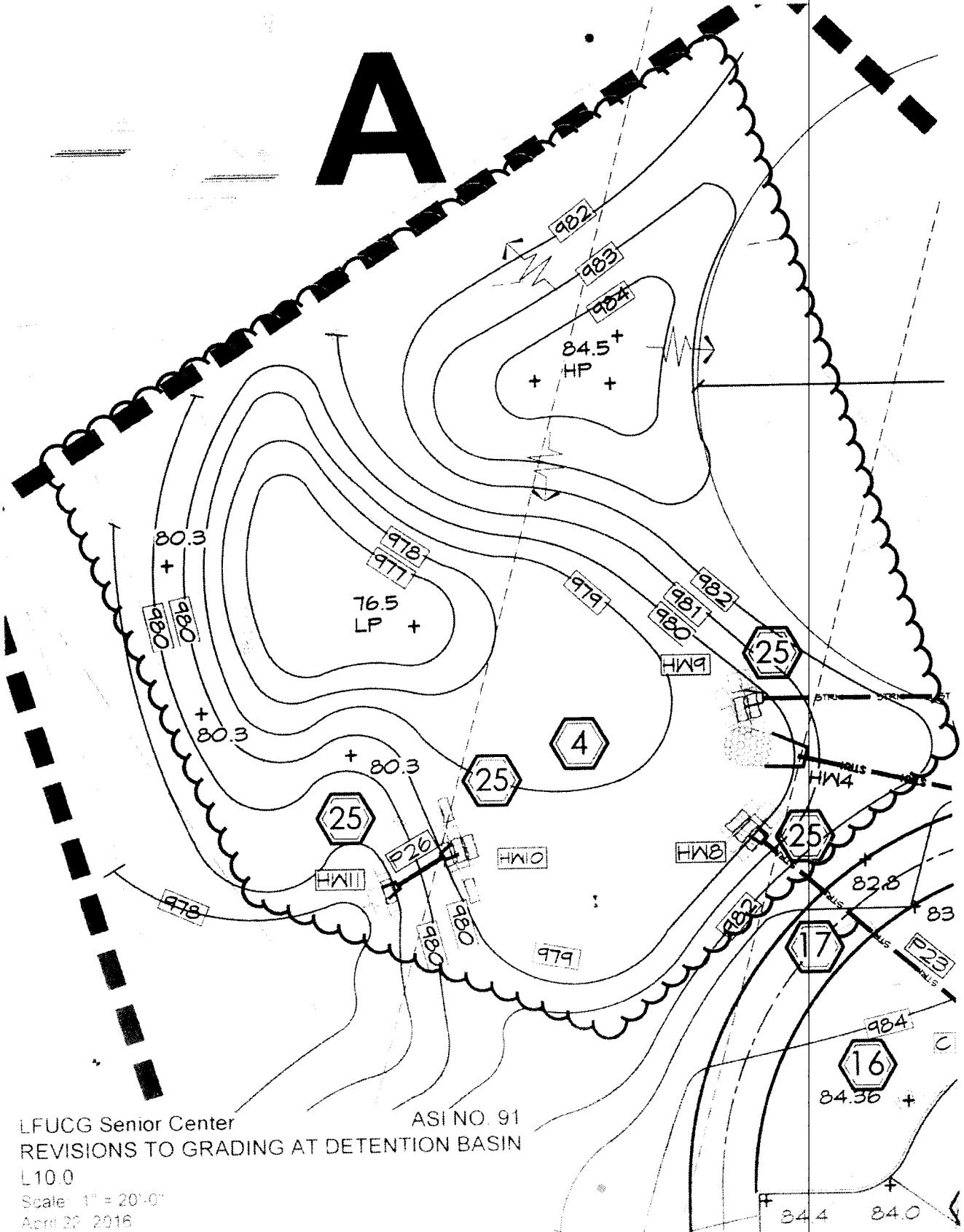

LFUCG Senior Center
REVISIONS TO GRADING AT DETENTION BASIN
L10.0
Scale: 1" = 20'-0"
April 22, 2016

ASI NO. 91

Croucher Excavating

606-308-3843

Senior Center

Lexington Ky

ASI-91 Revisions to Detention Basin

ASI-91 Revisions to Detention Basin

- \$1,200 to remobilize and execute.
 - Per Design this has been negotiated with Columbia Gas and the gas line is no longer an issue.

Thank you

Joe Croucher

Croucher Excavating

ENDRIS ENGINEERING, P.S.C.

Land Surveyors

771 Enterprise Drive
Lexington, Kentucky 40510

Ph. (859) 255-1455
Fax (859) 255-1456

April 27, 2016

Travis Harris
Marrillia Design and Construction
259 West Short Street, Suite 325
Lexington, Kentucky 40507
Tel 859-685-0414
Fax 859-685-0418
Mobile 859-519-7306

Re: Lexington Senior Center - Idle Hour - Lexington, KY

Travis,

Based on the grading plan and utility plan information you provided on Thursday, Endris Engineering offers the following estimates for construction layout:

Estimated Project Layout Fees

Calculate stakeout points for revised pond:
Stake revised ponds (one trip):

\$80⁰⁰
\$270⁰⁰

All staking and re-staking of these items and any additional items will be done at hourly rates listed below. The estimates above are for project budgeting only.

Hourly Rates:

Registered Land Surveyor:	\$90 ⁰⁰ per hour
2-Man Survey Crew (or 1-man with Robotic instrument):	\$120 ⁰⁰ per hour
3-Man Survey Crew (or 2-man with Robotic instrument):	\$145 ⁰⁰ per hour
Cad (layout calculations):	\$80 ⁰⁰ per hour

(The only time a "Land Surveyor" rate would apply would be in some sort of true boundary or plat issue, or for pad/layout certifications - i.e. not normal construction layout.)

A majority of the time, we will use a three-man crew since we are about 50% more efficient with that type of crew as compared to a two-man-crew. Time sheets are to be signed by the site superintendent each day the survey crew is on site that will detail field time only.

A copy of Endris Engineering's Standard Terms and Conditions is attached and made a part of this rate proposal. Thanks for the opportunity to provide these rates to you.

Thanks for the opportunity to provide these rates to you.

Sincerely,

Kevin M. Phillips, PLS
President

Terms and Conditions

Endris Engineering shall perform the services outlined in this agreement for the stated fee arrangement.

Access To Site:

Unless otherwise stated, Endris Engineering will have access to the site for activities necessary for the performance of the services. Endris Engineering will take precautions to minimize the damage due to these activities, but has not included in the fee the cost of restoration of any resulting damage.

Dispute Resolution:

Any claims or disputes made during design, construction or post-construction between the Client and Firm shall be submitted to non-binding mediation. Client and Firm agree to include a similar mediation agreement with all contractors, subcontractors, subconsultants, suppliers and fabricators, thereby providing for mediation as the primary method for dispute resolution between all parties.

Billing & Payments:

Invoices for Endris Engineering's services shall be submitted, at Endris Engineering's option, either upon completion of such services or on a monthly basis. Invoices shall be payable within 30 days after the invoice date. If the invoice is not paid within 30 days, Endris Engineering may, without waiving any claim or right against the Client, and without liability whatsoever to the client, terminate the performance of the service. Retainers shall be credited on the final invoice.

Late Payments:

Accounts unpaid 60 days after the invoice date may be subject to a monthly service charge of 1.5% (or the legal rate) on the then unpaid balance. In the event any portion or all of an account remains unpaid 90 days after billing, the Client shall pay all costs of collection, including reasonable attorney's fees.

Indemnification:

The Client shall, to the fullest extent permitted by law, indemnify and hold harmless Endris Engineering, his or her officers, directors, employees, agents and subconsultants from and against all damage, liability and cost, including reasonable attorney's fees and defense costs, arising out of or in any way connected with the performance by any of the parties above named of the services under this agreement, excepting only those damages, liabilities or costs attributable to the sole negligence or willful misconduct of Endris Engineering.

Certifications:

Guarantees and Warranties: Endris Engineering shall not be required to execute any document that would result in its certifying, guaranteeing or warranting the existence of conditions whose existence Endris Engineering cannot ascertain.

Limitations of Liability:

In recognition of the relative risk, rewards and benefits of the project to both the Client and Endris Engineering, the risks have been allocated such that the Client agrees that, to the fullest extent permitted by law, Endris Engineering's total liability to the Client for any and all injuries, claims, losses, expenses, damages or claim expenses arising out of this agreement from any cause or causes, shall not exceed \$100,000.00. Such causes include, but are not limited to, Endris Engineering's negligence, errors, omissions, strict liability, breach of contract or breach of warranty.

Termination of Services:

This agreement may be terminated by the Client or Endris Engineering should the other fail to perform its obligations hereunder. In the event of termination, the Client shall pay Endris Engineering for all services rendered to the date of termination, all reimbursable expenses, and reimbursable termination expenses.

Ownership of Documents:

All documents produced by Endris Engineering under this agreement shall remain the property of Endris Engineering, PSC until payment-in-full has been received by Endris Engineering at which time, all documents shall become the property of the Client.

Initial here: KE (Endris Engineering) _____ (Client)

THIS SHEET MUST BE INITIALED AND RETURNED TO OUR OFFICE BEFORE COMMENCEMENT OF WORK.



Alternates
 LFUCG Replacement Senior Citizen Center
 Lexington, KY

5/11/2016
 10:12 AM

Pending Owner Approval

PR-85 Extend a Soffit Across the North Flight of the West Stair per Proposal Request No. 73

Extend a Soffit Across the North Flight of the West Stair per Proposal Request No. 73

- Framing/Drywall to Construct Soffit - Bennet's Carpets
- Painting of the New Soffit - Simpson & Co.

Quantity	Units	Hr.	Rate	Labor	UP	Materials	Subcontractor	Total
	1	ls			700.00		700	
	1	ls			100.00		100	
				0		0	800	800

Cost of In-Place Construction (Labor, Materials and Equipment) =	800
Marrillia Design and Construction Overhead Percentage =	10.0%
Overhead - Marrillia Design and Construction =	80
Marrillia Design and Construction Profit Percentage =	5.0%
Profit - Marrillia Design and Construction =	40
General Liability Insurance (Construction) =	1
Builder's Risk Insurance =	1
Performance and Payment Bond (Rate of \$9.40 per \$1000 of Cost for \$0 - \$2,500,000) =	14.4
Performance and Payment Bond (Rate of \$8.15 per \$1000 of Cost for \$2,500,000 - \$5,000,000) =	14.4
Performance and Payment Bond (Rate of \$7.20 per \$1000 of Cost for \$5,000,000 and up) =	7
KY Surcharge on Project Bonds (1.8% of Bond Cost) =	0
Local Municipality Tax on Project Bonds (5% of Bond Cost) =	0
Total Construction Cost =	930



Proposal Request Transmittal

EOP Architects | 201 W. Summit St. Suite 700 Lexington KY 40507 United States

PROJECT	LFUCG Senior Citizens' Center 201333	DATE SENT	4/21/2016
SUBJECT	Soffit at West Stair	PROPOSAL REQUEST ID	PR-073
TYPE	Proposal Request	TRANSMITTAL ID	00961
PURPOSE	For Review and Response	IFA	Info Exchange

FROM

NAME	COMPANY	EMAIL	PHONE
Harding Dowell	EOP Architects	hdowell@eopa.com	(859) 231-7538

TO

NAME	COMPANY	EMAIL	PHONE
Travis Harris	Marrillia Design and Construction	tharris@marrillia.com	

REMARKS

Created by: Harding Dowell

Description:

Please provide pricing to extend a soffit across the north flight of the west stair. Please refer to the attached annotated photograph for extents of soffit and alignments to existing work.

Thanks,

Harding

Proposal Request Transmittal

DATE:
ID:

4/21/2016
00961

DESCRIPTION OF CONTENTS

QTY	DATED	TITLE	NUMBER	SCALE	SIZE	NOTES
1	4/21/2016	160421_PR- 073_SKETCH.pdf				

COPIES:

Brian Gravitt	(Marrillia Design and Construction)
Jim Martin	(Marrillia Design and Construction)
Josh Marrillia	(Marrillia Design and Construction)
Rob Price	(Marrillia Design and Construction)
Jessica Walker	(LFUCG)
Joyce Thomas	(LFUCG)
Martin Woodford	(LFUCG)

FINISH GWB AS DRAWN
AT JOINT W/ STEEL.
PAINT STEEL TO MATCH
OTHER STRINGERS

EXTEND GWB SOFFIT ACROSS
OPENING W/ METAL FRAMING.
ALIGN TO FACE AND TOP OF
COLUMN WRAP, FINISH TOP,
BOTTOM AND SIDES

ALIGN BOTTOM OF
SOFFIT WITH BOTTOM
OF EXISTING SOFFIT



Bennett's Carpets, Inc.
 149 Steve Drive
 Russell Springs, KY 42642
 (270) 866-6930
 Fax (270) 866-6200

QUOTATION • PROPOSAL

TO:	Marrilla	DATE:	04/28/16
ATT:	Travis		
RE:	Lexington Senior Citizens PR 073		

Description of Work: We hereby submit this estimate for furnishing and installing the following in accordance with plans and specifications including insurance:

TO add or extend soffit in west stair \$700.00

Total Quotation \$

Note: This quotation will become void if not accepted within 30 days.

We include no demolition unless stipulated. Reggie Roy

Acceptance: _____ Date: ___/___/___

Company/Title: _____

This Quotation/Proposal is to become a part of the contract documents. Payment to be made within 30 days from billing date with retainage held only as a part of original documents and previously agreed. Payment in full within 30 days upon completion and acceptance of this project.

Joyce Thomas

From: Harding Dowell <hdowell@eopa.com>
Sent: Wednesday, May 18, 2016 2:37 PM
To: Joyce Thomas
Cc: Jessica Walker; Martin Woodford
Subject: FW: Senior Center: PR Details Needed

Hi Joyce,

Travis has provided further information on both PR-044 and PR-073:

- Rock removal allowance of \$3,500. I've asked Marrillia to provide an updated top sheet to their proposal.
- Breakdown of framing/drywall work is as follows:
 - Reset scaffold-\$200
 - Remove installed materials and refinish \$300
 - Bennett's Framing Labor \$100
 - Materials \$100

Please let me know if you have additional questions.

Thanks,

Harding

J Harding Dowell, AIA
Associate



EOP Architects

LEXINGTON • LOUISVILLE

t: 859-231-7538 | m: 859-797-5515

[For more information, visit the new EOPA.COM](http://www.eopa.com)



From: Travis Harris [<mailto:tharris@marrillia.com>]
Sent: Wednesday, May 18, 2016 2:23 PM
To: Harding Dowell <hdowell@eopa.com>
Subject: RE: Senior Center: PR Details Needed

Hi Travis,

There are a few outstanding items delaying owner approval of submitted PR pricing:

- PR-044: allowance amount for rock removal by Croucher
Per JCroucher and TECO add \$3500.00 Allowance if rock is encountered which our O&P will be added if we do encounter. We will record and notify LFUCG if and when rock is encountered.
- PR-073: breakdown of framing/drywall price (material, labor, equipment) by Bennett's
Reset scaffold \$200
Remove installed materials and refinish \$300

Bennett's Framing Labor \$100
Materials \$100

From: Harding Dowell [mailto:hdowell@eopa.com]
Sent: Wednesday, May 18, 2016 12:03 PM
To: Travis Harris <tharris@marrillia.com>
Subject: Senior Center: PR Details Needed

Hi Travis,

There are a few outstanding items delaying owner approval of submitted PR pricing:

- PR-044: allowance amount for rock removal by Croucher
- PR-073: breakdown of framing/drywall price (material, labor, equipment) by Bennett's

Joyce would like to bundle these with PR-078 and get it released as soon as possible. Please provide this information today if possible.

Thanks,

Harding

J Harding Dowell, AIA
Associate



EOP Architects

LEXINGTON • LOUISVILLE

t: 859-231-7538 | m: 859-797-5515

For more information, visit the new EOPA.COM



[Submit Spam](#)



Alternates
 LFUCG Replacement Senior Citizen Center
 Lexington, KY

5/19/2015
 10:28 AM

Pending Owner Approval

PR-84 Install Additional 1" PVC Site Water Line for the Outdoor Drinking Fountain per Proposal Request No. 44 - Revision #2

Install Additional 1" PVC Site Water Line for the Outdoor Drinking Fountain per Proposal Request No. 44

- 1" PVC Site Water Line (Materials, Excavation*, Equipment, Etc.) - TECO Mechanical
- Sodding/Seeding of Disturbed Areas - Landesign
- Remove and Re-Install Fencing - Marrillia BUDGET
- Rock Excavation Allowance - Croucher Excavating/TECO Mechanical

Quantity	Units	Hr.	Rate	Labor	UP	Materials	Subcontractor	Total
	1	ls				11,852.00		11,852
	1	ls				1,957.50		1,958
	1	ls				500.00		500
	1	ls			See Below		See Below	
								14,310

Cost of In-Place Construction (Labor, Materials and Equipment) =	14,310
Marrillia Design and Construction Overhead Percentage =	10.0%
Overhead - Marrillia Design and Construction =	1,431
Marrillia Design and Construction Profit Percentage =	5.0%
Profit - Marrillia Design and Construction =	715
General Liability Insurance (Construction) =	20
Builder's Risk Insurance =	23
Performance and Payment Bond (Rate of \$9.40 per \$1000 of Cost for \$0 - \$2,500,000) =	N/A
Performance and Payment Bond (Rate of \$8.15 per \$1000 of Cost for \$2,500,000 - \$5,000,000) =	N/A
Performance and Payment Bond (Rate of \$7.20 per \$1000 of Cost for \$5,000,000 and up) =	119
KY Surcharge on Project Bonds (1.8% of Bond Cost) =	2
Local Municipality Tax on Project Bonds (5% of Bond Cost) =	6
Sub-Total (See Below for Rock Allowance) =	16,629
Rock Excavation Allowance =	4,067
Total Construction Cost =	20,696



architecture | interiors

Proposal Request Transmittal

EOP Architects | 201 W Short St Suite 700 Lexington KY 40507 United States

PROJECT	LFUCG Senior Citizens' Center 201333	DATE SENT	12/4/2015
SUBJECT	Water Line for Outdoor Drinking Fountain	PROPOSAL REQUEST ID	PR-044
TYPE	Proposal Request	TRANSMITTAL ID	00764
PURPOSE	For Review and Response	VIA	Info Exchange

FROM

NAME	COMPANY	EMAIL	PHONE
Harding Dowell	EOP Architects	hdowell@eopa.com	(859) 231-7538

TO

NAME	COMPANY	EMAIL	PHONE
Travis Harris	Marrillia Design and Construction	tharris@marrillia.com	

REMARKS:

Created by: Harding Dowell
Description:

Please provide pricing to establish a new connection from the private water line to the existing outdoor drinking fountain, as described in the enclosed sketch. Notes on the work include:

- Existing valve box near the corner of the pickleball court is too deep to be serviceable. Connection is to be abandoned.
- Existing damaged water line to be abandoned in place, except where removal is required to complete other work in the contract.
- New valve box, piping, and other associated structures shall be installed per the original contract documents (see sheet C2.0)
- Please provide pricing breakdown, including materials and labor (w/

elementdesign

C1.0, PR 044

C1.0

DATE: JAN 27 2018
PROJECT: SENIOR CENTER
DRAWN BY: [unreadable]
CHECKED BY: [unreadable]

LEXINGTON SENIOR CENTER

195 LIFE LANE LEXINGTON, KY 40502

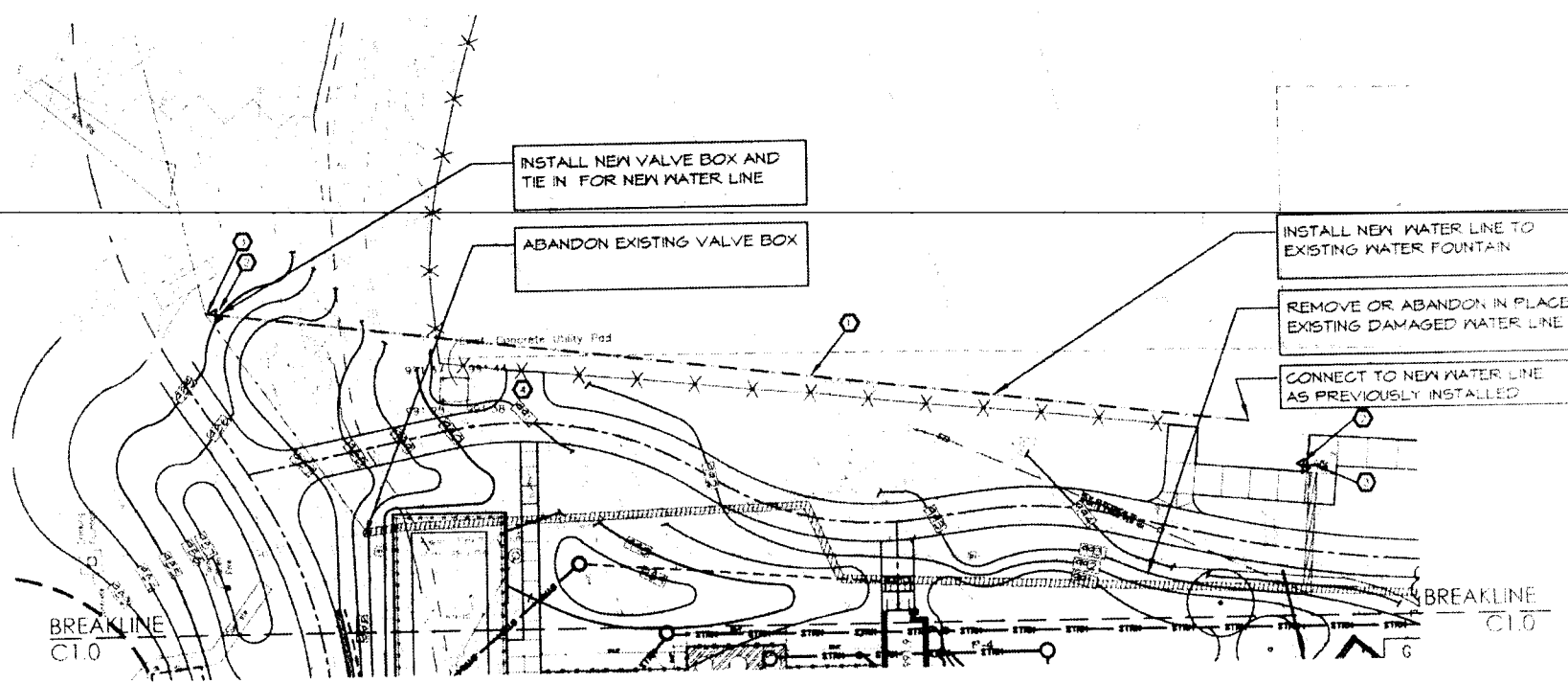
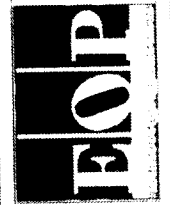

CIVIL UTILITY LEGEND

- WAT — PROPOSED POTABLE WATER LINE
- VALVE - SEE PLAN & KEYNOTE #4
- CE CONCRETE ENCASEMENT
- TB CONCRETE THRUST BLOCK (REFER TO A/C2.0)
- WATER LINE TO BE REMOVED/ OR CAPPED IN PLACE

SENIOR CENTER CIVIL SHEET NOTES:

- ① PROVIDE 1" PVC WATER LINE. REFER TO DETAIL C, SHEET C2.0 PROVIDE TRACER WIRE.
- ② PROVIDE GATE VALVE. REFER TO DETAIL D, SHEET C2.0.
- ③ CONNECT TO EXISTING PRIVATE WATER SERVICE LINE.
- ④ BACKFILL TRENCH IN THIS LOCATION WITH DGA TO PROTECT LINE PRIOR TO INSTALLATION OF NEW ACCESS DRIVE.

WATER PLAN
SCALE: 1" = 30'-0"



TECO

MECHANICAL CONTRACTOR, INC.

837 FLOYD DRIVE
LEXINGTON, KY 40505
PHONE (859) 255-6893

P.O. BOX 5043
LEXINGTON, KY 40505
FAX (859) 233-3430

April 27, 2016

Marrillia Design & Construction
259 West Short Street, Suite 325
Lexington, Kentucky 40507
Attn.: Josh Marrillia

Re: **Lexington Senior Center - PR 044 Addition to PR012 Cost to Install Additional 1" PVC Site Water Line.**

Josh,

We offer the following cost to install additional 1" PVC site water line, as requested:

MATERIAL:

190 ft - 1" PVC PIPE & FITTINGS
1 - 1" Tap Connection to existing 2" piping

MATERIAL SUBTOTAL \$ 1,606.00
6% SALES TAX \$ 96.00

LABOR: 40 HOURS \$ 3,400.00

CROUCHER TO LOCATE EXISTING UTILITIES,
EXCAVATE, BACKFILL & HAUL OFF SPOILS \$ 6,750.00

PR 044 \$ 11,852.00 ←

PR 012 \$ ~~7,253.00~~

COMBINED TOTAL PR 044 & PR 012 \$ 19,105.00.

Price does not include removal of existing water lines, seed, straw, or sod, rock excavation or replacing asphalt.

If you have any questions, or require further assistance, please call

Scott Hedger

Project Manager

Travis Harris

From: Ryan Parsons <ryan@landesignky.com>
Sent: Thursday, April 14, 2016 10:14 AM
To: Travis Harris
Subject: Re: PR-44 Sod Pricing

270 sq yds.
with soil and placement

\$1957.50

On Thu, Apr 14, 2016 at 9:55 AM, Travis Harris <tharris@marrillia.com> wrote:

Ryan

I need the pricing.

Travis Harris

Site Manager
Marrillia Design and Construction
259 West Short Street, Suite 325
Lexington, Kentucky 40507
Tel [859.685.0414](tel:859.685.0414)
Fax [859.685.0418](tel:859.685.0418)

Cell [859.200.9732](tel:859.200.9732)

Web www.marrillia.com

Email tharris@marrillia.com

