

LEXINGTON-FAYETTE URBAN COUNTY GOVERNMENT CONTRACT CHANGE ORDER Page 1 of 2		Date:	June 10, 2016
		Project:	Senior Citizen Center Constructio
		Location:	Lexington
To (Contractor): Marrillia Design & Construction 259 West Short Street Suite 325 Lexington, KY 40507		Contract No.	227-2014
		Original Contract Amt.	\$8,882,900.00
		Cumulative Amount of Previous Change Orders	\$1,505,849.37
		Percent Change - Previous Change Orders	16.95%
		Total Contract Amount Prior to this Change Order	\$10,388,749.37
		Change Order No.	47
You are hereby requested to comply with the following changes from the contract plans and specification;			
<b>Current Change Order</b>			
Item No.	Description of changes-quantities, unit prices, change in completion date, etc.	Decrease in contract price	Increase in contract price
1	Furnish and install a new fireplace hearth, surround, and mantel per PR 083		\$6,988.00
	Total decrease	\$0.00	
	Total increase		\$6,988.00
	Net Amount of this Change Order	\$6,988.00	
	New Contract Amount Including this Change Order	\$10,395,737.37	
	Percent Change - This Change Order		0.08%
	Percent Change - All Change Orders		17.03%
The time provided for the completion in the contract and all provisions of the contract will apply hereto.			
Recommended by	<i>Joyce Suras</i>	(Project Manager)	Date 6/10/16
Accepted by	<i>John Marrillia</i>	(Contractor)	Date 6/13/16
Approved by	<i>[Signature]</i>	(Director)	Date 6-13-16
Approved by	<i>[Signature] for Comm Rec</i>	(Commissioner)	Date 6-13-16
Approved by	<i>Dale Smith</i>	(Mayor or CAO)	Date 6/10/16

**JUSTIFICATION FOR CHANGE**

PROJECT: Senior Citizen Center Construction

CONTRACT NO. 227-2014

CHANGE ORDER NO. 47

1. Necessity for change: By Owner request.
  
2. Is proposed change an alternate bid? \_\_\_ Yes  X  No
3. Will proposed change alter the physical size of the project? \_\_\_ Yes  X  No  
If "Yes", explain.
  
4. Effect of this change on other prime contractors: N/A
  
5. Has consent of surety been obtained? \_\_\_ Yes  X  Not Necessary
6. Will this change affect expiration or extent of insurance coverage? \_\_\_ Yes  X  No  
If "Yes", will the policies be extended? \_\_\_ Yes \_\_\_ No
7. Effect on operation and maintenance costs: N/A
  
8. Effect on contract completion date: 0 working days

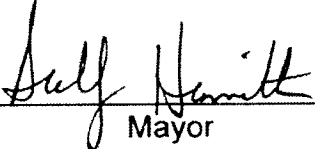
  
\_\_\_\_\_  
Mayor

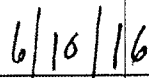
  
\_\_\_\_\_  
Date



**Alternates**  
 LFUCG Replacement Senior Citizen Center  
 Lexington, KY

6/10/2016  
 12:32 PM

Pending Owner Approval

**PR-95 Remove the Existing Fireplace Surround and Hearth and Install a Stone Surround, Hearth and Mantle Install per Proposal Request No. 83**

Remove the Existing Fireplace Surround and Hearth and Install a Stone Surround, Hearth and Mantle Install per Proposal Request No. 83

	Quantity	Units	Hr.	Rate	Labor	U/P	Materials (Sales Tax Added Below)	Subcontractor	Total	
Removal of Existing Fireplace Surround and Hearth - Marrilia	1	ls					500.00	500		
Stone Surround, Hearth and Mantle Install (materials) - Mantels Direct	1	ls					3,314.20	3,314		
Labor and Setting Materials to Complete the Installation - Martina Bros. Co., Inc.	1	ls					1,500.00	1,500		
<del>Touch-up and Re-Finish Drywall Around the New Surround and Mantle - Bennett's Carpets</del>	1	ls					500.00	500		
Painting Touch-up at the New Fireplace Mantle and Surround - Simpson & Co.	1	ls					No Charge	No Charge		
							0	3,513	2,500	6,013

Cost of In-Place Construction (Labor, Materials and Equipment) =	6,013
Marrilia Design and Construction Overhead Percentage =	10.0%
Overhead - Marrilia Design and Construction =	601
Marrilia Design and Construction Profit Percentage =	5.0%
Profit - Marrilia Design and Construction =	301
General Liability Insurance (Construction) =	11
Builder's Risk Insurance =	10
Performance and Payment Bond (Rate of \$9.40 per \$1000 of Cost for \$0 - \$2,500,000) =	N/A
Performance and Payment Bond (Rate of \$8.15 per \$1000 of Cost for \$2,500,000 - \$5,000,000) =	N/A
Performance and Payment Bond (Rate of \$7.20 per \$1000 of Cost for \$5,000,000 and up) =	50
KY Surcharge on Project Bonds (1.8% of Bond Cost) =	1
Local Municipality Tax on Project Bonds (5% of Bond Cost) =	2
<b>Total Construction Cost =</b>	<b>6,988</b>



ARCHITECTURE DESIGNERS

## Proposal Request Transmittal

EOP Architects | 201 W Short St Suite 700 Lexington KY 40507 United States

PROJECT	LFUCG Senior Citizens' Center 201333	DATE SENT	6/8/2016
SUBJECT	Fireplace Mantel	PROPOSAL REQUEST ID	PR-083
TYPE	Proposal Request	TRANSMITTAL ID	00992
PURPOSE	For Review and Response	VIA	Info Exchange

### FROM

NAME	COMPANY	EMAIL	PHONE
Harding Dowell	EOP Architects	hdowell@eopa.com	(859) 231-7538

### TO

NAME	COMPANY	EMAIL	PHONE
Travis Harris	Marrillia Design and Construction	tharris@marrillia.com	

### REMARKS:

**Created by: Harding Dowell**  
Description:

Please furnish and install a new fireplace hearth, surround, and mantel as indicated in the attached sketch. Specifications are as follows:

- Mantel model to be MantelsDirect York Majestic Series Stone Fireplace Mantel.  
([http://www.mantelsdirect.com/cast\\_stone/majestic\\_series/york-stone-fireplace-mantel.html?pn=1\\_2#targettabs](http://www.mantelsdirect.com/cast_stone/majestic_series/york-stone-fireplace-mantel.html?pn=1_2#targettabs))
- Provide matching surround and hearth by MantelsDirect. Refer to sketch for sizing, confirm with manufacturer.
- Mantel, surround, and hearth finish shall be Buff-Natural Stone.

# Proposal Request Transmittal

DATE:

6/8/2016

ID:

00992

In order to expedite fabrication and shipping, the order for the fireplace mantel, surround, and hearth **must** be made by Friday, June 10. Refer to the attached blank Estimate sheet for manufacturer contact information (Rodney Gifford is the project's sales rep, and is expecting your call)

The currently installed fireplace surround and hearth shall be removed. Any damaged drywall shall be repaired and finished. Repaired drywall shall be painted where exposed in final installation. Install fireplace hearth, surround, and mantel per attached manufacturer's installation instructions.

Thanks,

Harding

## DESCRIPTION OF CONTENTS

QTY	DATED	TITLE	NUMBER	SCALE	SIZE	NOTES
1	6/8/2016	160608_PR-083_Estimate.pdf				
1	6/7/2016	160608_PR-083_Installation.pdf				
1	6/8/2016	160608_PR-083_SKA-136.pdf				

## COPIES:

Brian Gravitt	(Marrillia Design and Construction)
Jim Martin	(Marrillia Design and Construction)
Josh Marrillia	(Marrillia Design and Construction)
Rob Price	(Marrillia Design and Construction)
Jessica Walker	(LFUCG)
Joyce Thomas	(LFUCG)
Martin Woodford	(LFUCG)

1  
SKA-136

170 LIBRARY WEST - FIREPLACE

SCALE: 1/4" = 1'-0"

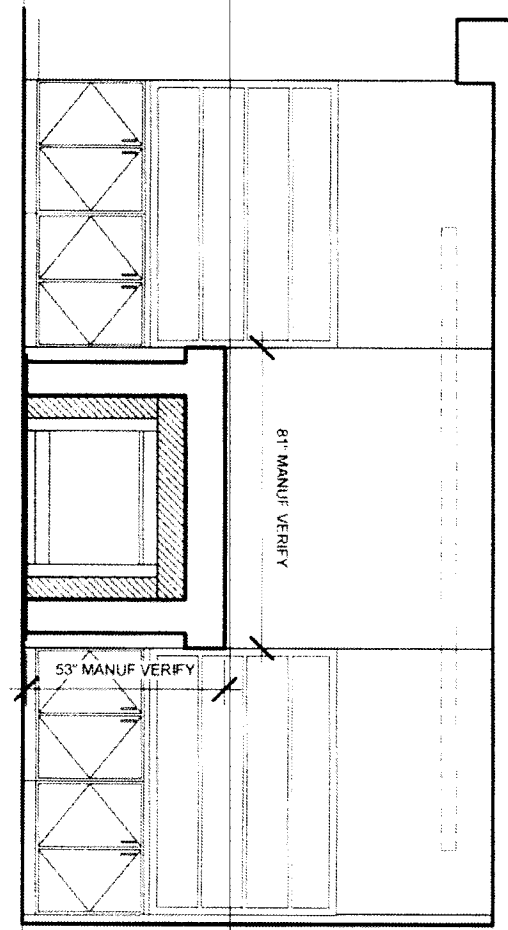

10' - 6"

1ST FLOOR  
0' - 0"

2  
SKA-136

ENLARGED FIREPLACE ELEVATION

SCALE: 1/2" = 1'-0"

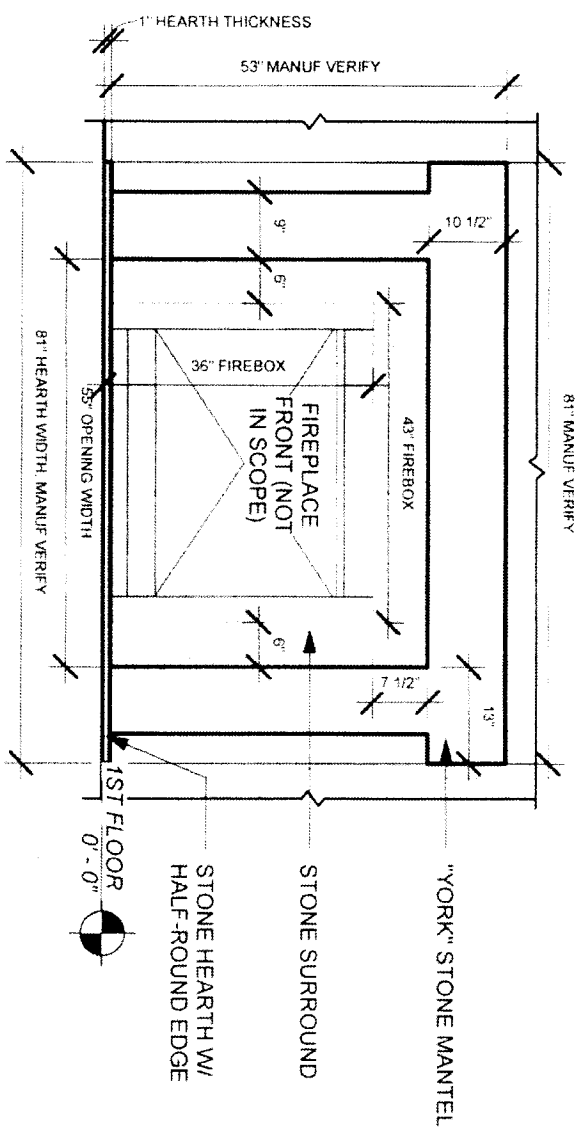

"YORK" STONE MANTEL  
STONE SURROUND  
STONE HEARTH W/  
HALF-ROUND EDGE

1ST FLOOR  
0' - 0"



LEXINGTON SENIOR CENTER  
195 LIFE LANE  
LEXINGTON, KY 40502

PR-083

Proj. No.	201332	Date	05/08/16
Client	HC	Project	RE

SKA-136

As indicated

**Travis Harris**

**From:** Rodney Gifford <rodney@renovationbrands.com>  
**Sent:** Friday, June 10, 2016 11:55 AM  
**To:** Travis Harris  
**Subject:** Mantels Direct: Estimate #348137



**Date** 6/6/2016  
**Estimate #** 348137

217 North Seminary Street  
Florence, AL 35630  
Phone: 888.493.8898  
Fax: 888.867.5774

**Bill To**

**Ship To**

Item	Qty	Description	Rate	Amount
York Majestic Custom-BUF-FROU	1	York Stone Mantel - Open Cast Finish Buff Color /1"H Half Rd Hearth  Seamless Facing Kit to Fit Firebox 43"W x 36"H Approx 6" of Facing Material will show on the Sides of the Firebox and 6.5" at the Top  Hearth w/Half Round Edge 81"W x 20"D x 1"H  A=52.5" Overall Height B= 42.5" Opening Height C=55" Opening Width D=81" Shelf Length E=73" Body Width F=14" Shelf Depth X=9" Leg Width Y=13" Leg & Shelf Overhang Z=10.5" Breast Height  ~~Thank you for the opportunity to help you with this Estimate It is Free Shipping and No Sales Tax too Let me know how I may be of further assistance. Rod 1-888-867-0989	3,314.20	3,314.20
			<b>Total</b>	<b>\$3,314.20</b>

THANK YOU FOR YOUR INTEREST! To place an order, please give me a call at (888) 493-8898. This estimate is valid for 21 days unless otherwise noted on this estimate.

[Submit Spam](#)

**Harding Dowell**

**From:** Rodney Gifford <rodney@renovationbrands.com>  
**Sent:** Monday, June 06, 2016 10:20 AM  
**To:** Harding Dowell  
**Subject:** Mantels Direct: Estimate #348137  
  
**Categories:** Filed by Newforma



217 North Seminary Street  
 Florence, AL 35630  
 Phone: 888.493.8898  
 Fax: 888.867.5774

**Bill To**

**Estimate**

**Date** 6/6/2016 **Estimate #** 348137

**Ship To**

Item	Qty	Description	Rate	Amount
York Majestic Custom-LIM-FROU	1	York Stone Mantel - Natural Stone/1"H Half Rd Hearth Seamless Facing Kit to Fit Firebox		
		Rod 1-888-867-0989		
<b>Total</b>				

THANK YOU FOR YOUR INTEREST! To place an order, please give me a call at (888) 493-8898. This estimate is valid for 21 days unless otherwise noted on this estimate.





217 North Seminary Street  
Florence, AL 35630

T: 888.493.8898  
F: 888.867.5774

[www.mantelsdirect.com](http://www.mantelsdirect.com)  
[info@mantelsdirect.com](mailto:info@mantelsdirect.com)

## Installation for Mantels

### CLASSIC CAST STONE MANTELS AND STONE MANTEL KITS

**You will need the following tools and materials to build your mantel:**



Power Drill



Circular Saw with  
Diamond Masonry  
Blade



Tape Measure



3" Wood Screws



Caulk Gun

- Shims to level components
- Thinset for setting the Hearth
- High-strength construction adhesive
- Bracing material
- Level

**Cast Stone Mantel and Stone Mantel Kit materials meet the requirements for non-combustibility when tested in accordance to ASTM E-136.**

#### Overview

Classic Stone Cast Stone Mantel Kits contain components for a typical installation, and include: mantel components (legs and shelf), facing panels (header, legs) (included on Builder Kits, optional on others) and a hearth (included on Builder Kits, optional on others). If facing panels and hearth are not supplied by Mantels Direct, please ensure the non-combustible facing panels located immediately around the firebox opening are built-up to a .75" thickness and extend at least 1" behind the inside edges of the mantel components.

#### Handling Hints

- Handle products with care to avoid damage to ornamental surfaces and fracturing of components. Avoid unnecessary contact of exposed faces of components with objects that may scratch or scuff surfaces
- Carry components on edge and store in original packaging at room temperature
- If any facing or hearth piece is bowed or warped following shipment, simply lay flat (face up) and mist with water using a spray bottle. Repeat if necessary after allowing time to dry

**NOTE: We include a patch kit that can make repairs to cracks and chips as well as fill screw holes and seams.**

Mantel components are ideally applied to solid, stable, flat and level substrates such as plaster or drywall. Wood surfaces are typically not stable and may cause cracks in components or filled joints.

**Important:** Layout and dry fitting of entire mantel is recommended before any adhesive is applied.

Components may be secured using a high-strength construction adhesive (available from Mantelsdirect.com) or most home centers. The construction adhesive should be suitable for plaster or masonry material and potentially high temperature application. Use bracing to secure components tight to the wall until the adhesive sets. Avoid adhesive on exposed component surfaces and use caution not to apply too much. Use a finishing nail or a small piece of plastic (shaped like a 'V') to remove excess adhesive at joints. Clean off excess adhesive immediately as required by adhesive manufacturer instructions.

### Hearth and Facing Panel Installation

#### STEP 1. Hearth Installation

Install the hearth first, centered on the firebox opening and set tight to the wall (**Fig. 1**). Set the hearth level on a bed of thin set masonry material if the floor is uneven and ensure there are no voids between the floor and underside of the hearth for complete and continuous support throughout its area, especially at the corners. Apply Construction Adhesive. (**Fig. 1.1**)

*For Raised Hearths it is recommended that create a wooden frame for the hearth to cover. Your frame should be approximately .75" smaller than the hearth on all sides. This will ensure that the raised hearth fits over your frame.*

**Fig. 1 Prepare and apply adhesive**



Apply the adhesive around the outside of the hearth, leaving two places for handholds

**Fig. 1.1 Install hearth**

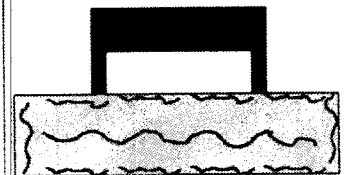

Carefully place the hearth on the Micore with the face of the marble facing the firebox, finished edge up. Center it on the Micore so that you will not have to move it any more than possible.

## Hearth and Facing Panel Installation

### STEP 2. Install Facing Panel Legs

The following instructions are for Adjustable Surround Facing that contains three pieces. Custom One Piece facing will simply fit over your firebox opening.

Adjustable Surround Facing:

**The cavity behind Classic Cast Mantel components is designed to allow for the position of the facing panels to be adjusted and accommodate a wide range of firebox openings.** Measure for the legs, and check both sides of the firebox; it may be necessary to cut the height of the legs. Cut the legs as required with a circular saw with a masonry blade. Always make your cuts on a level surface; never let the piece you are cutting fall free. Apply adhesive on the back of each leg and place into position. (Fig. 2)

### STEP 3. Install your Facing Header and Optional Riser

Apply adhesive on the back of the header and place into position. (Fig. 3)

*Note: It is usually okay if your header extends beyond the outside of each leg – our fireplace mantels are designed to overlap facing material and can accommodate up to 5" on each side in most cases.*

If you are using a riser panel, simply cut the panel to fit between the two facing legs, apply adhesive and place into position. (Fig. 3.1)

## Mantel Installation

### STEP 1. Install Mantel Legs

Install so that each mantel leg overlaps its respective facing panel. When set in place, the level height of each mantel leg must be identical to provide for a level mantel shelf. Use shims to level the mantel legs. Apply a generous and continuous bead of adhesive to ensure continuous contact between wall and bedding surface of the mantel legs. (Fig. 4) and (Fig. 4.1) Brace mantel legs securely until the adhesive sets. **Note:** If necessary, the mantel legs can be cut at the base to adjust the overall height of the mantel.

### STEP 2. Install Mantel Shelf

Your mantel shelf should be set so that there is equal distance on the outside of each leg. After locating this position, mark with pencil. Apply adhesive to the back of the shelf as well as the top of each leg. (Fig. 5) and (Fig. 5.1) Set the shelf. For additional security, install two (2) - 3"-long wood screws into the top of the mantel shelf and into the wood blocking below. Locate screw holes approx 1" from the wall and 18" on either side of the mantel centerline. Drill pilot holes first and countersink so that screw heads are located below the surface of the mantel shelf.

### STEP 3. Screw Hole and Seam Repair

Mix a small amount of the facing powder provided with a few ounces of the white liquid to create a workable paste (peanut butter consistency). Fill screw holes and seams with a knife or small putty tool to a smooth finish. Area may be sanded lightly, after it dries, if required.

### STEP 4. Sealing Your Fireplace Mantel

Polished and Honed mantels require a sealer. Use a clean cloth and apply sealer on all components.

Fig. 2 Install facing legs

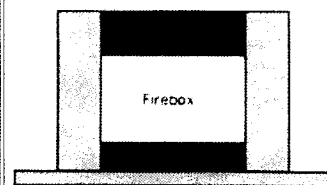
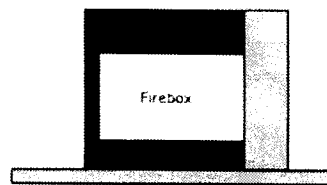

Fig. 3 Install header

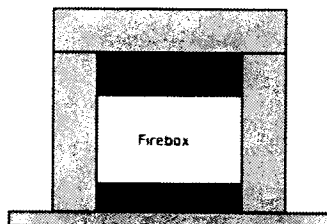
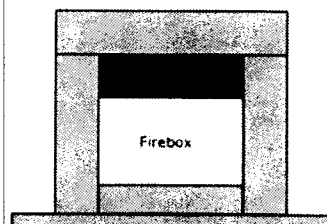
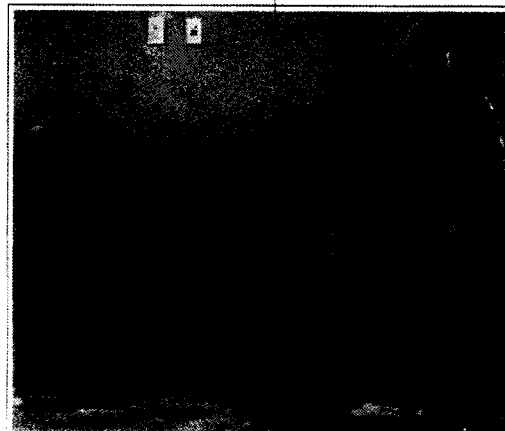
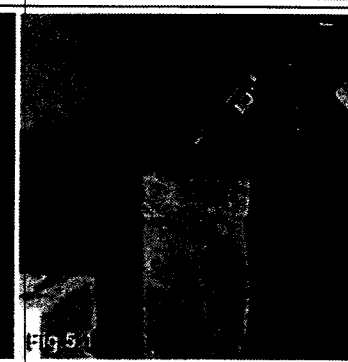
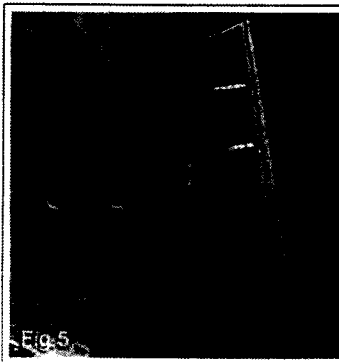
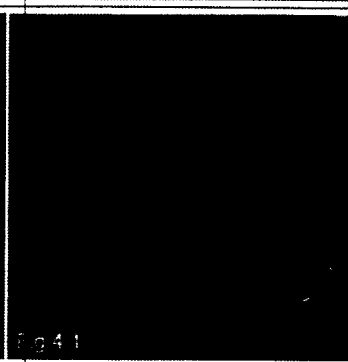
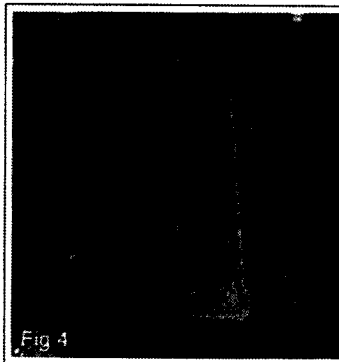

Fig 3.1 Optional riser installation



**Note: This firebox in this illustration has vents and would not require a riser.**



**MANTELS**

888.493.8898 [www.mantelsdirect.com/cast\\_stone\\_mantels.html](http://www.mantelsdirect.com/cast_stone_mantels.html)

## Travis Harris

---

**From:** Dino Martina <dinomartina@martinabros.com>  
**Sent:** Friday, June 10, 2016 12:13 PM  
**To:** Travis Harris  
**Subject:** RE: LFUCG Senior Center

Travis,

Labor and setting materials to install owner furnished fireplace surround would be \$1,500.00. This includes a 1 year installation warranty.

Contact me with any questions.

Thanks,

Dino Martina  
Martina Bros. Co., Inc.  
300 Scott St  
Lexington, KY 40508  
859-255-3602  
www.Martinabros.com

**From:** Travis Harris [mailto:tharris@marrillia.com]  
**Sent:** Friday, June 10, 2016 12:11 PM  
**To:** Travis Harris  
**Cc:** dinomartina@martinabros.com  
**Subject:** LFUCG Senior Center

Dino,

Please give me your install number.

Thanks,

Travis Harris  
Site Manager  
Marrillia Design and Construction  
259 West Short Street, Suite 326  
Lexington, Kentucky 40507  
Tel: 859.685.0414  
Fax: 859.685.0418  
Cell: 859.200.9732  
Web: [www.marrillia.com](http://www.marrillia.com)  
Email: [tharris@marrillia.com](mailto:tharris@marrillia.com)