



**FAYETTE COUNTY, KENTUCKY**  
 Property Valuation Administrator  
 David O'Neil, PVA



[Return to Search Results](#)   [Next Parcel](#)   [Main Search](#)   [Address Search](#)   [Subscription Home](#)   [Fayette Home](#)

**Owner and Parcel Information**

<b>Owner Name</b>	COMMONWEALTH OF KENTUCKY	<b>January 1, 2015 Owner</b>	COMMONWEALTH OF KENTUCKY
<b>Mailing Address</b>	110 S LIMESTONE ST LEXINGTON, KY 40507	<b>Parcel Number</b>	04038780
<b>Location Address</b>	110 S LIMESTONE LEXINGTON, KY 40507	<b>Tax District</b>	District 1
<b>Legal Description</b>	F-068 STEWART'S-PHOENIX PROP LOT	<b>2014 Tax Rate</b>	1.1867
<b>Property Class</b>	E-Exempt	<b>Acres</b>	0.5049
<b>PVA Neighborhood</b>	021-AYLESFORD	<b>Parcel Map</b>	<a href="#">Show Parcel Map</a>
<b>Land Use Code</b>	700-HOA, RET. BASIN, OPEN SPACE, GREENWAY	<b>ND-1 Zone</b>	
<b>USA/RSA Map</b>	04	<b>Overlay</b>	
<b>Map Block</b>	011	<b>PDR</b>	
<b>Lot</b>		<b>Map Scale</b>	200
<b>Subdivision</b>	STEWARTS PHOENIX PROP	<b>Block</b>	
<b>Deeded Acres</b>	0.5049	<b>LFUCG Zoning</b>	B-2B-DOWNTOWN CENTER BUSINESS
<b>Cabinet/Slide</b>	F-068	<b>Deeded Sqft</b>	20,500
		<b>Frontage / Out Of</b>	143 / PCL 1 2 3

**Assessment Information**

[Historical Assessments](#)

Year	Fair Cash Value	Agricultural Value Land	Agricultural Value Total	Exempt	Taxable Value
2015	\$ 1,500,000	\$ 0	\$ 0	\$ 1,500,000	\$ 0

**Improvement Information**

No improvement information available for this parcel

**Building Photo Preview**   [Enlarge/Show All Photos](#)



**Accessory Information**

Description	Year Built	Area	Grade
No accessory information associated with this parcel.			

**Sale Information**

Sale Date	Sale Price	Deed Book	Deed Page	Sales Validity	Owner	Previous Owner
1901-01-01		0000	0	50-UNKNOWN SALE DATE	COMMONWEALTH OF KENTUCKY	

The Fayette County Property Valuation Administrator's Office makes every effort to produce the most accurate information possible. No warranties, expressed or implied, are provided for the data herein, its use or interpretation. Website Updated: August 6, 2015

© 2011 by Fayette County KY | Website design by [qpublic.net](#)

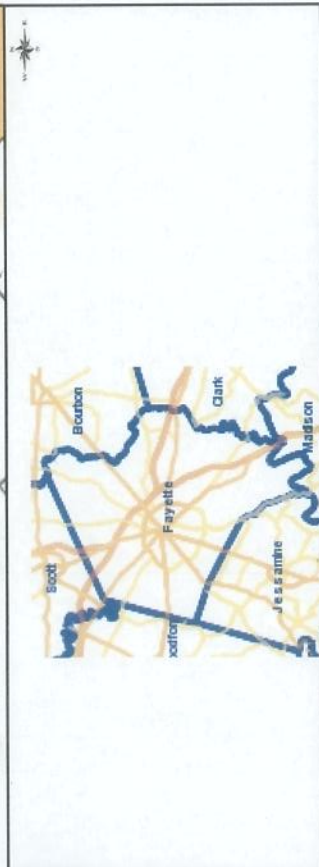
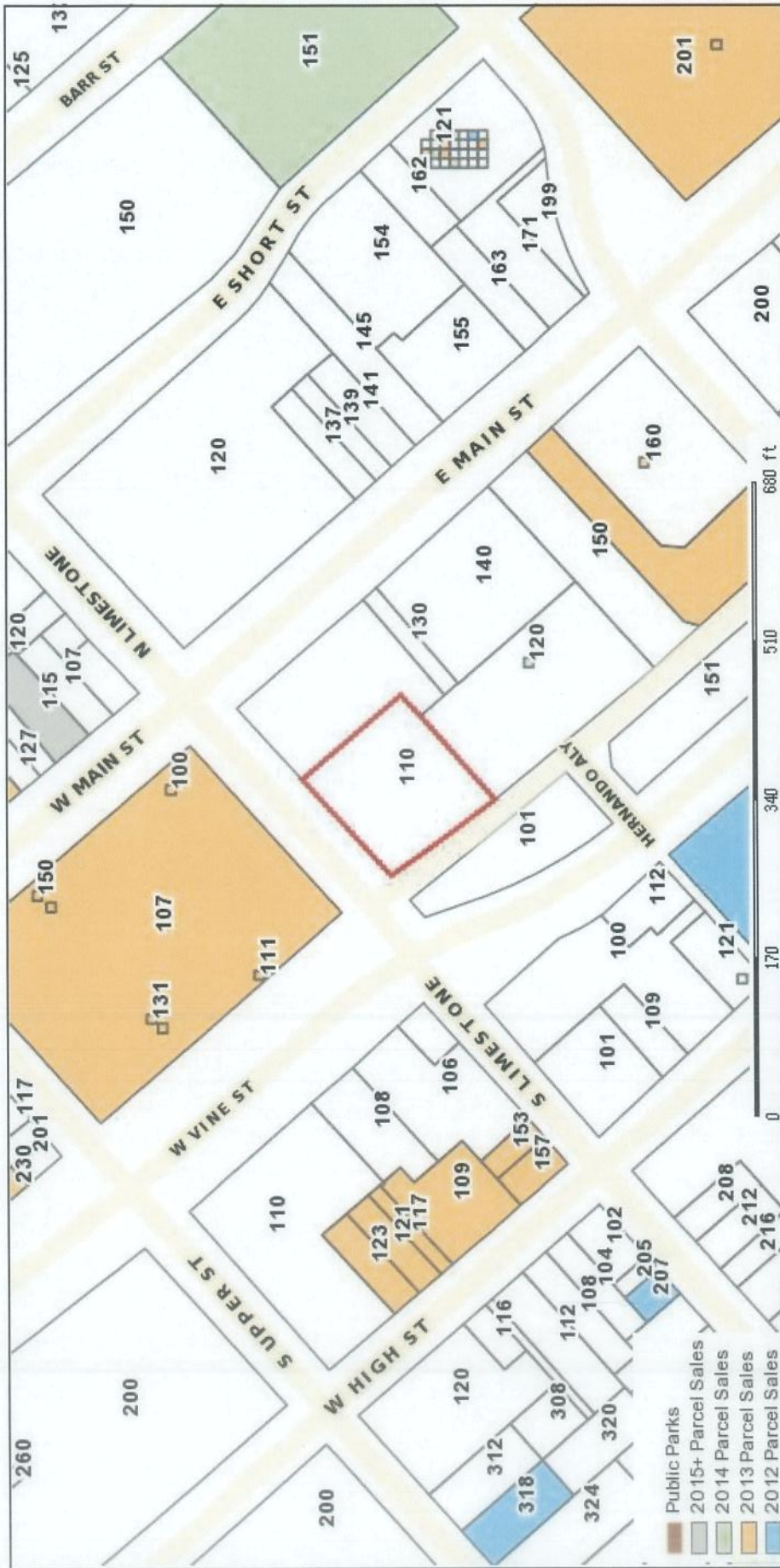

Fayette County Property Valuation Administrator

Parcel: 04038780 Acres: 0.5049 Book: 0000 Page: 0	
Name:	COMMONWEALTH OF KENTUCKY
Site:	110 S LIMESTONE
Sale:	0 on 1901-01-01 Reason=U Qual=50
Mail:	110 S LIMESTONE ST LEXINGTON, KY 40507
Fair Cash Value	\$ 1,500,000
Ag Land Value	0
Ag Total Value	0
Taxable Value	0

The Fayette County Property Valuation Administrator's Office makes every effort to produce the most accurate information possible. No warranties, expressed or implied, are provided for the data herein, its use or interpretation. The assessment information is from the last certified taxroll. All data is subject to change before the next certified taxroll. PLEASE NOTE THAT THE PROPERTY APPRAISER MAPS ARE FOR ASSESSMENT PURPOSES ONLY NEITHER FAYETTE COUNTY NOR ITS EMPLOYEES ASSUME RESPONSIBILITY FOR ERRORS OR OMISSIONS ---THIS IS NOT A SURVEY---

Date printed: 08/11/15 : 12:02:00