

ATTACHMENT A
to the GRANT AWARD AGREEMENT
between Lexington-Fayette Urban County Government (LFUCG) and
Hamburg Homeowners Association

GRANT PROGRAM: FY2016 Stormwater Quality Projects Incentive Grant Program

Class A (Neighborhood) Projects

- Funded through the LFUCG Water Quality Management Fee
- Administered by the LFUCG Division of Water Quality in the Department of Environmental Quality and Public Works

PROJECT TEAM AND CONTACT INFORMATION

Organization:



Hamburg Homeowners Association (Assumed Name Corporation)
Shetlands Homeowners Association, Inc.
1795 Alysheba Way #3103
Lexington, KY 40509
KY Organization #: 0464892

Organization President: Michael Young

Primary Project Contact and Project Manager: Darren Hawkins
859-509-1742
team@hawkinsstates.com

Secondary Project Contact: Katherine Pettit
859-421-3309
kat@hawkinsestates.com

Project Site Location(s): 889 Star Shoot Parkway
2364 Rockminster Road

Property Owners: Shetlands Homeowners Association, Inc.

Consulting Firm Contact: Clotfelter/Samokar
228 E. Reynolds Rd, Suite One
Benjamin Boggs
859-273-3700
info@clotfelter-samokar.com

Project Participants: Darren Hawkins – Project Manager
Benjamin Boggs, Clotfelter Samokar, Consultant
Community Management Associates – Property Management
Diamond Landscaper
H2O Designs – Rain Garden Installation

PROJECT PLAN ELEMENTS

1) STORMWATER CONTROL FACILITIES:

The goal of this project is to improve water quality through the design and installation of a new rain garden at the 2364 Rockminster Road property and the addition of plantings at the existing rain garden at 889 Star Shoot Parkway. Work will occur on association green space property which connects residential stormwater runoff to Bryan Station Creek, tributary to North Elkhorn Creek. Previous efforts at the Rockminster site have removed invasive plant species and uncovered an existing natural spring. Since the grant was only partially funded by the LFUCG Water Quality Fees Board, the grant may **not** be used to provide for a fountain, fencing or decorative stone to be placed around the designed stormwater control facilities even though they may be a part of the overall project.

A site map and conceptual design sketches for the two locations are provided in the *Supplemental Project Element Information* section of this document. The exact locations and details of improvements are to be determined by Grantee and Consulting Firm during the project.

Design guidance for the rain garden element can be located in the *LFUCG – Stormwater Management Low Impact Development Guidelines for New Development and Redevelopment* and LFUCG - Stormwater Manual found at Lexington's website.

All improvements shall be located on the properties listed above. No other property or Right-of-Way shall be disturbed without the written permission from the property owners and/or LFUCG.

The Organization agrees to enter into the Agreement to Maintain Stormwater Control Facilities for Class A Incentive Grant Projects included in Attachment B of the Grant Award Agreement within 21 calendar days of the final (post punch-list) inspection. It is anticipated that the new rain garden be included in Attachment B.

REPORTING REQUIREMENTS

In addition to the detailed reporting requirements listed in the Grant Award Agreement, the following special items are noted for this project:

1. Design Plans shall be provided to the LFUCG Grant Manager for review prior to starting construction of the project. All existing utilities and easement shall be located and shown on the design plans. If any work is proposed to occur within any easement (i.e. utility, etc.), whether public or private, the Organization shall obtain all necessary encroachment agreements for the authorized agencies prior to the start of construction. The Organization shall allow LFUCG ten (10) calendar days to review the submittals and provide comments.
2. All federal, state, and local permits, approvals, and agreements required for construction of the proposed improvements shall be obtained prior to the start of construction. The Organization is fully responsible for determination of which approvals, permits, and encroachments are required for the project.
3. The Grantee shall provide a set of record drawing schematics, of actually installed field elements, to LFUCG Grant Manager with the Final Project Report.
4. An Operation and Maintenance Plan (O&M) shall be generated and provided to Grantee and LFUCG Grant Manager.

PERMANENT FACILITIES/INFRASTRUCTURE

Permanent Capital Infrastructure: This grant includes Permanent Capital Infrastructure for purposes of the Grant Award Agreement.

Ownership: The proposed permanent facilities are expected to reside on private association property in Fayette County and be owned and maintained by the neighborhood association.

Future Inspection and Maintenance: The Organization (and/or Property Owner) agrees to sign and abide by the terms of the *Maintenance Agreement for Stormwater Control Facilities for Class A Incentive Grant Projects* included as Attachment B to the Grant Award Agreement.

Monitoring by LFUCG: The Organization agrees to allow LFUCG staff future access to properties on which work is performed to monitor the installed features for compliance with this Agreement during the grant period. After the grant period has ended, the Organization agrees to allow LFUCG access for monitoring per the terms of the Maintenance Agreement. Water quality sampling via grab samples or other methods may be employed by LFUCG staff as part of LFUCG's annual reporting requirement of its Kentucky Pollutant Discharge Elimination System (KPDES) MS4 Phase I permit.

ADDITIONAL GRANT STIPULATIONS

- a) Grantee shall obtain written approval/agreement prior to work being done on properties not owned by the applicant.
- b) Selected project component(s) include Rain Garden elements from the application. The following items in the application do not appear to be justified for Water Quality, Water Quantity, or Education: Fountain, Fence, and Decorative Stone.
- c) Rain garden shall not be installed within 10' of either side of existing sanitary sewer and measures shall be taken to prevent infiltrating water from entering into the sanitary sewer stone trench.

GRANT PERIOD & PROJECT SCHEDULE

The grant period starts on the date of execution by the Mayor and extends for the time period as listed in the Grant Award Agreement. Any time extensions must be approved in writing by the LFUCG Grant Manager. The project schedule shown in Table 1 is preliminary. Proposed changes to the project which alter this schedule significantly shall be discussed with the LFUCG Grant Manager prior to implementation.

TABLE 1 – PRELIMINARY PROJECT SCHEDULE

Activity	Anticipated Date (s)
Approval of Grant Award Agreement and Notice to Proceed (NTP)	February 2016
Meetings to plan project	March 2016
Design provided by Consultant	May 2016
Submit all required permitting	June 2016
Approved permits received	September 2015
Install Rain Garden and Plantings	October 2016
Provide Project Final Report to LFUCG	November 2016 (30 days after project completion)
Final Payment (3% Retainer)	After acceptance of Project Final Report

PROJECT BUDGET – GRANT ELIGIBLE EXPENSES

Table 2 lists the Eligible Expenses for elements of this project. Only properly invoiced items shall be reimbursed with grant monies or counted toward the Organization's cost share. Any work performed on this project prior to grant award by Urban County Council and Notice to Proceed from the LFUCG Grant Administrator is NOT an eligible expense and shall not be reimbursed or counted toward the cost share.

Hours worked by participants under the age of 12 shall not be counted toward the cost share. Any donated professional service hours not currently listed in the Eligible Expenses shall be valued, at a maximum, at the Median Hourly Wage for the expertise provided – from the U.S. Department of Labor, Bureau of Labor Statistics, State Occupational Employment and Wage Estimates for Kentucky (current website: www.bls.gov/oes/current/oes_ky.htm).

The construction estimate will be revised as part of the design process. The Grant is a not-to-exceed amount, and any cost overruns are the responsibility of the Grantee.

TABLE 2 – PROJECT BUDGET

Type of Expense	Participants	Item	Unit Price	Quantity	Funded by Organization	Funded by Grant	Total Expense
1 Project Element: Grant Management							
2 Donated Professional Service	Darren Hawkins	Grant Management	\$ 14.00 per hour	30	\$ 420.00	\$ -	\$ 420.00
3 Project Element: Rain Garden and Plantings Install							
4 Professional Design Service	Clofelter/Samuckar	Arch. Consulting & project management	\$ 3,000.00 Lump Sum	1	\$ 600.00	\$ 2,400.00	\$ 3,000.00
5 Professional Service/labor	H2O Designs	rain garden install (fountain not included)	\$ 4,200.00 Lump Sum	1	\$ 900.00	\$ 3,300.00	\$ 4,200.00
6 Labor/construction	Ray Layton	rain garden prep	\$ 100.00 per hour	16	\$ -	\$ 1,600.00	\$ 1,600.00
7 Professional service/labor	Diamond Landscapes	Install Rain Garden Plantings (decorative stone not included)	\$ 5,250.00 Lump Sum	1	\$ 1,050.00	\$ 4,200.00	\$ 5,250.00
8					TOTAL PROJECT BUDGET:		\$ 14,470.00
9					\$ 2,970.00 ORGANIZATION	\$ 11,500.00 GRANT	
10					COST SHARE % = 20.53% *		
11					SHARE 20.5%	SHARE 79.5%	
12					MUST BE > 20%		

* Note: Organization share must be 20% of total project costs.

SUPPLEMENTAL PROJECT ELEMENT INFORMATION
889 Star Shoot Parkway - Site Map and Design Sketch (Submitted with Application):

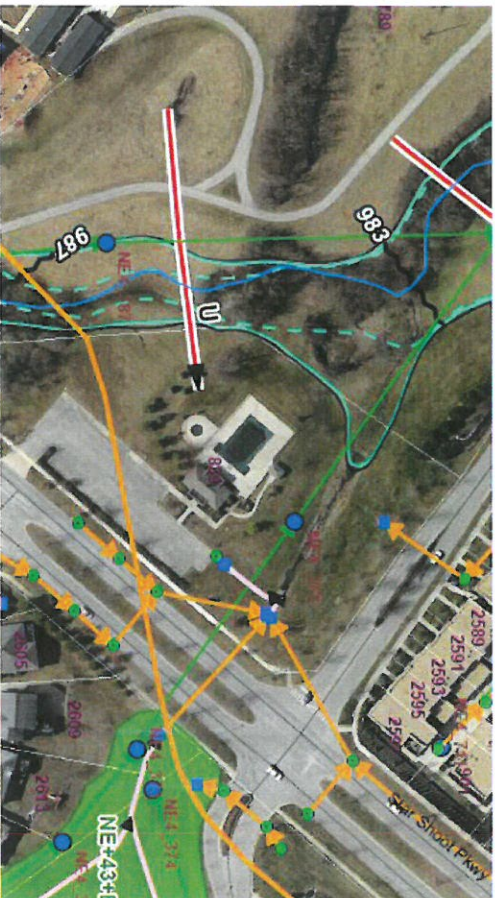



2364 Rockminster - Site Map and Design Sketch (Submitted with Application):

