

**LEXINGTON-FAYETTE URBAN COUNTY GOVERNMENT  
CONTRACT CHANGE ORDER**

Page 1 of 2

Date:	May 23, 2016
Project:	Public Safety Operations Center Phase 1B Renovation
Location:	115 Cisco Road
Contract No.	287-2014
Original Contract Amt.	\$6,109,000.00
Cumulative Amount of Previous Change Orders	\$540,661.24
Percent Change - Previous Change Orders	8.85%
Total Contract Amount Prior to this Change Order	\$6,649,661.24
Change Order No.	14

R-329-2016  
Original: R-744-2014  
Contract #: 287-2014

To (Contractor):  
Churchill McGee, LLC  
1315-C West Main Street  
Lexington, KY 40508

You are hereby requested to comply with the following changes from the contract plans and specification;

**Current Change Order**

Item No.	Description of changes-quantities, unit prices, change in completion date, etc.	Decrease in contract price	Increase in contract price	
1	Contract Time Extension of 42 days	\$0.00	\$0.00	
2	PR#51 Hilti Speed Sleeves IDF 145A	\$0.00	\$406.93	
3	PR#53 Data Cabinet Power Connection, Comm 140	\$0.00	\$1,939.90	
4	PR#54 Replace sidewalk at Northwest corner of building	\$0.00	\$6,754.00	
5	PR#55 EIFS at openings in precast, plus 2 days	\$0.00	\$1,650.00	
6	PR#56 Break metal at windows for column wraps	\$0.00	\$3,245.00	
7	PR#57 Sidewalk at Door V102		\$1,093.32	
	Total decrease	\$0.00		
	Total increase		\$15,089.15	
	Net Amount of this Change Order	\$15,089.15		
	New Contract Amount Including this Change Order	\$6,664,750.39		
	Percent Change - This Change Order			0.25%
	Percent Change - All Change Orders			9.10%

The time provided for the completion in the contract and all provisions of the contract will apply hereto.

Recommended by <i>[Signature]</i>	(Proj. Mgr.)	Date <i>5-24-16</i>
Accepted by <i>Nathan Churchill</i>	(Contractor)	Date <i>05-24-2016</i>
Approved by <i>N/A</i>	(Director)	Date
Approved by <i>R. B. Basten</i>	(Commissioner)	Date <i>5/24/16</i>
Approved by <i>Sally H. [Signature]</i>	(Mayor or CAO)	Date <i>5-24-16</i>
	Mayor	<i>26-May-16</i>

**JUSTIFICATION FOR CHANGE**

PROJECT: Public Safety Operations Center Phase 1B Renovation

CONTRACT NO. 287-2014

CHANGE ORDER: 14

1. Necessity for change: Per the attached Contract Time Extension request, add 44 working days and no cost to the construction schedule due to a delay by Time Warner for installation of internet, which is required for use in remote testing of HVAC controls per Building Inspection. Per Proposal Request 51, add Hilti speed sleeves to seal penetrations into IDF 145A for dry chemical fire suppression operation for \$406.93. Per Proposal Request 53, modify the data cabinet power connections in Communications 140 per the attached instructions for \$1,939.90. Per Proposal Request 54, replace the sidewalk at the northwest corner of the building for \$6,754.00. Per Proposal Request 55, add EIFS at the edges of the cut precast panels for new openings for \$1,650.00 and two (2) working days. Per Proposal Request 56, add break metal at windows for exposed ends of column wraps for \$3,245.00. Per Proposal Request 57, remove and replace existing sidewalk/door stoop at Door V102 for \$1,093.32.
  
2. Is proposed change an alternate bid? \_\_\_Yes XNo
3. Will proposed change alter the physical size of the project? \_\_\_Yes XNo  
If "Yes", explain.
  
4. Effect of this change on other prime contractors: N/A
  
5. Has consent of surety been obtained? \_\_\_Yes XNot Necessary
6. Will this change affect expiration or extent of insurance coverage? \_\_\_Yes XNo  
If "Yes", will the policies be extended? \_\_\_Yes \_\_\_No
7. Effect on operation and maintenance costs: N/A
8. Effect on contract completion date: add an additional forty-four (44) working days to the construction schedule



Mayor

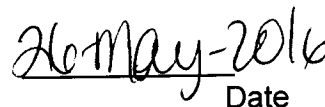

Date





PR 51

Date Issued: 03/28/2016

Murphy + Graves Project No. 1316

Project: LFUCG PSOC

Attachments: RFP Marcum Engineering

Issued by: Johnny Baucum via Andrea Bradford

Subject: Hilti Speed Sleeves IDF 145A

See attached RFP from Marcum Engineering.

Provide a proposal for the scope of work described in these documents, complete with breakdown.

**PUBLIC SAFETY OPERATIONS CENTER PHASE 2**  
**LEXINGTON FAYETTE URBAN COUNTY GOVERNMENT**  
**LEXINGTON, KENTUCKY**  
**MURPHY GRAVES TRIMBLE ARCHITECTS NO. 1316**  
**MARCUM NO. 13618**

**MPE REQUEST FOR PROPOSAL**

**TO:** Andrea Bradford, Murphy Graves Trimble

**CC:** Steve Cherry, Murphy Graves Trimble  
Perry Warren, Murphy Graves Trimble  
Jim Leake, Murphy Graves Trimble  
Pat McFeely, Mission Critical Partners  
Robert Lafaye, Mission Critical Partners  
Jim Krebs, Mission Critical Partners  
Baccus L. Oliver, Marcum Engineering

**FROM:** Johnny Baucum, Marcum Engineering

**DATE:** February 29, 2016

**SUBJECT:** RFP 10 Response to RFI 93 – Hilti Speed Sleeves IDF 145A.

---

**RATIONALE:**

Modifications required to seal IDF 145A for dry chemical operation and provide access to facilitate cable routing from Phase 1B to Phase 2.

**INSTRUCTIONS:**

The Contractor shall provide a proposal to locate (1) 16" x 16" access panel as shown on Sketch XE06. Added access panel shall match, make and model of the adjacent access panel in IDF 145A. Exact placement shall be coordinated with all MPE systems and allow access to the (2) 4" sleeves/raceway connecting Phase 1B and Phase 2.

The Hilti speed sleeves specified shall be installed in the horizontal ceiling plane in line with the (2) 4" wall sleeves and above the cable tray as shown in Sketch XE06.

**ATTACHMENTS:**

1. RFI 93 (Churchill McGee)
2. Sketch XE06

**END OF DOCUMENT**

# Request For Information (RFI)

Requested Reply Date

Project Name: 1316 PSOC Phase 1

<b>RFI Number</b> 93	<b>Submitted To:</b> M&G&T	<b>Submitted By:</b> Churchill McGee	<b>Copies To:</b>
<b>Date</b> 3-23-16			

Subject	Discipline	Co-Author
Hilti sleeves between Rooms T & C 144 and IDF 145A	Electrical / Communications	

**REFERENCE ATTACHMENTS:** (List specific documents researched when seeking the information requested.)

Specification Section	Drawing Reference	Other
Various	ASI 33 Drawings	

**RFI DESCRIPTION:** (Fully describe the question or type of information requested.)

In ASI #33 we are instructed to install 2 hilti sleeves between rooms 145A and 144 for the communications cabling. we believe these should be installed in the drywall ceiling above room 145A as this is where they will be needed as this is the area that will need to be sealed prior oa the clean agent fire system activation. We also believe (at a minimum) a 16" X 16 " access panel needs to be installed adjacent to these to allow the cabling to be pulled and for any future work to be added. Please advise how to proceed.

**SENDER'S RECOMMENDATION:** (if RFI concerns a site or construction condition, the sender may provide a recommendation, including cost and/or schedule considerations.)

**Response:**

Date Answered: \_\_\_\_\_ Answered By: \_\_\_\_\_

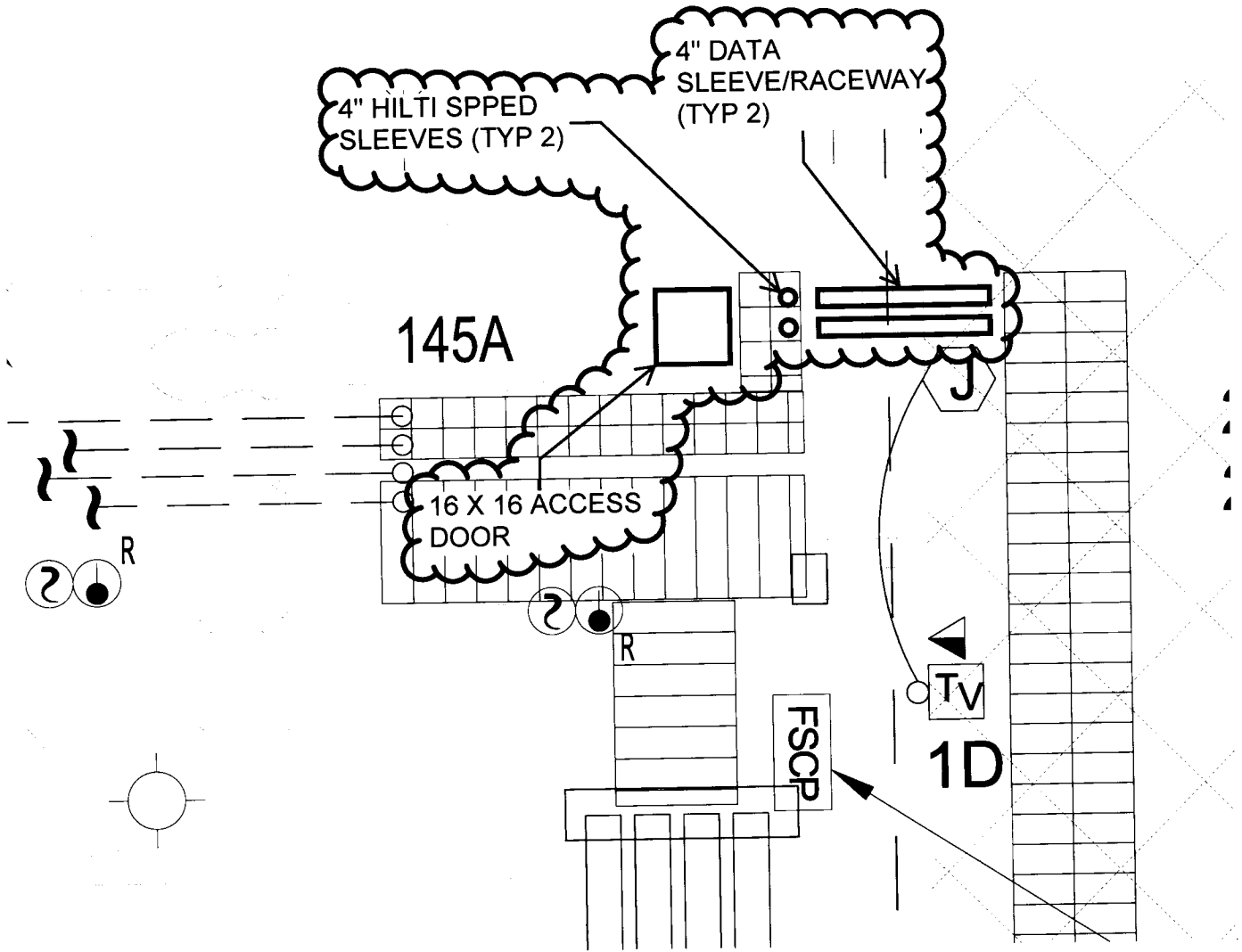

**MARCUM ENGINEERING, LLC**

500 SOUTH 17th STREET  
 PADUCAH, KENTUCKY 42002-0120  
 PHONE - 270.444.9274 FAX - 270.443.1904

COPYRIGHT ©, 2016 - MARCUM ENGINEERING, LLC

PROJECT NO.  
13618

DATE:  
3/25/2016

DRAWN BY:  
JOHNNY

SCALE:  
NONE

HILTI SPEED SLEEVE AND ACCESS DOOR  
IDF 145A

LFUCG OPERATIONS CENTER  
PHASE 2  
LEXINGTON KENTUCKY

REFERENCE DRAWING  
E1.5R

SKETCH NO.

**XE06**







1032 Rushwood Ct  
Lexington, Kentucky 40511  
Tel: 859-233-4427 Fax: 859-253-2831

# Quote

Quote # : 104403  
Quote Date : May 11, 2016  
Expiration Date : Jun 25, 2016

Customer:  
Cash Sale Div 2  
1032 Rushwood Court  
Lexington, Kentucky 40511

Ship To:  
Schiller Hardware  
1032 Rushwood Ct  
Lexington, Kentucky 40511

Tel: 859-233-4427 Fax: 859-253-2831

Account Code : CASH2  
Terms : COD  
Customer Job # :  
Salesperson : Scott Lucius  
Order Name : Access Door - Churchill Mcgee

Purchase Order # :  
Shipped Via : Counter Pickup

---

## 16"x16" Access door

---

**Qty Product Description**

1 16x16 Access Panel MDSEC1616

Pre-Tax Total : 349.00  
KY000 - Kentucky State Tax : 20.94  
**Quote Total : 369.94**

The above prices are quoted subject to acceptance within 30 days and credit approval by an officer of our company. State and local taxes are not included unless specifically noted. Material will be billed proportionately as shipped. Full amount of invoice due when rendered--retainage not acceptable. On shipments made by common carrier consigned to the customer, all claims for damages in transit must be filed by consignee. We do not include cost of unloading, storage or protection of material at jobsite.



PR 53

Date Issued: 04/11/2016

Murphy + Graves Project No. 1316

Project: LFUCG PSOC PH 1B

Attachments: RFP Marcum Engineering

Issued by: Johnny Baucum via Andrea Bradford

Subject: Data Cabinet Power Connection, Comm 140

See attached RFP from Marcum Engineering.

Provide a proposal for the scope of work described in these documents, complete with breakdown.

**PUBLIC SAFETY OPERATIONS CENTER PHASE 1B**  
**LEXINGTON FAYETTE URBAN COUNTY GOVERNMENT**  
**LEXINGTON, KENTUCKY**  
**MURPHY GRAVES TRIMBLE ARCHITECTS NO. 1316**  
**MARCUM NO. 13618**

**MPE REQUEST FOR PROPOSAL**

**TO:** Andrea Bradford, Murphy Graves Trimble

**CC:** Steve Cherry, Murphy Graves Trimble  
Perry Warren, Murphy Graves Trimble  
Jim Leake, Murphy Graves Trimble  
Pat McFeely, Mission Critical Partners  
Robert Lafaye, Mission Critical Partners  
Jim Krebs, Mission Critical Partners  
Baccus L. Oliver, Marcum Engineering

**FROM:** Johnny Baucum, Marcum Engineering

**DATE:** March 31, 2016

**SUBJECT:** RFP 11 – Data Cabinet Power Connection Modification, Communication  
140

---

**RATIONALE:**

Modifications required to connect Owner furnished data cabinets.

**INSTRUCTIONS:**

The Contractor shall provide a proposal to implement the following changes:

1. Row 2, Cabinet 2 and 3 (AIRBUS Cabinets). Change the (4) 20A 3-Phase service drops from the Starline busway to (L5-20) receptacles. Providing the L5-20 is a single phase outlet, alternate the different phases (L1, L2, L3, L1) to balance load.
2. Row 6, Cabinet 1, 2, 3, 4 and 5 (TMC Back-up Cabinets). Change the (10) 20A 3-Phase service drops from the Starline busway to (L6-30). Break out Cabinets 1 and 2 to show separate pricing.

**ATTACHMENTS:**

1. None

**END OF DOCUMENT**



# CHURCHILL McGEE, LLC

1315-C West Main Street  
phone (859) 389-6976

Lexington, Kentucky 40508  
fax (859) 389-6986

## Pricing Proposal for PR #53

Project: Public Safety Operations Center	Monday, May 9, 2016
--	---------------------

Project Number: MGT 1316

**PRICING PROPOSAL**

PR #53 Data Cabinet Power

	Arrow	Total
Material	\$1,113.28	\$1,113.28
Labor	\$566.28	\$566.28
Arrow Overhead 10%	\$167.96	\$167.96
Arrow Markup 5%	\$92.38	\$92.38
<b>Total</b>		<b>\$1,939.90</b>
<b>Change Order Total</b>		<b>\$1,939.90</b>



**A 0 Day Time Extension Request is Required For this PR**

We hereby authorize the above change order to be completed

Additional work is to be performed under the same conditions as specified in the original contract unless stipulated otherwise.

Date: \_\_\_\_\_ Owners Signature: \_\_\_\_\_

Churchill McGee LLC

Date: \_\_\_\_\_ Authorized Signature: \_\_\_\_\_

**NOTE: The above referenced change order revisions will only modify the original contract scope of work as specifically addressed in this change order. All other terms and conditions of the original contract will not change.**



# Change Proposal

**Client Address:**

**Churchill McGee, LLC**  
 1315-C West Main Street  
 Lexington, Kentucky 40508  
 Telephone: (859) 389-6976  
 Fax: (859) 389-6986  
 Contact: Jeff Griffith

**Ref #1** CE # 18  
**Date:** 4/15/2016  
**Project Name:** LFUCG Public Safety Operations Center  
**Project Number:** 20-10-2109 LFUCG Public Safety Operations Center  
**Contract #:** Dated Feb., 4th, 2015  
**Page Number:** 1

**Work Description**

With Respect to PR # 53, Arrow Electric offers the following for your consideration:

Row 2, Cabinet 2 and 3, Change the four (4) 20amp 3phase service drops to L5-20.  
 Row 6, Cabinets 1, 2, 3, 4, & 5, Change the ten (10) 20amp 3phase service drops to L6-30.  
 Change circuit breakers in Starline Busway to accomodate above.

We reserve the right to correct this quote for errors and omissions.

This quote covers direct costs only and we reserve the right to claim for impact and consequential costs.  
 This price is good for acceptance within 10 days from the date of receipt.  
 We request a time extension of 0 days.  
 We will supply and install all materials, labor, and equipment as per your instructions on PR # 53.

**Item Description**

Description	Qty	Total Mat.	Total Hrs.
#12/3C CORD - SOW	15	21.38	0.55
#10/4C CORD - SOW	35	75.88	1.52
20A 125V 3WIRE 1PH TW-LOCK FLNG INLET	4	70.24	1.16
30A 250V 3WIRE 1PH TW-LOCK FLNG INLET	10	308.80	3.80
20A 1P BREAKER BOLT-ON	4	85.76	0.76
30A 2P BREAKER BOLT-ON	10	488.20	3.10
<b>Totals</b>	<b>78</b>	<b>1,050.26</b>	<b>10.89</b>

**Summary**

<b>MATERIAL</b>		63.02
Material Tax (@ 6.000 %)		<b>1,113.28</b>
<b>Material Total</b>		566.28
JOURNEYMAN (10.89 Hrs @ \$52.00)		
<b>OVERHEAD &amp; MARKUP</b>		167.96 -
Overhead (@ 10.000 %)		92.38 -
Markup (@ 5.000 %)		

**Final Amount**

**\$1,939.90**

**CLIENT ACCEPTANCE**

CCN #: 18 \_\_\_\_\_  
 Final Amount: \$1,939.90 \_\_\_\_\_  
 Name: \_\_\_\_\_  
 Date: \_\_\_\_\_  
 Signature: \_\_\_\_\_



May 23, 2016

Mr. Steve Cherry  
Murphy Graves Trimble  
3399 Tates Creek Road, STE 250  
Lexington, KY 40502

Re: REVISED Proposal Review  
MGT PR 53 – REVISED Data Cabinet Power Connection Changes Communications  
Room 140  
Emergency Operations Center Phase 1B  
Lexington Fayette Urban County Government  
Lexington, Kentucky  
Marcum No. 13618

Steve,

Marcum has reviewed REVISED Proposal Request #53 in the amount of \$1939.90 and the amount to be representative of the work requested. Marcum recommends acceptance.

Please let me know if you have any questions.

Sincerely,

MARCUM ENGINEERING, LLC

A handwritten signature in black ink, appearing to read 'Johnny Baucum', with a long horizontal flourish extending to the right.

Johnny Baucum, Construction Administrator

Cc: Chuck Trimble, MGT  
Andrea Bradford, MGT  
Jim Leake, MGT  
Baccus Oliver, Marcum Engineering



## Proposal Request 54

Date Issued: 4-12-2016

Murphy + Graves Project No. 1316

Project: LFUCG PH I

Attachments: N/A

Issued by: Jim Leake via Dirk Bertram

Subject: Replace sidewalk at Northwest corner of building

Contractor shall remove existing sidewalk from the west side of new steps located at door C-105 to column line 2, or closest expansion joint at same location. Contractor shall install new sidewalk in this location, width as dimensioned on 9/C3.1. Bases of Design for sidewalk refer to sheet C3.1 in the Contract Documents.

Proposal shall be broken down to identify the cost of labor and material separately.



**CHURCHILL McGEE, LLC**  
1315-C West Main Street      Lexington, Kentucky 40508  
phone (859) 389-6976      fax (859) 389-6986

Change Order Proposal #54

Project: <b>Public Safety Operations Center</b>		4/24/2016
Project Number: <b>MGT 1316</b>		
You are authorizing us to perform the following additional work:		
<b>Remove and replace 62 lf of sidewalk at Northwest corner of the building as per PR #54 directions</b>		
	<b>TURLEY</b>	<b>TOTAL</b>
<b>Materials</b>	<b>\$1,429.50</b>	<b>\$1,429.50</b>
<b>Labor</b>	<b>\$4,710.50</b>	<b>\$4,710.50</b>
	<b>Total</b>	<b>\$6,140.00</b>
	<b>CM Mark up</b>	<b>\$614.00</b>
	<b>Total</b>	<b>\$6,754.00</b>
	<b>Total Change Order</b>	<b>\$6,754.00</b>
We hereby authorize the above change order to be completed		
Additional work is to be performed under the same conditions as specified in the original contract unless stipulated otherwise.		
Date: _____	Owners Signature: _____	
Churchill McGee LLC		
Date: _____	Authorized Signature: _____	

**NOTE: The above referenced change order revisions will only modify the original contract scope of work as specifically addressed in this change order. All other terms and conditions of the original contract will not change.**



# **TURLEY CONCRETE CONSTRUCTION, INC**

**2733 JESSICA LANE**

**LEXINGTON KY, 40511**

**PHONE: (859)259-1021/cell (859)621-0274**

## **Proposal LFUCG PSOC**

**Cisco Road Lexington, KY**

**Churchill McGee Construction Design Co**

**Contact person Jeff Griffith**

The undersigned Contractor, at request of Owner and for the price herein stated, agrees to furnish all materials and labor necessary for work (specified below) on premises located at

---

**Churchill McGee Construction Design**

---

**Owner**

**Address**

**Phone**

### **Specifications/work to be performed**

Following is a description of work to be performed at the above location. (1) The tear out and removal of 62 lf of 5' sidewalk, and AC pad, forming and re-pouring, \$6,140.00

**Total labor cost \$4710.50**

"The new concrete will be finished to a medium broom finish and conform to city codes and ordinances.

\*\*Churchill McGee will provide the following list of materials necessary for the completion of said work.

6 yards of 400 psi concrete with fiber @ \$112 per yard = \$ 672.00

5 sheets of 6X6 wire mesh @ \$30.00 per sheet =\$150.00

10 pcs of #4 steel 20' \$13.10 each =\$65.50

12 pcs of 5' expansion joint =\$60.00

2 ton of #57 stone = \$80.00

5 gallon buckets of sealer \$100.00

10% material oversight \$402.00

**Total cost for materials \$1,429.50**

**(Total cost to complete job including materials and labor is \$6,140.00)**

We recommend that you not put salt or any other melting agent on your concrete during the winter months as it can damage your concrete causing it to scale and flake off. If you choose to do so, it's at your own risk.

**Contractor will do all work in neat and workman like manner.**

If this contract is terminated before completion of the work specified herein, then owners agree to pay in full for all labor and materials furnished up to the date of such termination.

**The owner in consideration of the above agreement promises to pay to the order of TURLEY CONCRETE CONSTRUCTION INC the total amount of \$6,140.00 (six thousand one hundred and forty dollars)**

The contractor agrees to provide workman's compensation on his employees and general liability insurance on the job during the performance of said work.

1. All salvage and all debris is to be removed by the contractor at his expense unless otherwise specified.
2. The entire agreement between parties contained herein in writing and **NO VERBAL AGREEMENTS ARE RECOGNIZED.**
3. Any alterations or deviations from above specification involving extra cost will be executed only upon written order, and will become an extra charge over and above the estimate. All agreements and conditions are contingent upon strikes, weather, accidents, and or delays beyond our control.
4. The agreement is subject to acceptance by an officer of TURLEY CONCRETE INC.

---

Guarantee: the company and its employees warrant our workmanship for a period of (1) one year (Cracks in concrete are excluded).

---

**"Schedule of Payments"**





## Proposal Request 55

Date Issued: 4-12-2016

Murphy + Graves Project No. 1316

Project: LFUCG PH I

Attachments: PR # 55 Sketch/Picture of area to reference

Issued by: Jim Leake via Dirk Bertram

Subject: EIFS at openings in Precast

Contractor shall provide a proposal for the following scope of work at all openings that were cut into precast walls to receive HM frames. Contractor shall properly clean exposed rebar with a wire brush before applying one coat of Sherwin Williams Kemkromik (metal primer) to the areas where rebar is exposed in the openings. Contractor shall then apply a ½" Re-Enforced EIFS system to the face of the Head and Jamb of the opening as illustrated on the attached Sketch labeled PR # 55 Sketch.

Proposal shall be broken down to identify the cost of labor and material separately.

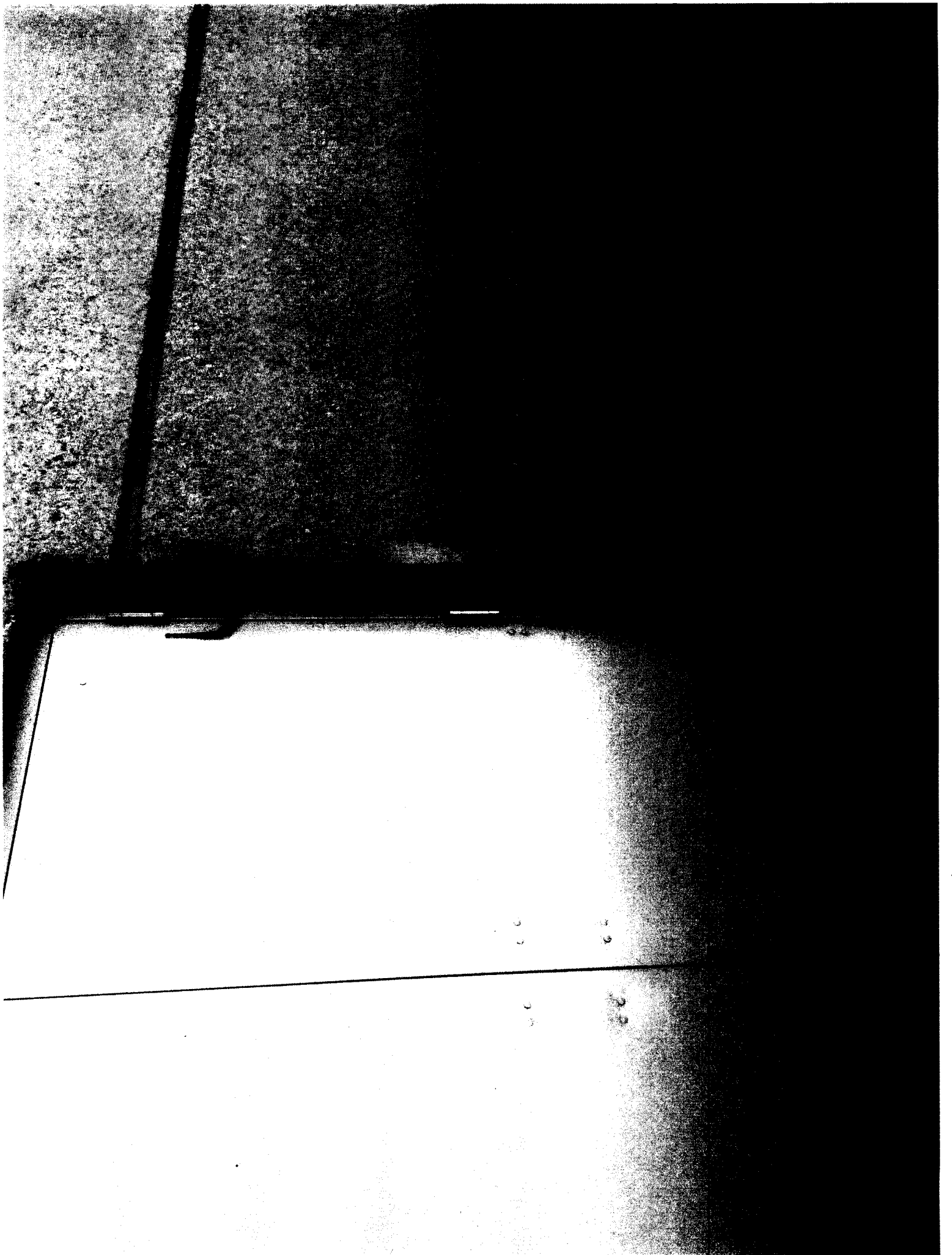

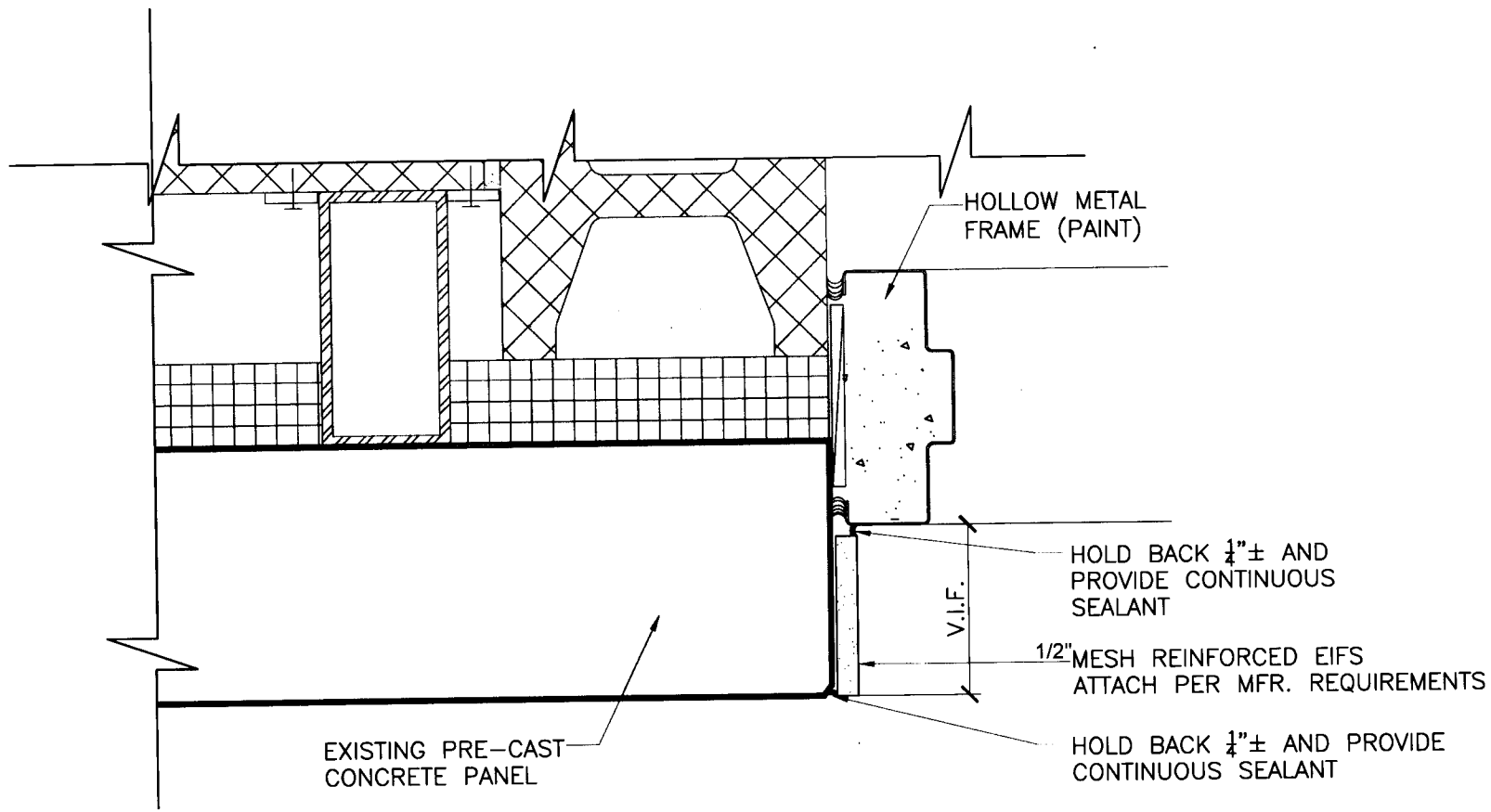

1

**DOOR JAMB DETAIL/HEAD DETAIL**

3" = 1'-0"

JOB NO. 1316  
 DATE: 4.12.2016  
 PRODUCED BY: APS  
 NOTES:

ARCH. SUP. DWG  
**PR-55**  
**SKETCH**

**EIFS @ DOOR JAMB**

**LFUGG PUBLIC SAFETY OPERATIONS  
 CENTER - PHASE 1B - RENOVATION**

**MURPHY-GRAVES-TRIMBLE, PLLC**  
 ARCHITECTS ENGINEERS INTERIORS  
 3997 Yates Creek Road, Suite 250  
 Lexington, KY 40502  
 P: 859.337.0604  
 www.mgtr.com  
 © copyright 2016





# INVOICE

1315C W Main Street  
 Lexington, KY 40508  
 859-475-6946  
[jmefford@d9interiors.com](mailto:jmefford@d9interiors.com)

DATE May 2, 2016  
 CUSTOMER ID Churchill McGee  
 DUE DATE 6/2/2016

TO Churchill McGee  
 1315C West Main Street  
 Lexington, KY

JOB NAME	ESTIMATOR	PREPARED FOR	START DATE
PSOC Phase 1	Jordan Mefford	Nathan Churchill	5/2/16

ITEM	DESCRIPTION	LINE TOTAL
Labor	Labor to Install 1/2" EIFS System at 4 Doorways to Cover Exposed Rebar	\$ 1,160.00
Material	Material to Install 1/2" EIFS System at 4 Doorways to Cover Exposed Rebar Includes Insulation, Fasteners, Base Coat, Finish Coat, Mesh and Caulk	265.00
Profit	5% Profit Markup	75.00

SUBTOTAL	\$ 1,500.00
ADDS	
TOTAL	\$ 1,500.00

Invoice prepared by: 

Payment terms are NET 30 unless otherwise specified in Subcontract.  
 Please remit payment to address above.



Date Issued: 04/19/2016

Murphy + Graves Project No. 1316

Project: LFUCG PSOC

Attachments: N/A

Issued by: Jim Leake via Andrea Bradford

Subject: Break Metal

Install break metal cover plate at exposed exterior window locations and of drywall installed on PR's 39 and 47.

Provide a proposal for the scope of work described in these documents, complete with breakdown.



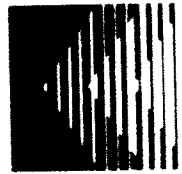

# Kentucky Mirror+ Plate Glass

DATE: 5/11/16

TO: Churchill McGee  
Attn: Nathan Churchill

RE: LFUCG Breakmetal

**WE AGREE TO FURNISH AND INSTALL:**

22 Custom Pieces of Clear Anodized .040 Break Metal  
Notch and Piece per Meeting with Dwayne and Jeff Griffith

Sum of \$2,950.00

Material	\$1,350.00
Labor	\$1,600.00

THIS QUOTATION IS SUBJECT TO THE FOLLOWING TERMS AND CONDITIONS

1. Prompt execution of this work will be subject to delays occasioned by strikes, fires, carriers and all other causes beyond our control.
2. We do not replace breakages caused directly or indirectly by anyone other than our own employees.
3. Cleaning of glass or metal Store Front Construction not included.
4. Figure quoted is based on an eight hour day (7 am - 3:30 pm), forty hour week. Overtime will be charged additional for work required during other than the regular work period, or for work performed on Saturday, Sunday or any Legal Holiday.
5. Rejections will not be allowed where owner's glass is to be reused, except at owner's expense.
6. After installation is made we do not assume responsibility for breakage or damage of any kind, except where it may be plainly shown to be our fault.
7. Correction of clerical errors prior to acceptance permissible.
8. Price revision allowable if not accepted within 30 days after date quoted.
9. Terms 90% net for all material furnished and work performed during the month is to be paid on, or before the tenth of the following month. Balance in full to be paid within thirty days after completion of contract.

ACCEPTED: \_\_\_\_\_

SUBMITTED: Jeffrey W. Spielberg

BY: \_\_\_\_\_

TITLE: Vice President

DATE: \_\_\_\_\_

DATE: 5/11/2016

---

Kentucky Mirror and Plate Glass  
816-822 W. Main Street · Louisville, KY 40202  
Phone (502) 583-5541 · Fax (502) 583-5546

Date Issued: 04/25/2016

Murphy + Graves Project No. 1316

Project: LFUCG PSOC PH 1B

Attachments: N/A

Issued by: Jim Leake via Andrea Bradford

Subject: Sidewalk

Contractor shall price removing the existing concrete slab at the Door V102 portico. Contractor shall not demolish concrete in such a way as to damage new door and frame at stated location or adjacent newly installed finishes. Contractor shall refer to floor slab details in the structural drawings and apply same finish as used on newly constructed sidewalks.

Provide a proposal for the scope of work described in these documents, complete with breakdown.



# **TURLEY CONCRETE CONSTRUCTION, INC**

**2733 JESSICA LANE**

**LEXINGTON KY, 40511**

**PHONE: (859)259-1021/cell (859)621-0274**

## **Proposal LFUCG PSOC**

**Cisco Road Lexington, KY**

**Churchill McGee Construction Design Co**

**Contact Nathan Churchill (513) 288-1980**

The undersigned Contractor, at request of Owner and for the price herein stated, agrees to furnish all materials and labor necessary for work (specified below) on premises located at

---

**Churchill McGee Construction Design**

---

**Owner**

**Address**

**Phone**

### **Specifications/work to be performed**

Following is a description of work to be performed at the above location. (1) The tear out and removal of a 10'X8' section of entrance apron and re-pouring, \$550.00

**Total labor cost \$550.00**

"The new concrete will be finished to a medium broom finish and conform to city codes and ordinances.

\*\*Churchill McGee will provide the following list of materials necessary for the completion of said work.

3 yards of 400 psi concrete with fiber @ \$127.93 per yard = \$ 383.93

1 sheets of 6X6 wire mesh @ \$30.00 per sheet =\$50.00

**Total cost for materials \$443.93**

**(Total cost to complete job including materials and labor is \$993.93)**

**We recommend that you not put salt or any other melting agent on your concrete during the winter months as it can damage your concrete causing it to scale and flake off. If you choose to do so, it's at your own risk.**

**Contractor will do all work in neat and workman like manner.**

**If this contract is terminated before completion of the work specified herein, then owners agree to pay in full for all labor and materials furnished up to the date of such termination.**

**The owner in consideration of the above agreement promises to pay to the order of **TURLEY CONCRETE CONSTRUCTION INC** the total amount of **\$993.93 (Nine hundred ninety three dollars and ninety three cent)****

The contractor agrees to provide workman's compensation on his employees and general liability insurance on the job during the performance of said work.

1. All salvage and all debris is to be removed by the contractor at his expense unless otherwise specified.
2. The entire agreement between parties contained herein in writing and **NO VERBAL AGREEMENTS ARE RECOGNIZED.**
3. Any alterations or deviations from above specification involving extra cost will be executed only upon written order, and will become an extra charge over and above the estimate. All agreements and conditions are contingent upon strikes, weather, accidents, and or delays beyond our control.
4. The agreement is subject to acceptance by an officer of **TURLEY CONCRETE INC.**

---

**Guarantee: the company and its employees warrant our workmanship for a period of (1) one year (Cracks in concrete are excluded).**

---

### **"Schedule of Payments"**

**Due to this being a scale job we request to be paid weekly depending on the amount of work that has been completed. The draw request will be submitted as per agreement with Churchill McGee.**

**In Witness WHEREOF, the owner has hereunto signed this on this 9 day of May, 2016**

**NOTICE TO BUYER. DO NOT SIGN THIS CONTRACT BEFORE YOU READ IT OR IF IT CONTAINS BLANK SPACES. YOU ARE ENTITLED TO A COPY OF THE CONTRACT YOU SIGN. I (WE) HEREBY ACKNOWLEDGE DELIVERY OF A COPY OF THIS CONTRACT.**

**Contractor: TURLEY CONCRETE CONSTRUCTION Inc.**

**Accepted by** \_\_\_\_\_  
**Property owner**

\_\_\_\_\_  
**Date Signed**

\_\_\_\_\_  
**Representative TCC**

\_\_\_\_\_  
**Date Signed**



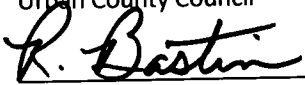

TO: Mayor Jim Gray  
Urban County Council

FROM:   
Ronnie Bastin, Commissioner, Public Safety

CC: Rick Curtis, Administrative Officer, Public Safety  
Jessica Walker, Administrative Officer, General Services

DATE: May 23, 2016

SUBJECT: Request a Resolution authorizing the Mayor, on behalf of the Urban County Government, to execute Change Order No. Fourteen (14) to the Contract with Churchill McGee, LLC, for Public Safety Operations Center Phase 1B Renovation, increasing the contract price by \$15,089.15 from \$6,649,661.24 to \$6,664,750.39 and an additional forty-four (44) working days.

**Request**

Authorization to Execute Change Order #14 with Churchill McGee, LLC in the amount of \$15,089.15 and an additional 44 working days to the construction schedule for the Public Safety Operations Center Phase 1B Renovation Contract #287-2014. The new contract total is \$6,664,750.39.

**Why are you requesting?**

Per the attached Contract Time Extension request, add 44 working days and no cost to the construction schedule due to a delay by Time Warner for installation of internet, which is required for use in remote testing of HVAC controls per Building Inspection. Per Proposal Request 51, add Hilti speed sleeves to seal penetrations into IDF 145A for dry chemical fire suppression operation for \$406.93. Per Proposal Request 53, modify the data cabinet power connections in Communications 140 per the attached instructions for \$1,939.90. Per Proposal Request 54, replace the sidewalk at the northwest corner of the building for \$6,754.00. Per Proposal Request 55, add EIFS at the edges of the cut precast panels for new openings for \$1,650.00 and two (2) working days. Per Proposal Request 56, add break metal at windows for exposed ends of column wraps for \$3,245.00. Per Proposal Request 57, remove and replace existing sidewalk/door stoop at Door V102 for \$1,093.32.

**What is the cost in this budget year and future budget years?**

The cost for this FY is: \$15,089.15

The cost for future FY is: N/A



**The funds are budgeted in:**

Account number:

FUND	DEPT ID	SECTION	ACCOUNT	AMOUNT
2606	505001	0001	91017	\$15,089.15

**File Number:**

Churchill McGee, LLC Contract #287-2014

**Director/Commissioner:**

Ronnie Bastin, Commissioner, Public Safety