

**LEXINGTON-FAYETTE URBAN COUNTY  
GOVERNMENT CONTRACT CHANGE ORDER**

Page 1 of 2

To (Contractor):  
Marrillia Design & Construction  
255 West Short Street  
Suite 325  
Lexington, KY 40507

Date	September 21, 2016
Project	Senior Citizen Center Constructio
Location	Lexington
Contract No.	227-2014
Original Contract Amt	\$8,882,900.00
Cumulative Amount of Previous Change Orders	\$1,644,470.37
Percent Change - Previous Change Orders	18.51%
Total Contract Amount Prior to this Change Order	\$10,527,370.37
Change Order No.	64

You are hereby requested to comply with the following changes from the contract plans and specification:

**Current Change Order**

Item No	Description of changes-quantities, unit prices, change in completion date, etc.	Increase in contract price	Decrease in contract price
1	Furnish & install Class II channel lining in detention basin per PR 110	\$9,781.00	
2	Credit pricing per PR		\$9,000.00
	Total decrease		\$9,000.00
	Total increase	\$9,781.00	
	Net Amount of this Change Order	\$781.00	
	New Contract Amount Including this Change Order		\$10,528,151.37
	Percent Change - This Change Order		0.01%
	Percent Change - All Change Orders		18.52%

The time provided for the completion in the contract and all provisions of the contract will apply hereto

Recommended by	<i>George Dumas</i>	(Project Manager)	Date	9/21/16
Accepted by	<i>Jack Marshall</i>	(Contractor)	Date	9/21/16
Approved by		(Director)	Date	
Approved by	<i>Jeffrey Pugh</i>	(Commissioner)	Date	9/21/16
Approved by	<i>Edwin C. Brown</i>	(Mayor or CAO)	Date	9/22/16

**JUSTIFICATION FOR CHANGE**

PROJECT: Senior Citizen Center Construction

CONTRACT NO. 227-2014

CHANGE ORDER # 64

- 1. Necessity for change: Channel lining is necessary to reduce amount of standing water in the detention basin. Emergency lane was deleted from the project with the Lexington Fire Department's approval.
  
- 2. Is proposed change an alternate bid? \_\_\_ Yes  X  No
- 3. Will proposed change alter the physical size of the project? \_\_\_ Yes  X  No  
If "Yes", explain.
  
- 4. Effect of this change on other prime contractors: N/A
  
- 5. Has consent of surety been obtained? \_\_\_ Yes  X  Not Necessary
- 6. Will this change affect expiration or extent of insurance coverage? \_\_\_ Yes  X  No  
If "Yes", will the policies be extended? \_\_\_ Yes \_\_\_ No
- 7. Effect on operation and maintenance costs:
  
- 8. Effect on contract completion date: 0 working days

*Glenn C. Brown*  
Mayor  
*Deputy CAO*

*9/22/16*  
Date



**Itemizing Owner Approval**  
**PR-123 Furnish and Install the Class II Channel Lining in the Detention Basin per Proposal Request No. 110**

Submit and install the Class II Channel Lining in the Detention Basin per Proposal Request No. 110

Approximate Area to Receive Class II Channel Lining:

Item Description	Quantity	Unit	Rate	Amount	Notes
DOT Class II Channel Lining	1,600	sf	1.18	1,888.00	
Equipment Mobilization and Demobilization (Compact Track Loader and CAT 315 Excavator)	100	hr	28.00	2,800.00	
Plywood for Protection of Existing Asphalt Walk Path and Parking Lot	4	ea	25.00	100.00	
CAT 315 Excavator for Class II Channel Lining Placement	1	hr	25.00	25.00	
Compact Track Loader for Class II Channel Lining Placement	12	hr	25.00	300.00	
Truck/Dump Truck to Move Class II Channel Lining from Parking Lot to Detention Basin	12	hr	25.00	300.00	
Truck/Dump Truck to Haul Class II Channel Lining from the Vulcan Materials Quarry	8	hr	25.00	200.00	
Labor to Assist in Temporary Protection and Placement of Class II Channel Lining	12	hr	15.00	180.00	
Compact Track Loader to Re-Grade Disturbed Areas	4	hr	14.00	56.00	
Labor to Assist in Re-Grading of Disturbed Areas and Removal of Temporary Protection	4	hr	15.00	60.00	
Straw Mat and Grass Seed to Re-Seed Disturbed Areas	1	ls	20.00	20.00	
<b>Total</b>				<b>3,039.00</b>	

Cost of In-Place Construction (Labor, Materials and Subcontractors):  
 Marietta Design and Construction Overhead/Profit  
 Overhead: Marietta Design and Construction  
 Profit: Marietta Design and Construction  
 General Liability Insurance (Contractor)  
 Bonder's Risk Premium  
 Performance and Payment Bond (Rate of \$9.40 per \$1,000 of Cost for \$2,500,000 - \$3,500,000)  
 Performance and Payment Bond (Rate of \$8.15 per \$1,000 of Cost for \$2,500,000 - \$3,500,000)  
 Performance and Payment Bond (Rate of \$7.20 per \$1,000 of Cost for \$5,000,000 and over)  
 KY Surcharge on Project Bonds (1.8% of Bond Cost)  
 Local Municipality Tax on Project Bonds (5% of Bond Cost)

Total Construction Cost: **3,781**



EOP Architects

# Proposal Request Transmittal

EOP Architects | 201 N. Short St. Suite 700 Lexington KY 40507 Office: 502-253-1000

PROJECT	LFUCG Senior Citizens' Center 201333	DATE SENT	9/2/2016
SHEET #	NW Basin Infill	PROPOSAL #	PR-110
TYPE	Proposal Request	PROJECT #	01027
STATUS	For Review and Response		Info Exchange

### FROM:

NAME	COMPANY	EMAIL	PHONE
Harding Dowell	EOP Architects	hdowell@eopa.com	(859) 231-7538

### TO:

NAME	COMPANY	EMAIL	PHONE
Jim Martin	Marrillia Design and Construction	jmartin@marrillia.com	(859) 685-0414

### REMARKS:

**Created by: Harding Dowell**  
Description:

At the northwest detention basin (nearest the creek), please fill the area currently ponding water with Class 2 channel lining, sloping the installation to drain toward the newly installed relief pipe. Please install per details in contract documents.

Thanks

Harding

Proposal Request - 01027

01027

9/2/2016

01027

DESCRIPTION OF CONTENTS

QTY	DATED	FILE	NUMBER	SCALE	SIZE	WIDTH
1	9/2/2016	PR-110_sketch.pdf				

COPIES:

Brian Gravitt	(Marrillia Design and Construction)
Josh Marrillia	(Marrillia Design and Construction)
Travis Harris	(Marrillia Design and Construction)
Joyce Thomas	(LFUCG)
Martin Woodford	(LFUCG)
Ramona Fry	(Element Design)

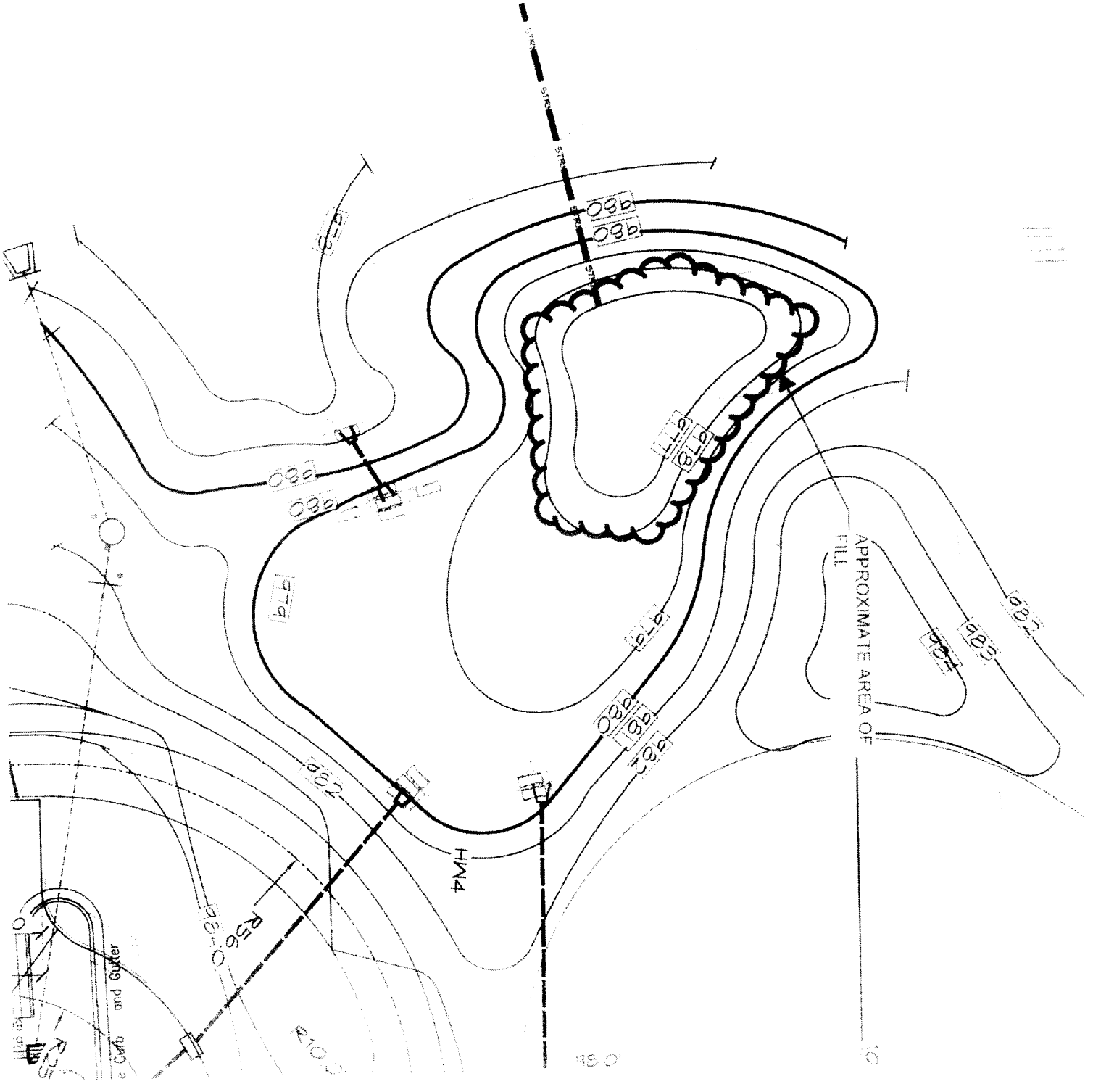



**Alternates**  
FIVE STAR RATED SENIOR CITIZEN CENTER  
DEPARTMENT OF TRANSPORTATION

**Remove the Emergency Access Lane from the Scope of the Contract per Proposal Request No. 70**

Remove the Emergency Access Lane from the Scope of the Contract per Proposal Request No. 70  
Credit for the Grasspave System at the Emergency Access Lane Decorative Paving Co. 1.1%

0 0

1.1%  
Decorative Paving Co.



192 Mt. Vernon Drive  
Georgetown, KY 40324

Office Phone: 502/863-6187  
Office Fax: 502/863-4901

Carl Hubbard Cell: 859/983-6133  
Ronnie Hubbard Cell: 859/983-6133

August 5, 2016

Marrillia Design & Construction  
259 West Short Street, Suite 325  
Lexington, KY 40507

Re: Lexington Senior Center -- **Emergency Curbs & Additional Concrete**  
Life Lane  
Lexington, KY

Dear Jim,

We are pleased to offer the following scope of work for the above referenced job:

**Scope of Work**

- A. Credit for curbs at Emergency Entrance - **\$1,400.00**
- B. Additional cost for bench seating - **\$1,400.00**

Please call with any questions.

Sincerely,  
Carl Hubbard, Member  
Hubbard Construction, LLC





# Proposal Request Transmittal

EOP Company: 101 West 11th Street, 700 Levee Drive, Suite 200, Lake Charles, LA 70601

PROJECT	LFUCG Senior Citizens' Center 201333	DATE	4/8/2016
ACTIVITY	Credit to Remove Emergency Lane	PROPOSAL NO.	PR-070
TYPE	Proposal Request	PROPOSAL ID	00948
STATUS	For Review and Response	STATUS	Info Exchange

### FOR

NAME	COMPANY	EMAIL	PHONE
Harding Dowell	EOP Architects	hdowell@eopa.com	(859) 231-7538

### TO

NAME	COMPANY	EMAIL
Travis Harris	Marrillia Design and Construction	tharris@marrillia.com

### NOTES

**Created by: Harding Dowell**

Description:

Per approval from the LFUCG Fire Department, please remove the emergency access lane from the scope of the contract and prepare a credit to the owner. Work to be removed includes, but is not limited to:

- Excavation to subgrade
- Grading surrounding areas to match emergency lane grades
- Installation of emergency lane curbs, gutters, drainage pipes, and P.C.S.
- Any work shown on the attached drawings and not the original EOP drawings.