

R-038-2016  
 Original: R-221-2016  
 Contract #: 013-2016

<b>LEXINGTON-FAYETTE URBAN COUNTY          GOVERNMENT CONTRACT CHANGE ORDER</b> Page 1 of 2	Date	February 17, 2017
	Project	Fire Station #2 Replacement
	Location	Lexington
To (Contractor) Olympic Construction, LLC 216 Bromme Drive Nicholasville, KY 40356	Contract No	013-2016
	Original Contract Amt	\$4,618,900.00
	Cumulative Amount of Previous Change Orders	\$62,387.83
	Percent Change - Previous Change Orders	1.35%
	Total Contract Amount Prior to this Change Order	\$4,681,287.83
	Change Order No	9

You are hereby requested to comply with the following changes from the contract plans and specification

**Current Change Order**

Item No	Description of changes-quantities, unit prices, change in completion date, etc	Decrease in contract price	Increase in contract price
1	Modify curb @ SE corner of Eastland & Murray Drives per Traffic Engineering, modify lighting controls, fire alarm strobe, smoke detector, and paging in Company Officers 104 per PR 11		\$6,407.50
	Total decrease	\$0.00	
	Total increase		\$6,407.50
	Net Amount of this Change Order	\$6,407.50	
	New Contract Amount Including this Change Order	\$4,687,695.33	
	Percent Change - This Change Order		0.14%
	Percent Change - All Change Orders		1.49%

The time provided for the completion in the contract and all provisions of the contract will apply hereto.

Recommended by	<i>Jasper Thomas</i>	(Project Manager)	Date	2/17/17
Accepted by	<i>[Signature]</i>	(Contractor)	Date	02/21/17
Approved by	<i>[Signature]</i>	(Director)	Date	2-21-17
Approved by	<i>[Signature]</i> (for Comm. need)	(Commissioner)	Date	2-21-17
Approved by	<i>[Signature]</i>	(Mayor or CAO)	Date	2-22-17

**JUSTIFICATION FOR CHANGE**

PROJECT: Fire Station #2 Replacement

CONTRACT NO. 013-2016

CHANGE ORDER NO. 9

1. Necessity for change: Traffic engineering has requested the SE corner curb modification. Operational changes has necessitated the modifications in Company Officers 104.
2. Is proposed change an alternate bid? \_\_\_ Yes  X  No
3. Will proposed change alter the physical size of the project? \_\_\_ Yes  X  No  
If "Yes", explain.
4. Effect of this change on other prime contractors: N/A
5. Has consent of surety been obtained? \_\_\_ Yes  X  Not Necessary
6. Will this change affect expiration or extent of insurance coverage? \_\_\_ Yes  X  No  
If "Yes", will the policies be extended? \_\_\_ Yes \_\_\_ No
7. Effect on operation and maintenance costs:
8. Effect on contract completion date: 0 working days

  
\_\_\_\_\_  
Mayor

2-22-17  
Date



**BRANDSTETTER  
CARROLL INC**

2360 Chauvin Dr  
LEXINGTON  
KY 40517  
859.268.1933  
FX: 859.268.3341

**Work Changes Proposal Request No. 11 Revised**

**Project:** 13117 Lexington Replacement Fire Station No. 2  
City Job No. 161-2015/038-2016

308 East 8<sup>th</sup> St  
CINCINNATI  
OH 45202  
513.651.4224  
FX: 513.651.0147

**To:** Olympic Construction  
216 Brome Dr.  
Nicholasville, KY 40356

1220 West 6<sup>th</sup> St  
Suite 300  
CLEVELAND  
OH 44113  
216.241.4480  
FX: 216.236.7155

**From:** Brandstetter Carroll Inc.  
2360 Chauvin Drive  
Lexington, KY 40517

**Date of Original Issuance:** February 7, 2017

**Date of Revised Issuance:** February 13, 2017

**Response Due:** ASAP

17300 Preston Rd  
Suite 310  
DALLAS  
TX 75252  
469.941.4926  
FX: 469.941.4112

**THIS IS NOT A CHANGE ORDER, CONSTRUCTION CHANGE DIRECTIVE, OR A DIRECTION  
TO PROCEED WITH THE WORK DESCRIBED IN THE PROPOSED MODIFICATION.**

Per owner request, please provide itemized pricing for the following items:

1. Modify curb at Southeast corner of Eastland and Murray Drive to provide ADA accessible curb cut as shown in PR 11.1 per LFUCG Standards. Extend new section of sidewalk to tie into existing sidewalk.
2. Add lighting control relay to a light fixture Type A in Company Officers Room 104 and tie into Zone 2 (Zone with the Bunk Room 109) so it is activated by the Station Alert Zone.
3. Add smoke detector with CO Sensor to Company Officers Room 104.
4. Modify Fire Alarm strobe in Company Officers 104 to low frequency horn/strobe combo unit.
5. Modify Paging Speaker in Company Officers 104 by connecting it to Zone 2 (Zone with the Bunk Room 109).

Please include detailed breakdowns of pricing for the items listed above. Provide material and labor pricing breakdowns for each item listing the quantities and unit costs associated with each item.

Attachments: PR 11.1

Submitted by:

Eric M. Chambers, AIA, CID, CDT, LFED GA  
Associate

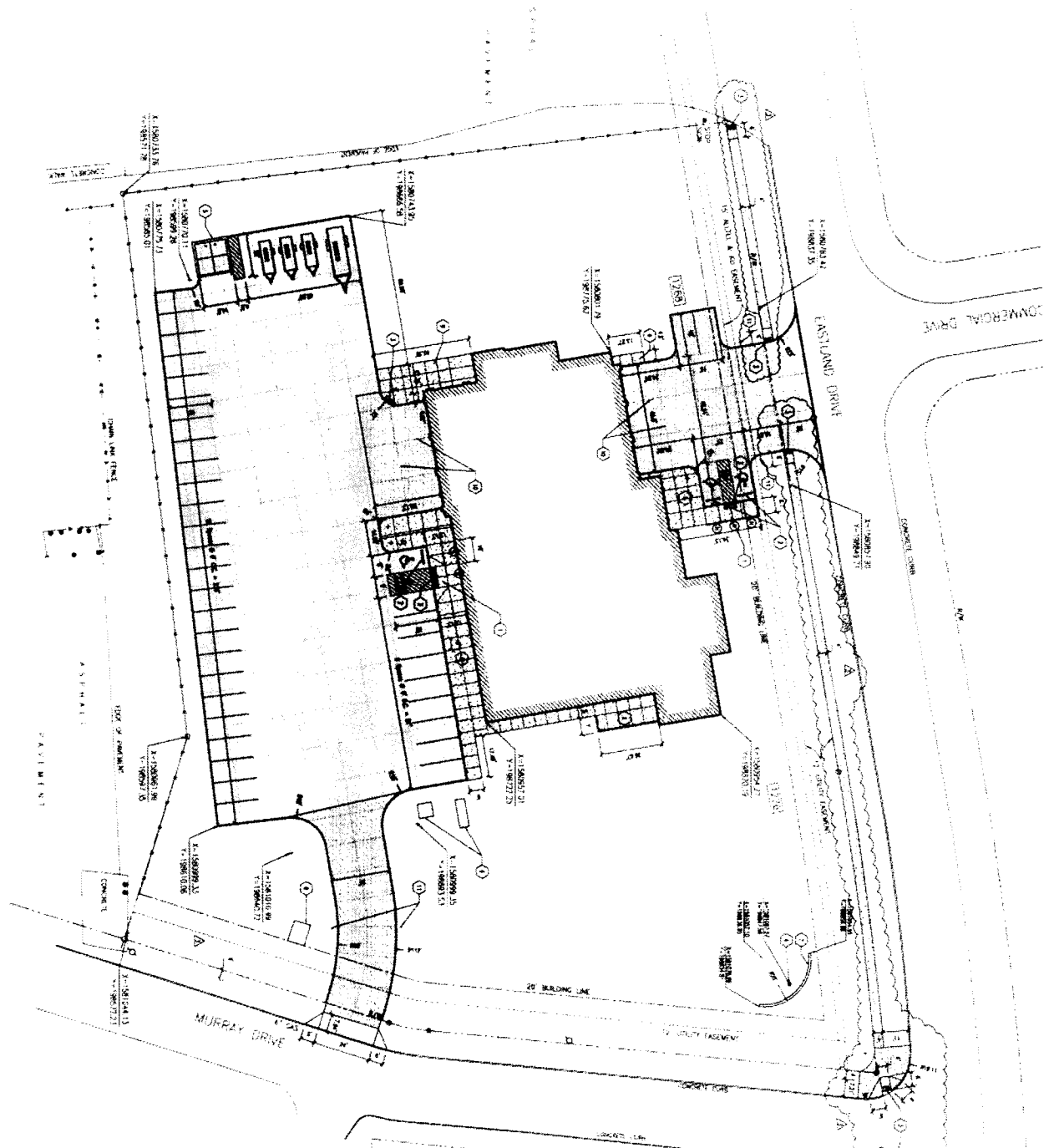

**Coded Notes**

- 1. EXISTING ASPHALT DRIVE
- 2. EXISTING ASPHALT DRIVE
- 3. EXISTING ASPHALT DRIVE
- 4. EXISTING ASPHALT DRIVE
- 5. EXISTING ASPHALT DRIVE
- 6. EXISTING ASPHALT DRIVE
- 7. EXISTING ASPHALT DRIVE
- 8. EXISTING ASPHALT DRIVE
- 9. EXISTING ASPHALT DRIVE
- 10. EXISTING ASPHALT DRIVE
- 11. EXISTING ASPHALT DRIVE
- 12. EXISTING ASPHALT DRIVE
- 13. EXISTING ASPHALT DRIVE
- 14. EXISTING ASPHALT DRIVE
- 15. EXISTING ASPHALT DRIVE

**General Notes**

1. THE EXISTING ASPHALT DRIVE SHALL BE REPAIRED TO MEET THE REQUIREMENTS OF THE CITY OF DENVER. THE REPAIR SHALL BE DONE IN ACCORDANCE WITH THE CITY OF DENVER SPECIFICATIONS FOR ASPHALT DRIVE REPAIR. THE REPAIR SHALL BE DONE IN ACCORDANCE WITH THE CITY OF DENVER SPECIFICATIONS FOR ASPHALT DRIVE REPAIR. THE REPAIR SHALL BE DONE IN ACCORDANCE WITH THE CITY OF DENVER SPECIFICATIONS FOR ASPHALT DRIVE REPAIR.

**Legend**

- 1. EXISTING ASPHALT DRIVE
- 2. EXISTING ASPHALT DRIVE
- 3. EXISTING ASPHALT DRIVE
- 4. EXISTING ASPHALT DRIVE
- 5. EXISTING ASPHALT DRIVE
- 6. EXISTING ASPHALT DRIVE
- 7. EXISTING ASPHALT DRIVE
- 8. EXISTING ASPHALT DRIVE
- 9. EXISTING ASPHALT DRIVE
- 10. EXISTING ASPHALT DRIVE
- 11. EXISTING ASPHALT DRIVE
- 12. EXISTING ASPHALT DRIVE
- 13. EXISTING ASPHALT DRIVE
- 14. EXISTING ASPHALT DRIVE
- 15. EXISTING ASPHALT DRIVE



13117  
 161 2015  
 C-101



# OLYMPIC CONSTRUCTION

120 MacArthur Court  
Nicholasville, KY 40356

Office 859-533-5723 Fax 859-881-1295  
victor@olympicconstruction.com

## Lexington Fire Station No. 2 Change Order Proposal Request 11

Per owner request, pricing for the following items:

1) Modify curb at Southeast corner of Eastland and Murray Drive to provide ADA accessible curb cut as shown in PR 11.1 per LFUCG Standards. Extend new section of sidewalk to tie into existing sidewalk. Materials \$820 Labor 48 hrs. @ \$45 per hr. = \$2,160	<b>\$2,980.00</b>
2) Add lighting control relay to a light fixture Type A in Company Officers Room 104 and tie into Zone 2 (Zone with the Bunk Room 109) so it is activated by the Station Alert Zone. Materials \$782 Labor 9 hrs. @ \$62 per hr. = \$558	<b>\$1,340.00</b>
3) Add smoke detector with CO Sensor to Company Officers Room 104. Materials \$353 Labor 9 hrs. @ \$62 per hr. = \$558	<b>\$911.00</b>
4) Modify Fire Alarm strobe in Company Officers 104 to low frequency horn/strobe combo unit. Materials \$95 Labor 1.5 hrs. @ \$62 per hr. = \$93	<b>\$188.00</b>
5) Modify Paging Speaker in Company Officers 104 by connecting it to Zone 2 (Zone with the Bunk Room 109). Materials \$89 Labor 1.5 hrs. @ \$62 per hr. = \$93	<b>\$182.00</b>
<b>Actual Cost Overhead</b> Bonds/Insurance \$224	<b>\$224.00</b>
<b>Total</b>	<b>\$5,825.00</b>
<b>10% Profit</b>	<b>\$582.50</b>
<b>Grand Total</b>	<b>\$6,407.50</b>

Contractor: Olympic Construction Representative: Victor Kunitsa

Signature: Victor Kunitsa Date: 02/14/2017