

P.O.B.
 N: 206,362.59
 E: 1,561,932.05

1498-1499 MEADOWTHORPE AVE.
 FECK STEPHEN M
 D.B. 2962, PG. 542
 PLAT: E-728A9
 PVA ID: 13387350
 ZONE: B-1

1492-1494 MEADOWTHORPE AVE.
 CRESTWOOD REAL ESTATE HOLDINGS
 LLC
 D.B. 2480, PG. 448
 PVA ID: 46787600
 ZONE: B-1

1478-1480 MEADOWTHORPE AVE.
 MORAN JOHN M
 D.B. 3099, PG. 61
 PLAT: E-728
 PVA ID: 43810400
 ZONE: B-1

1488-1488 MEADOWTHORPE AVE.
 PITCHFORD ELIZABETH R
 D.B. 2037, PG. 732
 PVA ID: 44093250
 ZONE: B-1

1474-1476 MEADOWTHORPE AVE.
 WOOD HARRY JR & CORINE
 & CARTER SHIRLEY
 D.B. 2928, PG. 632
 PLAT: E-728
 PVA ID: 44857350
 ZONE: B-1

1468-1470 MEADOWTHORPE AVE.
 WARMAN ROBA
 D.B. 3476, PG. 100
 PLAT: E-728
 PVA ID: 42591700
 ZONE: B-1

1462 MEADOWTHORPE AVE.
 EBERS LULA D
 D.B. 2594, PG. 9
 PVA ID: 44083650
 ZONE: B-1

1456 MEADOWTHORPE AVE.
 HENDERSON WILLIAM J &
 BRENDA L
 D.B. 2897, PG. 590
 PVA ID: 42581300
 ZONE: B-1

1447 ANTIQUE DR.
 MEADOWTHORPE
 DEVELOPMENT COMPANY LLC
 D.B. 3360, PG. 454
 PLAT: R-377

1447 Antique Dr.
 Change Requested
 from ZONE B-1 to R-4
 Gross Area: 4.327 Acres
 Net Area 3.719 Acres

1422 N FORBES RD.
 COLE JOHN WILLIAM
 D.B. 3217, PG. 563
 PLAT: R-377
 PVA ID: 34372000
 ZONE: B-1

PROPERTY MAP
 SCALE: 1"=100'

VICINITY MAP
 N.T.S.

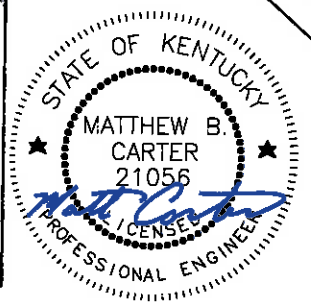
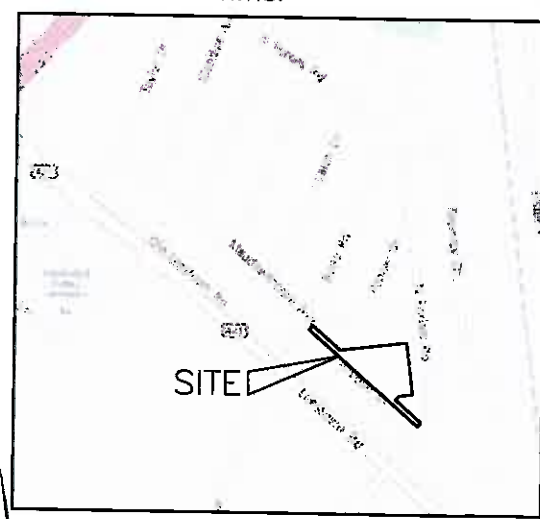

1408 N FORBES RD.
 S & B CATTLE CO
 SAUNDERS BUCHER BARBER
 D.B. 1835, PG. 196
 PLAT: A-058A
 PVA ID: 36623500
 ZONE: B-1

1400 N FORBES RD.
 J & C CAMPBELL
 INVESTMENT COMPANY
 D.B. 3100, PG. 704
 PLAT: A-58
 PVA ID: 44410800
 ZONE: B-1

NOTIFICATION MAP
 SCALE: 1"=200'

ZOMAR:	TITLE: Meadowthorpe Community Business Center Unit 1			
PROPERTY ADDRESS:	FROM	TO	GROSS	NET
1447 Antique Drive	B-1	R-4	4.327	3.719
APPLICANT NAME / ADDRESS:				
Meadowthorpe Senior Housing, LLLP				
159 Old Georgetown Street				
LEXINGTON, KY 40508				
OWNER: Meadowthorpe Development Co., LLC				
PREPARED BY: VISION ENGINEERING, LLC				
DATE FILED OR AMENDED: July 18, 2017	TOTAL		4.327	3.719