

R-8-2014
1 0 - 1

CONSULTANT SERVICES AGREEMENT

THIS IS AN AGREEMENT made as of January 16, 2014 between the LEXINGTON-FAYETTE URBAN COUNTY GOVERNMENT (**OWNER**) and EOP ARCHITECTS (**CONSULTANT**). **OWNER** intends to proceed with architectural/engineering design services as described in the attached Request for Proposal document. The services are to include the preparation of complete plans and specifications for the construction of the Replacement Senior Citizen Center as contemplated in the **OWNER**'s Request for Proposal No. 28-2013. The services are hereinafter referred to as the Project.

OWNER and **CONSULTANT** in consideration of their mutual covenants herein agree in respect of the performance of professional architectural/engineering services by **CONSULTANT** and the payment for those services by **OWNER** as set forth below.

CONSULTANT was selected by **OWNER** based upon its response to the Request for Proposal No. 28-2013.

CONSULTANT shall provide professional consulting services for **OWNER** in all phases of the Project to which this Agreement applies, serve as **OWNER'S** professional architectural and engineering representative for the Project as set forth below and shall give professional consultation and advice to **OWNER** during the performance of services hereunder.

SECTION 1 - BASIC SERVICES OF CONSULTANT

CONSULTANT shall perform professional services as hereinafter stated which include customary architectural and engineering incidental thereto.

The following documents are incorporated by reference herein as if fully stated and are attached hereto as exhibits: RFP No. 28-2013 (Exhibit "A"- revised 1/3/2014) and Consultant's Response dated November 5, 2013 (Exhibit "B").

To the extent there is conflict among their provisions, the provisions of this Agreement shall take precedence, followed by the provisions of Request for Proposal No. 28-2013 (Exhibit "A"- revised 1/3/2014).

After written authorization to proceed with Phase A Schematic Design Phase, **CONSULTANT** shall:

1. Notify the **OWNER** in writing of its authorized representative who shall act as Project architect and liaison representative between the **CONSULTANT** and the **OWNER**.
2. On the basis of "Selection Criteria" in the "Request for Proposal", attached in Exhibit "A", conduct field surveys and gather other necessary data or information, conduct public meetings with personnel pre-approved by LFUCG, prepare Phase A schematic design documents consisting of design

criteria, energy modeling, preliminary drawings, outline specifications, and cost estimates as well as all required deliverables listed in the Request for Proposal. See Exhibit "A" for complete listing of all Phase A through Phase D deliverables.

3. The Consultant has identified John Catlin, AIA as their Senior Center Specialist for the project and has included all expenses associated with Mr. Catlin's travel expenses associated with three trips to Lexington in their Basic Services Fee Amount. The purpose and timing of these three trips shall be at the discretion of the Owner and shall be coordinated with Mr. Catlin's availability. It is assumed that Mr. Catlin will attend the Senior Commission to Senior Services Commission Workshop, the Design Charrette and the Public Meeting to present the project's Schematic Design. In the event that the Owner requests Mr. Catlin to travel to Lexington more than the three times included within the Consultant's Basic Service Fee Amount, the costs and expenses associated with Mr. Catlin's trips beyond the three stated shall be at Additional Services and cost to the Owner.

This Agreement (consisting of pages 1 to 10 inclusive), together with the Exhibits and schedules identified above constitutes the entire Agreement between **OWNER** and **CONSULTANT** and supersedes all prior written or oral understandings. This Agreement and said Exhibits and schedules may only be amended, supplemented, modified, or canceled by a duly executed written instrument.

The General Condition provisions of RFP No. 28-2013 are incorporated herein by reference as if fully stated.

SECTION 2 - ADDITIONAL SERVICES BY CONSULTANT

- 2.1. The **OWNER** may desire to have the **CONSULTANT** perform work or render services in connection with this Project other than provided by Exhibit A of this Agreement. Such work shall be considered as "Additional Services", subject to a change order, supplemental to this Agreement, setting forth the character and scope thereof and the compensation therefore. Work under such change order shall not proceed until the **OWNER** gives written authorization. Should the **OWNER** find it desirable to have previously satisfactorily completed and accepted plans or parts thereof revised, the **CONSULTANT** shall make such revisions as directed, in writing, by the **OWNER**. This work shall be considered as "Additional Services" and shall be paid as such.
- 2.2. All "Additional Services" is subject to prior written authorization of **OWNER** and necessary appropriations made by the Urban County Council.

SECTION 3 - OWNER'S RESPONSIBILITIES

OWNER shall:

- 3.1.** Provide criteria and information as to **OWNER'S** requirements for the Project, including design objectives and constraints, space, capacity and performance requirements, flexibility and expandability, and any budgetary limitations.
- 3.2.** Assist **CONSULTANT** by placing at his disposal available information pertinent to the Project.
- 3.3.** Examine all studies, reports, sketches, drawings, specifications, proposals and other documents presented by **CONSULTANT**, and render in writing decisions pertaining thereto within a reasonable time so as not to delay the services of **CONSULTANT**.
- 3.4.** Designate in writing a person to act as **OWNER'S** representative with respect to the services to be rendered under this Agreement. Such person shall have complete authority to transmit instructions, receive information, interpret and define **OWNER'S** policies and decisions with respect to materials, equipment, elements and systems pertinent to **CONSULTANT'S** services.
- 3.5.** Give written notice to **CONSULTANT** whenever **OWNER** observes or otherwise becomes aware of any development that affects the scope or timing of **CONSULTANT'S** services, or any defect in the work of Contractor(s).
- 3.6.** Furnish or direct **CONSULTANT** to provide, necessary Additional Services as stipulated in Section Two (2) of this Agreement or other services as required.

SECTION 4 - PERIOD OF SERVICES

- 4.1.** Time is of the essence. See Exhibit "A" (attached) for the project schedule.
- 4.2.** The provisions of this Section Four (4) and the various rates of compensation for **CONSULTANT'S** services provided for elsewhere in this Agreement have been agreed to in anticipation of the orderly and continuous progress of the Project through completion.

If delays result by reason of acts of the **OWNER** or approving agencies or other causes, which are beyond the control of the **CONSULTANT**, an extension of time for such delay will be considered. If delays occur, the **CONSULTANT** shall within 30 days from the date of the delay apply in writing to the **OWNER** for an extension of time for such reasonable period as may be mutually agreed upon between the parties, and if approved, the Project schedule shall be revised to reflect the extension. Such extension of time to the completion date shall in no way be construed to operate as a waiver on the part of the **OWNER** of any

of its rights in the Agreement. Section 6.5, under DISPUTES, of this Agreement, shall apply in the event the parties cannot mutually agree upon an extension of time.

In the event that the overall delay resulting from the above described causes is sufficient to prevent complete performance of the Agreement within six (6) months of the time specified therein, the Agreement fee or fees shall be subject to reconsideration and possible adjustment. Section 6.5 of this Agreement shall apply in the event the parties cannot mutually agree upon an adjustment of fee.

SECTION 5 - PAYMENTS TO CONSULTANT

5.1 Methods of Payment for Services of CONSULTANT

5.1.1 For Basic Services.

All Lump Sum Pricing shall include all direct labor and supervision necessary to complete the item in a manner that meets or exceeds the customer's satisfaction. It shall also include the labor payroll costs, overhead (such as unemployment taxes, general liability insurance, rent, utilities, phones, supplies, administrative salaries, F.I.C.A. sick and vacations, etc. disposal fees tool allowance, equipment, materials, profit and all other costs used on the job. The negotiated cost of services is represented below.

Provide a Firm Lump Sum Cost for providing LFUCG with services as noted in these specifications.

<u>Phase A Cost (Total Cost of Services Below)</u>	<u>\$158,965</u>
Programming/Space Utilization:	\$17,325
Geotechnical Survey and Report:	\$6,700
Environmental Survey and Report (if required):	Not Applicable
Schematic Design:	\$115,000
Building Commissioning:	\$2,800
Building Energy Model:	\$8,500
Interior Design:	\$5,040
Independent Cost Estimator:	\$3,600

The LFUCG reserves the right to negotiate the following fees with the selected Consultant for Phase A or solicit new proposals for Phases B – D. Phase B - D proposals shall be valid for 12 months from contract award.

<u>Phase B Cost (Total Cost of Services Below)</u>	<u>\$14,700 + 1.5%</u>
Design Development: (percentage of construction costs)	1.5%
Building Commissioning:	\$3,000
Interior Design:	\$6,300
Independent Cost Estimator:	\$5,400
<u>Phase C Cost (Total Cost of Services Below)</u>	<u>\$74,970 + 2.1%</u>
Construction Documents: (percentage of construction costs)	2.1%
Building Energy Model:	\$14,000
LEED Certification:	\$33,000
Building Commissioning:	\$6,150
Independent Cost Estimator:	\$7,000
Interior Design:	\$8,820
Signage:	\$6,000
<u>Phase D Cost (Total Cost of Services Below)</u>	<u>\$119,700 + 0.4%</u>
Bidding Assistance:	\$4,200
Construction Administration:	\$103,500
Building Commissioning: (0.4% of construction)	0.4%
Punch List, Inspections, & Close Out:	\$12,000

Unit Pricing

- a. LFUCG reserves the right to increase or decrease frequencies of unit cost i.e., each task and / or services under this agreement. If Additional Services are requested, the base contract may be increased and/or decreased on the basis of these proposed unit rates. No price adjustments will be made, unless mutually agreed to in advance or as a result of temporary conditions (defined as 30 days or less from the date of the last invoice).
- b. All Unit Pricing Hourly Rates shall include all direct labor, any supervision required, labor payroll costs, overhead (such as unemployment taxes, general liability insurance, rent, utilities, phones, supplies, administrative salaries, F.I.C.A. sick and vacations, etc.) disposal fees tool allowance, equipment, materials, profit and all other costs used on the job.

<u>Title/Skill Level</u>	<u>Hourly Rate</u>
Principal	\$175/HR
Project Manager	\$130/HR
Registered Architect	\$130/HR
Graduate Architect	\$100/HR
CADD / Draftsperson	\$100/HR
Clerical	\$65/HR
Senior Interior Designer	\$100/HR
Interior Designer	\$85/HR
Graphic Designer	\$95/HR
Design Specialist (John Catlin)	\$225/HR
Senior Engineer	\$130/HR
Project Engineer	\$100/HR

- c. Additional Services may require procurement beyond the base contract. Procurement shall comply with the specifications set forth herein. The Consultant markup over the invoiced price shall be 1.15%.

5.2. Times of Payment.

5.2.1. **CONSULTANT** shall submit a schedule of values subject to approval by the **OWNER** prior to starting work. The approved schedule of values will be the basis for monthly statements for Basic Services and Additional Services rendered. The Statements will be based upon **CONSULTANT'S** estimate of the proportion of the total services actually completed at the time of billing and are subject to approval by the **OWNER**. **OWNER** shall pay **CONSULTANT'S** monthly statements within thirty (30) days of receipt.

5.3. Other Provisions Concerning Payments.

5.3.1. In the event the Agreement is terminated by the **OWNER** without fault on the part of the **CONSULTANT**, the **CONSULTANT** shall be paid for the work performed or services rendered an amount bearing the same ratio to the total Agreement fee as the amount of work completed or partially completed and delivered to the **OWNER** is to the total amount of work provided for herein, as determined by mutual agreement between the **OWNER** and the **CONSULTANT**.

5.3.2. In the event the services of the **CONSULTANT** are terminated by the **OWNER** for fault on the part of the **CONSULTANT**, the **CONSULTANT** shall be paid reasonable value of the work performed or services rendered and delivered, and the amount to be paid shall be determined by the **OWNER**.

5.3.3. In the event the **CONSULTANT** shall terminate the Agreement because of gross delays caused by the **OWNER**, the **CONSULTANT** shall be paid as set forth in Section 5.3.1. above.

SECTION 6 – ADDITIONAL GENERAL CONSIDERATIONS

6.1. Termination

6.1.1. The obligation to provide further services under this Agreement may be terminated by either party upon ten (10) days written notice in the event of substantial failure by the other party to perform in accordance with the terms hereof through no fault of the terminating party, provided the non-terminating party fails to cure such default within the ten (10) day period.

6.1.2. The **OWNER** reserves the right to terminate the Agreement for any reason at any time upon seven (7) days written notice to the **CONSULTANT**.

6.2. Ownership and Reuse of Documents

All documents, including Drawings and Specifications, prepared by the **CONSULTANT** pursuant to this Agreement shall be delivered to and become the property of the **OWNER**. The **OWNER** shall have the right to reuse same without restriction or limitation, but without liability or legal exposure to **CONSULTANT**.

6.3. Legal Responsibilities and Legal Relations.

6.3.1. The **CONSULTANT** shall familiarize himself with and shall at all times comply with all federal, state and local laws, ordinances, and regulations which in any manner affect the services of this Agreement.

6.3.2. In performing the services hereunder, the **CONSULTANT** and its **CONSULTANTS**, employees, agents and representatives shall not be deemed or construed to be employees of **OWNER** in any manner whatsoever. Except as otherwise provided in this Agreement, the **CONSULTANT** shall be acting as an independent contractor. The **CONSULTANT** shall not hold itself out as, nor claim to be, an officer or employee of **OWNER** by reason hereof and shall not make any claim, demand or application to or for any right or privilege applicable to an officer or employee of **OWNER**. The **CONSULTANT** shall be solely responsible for any claims for wages or compensation by **CONSULTANT'S** employees, agents and representatives, including **CONSULTANTS**, and shall save and hold **OWNER** harmless therefrom.

6.3.3. The parties hereto agree that causes of actions between the parties shall be governed by applicable provisions of the Kentucky Revised Statues.

6.4. Successors and Assigns.

6.4.1. **CONSULTANT** binds itself and his partners, successors, executors, administrators, assigns and legal representatives to this Agreement in respect to all

covenants, agreements and obligations of this Agreement. **CONSULTANT** shall not assign any interest, obligation or benefit in this Agreement. **CONSULTANT** shall not assign any interest, obligation or benefit in this Agreement or transfer any interest in the same, whether by assignment or novation, without prior written consent of **OWNER**.

6.4.2. The **CONSULTANT** shall not subcontract more than fifty percent (50%) of the work, based upon dollar value, to be provided under this Agreement. The **CONSULTANT** shall obtain written approval prior to subletting or assigning any services contained in this Agreement, and consent to sublet or assign any part of this Agreement shall not be construed to relieve the **CONSULTANT** of any responsibility for compliance with the provisions of this Agreement.

6.4.3. Nothing herein shall be construed to give any rights or benefits hereunder to anyone other than **OWNER** and **CONSULTANT**.

6.5. Disputes

Except as otherwise provided in this Agreement, any dispute concerning the amount of payment due the **CONSULTANT** or any dispute concerning any question of fact of any act to be performed under this Agreement, which is not disposed of by agreement between the Urban County Division of Central Purchasing and the **CONSULTANT**, shall be submitted to the Commissioner, Department of General Services, Lexington-Fayette Urban County Government for review. The decision of the Commissioner as to the determination of such dispute shall be final and conclusive unless determined by a court of competent jurisdiction to have been fraudulent, capricious, arbitrary or so grossly erroneous as necessarily to imply bad faith. Pending a final decision of a dispute hereunder, the **CONSULTANT** shall proceed diligently with the performance of the Agreement in accordance with the directions of the **OWNER**.

6.6. Accuracy of CONSULTANT'S Work.

The **CONSULTANT** shall be required to perform this Agreement in accordance with the degree of ordinary and reasonable skill and care usually exercised by professional architects and engineers prevailing at the time, place and under similar conditions as the services hereunder are rendered.

The **CONSULTANT** shall be responsible for the accuracy of all work, even though Drawings and Specifications have been accepted by the **OWNER**, and shall make any necessary revisions or corrections resulting from errors and/or omissions on the part of the **CONSULTANT**, without additional compensation. By submission of reports, soils and subsurface information, quantities estimates, calculations and Drawings and Specifications to the **OWNER**, the **CONSULTANT** has made a statement that, to the best of its belief and knowledge, the information is accurate. Failure on the part of **CONSULTANT** to provide the expected level of accuracy may be grounds for the **OWNER** to disqualify **CONSULTANT** from consideration for future **CONSULTANT** service agreements.

6.7. Security Clause.

The **CONSULTANT** certifies that he shall not at any time release or divulge any information concerning the services covered by this Agreement to any person or any public or private organization except the **OWNER** without prior approval of the **OWNER**.

6.8. Access to Records.

The **CONSULTANTS** and his sub-**CONSULTANTS** shall maintain all books, documents, papers, and accounting records, and make such materials available at their respective offices at all reasonable times during the contract period and for three (3) years from the date of final payment under the contract for inspection by the **OWNER**, and copies thereof shall be furnished if requested. Failure to maintain such records for three (3) years after the date of final payment may be grounds for the **OWNER** to disqualify the **CONSULTANT** from consideration for future **CONSULTANT** service agreements.

6.9. Resident Services During Construction.

The **OWNER** reserves the right to furnish a Resident Project Inspector.

6.10. Required Risk Management Provisions.

The Risk Management Provisions of RFP No. 28-2013 (revised 1/3/2014) are incorporated herein by reference as if fully stated. Copies of the required Certificates of Insurance shall be provided to **OWNER** as required therein.

SECTION 7 - EQUAL EMPLOYMENT OPPORTUNITY

During the performance of this service agreement, the **CONSULTANT** agrees as follows:

- 7.1.** The **CONSULTANT** will not discriminate against any employee or application for employment because of race, color, religion, national origin, sex, age or handicap. The **CONSULTANT** will take affirmative action to ensure that applicants are employed, and that employees are treated during employment without regard to their race, color, religion, national origin, sex, age or handicap. Such action shall include, but not be limited to the following: employment upgrading, demotion or transfer, recruitment or recruitment advertising, layoff or termination; rates of pay or other forms of compensation; and selection for training, including apprenticeships. The **CONSULTANT** agrees to post in conspicuous places, available to employees and applicants for employment, notices to be provided setting forth the provisions of this non-discrimination clause.
- 7.2** The **CONSULTANT** will, in all solicitations or advertisements for employees placed by or on behalf of the **CONSULTANT**, state that all qualified applicants will receive consideration for employment without regard to race, color, religion, national origin, sex, age (between forty and seventy), or handicap.

SECTION 8 - SPECIAL PROVISIONS

8.1. This Agreement is subject to the following provisions.

8.1.2. Pursuant to subparagraph 3.4 of this Agreement, **OWNER** has assigned the appropriate LFUCG employee (the "**OWNER'S** Agent"), as the authorized agent of **OWNER**, to monitor, direct and review the performance of work of the **CONSULTANT**. Documents, data, reports and all matters associated with carrying out this Agreement shall be addressed to the **OWNER'S** Agent or their designee. Questions by the **CONSULTANT** regarding interpretations of the terms, provisions and requirements under this Agreement shall be addressed to the **OWNER'S** Agent or their designee. The **CONSULTANT** shall look only to the **OWNER'S** Agent or their designee for direction in its performance under this Agreement; no other direction shall be binding upon **OWNER**. **OWNER** shall respond to written requests by **CONSULTANT** within thirty (30) days.

IN WITNESS WHEREOF, the parties hereto have made and executed this Agreement as of the day and year first above written.

OWNER:

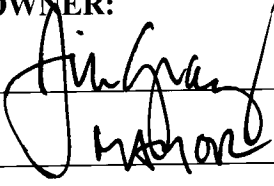

LFUCG

CONSULTANT:



Richard Polk, Jr., AIA, LEED AP

EOP Architects



CERTIFICATE OF LIABILITY INSURANCE

DATE (MM/DD/YYYY)

12/30/2013

THIS CERTIFICATE IS ISSUED AS A MATTER OF INFORMATION ONLY AND CONFERS NO RIGHTS UPON THE CERTIFICATE HOLDER. THIS CERTIFICATE DOES NOT AFFIRMATIVELY OR NEGATIVELY AMEND, EXTEND OR ALTER THE COVERAGE AFFORDED BY THE POLICIES BELOW. THIS CERTIFICATE OF INSURANCE DOES NOT CONSTITUTE A CONTRACT BETWEEN THE ISSUING INSURER(S), AUTHORIZED REPRESENTATIVE OR PRODUCER, AND THE CERTIFICATE HOLDER.

IMPORTANT: If the certificate holder is an ADDITIONAL INSURED, the policy(ies) must be endorsed. If SUBROGATION IS WAIVED, subject to the terms and conditions of the policy, certain policies may require an endorsement. A statement on this certificate does not confer rights to the certificate holder in lieu of such endorsement(s).

PRODUCER The Underwriters Group, Inc. 1700 Eastpoint Parkway P.O. Box 23790 Louisville, KY 40223	CONTACT NAME: PHONE (A/C, No, Ext): 502-244-1343 E-MAIL ADDRESS:	FAX (A/C, No): 502-244-1411													
	<table border="1"> <thead> <tr> <th>INSURER(S) AFFORDING COVERAGE</th> <th>NAIC #</th> </tr> </thead> <tbody> <tr> <td>INSURER A: Travelers Indemnity Co Of America</td> <td>25666</td> </tr> <tr> <td>INSURER B: Travelers Property Casualty Co of Amer</td> <td>25674</td> </tr> <tr> <td>INSURER C: Travelers Indemnity Company</td> <td>25658</td> </tr> <tr> <td>INSURER D: Charter Oak Fire Insurance Company</td> <td>25615</td> </tr> <tr> <td>INSURER E: Atlantic Specialty Insurance Company</td> <td>27154</td> </tr> <tr> <td>INSURER F:</td> <td></td> </tr> </tbody> </table>		INSURER(S) AFFORDING COVERAGE	NAIC #	INSURER A: Travelers Indemnity Co Of America	25666	INSURER B: Travelers Property Casualty Co of Amer	25674	INSURER C: Travelers Indemnity Company	25658	INSURER D: Charter Oak Fire Insurance Company	25615	INSURER E: Atlantic Specialty Insurance Company	27154	INSURER F:
INSURER(S) AFFORDING COVERAGE	NAIC #														
INSURER A: Travelers Indemnity Co Of America	25666														
INSURER B: Travelers Property Casualty Co of Amer	25674														
INSURER C: Travelers Indemnity Company	25658														
INSURER D: Charter Oak Fire Insurance Company	25615														
INSURER E: Atlantic Specialty Insurance Company	27154														
INSURER F:															
INSURED EOP Architects, PSC 201 West Short Street #700 Lexington, KY 40508															

COVERAGES**CERTIFICATE NUMBER:****REVISION NUMBER:**

THIS IS TO CERTIFY THAT THE POLICIES OF INSURANCE LISTED BELOW HAVE BEEN ISSUED TO THE INSURED NAMED ABOVE FOR THE POLICY PERIOD INDICATED. NOTWITHSTANDING ANY REQUIREMENT, TERM OR CONDITION OF ANY CONTRACT OR OTHER DOCUMENT WITH RESPECT TO WHICH THIS CERTIFICATE MAY BE ISSUED OR MAY PERTAIN, THE INSURANCE AFFORDED BY THE POLICIES DESCRIBED HEREIN IS SUBJECT TO ALL THE TERMS, EXCLUSIONS AND CONDITIONS OF SUCH POLICIES. LIMITS SHOWN MAY HAVE BEEN REDUCED BY PAID CLAIMS.

INSR LTR	TYPE OF INSURANCE	ADDL INSR	SUBR WVD	POLICY NUMBER	POLICY EFF (MM/DD/YYYY)	POLICY EXP (MM/DD/YYYY)	LIMITS
A	GENERAL LIABILITY <input checked="" type="checkbox"/> COMMERCIAL GENERAL LIABILITY CLAIMS-MADE <input checked="" type="checkbox"/> OCCUR GEN'L AGGREGATE LIMIT APPLIES PER: <input type="checkbox"/> POLICY <input type="checkbox"/> PRO-JECT <input type="checkbox"/> LOC			6801479L639TIA13	05/01/2013	05/01/2014	EACH OCCURRENCE \$1,000,000 DAMAGE TO RENTED PREMISES (Ea occurrence) \$1,000,000 MED EXP (Any one person) \$10,000 PERSONAL & ADV INJURY \$1,000,000 GENERAL AGGREGATE \$2,000,000 PRODUCTS - COMP/OP AGG \$2,000,000
B	AUTOMOBILE LIABILITY <input type="checkbox"/> ANY AUTO <input checked="" type="checkbox"/> ALL OWNED AUTOS <input type="checkbox"/> HIRED AUTOS <input type="checkbox"/> SCHEDULED AUTOS <input checked="" type="checkbox"/> NON-OWNED AUTOS			BA2698L92613GRP	05/01/2013	05/01/2014	COMBINED SINGLE LIMIT (Ea accident) \$1,000,000 BODILY INJURY (Per person) \$ BODILY INJURY (Per accident) \$ PROPERTY DAMAGE (Per accident) \$
C	<input checked="" type="checkbox"/> UMBRELLA LIAB <input checked="" type="checkbox"/> EXCESS LIAB DED <input checked="" type="checkbox"/> RETENTION \$10,000			CUP6209Y14A1347	05/01/2013	05/01/2014	EACH OCCURRENCE \$1,000,000 AGGREGATE \$1,000,000
D	WORKERS COMPENSATION AND EMPLOYERS' LIABILITY ANY PROPRIETOR/PARTNER/EXECUTIVE OFFICER/MEMBER EXCLUDED? (Mandatory in NH) If yes, describe under DESCRIPTION OF OPERATIONS below			VMPOUB4059T50013	05/01/2013	05/01/2014	<input checked="" type="checkbox"/> WC STATUTORY LIMITS <input type="checkbox"/> OTH-ER E.L. EACH ACCIDENT \$500,000 E.L. DISEASE - EA EMPLOYEE \$500,000 E.L. DISEASE - POLICY LIMIT \$500,000
E	Professional Liability			DPL299413	12/10/2013	12/10/2014	Each Claim 1,000,000 Aggregate 2,000,000

DESCRIPTION OF OPERATIONS / LOCATIONS / VEHICLES (Attach ACORD 101, Additional Remarks Schedule, if more space is required)

Project: LFUCG Senior Center
 Lexington-Fayette Urban County Governemnt is included as Additional Insured for General Liability and Automobile Liability in regard to the referenced project.

CERTIFICATE HOLDER**CANCELLATION**

Lexington-Fayette Urban County Government
 200 East Main Street
 Lexington, KY 40507

SHOULD ANY OF THE ABOVE DESCRIBED POLICIES BE CANCELLED BEFORE THE EXPIRATION DATE THEREOF, NOTICE WILL BE DELIVERED IN ACCORDANCE WITH THE POLICY PROVISIONS.

AUTHORIZED REPRESENTATIVE

© 1988-2010 ACORD CORPORATION. All rights reserved.



Lexington-Fayette Urban County Government

Request for Proposal

The Lexington-Fayette Urban County Government hereby requests proposals for **RFP #28-2013 Design Services for Replacement Senior Citizen Center** to be provided in accordance with terms, conditions and specifications established herein.

Sealed proposals will be received in the Division of Central Purchasing, Room 338, Government Center, 200 East Main Street, Lexington, KY, 40507, until **2:00 PM**, prevailing local time, on **November 5, 2013**.

Proposals received after the date and time set for opening proposals will not be considered for award of a contract and will be returned unopened to the Proposer. It is the sole responsibility of the Proposer to assure that his/her proposal is received by the Division of Central Purchasing before the date and time set for opening proposals.

Proposals must be sealed in an envelope and the envelope prominently marked:

RFP #28-2013 Design Services for Replacement Senior Citizen Center

If mailed, the envelope must be addressed to:

Purchasing Director
Lexington-Fayette Urban County Government
Room 338, Government Center
200 East Main Street
Lexington, KY 40507

Additional copies of this Request For Proposals are available from the Division of Central Purchasing, Room 338 Government Center, 200 East Main Street, Lexington, KY 40507, (859)-258-3320, at no charge.

Proposals, once submitted, may not be withdrawn for a period of sixty (60) calendar days.

There will be a pre-proposal meeting on Friday, October 18, at 3:00 pm Eastern time at the current Senior Citizen Center, 1530 Nicholasville Rd, Lexington, Kentucky 40503. *(due to space limitations, this meeting shall be limited to 2 persons per firm and the walk-through shall be limited to 1 person per firm)*

The Proposer must submit one (1) master (hardcopy), (1) electronic version in PDF format on a flashdrive or CD and ten (10) duplicates (hardcopies) of their proposal for evaluation purposes.

The Lexington-Fayette Urban County Government reserves the right to reject any or all proposals, and to waive technicalities and informalities when such waiver is determined by the Lexington-Fayette Urban County Government to be in its best interest.

Signature of this proposal by the Proposer constitutes acceptance by the Proposer of terms, conditions and requirements set forth herein.

Minor exceptions may not eliminate the proposal. Any exceptions to the specifications established herein shall be listed in detail on a separate sheet and attached hereto. The Lexington-Fayette Urban County Government shall determine whether any exception is minor.

The Lexington-Fayette Urban County Government encourages the participation of minority- and women-owned businesses in Lexington-Fayette Urban County Government contracts. This proposal is subject to Affirmative Action requirements attached hereto.

Please do not contact any City staff member or any other person involved in the selection process other than the designated contact person(s) regarding the project contemplated under this RFP while this RFP is open and a selection has not been finalized. Any attempt to do so may result in disqualification of the firm's submittal for consideration.

Laws and Regulations

All applicable state laws, municipal ordinances and regulations of all authorities having jurisdiction over the project shall apply to the contract, and shall be deemed to be incorporated herein by reference.

Equal Employment Opportunity

The Entity (regardless of whether construction contractor, non-construction contractor or supplier) agrees to provide equal opportunity in employment for all qualified persons, to prohibit discrimination in employment because of race, color, creed, national origin, sex or age, and to promote equal employment through a positive, continuing program from itself and each of its subcontracting agents. This program of equal employment opportunity shall apply to every aspect of its employment policies and practices.

Kentucky Equal Employment Opportunity Act

The Kentucky Equal Employment Opportunity Act of 1978 (KRS 45.560-45.640) requires that any "county, city, town, school district, water district, hospital district, or other political subdivision of the state shall include in directly or indirectly publicly funded

contracts for supplies, materials, services, or equipment hereinafter entered into the following provisions:

"During the performance of this contract, the contractor agrees as follows:

- (1) The contractor will not discriminate against any employee or applicant for employment because of race, color, religion, sex, age, or national origin;
- (2) The contractor will state in all solicitations or advertisements for employees placed by or on behalf of the contractors that all qualified applicants will receive consideration for employment without regard to race, color, religion, sex, age, or national origin;
- (3) The contractor will post notices in conspicuous places, available to employees and applicants for employment, setting forth the provision of the nondiscrimination clauses required by this section; and
- (4) The contractor will send a notice to each labor union or representative of workers with which he has a collective bargaining agreement or other contract or understanding advising the labor union or workers' representative of the contractor's commitments under the nondiscrimination clauses."

The Act further provides:

"KRS 45.610. Hiring minorities -- Information required

- (1) For the length of the contract, each contractor shall hire minorities from other sources within the drawing area, should the union with which he has collective bargaining agreements be unwilling to supply sufficient minorities to satisfy the agreed upon goals and timetables.
- (2) Each contractor shall, for the length of the contract, furnish such information as required by KRS 45.560 to KRS 45.640 and by such rules, regulations and orders issued pursuant thereto and will permit access to all books and records pertaining to his employment practices and work sites by the contracting agency and the department for purposes of investigation to ascertain compliance with KRS 45.560 to 45.640 and such rules, regulations and orders issued pursuant thereto.

KRS 45.620. Action against contractor -- Hiring of minority contractor or subcontractor

- (1) If any contractor is found by the department to have engaged in an unlawful practice under this chapter during the course of performing under a contract or subcontract covered under KRS 45.560 to 45.640, the department shall so certify to the contracting agency and such certification

shall be binding upon the contracting agency unless it is reversed in the course of judicial review.

(2) If the contractor is found to have committed an unlawful practice under KRS 45.560 to 45.640, the contracting agency may cancel or terminate the contract, conditioned upon a program for future compliance approved by the contracting agency and the department. The contracting agency may declare such a contractor ineligible to bid on further contracts with that agency until such time as the contractor complies in full with the requirements of KRS 45.560 to 45.640.

(3) The equal employment provisions of KRS 45.560 to 45.640 may be met in part by a contractor by subcontracting to a minority contractor or subcontractor. For the provisions of KRS 45.560 to 45.640, a minority contractor or subcontractor shall mean a business that is owned and controlled by one or more persons disadvantaged by racial or ethnic circumstances.

KRS 45.630 Termination of existing employee not required, when

Any provision of KRS 45.560 to 45.640 notwithstanding, no contractor shall be required to terminate an existing employee upon proof that employee was employed prior to the date of the contract.

KRS 45.640 Minimum skills

Nothing in KRS 45.560 to 45.640 shall require a contractor to hire anyone who fails to demonstrate the minimum skills required to perform a particular job."

It is recommended that all of the provisions above quoted be included as special conditions in each contract. In the case of a contract exceeding \$250,000, the contractor is required to furnish evidence that his workforce in Kentucky is representative of the available work-force in the area from which he draws employees, or to supply an Affirmative Action plan which will achieve such representation during the life of the contract.

Contention Process

Vendors who respond to this invitation have the right to file a notice of contention associated with the RFP process or to file a notice of appeal of the recommendation made by the Director of Central Purchasing resulting from this invitation.

Notice of contention with the RFP process must be filed within 3 business days of the bid/proposal opening by (1) sending a written notice, including sufficient documentation to support contention, to the Director of the Division of Central Purchasing or (2) submitting a written request for a meeting with the Director of Central Purchasing to explain his/her contention with the RFP process. After consulting with the Commissioner of Finance the Chief Administrative Officer and reviewing the documentation and/or hearing the vendor, the Director of Central Purchasing shall promptly respond in writing findings as to the compliance with RFP processes. If, based on this review, a RFP process irregularity is deemed to have occurred the Director of Central Purchasing will consult with the Commissioner of Finance, the Chief Administrative Officer and the Department of Law as to the appropriate remedy.

Notice of appeal of a RFP recommendation must be filed within 3 business days of the RFP recommendation by (1) sending a written notice, including sufficient documentation to support appeal, to the Director, Division of Central Purchasing or (2) submitting a written request for a meeting with the Director of Central Purchasing to explain his appeal. After reviewing the documentation and/or hearing the vendor and consulting with the Commissioner of Finance and the Chief Administrative Officer, the Director of Central Purchasing shall in writing, affirm or withdraw the recommendation.

SELECTION CRITERIA:

1. Specialized experienced and technical competence of the person or firm (including a joint venture or association) with the type of service required. *20 points total*
2. Capacity of the person or firm to perform the work, including any specialized services, within the time limitations. *10 points total*
3. Demonstrated understanding of the requirements of the project. *10 points total*
4. Past experience with designing senior citizen centers. *10 points total*
5. Past record and performance on contracts with the Urban County Government or other governmental agencies and private industry with respect to such factors as cost control, quality of work, and ability to meet schedule requirements. *10 points total*
6. Experience of the team in support of sustainable design and building cycle cost analysis. *10 points total*
7. Degree of local employment to be provided by the person or firm in the performance of the contract by the person or firm. *10 points total*
8. Fees. *20 points total*

Questions shall be addressed to:

Theresa Maynard, Buyer Senior
Division of Central Purchasing
200 East Main Street, Room 338
Lexington, Kentucky 40507
859-258-3320
theresam@lexingtonky.gov

The Deadline for Questions is Wednesday, October 23rd at 2:00 pm Eastern time.

Affirmative Action Plan

All vendors must submit as a part of the proposal package the following items to the Urban County Government:

1. Affirmative Action Plan for his/her firm;
2. Current Work Force Analysis Form;

Failure to submit these items as required may result in disqualification of the submitter from award of the contract. All submissions should be directed to:

Director, Division of Central Purchasing
Lexington-Fayette Urban County Government
200 East Main Street, 3rd Floor
Lexington, Kentucky 40507

All questions regarding this proposal must be directed to the Division of Central Purchasing, (859)-258-3320.

AFFIDAVIT

Comes the Affiant, _____, and after being first duly sworn, states under penalty of perjury as follows:

1. His/her name is _____ and he/she is the individual submitting the proposal or is the authorized representative of _____, the entity submitting the proposal (hereinafter referred to as "Proposer").

2. Proposer will pay all taxes and fees, which are owed to the Lexington-Fayette Urban County Government at the time the proposal is submitted, prior to award of the contract and will maintain a "current" status in regard to those taxes and fees during the life of the contract.

3. Proposer will obtain a Lexington-Fayette Urban County Government business license, if applicable, prior to award of the contract.

4. Proposer has authorized the Division of Central Purchasing to verify the above-mentioned information with the Division of Revenue and to disclose to the Urban County Council that taxes and/or fees are delinquent or that a business license has not been obtained.

5. Proposer has not knowingly violated any provision of the campaign finance laws of the Commonwealth of Kentucky within the past five (5) years and the award of a contract to the Proposer will not violate any provision of the campaign finance laws of the Commonwealth.

6. Proposer has not knowingly violated any provision of Chapter 25 of the Lexington-Fayette Urban County Government Code of Ordinances, known as "Ethics Act."

Continued on next page

7. Proposer acknowledges that "knowingly" for purposes of this Affidavit means, with respect to conduct or to circumstances described by a statute or ordinance defining an offense, that a person is aware or should have been aware that his conduct is of that nature or that the circumstance exists.

Further, Affiant sayeth naught.

STATE OF _____

COUNTY OF _____

The foregoing instrument was subscribed, sworn to and acknowledged before me

by _____ on this the _____ day

of _____, 2013.

My Commission expires: _____

NOTARY PUBLIC, STATE AT LARGE

EQUAL OPPORTUNITY AGREEMENT

The Law

- Title VII of the Civil Rights Act of 1964 (amended 1972) states that it is unlawful for an employer to discriminate in employment because of race, color, religion, sex, age (40-70 years) or national origin.
- Executive Order No. 11246 on Nondiscrimination under Federal contract prohibits employment discrimination by contractor and sub-contractor doing business with the Federal Government or recipients of Federal funds. This order was later amended by Executive Order No. 11375 to prohibit discrimination on the basis of sex.
- Section 503 of the Rehabilitation Act of 1973 states:

The Contractor will not discriminate against any employee or applicant for employment because of physical or mental handicap.

- Section 2012 of the Vietnam Era Veterans Readjustment Act of 1973 requires Affirmative Action on behalf of disabled veterans and veterans of the Vietnam Era by contractors having Federal contracts.
- Section 206(A) of Executive Order 12086, Consolidation of Contract Compliance Functions for Equal Employment Opportunity, states:

The Secretary of Labor may investigate the employment practices of any Government contractor or sub-contractor to determine whether or not the contractual provisions specified in Section 202 of this order have been violated.

The Lexington-Fayette Urban County Government practices Equal Opportunity in recruiting, hiring and promoting. It is the Government's intent to affirmatively provide employment opportunities for those individuals who have previously not been allowed to enter into the mainstream of society. Because of its importance to the local Government, this policy carries the full endorsement of the Mayor, Commissioners, Directors and all supervisory personnel. In following this commitment to Equal Employment Opportunity and because the Government is the benefactor of the Federal funds, it is both against the Urban County Government policy and illegal for the Government to let contracts to companies which knowingly or unknowingly practice discrimination in their employment practices. Violation of the above mentioned ordinances may cause a contract to be canceled and the contractors may be declared ineligible for future consideration.

Please sign this statement in the appropriate space acknowledging that you have read and understand the provisions contained herein. Return this document as part of your application packet.

Bidders

I/We agree to comply with the Civil Rights Laws listed above that govern employment rights of minorities, women, Vietnam veterans, handicapped and aged persons.

Signature

Name of Business

WORKFORCE ANALYSIS FORM

Name of Organization: _____

Date: ____/____/____

Categories	Total	White		Latino		Black		Other		Total	
		M	F	M	F	M	F	M	F	M	F
Administrators											
Professionals											
Superintendents											
Supervisors											
Foremen											
Technicians											
Protective Service											
Para-Professionals											
Office/Clerical											
Skilled Craft											
Service/Maintenance											
Total:											

Prepared by: _____
Name & Title

**DIRECTOR, DIVISION OF CENTRAL PURCHASING
LEXINGTON-FAYETTE URBAN COUNTY GOVERNMENT
200 EAST MAIN STREET
LEXINGTON, KENTUCKY 40507**

**NOTICE OF REQUIREMENT FOR AFFIRMATIVE ACTION TO ENSURE EQUAL
EMPLOYMENT OPPORTUNITIES AND DBE CONTRACT PARTICIPATION**

Notice of requirement for Affirmative Action to ensure Equal Employment Opportunities and Disadvantaged Business Enterprises (DBE) Contract participation. Disadvantaged Business Enterprises (DBE) consists of Minority-Owned Business Enterprises (MBE) and Woman-Owned Business Enterprises (WBE).

The Lexington-Fayette Urban County Government has set a goal that not less than ten percent (10%) of the total value of this Contract be subcontracted to Disadvantaged Business Enterprises, which is made up of MBEs and WBEs. The goal for the utilization of Disadvantaged Business Enterprises as subcontractors is a recommended goal. Contractor(s) who fail to meet such goal will be expected to provide written explanations to the Director of the Division of Purchasing of efforts they have made to accomplish the recommended goal, and the extent to which they are successful in accomplishing the recommended goal will be a consideration in the procurement process. Depending on the funding source, other DBE goals may apply.

For assistance in locating Disadvantaged Business Enterprises Subcontractors contact:

Marilyn Clark, Division of Central Purchasing
Lexington-Fayette Urban County Government
200 East Main Street, 3rd Floor, Room 338
Lexington, Kentucky 40507
mclark@lexingtonky.gov

Firm Submitting Proposal: _____

Complete Address: _____
 Street City Zip

Contact Name: _____ Title: _____

Telephone Number: _____ Fax Number: _____

Email address: _____

Lexington-Fayette Urban County Government
MWDBE PARTICIPATION GOALS

A. GENERAL

- 1) The LFUCG request all potential contractors to make a concerted effort to include Minority-Owned (MBE), Woman-Owned (WBE) and Disadvantaged (DBE) Business Enterprises as subcontractors or suppliers in their bids.
- 2) Toward that end, the LFUCG has established 10% of total procurement costs as a Goal for participation of Minority-Owned, Woman-Owned and Disadvantaged Businesses on this contract.
- 3) **It is therefore a request of each Bidder to include in its bid, the same goal (10%) for MWDBE participation and other requirements as outlined in this section.**

B. PROCEDURES

- 1) The successful bidder will be required to report to the LFUCG, the dollar amounts of all payments submitted to Minority-Owned or Woman-Owned subcontractors and suppliers for work done or materials purchased for this contract. (See Subcontractor Monthly Payment Report)
- 2) Replacement of a Minority-Owned or Woman-Owned subcontractor or supplier listed in the original submittal must be requested in writing and must be accompanied by documentation of Good Faith Efforts to replace the subcontractor / supplier with another MWDBE Firm; this is subject to approval by the LFUCG. (See LFUCG MWDBE Substitution Form)
- 3) For assistance in identifying qualified, certified businesses to solicit for potential contracting opportunities, bidders may contact:
 - a) The Lexington-Fayette Urban County Government, Division of Central Purchasing (859-258-3320)
- 4) The LFUCG will make every effort to notify interested MWDBE subcontractors and suppliers of each Bid Package, including information on the scope of work, the pre-bid meeting time and location, the bid date, and all other pertinent information regarding the project.

C. DEFINITIONS

- 1) A Minority-Owned Business Enterprise (MBE) is defined as a business which is certified as being at least 51% owned and operated by persons of African American, Hispanic, Asian, Pacific Islander, American Indian or Alaskan Native Heritage.

- 2) A Woman-Owned Business Enterprise (WBE) is defined as a business which is certified as being at least 51% owned and operated by one or more Non-Minority Females.
- 3) A Disadvantaged Business (DBE) is defined as a business which is certified as being at least 51% owned and operated by a person(s) that are economically and socially disadvantaged.
- 4) Good Faith Efforts are efforts that, given all relevant circumstances, a bidder or proposer actively and aggressively seeking to meet the goals, can reasonably be expected to make. In evaluating good faith efforts made toward achieving the goals, whether the bidder or proposer has performed the efforts outlined in the Obligations of Bidder for Good Faith Efforts outlined in this document will be considered, along with any other relevant factors.

D. OBLIGATION OF BIDDER FOR GOOD FAITH EFFORTS

- 1) **The bidder shall make a Good Faith Effort to achieve the Participation Goal for MWDBE subcontractors/suppliers. The failure to meet the goal shall not necessarily be cause for disqualification of the bidder; however, bidders not meeting the goal are required to furnish with their bids written documentation of their Good Faith Efforts to do so.**
- 2) Award of Contract shall be conditioned upon satisfaction of the requirements set forth herein.
- 3) The Form of Proposal includes a section entitled "MWDBE Participation Form". The applicable information must be completed and submitted as outlined below.
- 4) **Failure to submit this information as requested may be cause for rejection of bid.**

E. DOCUMENTATION REQUIRED FOR GOOD FAITH EFFORTS

- 1) Bidders reaching the Goal are required to submit only the MWDBE Participation Form." The form must be fully completed including names and telephone number of participating MWDBE firm(s); type of work to be performed; estimated value of the contract and value expressed as a percentage of the total Lump Sum Bid Price. The form must be signed and dated, and is to be submitted with the bid.
- 2) Bidders not reaching the Goal must submit the "MWDBE Participation Form", the "Quote Summary Form" and a written statement documenting their Good Faith Effort to do so. If bid includes no MWDBE participation, bidder shall enter "None" on the subcontractor / supplier form). In addition, the bidder must submit written proof of their Good Faith Efforts to meet the Participation Goal:
 - a. Advertised opportunities to participate in the contract in at least two (2) publications of general circulation media; trade and professional association

publications; small and minority business or trade publications; and publications or trades targeting minority, women and disadvantaged businesses not less than fifteen (15) days prior to the deadline for submission of bids to allow MWDBE firms to participate.

b. Included documentation of advertising in the above publications with the bidders good faith efforts package

c. Attended LFUCG Central Purchasing Economic Inclusion Outreach event

d. Attended pre-bid meetings that were scheduled by LFUCG to inform MWDBEs of subcontracting opportunities

e. Sponsored Economic Inclusion event to provide networking opportunities for prime contractors and MWDBE firms

f. Requested a list of MWDBE subcontractors or suppliers from LFUCG Economic Engine and showed evidence of contacting the companies on the list(s).

g. Contacted organizations that work with MWDBE companies for assistance in finding certified MWBDE firms to work on this project. Those contacted and their responses should be a part of the bidder's good faith efforts documentation.

h. Sent written notices, by certified mail, email or facsimile, to qualified, certified MWDBEs soliciting their participation in the contract not less than seven (7) days prior to the deadline for submission of bids to allow them to participate effectively.

i. Followed up initial solicitations by contacting MWDBEs to determine their level of interest.

j. Provided the interested MWBDE firm with adequate and timely information about the plans, specifications, and requirements of the contract.

k. Selected portions of the work to be performed by MWDBE firms in order to increase the likelihood of meeting the contract goals. This includes, where appropriate, breaking out contract work items into economically feasible units to facilitate MWDBE participation, even when the prime contractor may otherwise perform these work items with its own workforce

l. Negotiated in good faith with interested MWDBE firms not rejecting them as unqualified without sound reasons based on a thorough investigation of their capabilities. Any rejection should be so noted in writing with a description as to why an agreement could not be reached.

m. Included documentation of quotations received from interested MWDBE firms which were not used due to uncompetitive pricing or were rejected as unacceptable and/or copies of responses from firms indicating that they would not be submitting a bid.

n. Bidder has to submit sound reasons why the quotations were considered unacceptable. The fact that the bidder has the ability and/or desire to perform the contract work with its own forces will not be considered a sound reason for rejecting a MWDBE quote. Nothing in this provision shall be construed to require the bidder to accept unreasonable quotes in order to satisfy MWDBE goals.

o. Made an effort to offer assistance to or refer interested MWDBE firms to obtain the necessary equipment, supplies, materials, insurance and/or bonding to satisfy the work requirements of the bid proposal

p. Made efforts to expand the search for MWBE firms beyond the usual geographic boundaries.

q. Other--any other evidence that the bidder submits which may show that the bidder has made reasonable good faith efforts to include MWDBE participation.

Failure to submit any of the documentation requested in this section may be cause for rejection of bid. Bidders may include any other documentation deemed relevant to this requirement. Documentation of Good Faith Efforts are to be submitted with the Bid, if the participation Goal is not met.



MINORITY BUSINESS ENTERPRISE PROGRAM

Marilyn Clark
Minority Business Enterprise Liaison
Division of Central Purchasing
Lexington-Fayette Urban County Government
200 East Main Street
Lexington, KY 40507
mclark@lexingtonky.gov
859-258-3323

OUR MISSION: The mission of the Minority Business Enterprise Program is to facilitate the full participation of minority and women owned businesses in the procurement process and to promote economic inclusion as a business imperative essential to the long term economic viability of Lexington-Fayette Urban County Government.

To that end the city council adopted and implemented resolution 167-91—Disadvantaged Business Enterprise (DBE) 10% Goal Plan in July of 1991. The resolution states in part (a full copy is available in Central Purchasing):

“A Resolution supporting adoption of the administrative plan for a ten percent (10%) Minimum goal for disadvantaged business enterprise participation in Lexington-Fayette Urban County Government construction and professional services contracts; Providing that as part of their bids on LFUCG construction contracts, general Contractors shall make a good faith effort to award at least ten percent (10%) of All subcontracts to disadvantaged business enterprises; providing that divisions of LFUCG shall make a good faith effort to award at least ten percent of their Professional services and other contracts to disadvantaged business enterprises...”

A Disadvantaged Business Enterprise is defined as a business that has been certified as being at least 51% owned, operated and managed by a U.S. Citizen of the following groups:

- African-American
- Hispanic-American
- Asian/Pacific Islander
- Native American/Native Alaskan
- Non-Minority Female
- Economically and Socially Disadvantaged

We have compiled the list below to help you locate certified MBE, WBE and DBE certified businesses. Below is a listing of contacts for LFUCG Certified MWDBEs in Economic Engine (<https://lfucg.economicengine.com>)

Business	Contact	Email Address	Phone
LFUCG	Marilyn Clark	mclark@lexingtonky.gov	859-258-3323
Commerce Lexington – Minority Business Development	Tyrone Tyra	ttyra@commercelexington.com	859-226-1625
Tri-State Minority Supplier Diversity Council	Sonya Brown	sbrown@tsmsdc.com	502-625-0137
Small Business Development Council	Dee Dee Harbut UK SBDC	ddharbut@uky.edu	
	Shiree Mack	smack@uky.edu	
Community Ventures Corporation	James Coles	jcoles@cycky.org	859-231-0054
KY Department of Transportation	Melvin Bynes	Melvin.bynes@ky.gov	502-564-3601
	Shella Eagle	Shella.Eagle@ky.gov	502-564-3601
Ohio River Valley Women’s Business Council (WBENC)	Rea Waldon	rwaldon@gcul.org	513-487-6534
Kentucky MWBE Certification Program	Yvette Smith, Kentucky Finance Cabinet	Yvette.Smith@ky.gov	502-564-8099
National Women Business Owner’s Council (NWBOC)	Janet Harris-Lange	janet@nwbo.org	800-675-5066
Small Business Administration	Robert Coffey	robertcoffey@sba.gov	502-582-5971
LaVoz de Kentucky	Andres Cruz	lavozdeky@yahoo.com	859-621-2106
The Key News Journal	Patrice Muhammad	paatricem@keynewsjournal.com	859-373-9428



LFUCG MWDBE PARTICIPATION FORM

Bid/RFP/Quote Reference # _____

The MWDBE subcontractors listed have agreed to participate on this Bid/RFP/Quote. If any substitution is made or the total value of the work is changed prior to or after the job is in progress, it is understood that those substitutions must be submitted to Central Purchasing for approval immediately.

MWDBE Company, Name, Address, Phone, Email	Work to be Performed	Total Dollar Value of the Work	% Value of Total Contract
1.			
2.			
3.			
4.			

The undersigned company representative submits the above list of MWDBE firms to be used in accomplishing the work contained in this Bid/RFP/Quote. Any misrepresentation may result in the termination of the contract and/or be subject to applicable Federal and State laws concerning false statements and false claims.

Company

Company Representative

Date

Title



LFUCG MWDBE SUBSTITUTION FORM
 Bid/RFP/Quote Reference # _____

The substituted MWDBE subcontractors listed below have agreed to participate on this Bid/RFP/Quote. These substitutions were made prior to or after the job was in progress. These substitutions were made for reasons stated below and are now being submitted to Central Purchasing for approval. By the authorized signature of a representative of our company, we understand that this information will be entered into our file for this project.

SUBSTITUTED MWDBE Company Name, Address, Phone, Email	MWDBE Formally Contracted/ Name, Address, Phone, Email	Work to Be Performed	Reason for the Substitution	Total Dollar Value of the Work	% Value of Total Contract
1.					
2.					
3.					
4.					

The undersigned acknowledges that any misrepresentation may result in termination of the contract and/or be subject to applicable Federal and State laws concerning false statements and false claims.

Company

Company Representative

Date

Title



MWDBE QUOTE SUMMARY FORM

Bid/RFP/Quote Reference # _____

The undersigned acknowledges that the minority subcontractors listed on this form did submit a quote to participate on this project.

Company Name	Contact Person
Address/Phone/Email	Bid Package / Bid Date

MWDBE Company Address	Contact Person	Contact Information (work phone, Email, cell)	Date Contacted	Services to be performed	Method of Communication (email, phone meeting, ad, event etc)	Total dollars \$\$ Do Not Leave Blank (Attach Documentation)	MBE * AA HA AS NA Female

(MBE designation / AA=African American / HA= Hispanic American/AS = Asian American/Pacific Islander/ NA= Native American)

The undersigned acknowledges that all information is accurate. Any misrepresentation may result in termination of the contract and/or be subject to applicable Federal and State laws concerning false statements and claims.

Company

Company Representative

Date

Title



LFUCG SUBCONTRACTOR MONTHLY PAYMENT REPORT

The LFUCG has a 10% goal plan adopted by city council to increase the participation of minority and women owned businesses in the procurement process. In order to measure that goal LFUCG will track spending with MWDBE vendors on a monthly basis. By the signature below of an authorized company representative, you certify that the information is correct, and that each of the representations set forth below is true. Any misrepresentation may result in termination of the contract and/or prosecution under applicable Federal and State laws concerning false statements and false claims. Please submit this form monthly to the Division of Central Purchasing/ 200 East Main Street / Room 338 / Lexington, KY 40507.

Bid/RFP/Quote # _____

Total Contract Amount Awarded to Prime Contractor for this Project _____

Project Name/ Contract #	Work Period/ From: _____ To: _____
Company Name:	Address:
Federal Tax ID:	Contact Person:

Subcontractor Vendor ID (name, address, phone, email)	Description of Work	Total Subcontract Amount	% of Total Contract Awarded to Prime for this Project	Total Amount Paid for this Period	Purchase Order number for subcontractor work (please attach PO)	Scheduled Project Start Date	Scheduled Project End Date

By the signature below of an authorized company representative, you certify that the information is correct, and that each of the representations set forth below is true. Any misrepresentations may result in the termination of the contract and/or prosecution under applicable Federal and State laws concerning false statements and false claims.

Company

Company Representative

Date

Title

LFUCG STATEMENT OF GOOD FAITH EFFORTS

Bid/RFP/Quote # _____

By the signature below of an authorized company representative, we certify that we have utilized the following Good Faith Efforts to obtain the maximum participation by MWDBE business enterprises on the project and can supply the appropriate documentation.

_____ Advertised opportunities to participate in the contract in at least two (2) publications of general circulation media; trade and professional association publications; small and minority business or trade publications; and publications or trades targeting minority, women and disadvantaged businesses not less than fifteen (15) days prior to the deadline for submission of bids to allow MWDBE firms to participate.

_____ Included documentation of advertising in the above publications with the bidders good faith efforts package

_____ Attended LFUCG Central Purchasing Economic Inclusion Outreach event

_____ Attended pre-bid meetings that were scheduled by LFUCG to inform MWDBEs of subcontracting opportunities

_____ Sponsored Economic Inclusion event to provide networking opportunities for prime contractors and MWDBE firms

_____ Requested a list of MWDBE subcontractors or suppliers from LFUCG Economic Engine and showed evidence of contacting the companies on the list(s).

_____ Contacted organizations that work with MWDBE companies for assistance in finding certified MWBDE firms to work on this project. Those contacted and their responses should be a part of the bidder's good faith efforts documentation.

_____ Sent written notices, by certified mail, email or facsimile, to qualified, certified MWDBEs soliciting their participation in the contract not less than seven (7) days prior to the deadline for submission of bids to allow them to participate effectively.

_____ Followed up initial solicitations by contacting MWDBEs to determine their level of interest.

_____ Provided the interested MWBDE firm with adequate and timely information about the plans, specifications, and requirements of the contract.

_____ Selected portions of the work to be performed by MWDBE firms in order to increase the likelihood of meeting the contract goals. This includes, where appropriate, breaking out contract work items into economically feasible

units to facilitate MWDBE participation, even when the prime contractor may otherwise perform these work items with its own workforce

_____ Negotiated in good faith with interested MWDBE firms not rejecting them as unqualified without sound reasons based on a thorough investigation of their capabilities. Any rejection should be so noted in writing with a description as to why an agreement could not be reached.

_____ Included documentation of quotations received from interested MWDBE firms which were not used due to uncompetitive pricing or were rejected as unacceptable and/or copies of responses from firms indicating that they would not be submitting a bid.

_____ Bidder has to submit sound reasons why the quotations were considered unacceptable. The fact that the bidder has the ability and/or desire to perform the contract work with its own forces will not be considered a sound reason for rejecting a MWDBE quote. Nothing in this provision shall be construed to require the bidder to accept unreasonable quotes in order to satisfy MWDBE goals.

_____ Made an effort to offer assistance to or refer interested MWDBE firms to obtain the necessary equipment, supplies, materials, insurance and/or bonding to satisfy the work requirements of the bid proposal

_____ Made efforts to expand the search for MWBE firms beyond the usual geographic boundaries.

_____ Other - any other evidence that the bidder submits which may show that the bidder has made reasonable good faith efforts to include MWDBE participation.

Failure to submit any of the documentation requested in this section may be cause for rejection of bid. Bidders may include any other documentation deemed relevant to this requirement. Documentation of Good Faith Efforts are to be submitted with the Bid, if the participation Goal is not met.

The undersigned acknowledges that all information is accurate. Any misrepresentations may result in termination of the contract and/or be subject to applicable Federal and State laws concerning false statements and claims.

Company

Company Representative

Date

Title

GENERAL PROVISIONS

1. Each Respondent shall comply with all Federal, State & Local regulations concerning this type of service or good.

The Respondent agrees to comply with all statutes, rules, and regulations governing safe and healthful working conditions, including the Occupational Health and Safety Act of 1970, *29 U.S.C. 650 et. seq.*, as amended, and KRS Chapter 338. The Respondent also agrees to notify the LFUCG in writing immediately upon detection of any unsafe and/or unhealthful working conditions at the job site. The Respondent agrees to indemnify, defend and hold the LFUCG harmless from all penalties, fines or other expenses arising out of the alleged violation of said laws.

2. Failure to submit ALL forms and information required in this RFP may be grounds for disqualification.
3. Addenda: All addenda, if any, shall be considered in making the proposal, and such addenda shall be made a part of this RFP. Before submitting a proposal, it is incumbent upon each proposer to be informed as to whether any addenda have been issued, and the failure to cover in the bid any such addenda may result in disqualification of that proposal.
4. Proposal Reservations: LFUCG reserves the right to reject any or all proposals, to award in whole or part, and to waive minor immaterial defects in proposals. LFUCG may consider any alternative proposal that meets its basic needs.
5. Liability: LFUCG is not responsible for any cost incurred by a Respondent in the preparation of proposals.
6. Changes/Alterations: Respondent may change or withdraw a proposal at any time prior to the opening; however, no oral modifications will be allowed. Only letters, or other formal written requests for modifications or corrections of a previously submitted proposal which is addressed in the same manner as the proposal, and received by LFUCG prior to the scheduled closing time for receipt of proposals, will be accepted. The proposal, when opened, will then be corrected in accordance with such written request(s), provided that the written request is contained in a sealed envelope which is plainly marked "modifications of proposal".
7. Clarification of Submittal: LFUCG reserves the right to obtain clarification of any point in a bid or to obtain additional information from a Respondent.
8. Bribery Clause: By his/her signature on the bid, Respondent certifies that no employee of his/hers, any affiliate or Subcontractor, has bribed or attempted to bribe an officer or employee of the LFUCG.

9. Additional Information: While not necessary, the Respondent may include any product brochures, software documentation, sample reports, or other documentation that may assist LFUCG in better understanding and evaluating the Respondent's response. Additional documentation shall not serve as a substitute for other documentation which is required by this RFP to be submitted with the proposal,
10. Ambiguity, Conflict or other Errors in RFP: If a Respondent discovers any ambiguity, conflict, discrepancy, omission or other error in the RFP, it shall immediately notify LFUCG of such error in writing and request modification or clarification of the document if allowable by the LFUCG.
11. Agreement to Bid Terms: In submitting this proposal, the Respondent agrees that it has carefully examined the specifications and all provisions relating to the work to be done attached hereto and made part of this proposal. By acceptance of a Contract under this RFP, proposer states that it understands the meaning, intent and requirements of the RFP and agrees to the same. The successful Respondent shall warrant that it is familiar with and understands all provisions herein and shall warrant that it can comply with them. No additional compensation to Respondent shall be authorized for services or expenses reasonably covered under these provisions that the proposer omits from its Proposal.
12. Cancellation: If the services to be performed hereunder by the Respondent are not performed in an acceptable manner to the LFUCG, the LFUCG may cancel this contract for cause by providing written notice to the proposer, giving at least thirty (30) days notice of the proposed cancellation and the reasons for same. During that time period, the proposer may seek to bring the performance of services hereunder to a level that is acceptable to the LFUCG, and the LFUCG may rescind the cancellation if such action is in its best interest.

A. Termination for Cause

- (1) LFUCG may terminate a contract because of the contractor's failure to perform its contractual duties
- (2) If a contractor is determined to be in default, LFUCG shall notify the contractor of the determination in writing, and may include a specified date by which the contractor shall cure the identified deficiencies. LFUCG may proceed with termination if the contractor fails to cure the deficiencies within the specified time.
- (3) A default in performance by a contractor for which a contract may be terminated shall include, but shall not necessarily be limited to:
 - (a) Failure to perform the contract according to its terms,

- conditions and specifications;
- (b) Failure to make delivery within the time specified or according to a delivery schedule fixed by the contract;
 - (c) Late payment or nonpayment of bills for labor, materials, supplies, or equipment furnished in connection with a contract for construction services as evidenced by mechanics' liens filed pursuant to the provisions of KRS Chapter 376, or letters of indebtedness received from creditors by the purchasing agency;
 - (d) Failure to diligently advance the work under a contract for construction services;
 - (e) The filing of a bankruptcy petition by or against the contractor; or
 - (f) Actions that endanger the health, safety or welfare of the LFUCG or its citizens.

B. At Will Termination

Notwithstanding the above provisions, the LFUCG may terminate this contract at will in accordance with the law upon providing thirty (30) days written notice of that intent. Payment for services or goods received prior to termination shall be made by the LFUCG provided these goods or services were provided in a manner acceptable to the LFUCG. Payment for those goods and services shall not be unreasonably withheld.

13. **Assignment of Contract:** The contractor shall not assign or subcontract any portion of the Contract without the express written consent of LFUCG. Any purported assignment or subcontract in violation hereof shall be void. It is expressly acknowledged that LFUCG shall never be required or obligated to consent to any request for assignment or subcontract; and further that such refusal to consent can be for any or no reason, fully within the sole discretion of LFUCG.
14. **No Waiver:** No failure or delay by LFUCG in exercising any right, remedy, power or privilege hereunder, nor any single or partial exercise thereof, nor the exercise of any other right, remedy, power or privilege shall operate as a waiver hereof or thereof. No failure or delay by LFUCG in exercising any right, remedy, power or privilege under or in respect of this Contract shall affect the rights, remedies, powers or privileges of LFUCG hereunder or shall operate as a waiver thereof.
15. **Authority to do Business:** The Respondent must be a duly organized and authorized to do business under the laws of Kentucky. Respondent must be in good standing and have full legal capacity to provide the services specified under this Contract. The Respondent must have all necessary right and lawful authority to enter into this Contract for the full term hereof and that proper corporate or other action has been duly taken authorizing the Respondent to enter into this

Contract. The Respondent will provide LFUCG with a copy of a corporate resolution authorizing this action and a letter from an attorney confirming that the proposer is authorized to do business in the State of Kentucky if requested. All proposals must be signed by a duly authorized officer, agent or employee of the Respondent.

16. **Governing Law:** This Contract shall be governed by and construed in accordance with the laws of the Commonwealth of Kentucky. In the event of any proceedings regarding this Contract, the Parties agree that the venue shall be the Fayette County Circuit Court or the U.S. District Court for the Eastern District of Kentucky, Lexington Division. All parties expressly consent to personal jurisdiction and venue in such Court for the limited and sole purpose of proceedings relating to this Contract or any rights or obligations arising thereunder. Service of process may be accomplished by following the procedures prescribed by law.
17. **Ability to Meet Obligations:** Respondent affirmatively states that there are no actions, suits or proceedings of any kind pending against Respondent or, to the knowledge of the Respondent, threatened against the Respondent before or by any court, governmental body or agency or other tribunal or authority which would, if adversely determined, have a materially adverse effect on the authority or ability of Respondent to perform its obligations under this Contract, or which question the legality, validity or enforceability hereof or thereof.
18. Contractor understands and agrees that its employees, agents, or subcontractors are not employees of LFUCG for any purpose whatsoever. Contractor is an independent contractor at all times during the performance of the services specified.
19. If any term or provision of this Contract shall be found to be illegal or unenforceable, the remainder of the contract shall remain in full force and such term or provision shall be deemed stricken.

Signature

Date

**RISK MANAGEMENT PROVISIONS
INSURANCE AND INDEMNIFICATION**

RFP#28-2013 DESIGN SERVICES FOR REPLACEMENT SENIOR CITIZEN CENTER

INDEMNIFICATION AND HOLD HARMLESS PROVISION

- (1) It is understood and agreed by the parties that Consultant hereby assumes the entire responsibility and liability for any and all damages to persons or property caused by or resulting from or arising out of any act or omission on the part of Consultant or its employees, agents, servants, owners, principals, licensees, assigns or subcontractors of any tier (hereinafter "Consultant") under or in connection with this agreement and/or the provision of goods or services and the performance or failure to perform any work required thereby.
- (2) Consultant shall indemnify, save, hold harmless and defend the Lexington-Fayette Urban County Government and its elected and appointed officials, employees, agents, volunteers, and successors in interest (hereinafter "LFUCG") from and against all liability, damages, and losses, including but not limited to, demands, claims, obligations, causes of action, judgments, penalties, fines, liens, costs, expenses, interest, defense costs and reasonable attorney's fees that are in any way incidental to or connected with, or that arise or are alleged to have arisen, directly or indirectly, from or by Consultant's performance or breach of the agreement and/or the provision of goods or services provided that: (a) it is attributable to personal injury, bodily injury, sickness, or death, or to injury to or destruction of property (including the loss of use resulting therefrom), or to or from the negligent acts, errors or omissions or willful misconduct of the Consultant; and (b) not caused solely by the active negligence or willful misconduct of LFUCG.
- (3) Notwithstanding, the foregoing, with respect to any professional services performed by Consultant hereunder (and to the fullest extent permitted by law), Consultant shall indemnify, save, hold harmless and defend LFUCG from and against any and all liability, damages and losses, including but not limited to, demands, claims, obligations, causes of action, judgments, penalties, fines, liens, costs, expenses, interest, defense costs and reasonable attorney's fees, for any damage due to death or injury to any person or injury to any property (including the loss of use resulting therefrom) to the extent arising out of, pertaining to or relating to the negligence, recklessness or willful misconduct of Consultant in the performance of this agreement.
- (4) In the event LFUCG is alleged to be liable based upon the above, Consultant shall defend such allegations and shall bear all costs, fees and expenses of such defense, including but not limited to, all reasonable attorneys' fees and expenses, court costs, and expert witness fees and expenses, using attorneys approved in writing by LFUCG, which approval shall not be unreasonably withheld.
- (5) These provisions shall in no way be limited by any financial responsibility or insurance requirements, and shall survive the termination of this agreement.

FINANCIAL RESPONSIBILITY

Consultant understands and agrees that it shall, prior to final acceptance of its proposal and the commencement of any work or services, demonstrate the ability to assure compliance with the above Indemnity provisions and these other risk management provisions.

INSURANCE REQUIREMENTS

YOUR ATTENTION IS DIRECTED TO THE INSURANCE REQUIREMENTS BELOW, AAND YOU MAY NEED TO CONFER WITH YOUR INSURANCE AGENTS, BROKERS, OR

CARRIERS TO DETERMINE IN ADVANCE OF SUBMISSION OF A RESPONSE THE AVAILABILITY OF THE INSURANCE COVERAGES AND ENDORSEMENTS REQUIRED HEREIN. IF YOU FAIL TO COMPLY WITH THE INSURANCE REQUIREMENTS BELOW, YOU MAY BE DISQUALIFIED FROM AWARD OF THE CONTRACT.

Required Insurance Coverage

Consultant shall procure and maintain for the duration of this contract the following or equivalent insurance policies at no less than the limits shown below and cause its subcontractors to maintain similar insurance with limits acceptable to LFUCG in order to protect LFUCG against claims for injuries to persons or damages to property which may arise from or in connection with the performance of the work or services hereunder by Consultant. The cost of such insurance shall be included in any bid:

<u>Coverage</u>	<u>Limits</u>
General Liability (Insurance Services Office Form CG 00 01)	\$1 million per occurrence, \$2 million aggregate or \$2 million combined single limit
Commercial Automobile Liability (Insurance Services Office Form CA 0001)	combined single, \$1 million per occurrence
Professional Liability aggregate	\$1 million per occurrence, \$3 million
Worker's Compensation	Statutory
Employer's Liability	\$500,000.00

The policies above shall contain the following conditions:

- a. All Certificates of Insurance forms used by the insurance carrier shall be properly filed and approved by the Department of Insurance for the Commonwealth of Kentucky. LFUCG shall be named as an additional insured in the General Liability Policy and Commercial Automobile Liability Policy using the Kentucky DOI approved forms.
- b. The General Liability Policy shall be primary to any insurance or self-insurance retained by LFUCG.
- c. The General Liability Policy shall have a Professional Liability endorsement (including Errors and Omissions) for any services performed pursuant to the contract, and/or a separate Professional Liability Policy shall be obtained unless it is deemed not to apply by LFUCG.
- d. The Professional Liability policy shall be maintained for a minimum of three years beyond the completion date of the project, to the extent commercially available. If not commercially available, Consultant shall notify LFUCG and obtain similar insurance that is commercially available and acceptable to LFUCG.
- e. LFUCG shall be provided at least 30 days advance written notice via certified mail, return receipt requested, in the event any of the required policies are canceled or non-renewed.
- f. Said coverage shall be written by insurers acceptable to LFUCG and shall be in a form acceptable to LFUCG. Insurance placed with insurers with a rating classification of no less than Excellent (A or A-) and a financial size category of no less than VIII, as defined by the most current Best's Key Rating Guide shall be deemed automatically acceptable.

Renewals

After insurance has been approved by LFUCG, evidence of renewal of an expiring policy must be submitted to LFUCG, and may be submitted on a manually signed renewal endorsement form. If the policy or carrier has changed, however, new evidence of coverage must be submitted in accordance with these Insurance Requirements.

Safety and Loss Control

Consultant shall comply with all applicable federal, state, and local safety standards related to the performance of its works or services under this Agreement and take necessary action to protect the life, health and safety and property of all of its personnel on the job site, the public, and LFUCG.

Deductibles and Self-Insured Programs

IF YOU INTEND TO SUBMIT A SELF-INSURANCE PLAN IT MUST BE FORWARDED TO LEXINGTON-FAYETTE URBAN COUNTY GOVERNMENT, DIVISION OF RISK MANAGEMENT, 200 EAST MAIN STREET, LEXINGTON, KENTUCKY 40507 NO LATER THAN A MINIMUM OF FIVE (5) WORKING DAYS PRIOR TO THE RESPONSE DATE. Self-insurance programs, deductibles, and self-insured retentions in insurance policies are subject to separate approval by Lexington-Fayette Urban County Government's Division of Risk Management, upon review of evidence of Consultant's financial capacity to respond to claims. Any such programs or retentions must provide LFUCG with at least the same protection from liability and defense of suits as would be afforded by first-dollar insurance coverage. If Consultant satisfies any portion of the insurance requirements through deductibles, self-insurance programs, or self-insured retentions, Consultant agrees to provide Lexington-Fayette Urban County Government, Division of Risk Management, the following data prior to the final acceptance of bid and the commencement of any work:

- a. Latest audited financial statement, including auditor's notes.
- b. Any records of any self-insured trust fund plan or policy and related accounting statements.
- c. Actuarial funding reports or retained losses.
- d. Risk Management Manual or a description of the self-insurance and risk management program.
- e. A claim loss run summary for the previous five (5) years.
- f. Self-Insured Associations will be considered.

Verification of Coverage

Consultant agrees to furnish LFUCG with all applicable Certificates of Insurance signed by a person authorized by the insurer to bind coverage on its behalf prior to final award, and if requested, shall provide LFUCG copies of all insurance policies, including all endorsements.

Right to Review, Audit and Inspect

Consultant understands and agrees that LFUCG may review, audit and inspect any and all of its records and operations to insure compliance with these Insurance Requirements.

DEFAULT

Consultant understands and agrees that the failure to comply with any of these insurance, safety, or loss control provisions shall constitute default and that LFUCG may elect at its option any single remedy or penalty or any combination of remedies and penalties, as available, including but not limited to purchasing insurance and charging Consultant for any such insurance premiums purchased, or suspending or terminating the work.

00409263

Design Services for Replacement Senior Citizen Center

Request for Proposal No. 28-2013

Scope of Work

The Lexington-Fayette Urban County Government (LFUCG) is seeking proposals from qualified firms to provide complete Architectural/Engineering services for the design of a replacement Senior Citizen Center, access drive to the Center, and parking lot.

1. Project Summary Narrative (Project Vision)

The current Senior Citizen Center is located at 1530 Nicholasville Road on 2.84 acres. The Center was constructed in 1983 and consists of a 17,000 square foot single story building with 117 parking spaces adjacent to the Center. The Center receives between 120-150 visitors daily for a wide range of offerings which include educational forums and classes; crafts; creative writing; health support groups; exercise classes; yoga; table tennis; billiards; book clubs; Tai Chi; line dancing; bingo; bid euchre and bridge; blood pressure clinics; and daily lunches. In addition to the senior programming offered at the Center, the building plays host to several partner agencies that provide essential services to senior citizens. The Center also accommodates a number of community events such as flu shot clinics, public meetings, special events, and parties. Lastly, the Center serves as an emergency shelter for medically fragile seniors.

Census data from 2010 indicates there are currently 40,226 Fayette County residents who are 60 years or older. It is projected that Fayette County's 60+ population will nearly double in the next 20 years. This increase will impact the Center's ability to offer essential programs at the current facility. The current facility was evaluated for possible expansion and renovation but was deemed insufficient to handle the projected increased population. Various locations around Lexington have been evaluated in recent months. In August 2013, the Lexington-Fayette Urban County Government Council voted to proceed with the design to construct a new Senior Citizen Center inside Idle Hour Park located on St. Ann Drive. The new Center will be constructed on a 4.46 acre area at the south east end of the park.

The new Senior Citizen Center will include a few dedicated spaces but will focus on flexible multi-purpose areas. Planned programs will include art activities, educational classes, recreational (dance and exercise) classes, a game area, and library.

Additional space will be needed for personal services and private consultations. A warming kitchen and associated storage and a dining space will also be included. Offices for Center staff and partner agencies will be included as well as storage throughout the building to accommodate the various activities. It is anticipated that the new Senior Citizen Center will encompass roughly 35,000 to 45,000 square feet.

The building exterior and parking lot should be well lit to provide for safe use of the facility. Exterior lights should be resistant to vandalism and energy efficient.

Security systems will be included in this scope of work. A security camera system, access control system, and an intrusion detection system are to be included in the design. An emergency generator is being considered for the new Center. The design and specification of the generator is included in this scope of work.

The HVAC for the building should be designed to meet energy performance guidelines without compromising the comfort of building occupants. System must be accessible for maintenance and repair. Mechanical systems should be engineered for long term operating efficiency, energy costs, and maintenance costs. An overall mechanical systems evaluation must be made available to the project team before a final decision on the mechanical system is made. It is preferred to have separately controlled heating and cooling zones with thermostats in the various areas. The architect/engineer should ensure the mechanical systems can be serviced and maintained by locally available trades-people. If the mechanical system is at ground level, adequate security must be provided.

All interior finish materials should be long lasting, durable, and aesthetically pleasing. Standard finish materials are preferred. The provision of furniture, fixture, and equipment (FF&E) specifications will be included in this scope of work.

Interior signage should be consistent, easy to read, and changeable. Exterior signage should be easily visible and vandal resistant. Directional signage is included in this scope of services.

The new Center will be designed utilizing "Universal Design" and will go beyond ADA Design standards where necessary to attain the highest level of accessibility possible.

It is the intent of the LFUCG to build an energy efficient building and to pursue LEED certification. Creativity will be needed to reduce the additional storm water runoff produced by the new Center and expanded parking lot. Options such as a rainwater collection system would be considered. The stored rainwater could be used for a shared community garden adjacent to the new Center. Pervious pavement would also be considered as a means to reduce the impact of increased stormwater runoff.

The parking lot will be designed to minimize foot traffic that crosses drive aisles and will offer a minimum of 200 spaces. Since the new Center will be located inside an existing park, site layout and landscaping will be designed in coordination with park amenities and landscaping. Temporary parking to accommodate both park activities and construction requirements will be planned by the design team.

The design process will be collaborative. Input from the Center staff and participants will be part of the design process.

Phase A (Schematic Design) deliverables will include two (2) options each with a complete and detailed cost estimate. Ultimately, one option will be selected by the LFUCG. This option will be presented to Council by the Consultant. Refer to Phase A below for a complete list of deliverables.

General Requirements

a. LEED Certification

- i. The new Senior Citizen Center shall be designed by the Consultant to accommodate a minimum rating of LEED-NC Certified by the United States Green Building Council. Support documentation necessary to certify the building shall be provided to the Owner upon request. The Consultant is responsible for obtaining the actual certification for the building.

b. Public Meetings

- i. The Consultant shall attend one public meeting at the beginning of Phase A which will be facilitated by LFUCG Social Services staff. The Consultant's role will be to observe the Center programming presentation and the resultant public feedback.
- ii. A minimum of two public meetings shall be facilitated by the Consultant during this Project. One meeting shall be held at the end of Schematic Design and another at the Owner's discretion. Other meetings will be held as deemed necessary by the Owner. Presentations shall be prepared for each meeting to include schematic level drawings and renderings of the replacement Senior Citizen Center and site.

c. Public Facility Review

- i. The Consultant shall provide the necessary documentation for the Public Facility Review and will present to the Division of Planning as required.

d. Council Presentations

- i. The Consultant must be available for Council Work Sessions and/or Council Meetings to make presentations, answer design questions, and provide change order information as necessary.

e. Energy Modeling

- i. The Consultant shall quantify energy performance relative to a baseline building at the end of Schematic Design and Design Development in compliance with the LEED-NC rating system.
- ii. The Consultant shall also consider how to accommodate the use of possible future alternative energy sources in these facilities.

f. Commissioning Agent

- i. The Consultant is required to involve a third-party commissioning agent throughout the Project to assure system(s) design compliance (Mechanical, Plumbing, and Electrical) with the LEED-NC rating system.

g. Third Party Cost Estimator

- i. The Consultant shall hire a third party estimator to provide detailed construction cost estimates at the end of Phases A, B, and C. The cost estimates shall include all FF&E as well as building construction costs.

2. Phase A

a. Programming/Space Utilization

- i. The consultant shall prepare a written Program which shall set forth the Owner's objectives, schedule, constraints and criteria, including space requirements and relationships, flexibility, and expandability of the space and the program, special equipment, systems, and site requirements.
- ii. This Program shall address the requirements of Civil, Structural, Architectural, Mechanical, Plumbing, and Electrical disciplines as well as accommodate the Project Vision mentioned above.
- iii. The Consultant shall provide the Owner with written and graphic/visual documents displaying a concise yet comprehensive understanding of function, flexibility, and requirements of each of the disciplines as well as an understanding of how LFUCG desires to conduct business. Estimated Project costs and Project timeline shall be conducted by a Consultant provided third-party estimator to ensure alignment with the existing Project budget and timeline.
- iv. Ongoing and continual input from the Owner shall be actively sought throughout the design process. The Consultant shall facilitate a public meeting at the end of Schematic Design to include preliminary drawings and renderings of the new Senior Citizen Center in order to obtain sufficient feedback from the public.

b. Surveys

i. Site Survey

1. The site survey will be available at the time of contract award. The Consultant will be responsible for verifying site dimensions on the proposed site. Any preliminary dimensions provided by the Owner shall not be utilized by the Consultant in final building design.

ii. Geotechnical Survey

1. The Consultant shall furnish services of geotechnical engineers, which may include but are not limited to test borings, test pits, determination of soil bearing values, percolation tests, evaluations of hazardous materials, seismic evaluation, ground corrosion tests and resistivity tests, including necessary operations for anticipating subsoil conditions, with written reports and appropriate recommendations.

iii. Environmental Survey

1. A Phase I Environmental Site Assessment will be available at the time of award. If required, the Consultant shall perform a Phase II Environmental Site Assessment of the proposed site. Results of the survey shall be provided to the Owner upon completion.

- c. **Schematic Design**
 - i. The Consultant shall prepare two options of Schematic Design with cost estimates for each for the Owner's selection. The Schematic Design documents shall consist of drawings and other documents including the site plan, preliminary building plans, sections, and elevations that show how and what systems are anticipated from all disciplines to include but not limited to Civil, Structural, Architectural, Mechanical, Plumbing, and Electrical. Preliminary selections of major building systems and construction materials shall be noted on the drawings or described in writing.
 - ii. Value engineering shall be performed at the end of Schematic Design Development.
- d. **Phase A Deliverables:** (Five hard copies and one electronic copy to be provided as indicated below)
 - i. Consultant shall provide Schematic Design drawings in 11"x17" bound format and will include at a minimum:
 1. Site Plan Schematic
 2. Site Utility Schematic
 3. Site Layout showing buildings and access roads
 4. Architectural Floor Plans
 5. Architectural Elevations
 6. Structural Schematics
 7. Fire Suppression, Plumbing, HVAC, Electrical, Communications, and Electronic Safety & Security Plans Schematic
 8. Sketch perspective or digital modeling of major structure
 9. Energy modeling results or alternate compliance path documentation
 10. Project rendering in color
 11. Phase A outline specifications in 8 1/2"x11" bound format
 12. Phase A Project Schedule
 13. Phase A Cost Estimate prepared by third-party estimator to ensure alignment with any existing project budget and timeline.
 14. Identify and list all regulatory review and permitting requirements
 15. Geotechnical survey report and recommendations
 16. Phase II Environmental Site Assessment (if required)
- e. The Consultant shall not proceed with the next Phase of Work until cost and timeline estimates are aligned with the Owner's budget and timeline, and approved by the Owner. Authorization to commence with Phase B work will be by letter from the Owner after approval of Phase A documents. Any work performed by the Consultant without this written authorization will be at the Consultant's risk.

3. Phase B

a. Design Development

- i. The Consultant shall prepare Design Development documents for the Owner's Approval. The Design Development documents shall illustrate and describe the development of the approved Schematic Design documents and shall consist of drawings and other documents including plans, Sections, elevations, typical construction details, and diagrammatic layouts of building systems to fix and describe the size and character of the Project as to Civil, Structural, Architectural, Mechanical, Plumbing, and Electrical systems, and such other elements as may be appropriate. The Design Development documents shall also include outline specifications that identify major materials and systems and establish in general their quality levels.
- ii. The Consultant shall provide the Owner with a completed Project Design and supporting documents which effectively address the Owner requirements outlined in the Project Vision and Phase A.
- iii. Ongoing and continual input from the Owner shall be actively sought throughout the design process.

b. Phase B Deliverables: (Five hard copies and one electronic copy to be provided as indicated below)

- i. Consultant shall provide Schematic Design drawings in 24"x36" or 30"x42" bound format and will include at a minimum:
 1. Site Plan
 2. Site Utility Plan
 3. Architectural Floor Plans
 4. Architectural Elevations
 5. Sections
 6. Typical Construction Details
 7. Structural Plans
 8. Fire Suppression, Plumbing, HVAC, Electrical, Communications, and Electronic Safety and Security Plans
 9. Revised outline specifications including materials/equipment/fixtures data sheets and other studies, calculations and evaluations as appropriate
 10. Revised energy modeling results or alternate compliance path documentation
 11. Revised Project Schedule
 12. Phase B refined and fine tuned Cost Estimate performed by a third-party estimator to ensure alignment with any existing project budget and timeline.
- c. Value engineering shall be performed at the end of Design Development.
- d. The Consultant shall not proceed with the next Phase of Work until cost and timeline estimates are aligned with the Owner's budget and timeline, and approved by the Owner. Authorization to commence with Phase C work will be by letter from the Owner after approval of Phase B documents. Any work

performed by the Consultant without this written authorization will be at the Consultant's risk.

4. Phase C

a. Construction Documents

- i. The Consultant shall prepare construction documents for the Owner's approval. The construction documents shall illustrate and describe the further development of the approved Design Development documents and shall consist of drawings and specifications setting forth in detail the quality levels of materials and systems and other requirements for the construction of the work. These documents must be sufficient for obtaining final construction pricing, and detailed enough to minimize potential future change orders.
- ii. Upon receiving approval, the Consultant will take the construction documents through the Plan Review process in Building Inspection to obtain any required building permits. The Consultant will complete any revisions or additions of information that are deemed necessary as a result of this review.

b. Energy Modeling

- i. The Consultant shall model the building's energy performance 50 percent into the construction documents to ensure the project Design will obtain the desired energy efficiencies as well as comply with the LEED-NC rating system.

c. Value Engineering

- i. Value engineering shall be performed throughout the process and at completion of the Construction Documents.

d. Ready-to-Advertise

- i. Consultant to prepare "ready to advertise" corrected construction documents, including drawings and specifications incorporating comments from the Phase C Final Review.

e. Phase C Deliverables: (Five hard copies and one electronic copy to be provided as indicated below)

- i. Consultant shall provide Construction Drawings in 24"x36" or 30"x42" bound format and will include at a minimum:
 1. 100% drawings shall include a cover sheet, original site survey, original geotechnical survey, and all necessary civil, landscape, structural, architectural, mechanical, plumbing, fire protection, electrical communications, and other drawings as necessary to completely describe and detail the project. Review Submittal drawings may be submitted as half-size 11"x17" prints upon approval of the Project Manager.
 2. 100% Specifications submitted on bound 8 ½"x11" double-sided hardcopy.
 3. Phase C Project Schedule

4. Phase C concrete project cost estimate to be performed by a third-party estimator to ensure alignment with any existing project budget and timeline.
 5. Energy modeling results or alternate compliance path documentation at 50% construction design.
 6. One set of ready-to-advertise drawings are to be submitted unbound on 24"x36" or 30"x42" paper or vellum sheets.
 7. One set of ready-to-advertise unbound specification masters on 8 ½"x11" one-sided paper.
- f. The Consultant shall not proceed with the next Phase of Work until cost estimates and timelines are aligned with the Owner's budget and approved by the Owner. Authorization to commence with Phase D work will be by letter from the Owner after approval of Phase C documents. Any work performed by the Consultant without this written authorization will be at the Consultant's risk.

5. Phase D

a. Construction Administration

b. Bidding

- i. The Consultant shall assist the Owner in establishing a list of prospective contractors. Following the Owner's approval of the Construction Documents, the Consultant shall assist the Owner in (1) obtaining either competitive bids or negotiated proposals; (2) confirming responsiveness of bids or proposals; (3) determining the successful bid or proposal; if any; and (4) awarding and preparing contracts for construction.

c. Construction Administration

- i. The Consultant shall act in the capacity of an agent of the Owner, overseeing construction to ensure conformity to construction drawings, specifications, and standards.

d. Building Commissioning

- i. The Consultant shall hire a third-party commissioning agent to commission the LFUCG new Senior Citizen Center building ensuring that the Mechanical, Plumbing, and Electrical systems were installed as they were designed and are functioning as they are intended. The Commissioning Agent shall also validate system(s) compliance with the LEED-NC rating system applicable to the Project as the time of construction.

e. Punch Lists , Inspections, and Close Out

- i. To ensure that all construction work is complete, the Consultant shall perform the following steps:
 1. Conduct a project walk-through at the project site and create a subcontractor pre-punch list.
 2. Assign tasks on pre-punch list to appropriate subcontractors.
 3. Ensure that all items are completed in accordance with plans, specifications, and applicable Codes.

4. Conduct a punch list walk through with the LFUCG representative to create a formal punch list. The end user may be asked to participate in this process.
5. Ensure that subcontractors promptly complete all punch list items.
6. Coordinates closure of RFI's and Change Orders; completion of as-builts; transmission of warranties, approved Operations & Maintenance Manuals (O&M's), extra stock, special tools, and spare parts; and provide per the Specifications and other Division 1 General Requirements. This information will be compiled per the Project Close Out requirements.

f. Phase D Deliverables

- i. The Consultant shall provide the Owner with a completed Project that complies with building design, standards, specifications, strategies, concepts, efficiencies and requirements outlined in Phases A-D above. The Project timeline and budget shall be of the utmost priority throughout Phase D of the Project and shall be strictly adhered to unless otherwise approved by the appropriate LFUCG representative.
- ii. The Consultant will coordinate training for Owner of all the major building systems and equipment that are part of the project.
- iii. The Consultant will coordinate the distribution of O&M Manuals for all major building systems and equipment.
- iv. The Consultant shall prepare accurate record drawings that reflect project improvements "as-built" in the field.
- v. The Consultant shall provide an electronic version (AutoCAD, pdf, etc.) of all project documents including but not limited to construction plans at the conclusion of the Project.

Attachment A: Project Location Map

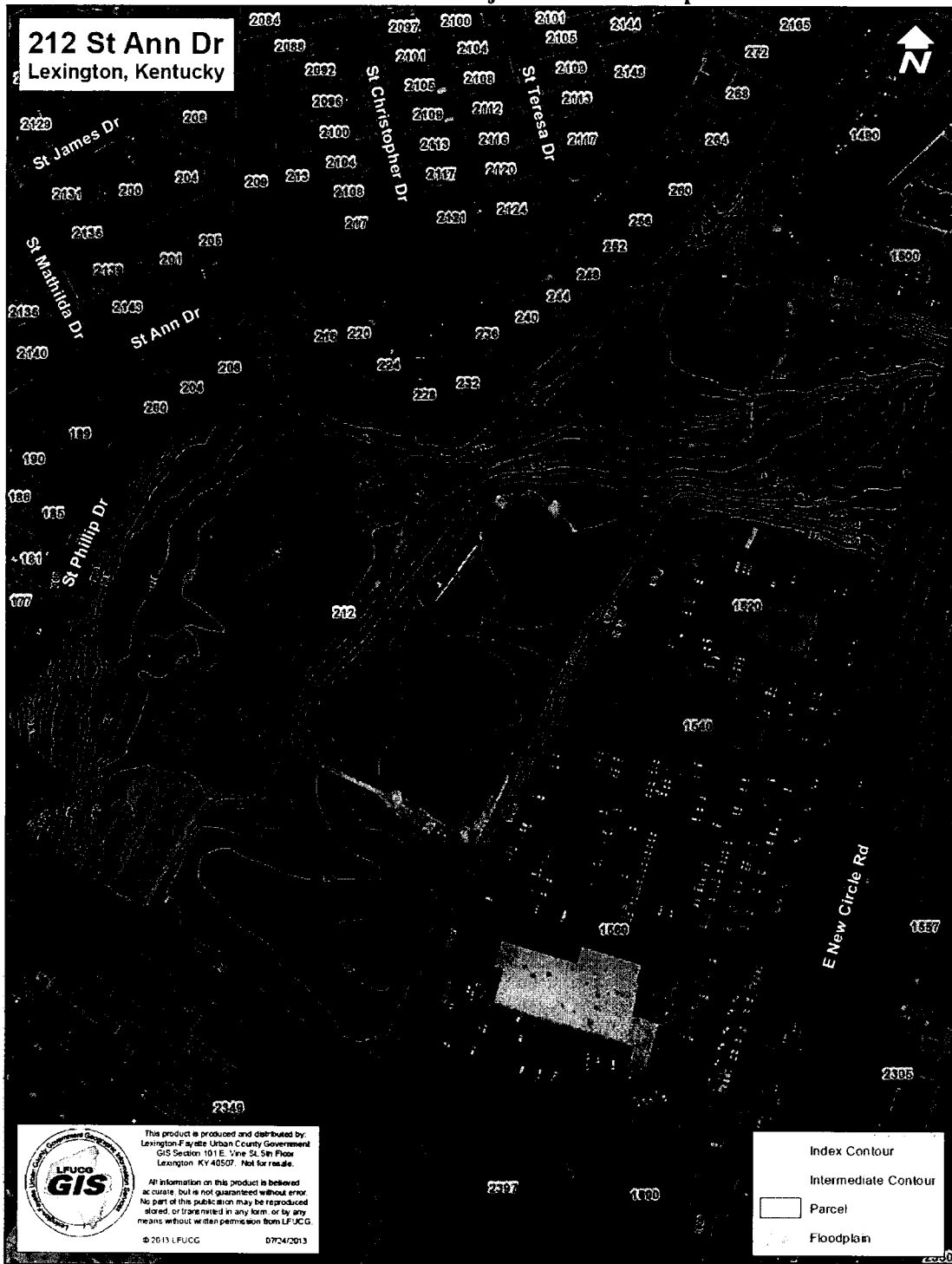

Attachment B: Timeline

Project Schedule:

The following table identifies milestones and the anticipated schedule.

Milestone/Task	Timing/Duration
Public Meeting Attendance–Social Services Presentation of Center Programming	Scheduled by Social Services Staff
Design Charrette	Within 5 days of above Public Meeting
Public Facility Review	Within 10 days of charrette, submit formal letter of request to Planning
Phase A Design Options/Deliverables Due	35 days after Design Charrette
Phase A Option Review and Selection	10 days after Deliverables Received
Phase A Design Presentation to Council	First Work Session date after design option is selected
Public Meeting to Present Schematic Design	Within 5 days of Council presentation
Phase B Deliverables Due	15 days after Council Approval to Proceed
Phase B Approval	5 days after Phase B Deliverables Received
Phase C Deliverables Due	15 days after Phase B Approval
Phase C Approval	5 days after Phase C Deliverables Received
Construction Documents	10 days after Phase C Approval

Days are working days, not calendar days.

Attachment C: SAMPLE Consultant Services Agreement

CONSULTANT SERVICES AGREEMENT

THIS IS AN AGREEMENT made as of _____, 2013 between the LEXINGTON-FAYETTE URBAN COUNTY GOVERNMENT (**OWNER**) and (**CONSULTANT**). **OWNER** intends to proceed with architectural/engineering design services as described in the attached Request for Proposal document. The services are to include the preparation of complete plans and specifications for the construction of the new Senior Citizen Center as contemplated in the **OWNER**'s Request for Proposal No. 28-2013. The services are hereinafter referred to as the Project.

OWNER and **CONSULTANT** in consideration of their mutual covenants herein agree in respect of the performance of professional architectural/engineering services by **CONSULTANT** and the payment for those services by **OWNER** as set forth below.

CONSULTANT was selected by **OWNER** based upon its response to the Request for Proposal No. 28-2013.

CONSULTANT shall provide professional consulting services for **OWNER** in all phases of the Project to which this Agreement applies, serve as **OWNER'S** professional architectural and engineering representative for the Project as set forth below and shall give professional consultation and advice to **OWNER** during the performance of services hereunder.

SECTION 1 - BASIC SERVICES OF CONSULTANT

CONSULTANT shall perform professional services as hereinafter stated which include customary architectural and engineering incidental thereto.

The following documents are incorporated by reference herein as if fully stated and are attached hereto as exhibits: RFP No. 28-2013 (Exhibit "A") and Consultant's Response dated Xxxxx xx, 201x (Exhibit "B").

To the extent there is conflict among their provisions, the provisions of this Agreement shall take precedence, followed by the provisions of Request for Proposal No. 28-2013 (Exhibit "A").

After written authorization to proceed with the Evaluation and Recommendation Phase, **CONSULTANT** shall:

1. Notify the **OWNER** in writing of its authorized representative who shall act as Project architect and liaison representative between the **CONSULTANT** and the **OWNER**.
2. On the basis of "Selection Criteria" in the "Request for Proposal", attached in Exhibit "A", conduct field surveys and gather other necessary

data or information, prepare an evaluation and recommendation document consisting of design options and cost estimates as well as all required deliverables listed in the Request for Proposal. See Exhibit "A" for complete listing of all deliverables.

This Agreement (consisting of pages 1 to 12 inclusive), together with the Exhibits and schedules identified above constitutes the entire Agreement between **OWNER** and **CONSULTANT** and supersedes all prior written or oral understandings. This Agreement and said Exhibits and schedules may only be amended, supplemented, modified, or canceled by a duly executed written instrument.

The General Condition provisions of RFP No. 28-2013 are incorporated herein by reference as if fully stated.

SECTION 2 - ADDITIONAL SERVICES BY CONSULTANT

- 2.1. The **OWNER** may desire to have the **CONSULTANT** perform work or render services in connection with this Project other than provided by Exhibit A of this Agreement. Such work shall be considered as "Additional Services", subject to a change order, supplemental to this Agreement, setting forth the character and scope thereof and the compensation therefore. Work under such change order shall not proceed until the **OWNER** gives written authorization. Should the **OWNER** find it desirable to have previously satisfactorily completed and accepted plans or parts thereof revised, the **CONSULTANT** shall make such revisions as directed, in writing, by the **OWNER**. This work shall be considered as "Additional Services" and shall be paid as such.
- 2.2. All "Additional Services" is subject to prior written authorization of **OWNER** and necessary appropriations made by the Urban County Council.

SECTION 3 - OWNER'S RESPONSIBILITIES

OWNER shall:

- 3.1. Provide criteria and information as to **OWNER'S** requirements for the Project, including design objectives and constraints, space, capacity and performance requirements, flexibility and expandability, and any budgetary limitations.
- 3.2. Assist **CONSULTANT** by placing at his disposal available information pertinent to the Project.
- 3.3. Examine all studies, reports, sketches, drawings, specifications, proposals and other documents presented by **CONSULTANT**, and render in writing decisions pertaining thereto within a reasonable time so as not to delay the services of **CONSULTANT**.

- 3.4. Designate in writing a person to act as **OWNER'S** representative with respect to the services to be rendered under this Agreement. Such person shall have complete authority to transmit instructions, receive information, interpret and define **OWNER'S** policies and decisions with respect to materials, equipment, elements and systems pertinent to **CONSULTANT'S** services.
- 3.5. Give written notice to **CONSULTANT** whenever **OWNER** observes or otherwise becomes aware of any development that affects the scope or timing of **CONSULTANT'S** services, or any defect in the work of Contractor(s).
- 3.6. Furnish or direct **CONSULTANT** to provide, necessary Additional Services as stipulated in Section Two (2) of this Agreement or other services as required.

SECTION 4 - PERIOD OF SERVICES

- 4.1. Time is of the essence. See Exhibit "A" (attached) for the project schedule.
- 4.2. The provisions of this Section Four (4) and the various rates of compensation for **CONSULTANT'S** services provided for elsewhere in this Agreement have been agreed to in anticipation of the orderly and continuous progress of the Project through completion.

If delays result by reason of acts of the **OWNER** or approving agencies or other causes, which are beyond the control of the **CONSULTANT**, an extension of time for such delay will be considered. If delays occur, the **CONSULTANT** shall within 30 days from the date of the delay apply in writing to the **OWNER** for an extension of time for such reasonable period as may be mutually agreed upon between the parties, and if approved, the Project schedule shall be revised to reflect the extension. Such extension of time to the completion date shall in no way be construed to operate as a waiver on the part of the **OWNER** of any of its rights in the Agreement. Section 6.5, under DISPUTES, of this Agreement, shall apply in the event the parties cannot mutually agree upon an extension of time.

In the event that the overall delay resulting from the above described causes is sufficient to prevent complete performance of the Agreement within six (6) months of the time specified therein, the Agreement fee or fees shall be subject to reconsideration and possible adjustment. Section 6.5 of this Agreement shall apply in the event the parties cannot mutually agree upon an adjustment of fee.

SECTION 5 - PAYMENTS TO CONSULTANT

5.1 Methods of Payment for Services of CONSULTANT

5.1.1 For Basic Services.

Lump Sum Pricing

All Lump Sum Pricing shall include all direct labor and supervision necessary to complete the item in a manner that meets or exceeds the customer's satisfaction. It shall also include the labor payroll costs, overhead (such as unemployment taxes, general liability insurance, rent, utilities, phones, supplies, administrative salaries, F.I.C.A. sick and vacations, etc. disposal fees tool allowance, equipment, materials, profit and all other costs used on the job. The negotiated cost of services is represented in Exhibit C and below.

<u>Phase A Cost (Total Cost of Services Below)</u>	\$ _____
Programming/Space Utilization:	\$ _____
Geotechnical Survey and Report:	\$ _____
Environmental Survey and Report (if required):	\$ _____
Schematic Design:	
(percentage of construction costs)	_____ %
Building Commissioning:	\$ _____
Building Energy Model:	\$ _____
Interior Design:	\$ _____
Independent Cost Estimator:	\$ _____

The LFUCG reserves the right to negotiate the following fees with the selected Consultant for Phase A or solicit new proposals for Phases B – D.

<u>Phase B Cost (Total Cost of Services Below)</u>	\$ _____
Design Development:	
(percentage of construction costs)	_____ %
Building Commissioning:	\$ _____
Interior Design:	\$ _____
Independent Cost Estimator:	\$ _____

<u>Phase C Cost (Total Cost of Services Below)</u>	\$ _____
Construction Documents:	
(percentage of construction costs)	_____ %
Building Energy Model:	\$ _____
LEED Certification:	\$ _____
Building Commissioning:	\$ _____
Independent Cost Estimator:	\$ _____
Interior Design:	\$ _____
Signage:	\$ _____

<u>Phase D Cost (Total Cost of Services Below)</u>	\$ _____
Bidding Assistance:	\$ _____
Construction Administration:	\$ _____
Building Commissioning:	
(not to exceed percentage of construction budget)	_____ %
Punch List, Inspections, & Close Out:	\$ _____

5.1.2. For Additional Services.

"Additional Services" shall be paid for by the **OWNER** on the basis of unit pricing, the amount of which shall be determined by negotiation. In the event the **OWNER** and the **CONSULTANT** are unable to agree upon the amount of payment for "Additional Services", then the amount of such payment shall be determined as set forth in Section 6.5, "DISPUTES" of this Agreement.

Unit Pricing

LFUCG reserves the right to increase or decrease frequencies of unit cost i.e., each task and / or services under this agreement. If Additional Services are requested, the base contract may be increased and/or decreased on the basis of these proposed unit rates. No price adjustments will be made, unless mutually agreed to in advance or as a result of temporary conditions (defined as 30 days or less from the date of the last invoice).

All Unit Pricing Hourly Rates shall include all direct labor, any supervision required, labor payroll costs, overhead (such as unemployment taxes, general liability insurance, rent, utilities, phones, supplies, administrative salaries, F.I.C.A. sick and vacations, etc.) disposal fees tool allowance, equipment, materials, profit and all other costs used on the job.

<u>Title/Skill Level</u>	<u>Hourly Rate</u>
_____	_____ \$/HR
_____	_____ \$/HR
_____	_____ \$/HR
_____	_____ \$/HR
_____	_____ \$/HR
_____	_____ \$/HR
_____	_____ \$/HR

Additional Services may require procurement beyond the base contract. Procurement shall comply with the specifications set forth herein. The **CONSULTANT** markup over the invoiced price shall be _____
10 %

5.2. Times of Payment.

5.2.1. CONSULTANT shall submit a schedule of values subject to approval by the OWNER prior to starting work. The approved schedule of values will be the basis for monthly statements for Basic Services and Additional Services rendered. The Statements will be based upon CONSULTANT'S estimate of the proportion of the total services actually completed at the time of billing and are subject to approval by the OWNER. OWNER shall pay CONSULTANT'S monthly statements within thirty (30) days of receipt.

5.3. Other Provisions Concerning Payments.

5.3.1. In the event the Agreement is terminated by the OWNER without fault on the part of the CONSULTANT, the CONSULTANT shall be paid for the work performed or services rendered an amount bearing the same ratio to the total Agreement fee as the amount of work completed or partially completed and delivered to the OWNER is to the total amount of work provided for herein, as determined by mutual agreement between the OWNER and the CONSULTANT.

5.3.2. In the event the services of the CONSULTANT are terminated by the OWNER for fault on the part of the CONSULTANT, the CONSULTANT shall be paid reasonable value of the work performed or services rendered and delivered, and the amount to be paid shall be determined by the OWNER.

5.3.3. In the event the CONSULTANT shall terminate the Agreement because of gross delays caused by the OWNER, the CONSULTANT shall be paid as set forth in Section 5.3.1. above.

SECTION 6 – ADDITIONAL GENERAL CONSIDERATIONS

6.1. Termination

6.1.1. The obligation to provide further services under this Agreement may be terminated by either party upon ten (10) days written notice in the event of substantial failure by the other party to perform in accordance with the terms hereof through no fault of the terminating party, provided the non-terminating party fails to cure such default within the ten (10) day period.

6.1.2. The OWNER reserves the right to terminate the Agreement for any reason at any time upon seven (7) days written notice to the CONSULTANT.

6.2. Ownership and Reuse of Documents.

All documents, including Drawings and Specifications, prepared by the CONSULTANT pursuant to this Agreement shall be delivered to and become the property of the OWNER.

The **OWNER** shall have the right to reuse same without restriction or limitation, but without liability or legal exposure to **CONSULTANT**.

6.3. Legal Responsibilities and Legal Relations.

6.3.1. The **CONSULTANT** shall familiarize himself with and shall at all times comply with all federal, state and local laws, ordinances, and regulations which in any manner affect the services of this Agreement.

6.3.2. In performing the services hereunder, the **CONSULTANT** and its **CONSULTANTS**, employees, agents and representatives shall not be deemed or construed to be employees of **OWNER** in any manner whatsoever. Except as otherwise provided in this Agreement, the **CONSULTANT** shall be acting as an independent contractor. The **CONSULTANT** shall not hold itself out as, nor claim to be, an officer or employee of **OWNER** by reason hereof and shall not make any claim, demand or application to or for any right or privilege applicable to an officer or employee of **OWNER**. The **CONSULTANT** shall be solely responsible for any claims for wages or compensation by **CONSULTANT'S** employees, agents and representatives, including **CONSULTANTS**, and shall save and hold **OWNER** harmless therefrom.

6.3.3. The parties hereto agree that causes of actions between the parties shall be governed by applicable provisions of the Kentucky Revised Statutes.

6.4. Successors and Assigns.

6.4.1. **CONSULTANT** binds itself and his partners, successors, executors, administrators, assigns and legal representatives to this Agreement in respect to all covenants, agreements and obligations of this Agreement. **CONSULTANT** shall not assign any interest, obligation or benefit in this Agreement. **CONSULTANT** shall not assign any interest, obligation or benefit in this Agreement nor transfer any interest in the same, whether by assignment or novation, without prior written consent of **OWNER**.

6.4.2. The **CONSULTANT** shall not subcontract more than fifty percent (50%) of the work, based upon dollar value, to be provided under this Agreement. The **CONSULTANT** shall obtain written approval prior to subletting or assigning any services contained in this Agreement, and consent to sublet or assign any part of this Agreement shall not be construed to relieve the **CONSULTANT** of any responsibility for compliance with the provisions of this Agreement.

6.4.3. Nothing herein shall be construed to give any rights or benefits hereunder to anyone other than **OWNER** and **CONSULTANT**.

6.5. Disputes.

Except as otherwise provided in this Agreement, any dispute concerning the amount of payment due the **CONSULTANT** or any dispute concerning any question of fact of any act

to be performed under this Agreement, which is not disposed of by agreement between the Urban County Division of Central Purchasing and the **CONSULTANT**, shall be submitted to the Commissioner, Department of General Services, Lexington-Fayette Urban County Government for review. The decision of the Commissioner as to the determination of such dispute shall be final and conclusive unless determined by a court of competent jurisdiction to have been fraudulent, capricious, arbitrary or so grossly erroneous as necessarily to imply bad faith. Pending a final decision of a dispute hereunder, the **CONSULTANT** shall proceed diligently with the performance of the Agreement in accordance with the directions of the **OWNER**.

6.6. Accuracy of CONSULTANT'S Work.

The **CONSULTANT** shall be required to perform this Agreement in accordance with the degree of ordinary and reasonable skill and care usually exercised by professional architects and engineers prevailing at the time, place and under similar conditions as the services hereunder are rendered.

The **CONSULTANT** shall be responsible for the accuracy of all work, even though Drawings and Specifications have been accepted by the **OWNER**, and shall make any necessary revisions or corrections resulting from errors and/or omissions on the part of the **CONSULTANT**, without additional compensation. By submission of reports, soils and subsurface information, quantities estimates, calculations and Drawings and Specifications to the **OWNER**, the **CONSULTANT** has made a statement that, to the best of its belief and knowledge, the information is accurate. Failure on the part of **CONSULTANT** to provide the expected level of accuracy may be grounds for the **OWNER** to disqualify **CONSULTANT** from consideration for future **CONSULTANT** service agreements.

6.7. Security Clause.

The **CONSULTANT** certifies that he shall not at any time release or divulge any information concerning the services covered by this Agreement to any person or any public or private organization except the **OWNER** without prior approval of the **OWNER**.

6.8. Access to Records.

The **CONSULTANTS** and his sub-**CONSULTANTS** shall maintain all books, documents, papers, and accounting records, and make such materials available at their respective offices at all reasonable times during the contract period and for three (3) years from the date of final payment under the contract for inspection by the **OWNER**, and copies thereof shall be furnished if requested. Failure to maintain such records for three (3) years after the date of final payment may be grounds for the **OWNER** to disqualify the **CONSULTANT** from consideration for future **CONSULTANT** service agreements.

6.9. Resident Services During Construction.

The **OWNER** will furnish a Resident Project Inspector.

6.10. Required Risk Management Provisions.

The Risk Management Provisions of RFP No. 28-2013 are incorporated herein by reference as if fully stated. Copies of the required Certificates of Insurance shall be provided to **OWNER** as required therein.

SECTION 7 - EQUAL EMPLOYMENT OPPORTUNITY

During the performance of this service agreement, the **CONSULTANT** agrees as follows:

- 7.1. The **CONSULTANT** will not discriminate against any employee or application for employment because of race, color, religion, national origin, sex, age or handicap. The **CONSULTANT** will take affirmative action to ensure that applicants are employed, and that employees are treated during employment without regard to their race, color, religion, national origin, sex, age or handicap. Such action shall include, but not be limited to the following: employment upgrading, demotion or transfer, recruitment or recruitment advertising, layoff or termination; rates of pay or other forms of compensation; and selection for training, including apprenticeships. The **CONSULTANT** agrees to post in conspicuous places, available to employees and applicants for employment, notices to be provided setting forth the provisions of this non-discrimination clause.
- 7.2 The **CONSULTANT** will, in all solicitations or advertisements for employees placed by or on behalf of the **CONSULTANT**, state that all qualified applicants will receive consideration for employment without regard to race, color, religion, national origin, sex, age (between forty and seventy), or handicap.

SECTION 8 - SPECIAL PROVISIONS

- 8.1. This Agreement is subject to the following provisions.

8.1.2. Pursuant to subparagraph 3.4 of this Agreement, **OWNER** has assigned the appropriate LFUCG employee (the "**OWNER'S** Agent"), as the authorized agent of **OWNER**, to monitor, direct and review the performance of work of the **CONSULTANT**. Documents, data, reports and all matters associated with carrying out this Agreement shall be addressed to the **OWNER'S** Agent or their designee. Questions by the **CONSULTANT** regarding interpretations of the terms, provisions and requirements under this Agreement shall be addressed to the **OWNER'S** Agent or their designee. The **CONSULTANT** shall look only to the **OWNER'S** Agent or their designee for direction in its performance under this Agreement; no other direction shall be binding upon **OWNER**. **OWNER** shall respond to written requests by **CONSULTANT** within thirty (30) days.

IN WITNESS WHEREOF, the parties hereto have made and executed this Agreement as of the day and year first above written.

OWNER:

CONSULTANT:

Design Services for Replacement Senior Citizen Center

Request for Proposal No. 28-2013

Form of Proposal

Consultant:

Address:

1. General

- a. The undersigned Consultant, having read and examined the specifications and associated documents for the above designated work, affirms agreement to complete all work in accordance with the contract documents.
- b. The selected Successful Consultant (SC) shall verify all mentioned requirements in these contract documents. The SC shall confirm in writing any discrepancies found within one week of being informed of successful proposal.
- c. The undersigned agrees that this proposal constitutes a firm offer to LFUCG which cannot be withdrawn for one hundred twenty (120) calendar days from and after the stated closing time, or until a contract is fully executed by LFUCG and a third party, whichever occurs earlier.
- d. The Consultant shall include Technical Information as required herein.

2. Submittal Requirements: Interested firms are encouraged to submit their qualifications which will include the information below. Failure to comply with this requirement may lead in disqualification of the Consultant's proposal:

- a. Signed cover letter stating interest in the project. The cover letter should indicate the proposer's willingness to enter into an agreement with the LFUCG. An officer of the company who has authority to commit their firm to the proposed project must sign the letter.
- b. Additional company information to be provided shall include company history, key management members, major accomplishments, inter-company or third party alliances or partnerships, and any major pending litigation and facts of the case(s).
- c. Narrative on how customer satisfaction is tracked.
- d. Copies of written training program and quality control program.
- e. Provide the current number of employees and employee types.

- f. Statement of general firm qualifications and capacity which should include firm location, where the work will be performed, and the firm's background and demonstrated ability to perform the required services for this project.
 - g. Project Team list including sub consultants indicating key professionals that will be specifically assigned to work on this project. Identify project manager. Detailed resumes for the key professionals and project manager should be included with the proposal. Describe team members' educational background, related experience, experience in providing like services to governmental entities, and individual references within such entities. Describe how the team has worked together on similar projects in the past.
 - h. Summary of firm's recent (5 year) experience in similar/representative projects including construction costs and references.
 - i. Conflict of Interest Statement clearly stating the proposer has no conflicts of interest in providing professional services on the project.
 - j. Approach to project inclusive of proposed work scope, preliminary design concepts, approach, and related considerations.
 - k. Ability to meet required deadlines including demonstrating the ability to integrate this project into the firm's present workload (provide current and projected staff workload data).
 - l. References: names and contact information of previous clients on similar projects within the past five (5) years with a description of the type of project completed on schedule and on budget. A minimum of three references is required.
3. Proposals will be limited to 20 pages not including the required LFUCG documents. Proposals in excess of 20 pages single-sided pages in length may not be considered.
 4. Respondents are responsible for all costs associated with the preparation of materials in response to this RFP. LFUCG assumes no responsibility for such costs. LFUCG reserves the right to waive any formality in the submitted statements of qualifications, to reject any and all statements of qualifications or to re-advertise for additional statements of qualifications.
5. **Work Plan:** Consultant shall provide a plan to complete the work described herein in submitted proposal. Included in work plan shall be:
 - a. A check list of what specific deliverables will be provided at each design phase and/or milestone and what discipline in their team will provide that deliverable.
 - b. A specific budget and schedule to complete services described herein.
 - c. An explanation of the communication/documentation and collaboration plan.
 - d. A team plan on sustainable design.
 - e. An explanation of the approach that will be used to assure quality and well coordinated documents between all disciplines.
 - f. An explanation of the team Quality Control Program from design through construction administration.

6. Lump Sum Pricing

- a. All Lump Sum Pricing shall include all direct labor and supervision necessary to complete the item in a manner that meets or exceeds the customer's satisfaction. It shall also include the labor payroll costs, overhead (such as unemployment taxes, general liability insurance, rent, utilities, phones, supplies, administrative salaries, F.I.C.A. sick and vacations, etc. disposal fees tool allowance, equipment, materials, profit and all other costs used on the job.
- b. Provide Firm Lump Sum Cost for providing LFUCG with services as noted in these specifications.

<u>Phase A Cost (Total Cost of Services Below)</u>	\$ _____
Programming/Space Utilization:	\$ _____
Geotechnical Survey and Report:	\$ _____
Environmental Survey and Report (if required):	\$ _____
Schematic Design: (percentage of construction costs)	_____ %
Building Commissioning:	\$ _____
Building Energy Model:	\$ _____
Interior Design:	\$ _____
Independent Cost Estimator:	\$ _____

The LFUCG reserves the right to negotiate the following fees with the selected Consultant for Phase A or solicit new proposals for Phases B – D. Phase B - D proposals shall be valid for 12 months from contract award.

<u>Phase B Cost (Total Cost of Services Below)</u>	\$ _____
Design Development: (percentage of construction costs)	_____ %
Building Commissioning:	\$ _____
Interior Design:	\$ _____
Independent Cost Estimator:	\$ _____

<u>Phase C Cost (Total Cost of Services Below)</u>	\$ _____
Construction Documents: (percentage of construction costs)	_____ %
Building Energy Model:	\$ _____
LEED Certification:	\$ _____

Building Commissioning: \$ _____
 Independent Cost Estimator: \$ _____
 Interior Design: \$ _____
 Signage: \$ _____

Phase D Cost (Total Cost of Services Below) \$ _____
 Bidding Assistance: \$ _____
 Construction Administration: \$ _____
 Building Commissioning:
 (not to exceed percentage of construction budget) _____ %
 Punch List, Inspections, & Close Out: \$ _____

7. Unit Pricing

- a. LFUCG reserves the right to increase or decrease frequencies of unit cost i.e., each task and / or services under this agreement. If Additional Services are requested, the base contract may be increased and/or decreased on the basis of these proposed unit rates. No price adjustments will be made, unless mutually agreed to in advance or as a result of temporary conditions (defined as 30 days or less from the date of the last invoice).
- b. All Unit Pricing Hourly Rates shall include all direct labor, any supervision required, labor payroll costs, overhead (such as unemployment taxes, general liability insurance, rent, utilities, phones, supplies, administrative salaries, F.I.C.A. sick and vacations, etc.) disposal fees tool allowance, equipment, materials, profit and all other costs used on the job.

<u>Title/Skill Level</u>	<u>Hourly Rate</u>
_____	_____ \$/HR
_____	_____ \$/HR
_____	_____ \$/HR
_____	_____ \$/HR
_____	_____ \$/HR
_____	_____ \$/HR
_____	_____ \$/HR
_____	_____ \$/HR

- c. Additional Services may require procurement beyond the base contract. Procurement shall comply with the specifications set forth herein. The Consultant markup over the invoiced price shall be _____ %

RISK MANAGEMENT PROVISIONS
INSURANCE AND INDEMNIFICATION – Revised 12/26/13

INDEMNIFICATION AND HOLD HARMLESS PROVISION

- (1) It is understood and agreed by the parties that Consultant hereby assumes responsibility and liability for damages to persons or property caused by or resulting from or arising out of any negligent act or omission on the part of Consultant or its employees, servants, owners, principals, licensees, assigns or subcontractors of any tier (hereinafter "Consultant") under or in connection with this agreement and/or the provision of goods or services and the negligent performance or failure to perform any work required thereby.
- (2) Consultant shall indemnify, save, hold harmless and defend the Lexington-Fayette Urban County Government and its elected and appointed officials, employees, volunteers, and successors in interest (hereinafter "LFUCG") from and against liability, damages, and losses, including but not limited to, demands, claims, obligations, causes of action, judgments, penalties, fines, liens, costs, expenses, interest, defense costs and reasonable attorney's fees that are connected with, or that arise or are alleged to have arisen, directly or indirectly, from or by Consultant's negligent performance or breach of the agreement and/or the provision of goods or services provided that: (a) it is attributable to personal injury, bodily injury, sickness, or death, or to injury to or destruction of property (including the loss of use resulting therefrom) and from the negligent acts, errors or omissions or willful misconduct of the Consultant; and (b) not caused solely by the active negligence or willful misconduct of LFUCG.
- (3) Notwithstanding, the foregoing, with respect to any professional services performed by Consultant hereunder (and to the fullest extent permitted by law), Consultant shall indemnify, save, hold harmless and defend LFUCG from and against liability, damages and losses, including but not limited to, demands, claims, obligations, causes of action, judgments, penalties, fines, liens, costs, expenses, interest, defense costs and reasonable attorney's fees, for any damage due to death or injury to any person or injury to any property (including the loss of use resulting therefrom) to the extent arising out of, pertaining to or relating to the negligence of Consultant in the performance of this agreement.
- (4) In the event LFUCG is alleged to be liable based upon the above, Consultant shall defend such allegations and shall bear all costs, fees and expenses of such defense, including but not limited to, all reasonable attorneys' fees and expenses, court costs, and expert witness fees and expenses, using attorneys approved in writing by LFUCG, which approval shall not be unreasonably withheld.
- (5) These provisions shall in no way be limited by any financial responsibility or insurance requirements, and shall survive the termination of this agreement.

FINANCIAL RESPONSIBILITY

Consultant understands and agrees that it shall, prior to final acceptance of its proposal and the commencement of any work or services, demonstrate the ability to assure compliance with the above Indemnity provisions and these other risk management provisions.

INSURANCE REQUIREMENTS

YOUR ATTENTION IS DIRECTED TO THE INSURANCE REQUIREMENTS BELOW, AAND YOU MAY NEED TO CONFER WITH YOUR INSURANCE AGENTS, BROKERS, OR

CARRIERS TO DETERMINE IN ADVANCE OF SUBMISSION OF A RESPONSE THE AVAILABILITY OF THE INSURANCE COVERAGES AND ENDORSEMENTS REQUIRED HEREIN. IF YOU FAIL TO COMPLY WITH THE INSURANCE REQUIREMENTS BELOW, YOU MAY BE DISQUALIFIED FROM AWARD OF THE CONTRACT.

Required Insurance Coverage

Consultant shall procure and maintain for the duration of this contract the following or equivalent insurance policies at no less than the limits shown below and cause its subcontractors to maintain similar insurance with limits acceptable to LFUCG in order to protect LFUCG against claims for injuries to persons or damages to property which may arise from or in connection with the performance of the work or services hereunder by Consultant. The cost of such insurance shall be included in any bid:

<u>Coverage</u>	<u>Limits</u>
General Liability (Insurance Services Office Form CG 00 01)	\$1 million per occurrence, \$2 million aggregate or \$2 million combined single limit
Commercial Automobile Liability (Insurance Services Office Form CA 0001)	combined single, \$1 million per occurrence
Professional Liability aggregate	\$1 million per occurrence, \$2 million
Worker's Compensation	Statutory
Employer's Liability	\$500,000.00

The policies above shall contain the following conditions:

- a. All Certificates of Insurance forms used by the insurance carrier shall be properly filed and approved by the Department of Insurance for the Commonwealth of Kentucky. LFUCG shall be named as an additional insured in the General Liability Policy and Commercial Automobile Liability Policy using the Kentucky DOI approved forms.
- b. The General Liability Policy shall be primary to any insurance or self-insurance retained by LFUCG.
- c. The General Liability Policy shall have a Professional Liability endorsement (including Errors and Omissions) for any services performed pursuant to the contract, and/or a separate Professional Liability Policy shall be obtained unless it is deemed not to apply by LFUCG.
- d. The Professional Liability policy shall be maintained for a minimum of three years beyond the completion date of the project, to the extent commercially available. If not commercially available, Consultant shall notify LFUCG and obtain similar insurance that is commercially available and acceptable to LFUCG.
- e. LFUCG shall be provided at least 30 days advance written notice via certified mail, return receipt requested, in the event any of the required policies are canceled or non-renewed.
- f. Said coverage shall be written by insurers acceptable to LFUCG and shall be in a form acceptable to LFUCG. Insurance placed with insurers with a rating classification of no less than Excellent (A or A-) and a financial size category of no less than VIII, as defined by the most current Best's Key Rating Guide shall be deemed automatically acceptable.