



Lexington-Fayette Urban County Government
DEPARTMENT OF GENERAL SERVICES

TRANSMITTAL

Date: April 25, 2016

Contract Number: 227-2014

Purchase Order Number: LF00120278

Bid Package Number: 99-2014

Capital Project Number: TBD

Work Order Number: N/A

Building: Senior Citizen Center

Project Description: Replacement Senior Citizen Center Construction

To: Josh Marrillia, Marrillia Design & Construction

RE: Change Order #41 fully executed

CC: Harding Dowell, EOP Architects

Martha Allen, Council Clerk

Trina Brown [1105-606102-6081-90511 IH_PARK_SR_2016]

From: Joyce Thomas, General Services *Joyce*

We Are Sending You:

Contract

Operation and Maintenance Manuals

Warranties

Change Order

Payment Application

Plans

Item	Copies	Description	Pages	Date
1.	1	Change Order #41 fully executed	26	4/25/2016

THESE ARE TRANSMITTED AS INDICATED BELOW:

FOR APPROVAL

FOR ACTION (Trina Brown)

FOR YOUR USE

FOR FILE

FOR YOUR REVIEW AND COMMENT

FOR SIGNATURE

OTHER:

REPLY BY _____ TO AVOID DELAY IN CONSTRUCTION

Remarks:

R# 665-2015

**LEXINGTON-FAYETTE URBAN COUNTY
GOVERNMENT CONTRACT CHANGE ORDER**

Page 1 of 2

To (Contractor):
Marrilla Design & Construction
259 West Short Street
Suite 325
Lexington, KY 40507

Date:	April 21, 2016
Project:	Senior Citizen Center Construction
Location:	Lexington
Contract No.	227-2014
Original Contract Amt.	\$8,882,900.00
Cumulative Amount of Previous Change Orders	\$1,443,389.37
Percent Change - Previous Change Orders	16.25%
Total Contract Amount Prior to this Change Order	\$10,326,289.37
Change Order No.	41

You are hereby requested to comply with the following changes from the contract plans and specification;

Current Change Order

Item No.	Description of changes-quantities, unit prices, change in completion date, etc.	Decrease in contract price	Increase in contract price	
1	Change material for coping above stone walls from composite to aluminum and install icewater shield underlayment and additional metal flashing per PR 062 & 063 (this is a cost neutral change)		\$0.00	
2	Raise manhole at pickleball court per PR 65		\$9,563.00	
	Total decrease	\$0.00		
	Total increase		\$9,563.00	
	Net Amount of this Change Order	\$9,563.00		
	New Contract Amount Including this Change Order	\$10,335,852.37		
	Percent Change - This Change Order			0.11%
	Percent Change - All Change Orders			16.36%

The time provided for the completion in the contract and all provisions of the contract will apply hereto.

Recommended by *[Signature]* (Project Manager) Date 4/22/16

Accepted by *[Signature]* (Contractor) Date 4/22/16

Approved by *[Signature]* (Director) Date 4-25-16

Approved by *[Signature]* (Commissioner) Date 4-25-16

Approved by *[Signature]* (Mayor or CAO) Date 4-25-16

JUSTIFICATION FOR CHANGE

PROJECT: Senior Citizen Center Construction

CONTRACT NO. 227-2014

CHANGE ORDER NO. 41

1. Necessity for change: Roofing contractor has recommended changing the material for roof coping above the stone walls from composite to aluminum for a better installation. PR 62 & 63 call for ice/water shield membranes to be added in two locations and additional flashing at gutters. These changes cancel each other out from a cost perspective. Grading issues are causing the manhole adjacent to the pickleball court to be raised. This will impact the pickleball court which will have to be partially cut out and patched.
2. Is proposed change an alternate bid? ___ Yes X No
3. Will proposed change alter the physical size of the project? ___ Yes X No
If "Yes", explain.
4. Effect of this change on other prime contractors: N/A
5. Has consent of surety been obtained? ___ Yes X Not Necessary
6. Will this change affect expiration or extent of insurance coverage? ___ Yes X No
If "Yes", will the policies be extended? ___ Yes ___ No
7. Effect on operation and maintenance costs: Aluminum coping above stone walls will create a more sound roof coping assembly.
8. Effect on contract completion date: 0 working days

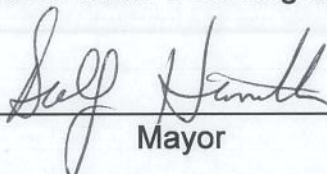

Mayor

4-25-16
Date



architecture | interiors

Proposal Request Transmittal

EOP Architects | 201 W Short St Suite 700 Lexington KY 40507 United States

PROJECT	LFUCG Senior Citizens' Center 201333	DATE SENT	3/24/2016
SUBJECT	Ice/Water Shield at CW 1+2	PROPOSAL REQUEST ID	PR-062
TYPE	Proposal Request	TRANSMITTAL ID	00920
PURPOSE	For Review and Response	VIA	Info Exchange

FROM

NAME	COMPANY	EMAIL	PHONE
Harding Dowell	EOP Architects	hdowell@eopa.com	(859) 231-7538

TO

NAME	COMPANY	EMAIL	PHONE
Travis Harris	Marrillia Design and Construction	tharris@marrillia.com	

REMARKS:

Created by: Harding Dowell

Description:

Please provide pricing to apply ice/water shield at the horizontal wedge-shaped areas at the top of curtain walls 1 and 2. Refer to sketches for areas and details.

Thanks,

Harding

Proposal Request Transmittal

DATE: 3/24/2016
ID: 00920

DESCRIPTION OF CONTENTS

QTY	DATED	TITLE	NUMBER	SCALE	SIZE	NOTES
1	3/24/2016	160324_PR-062_SKA-118.pdf				

COPIES:

Brian Gravitt (Marrillia Design and Construction)
Jim Martin (Marrillia Design and Construction)
Josh Marrillia (Marrillia Design and Construction)
Rob Price (Marrillia Design and Construction)
Jessica Walker (LFUCG)
Joyce Thomas (LFUCG)
Martin Woodford (LFUCG)

1 ROOF DETAIL
 SKA-118 SCALE: 1/2" = 1'-0"

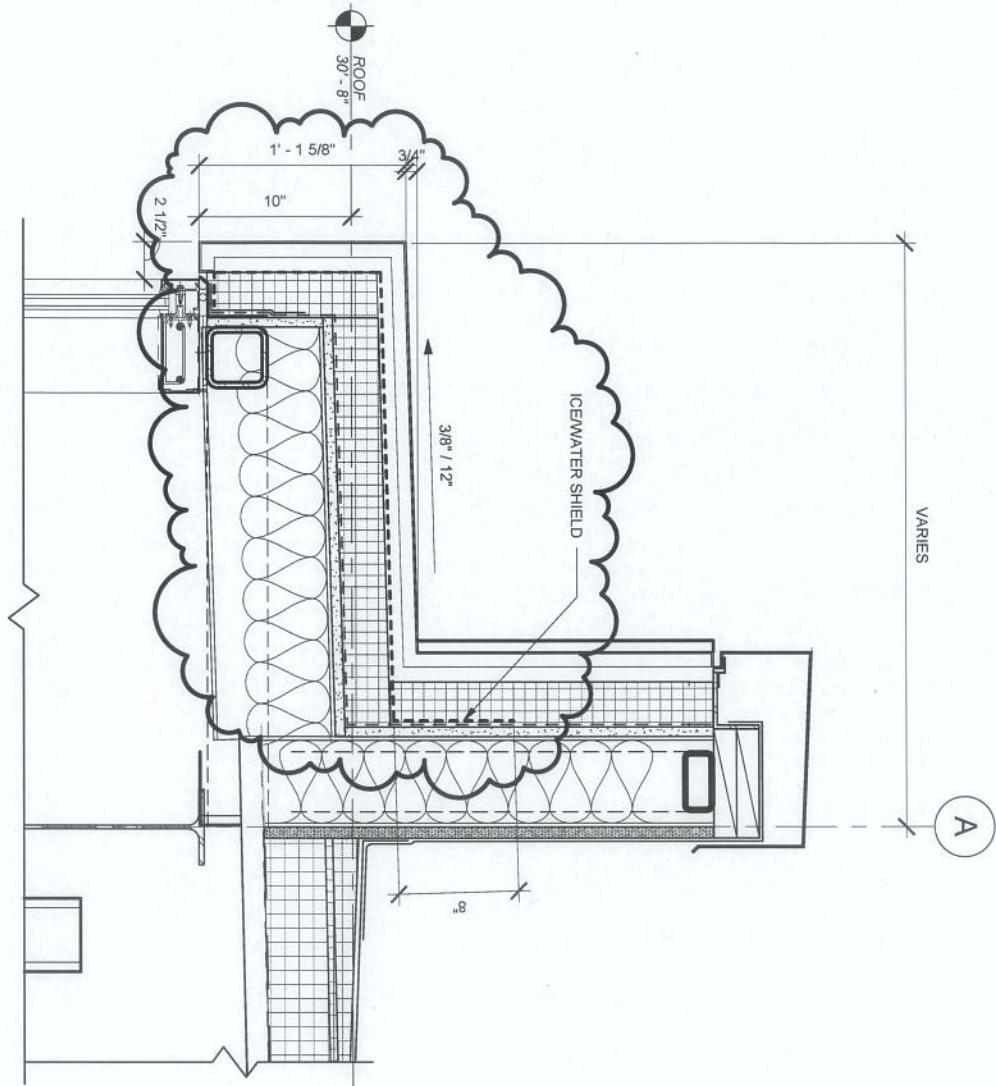

2 PARTIAL ROOF PLAN
 SKA-118 SCALE: 1/8" = 1'-0"

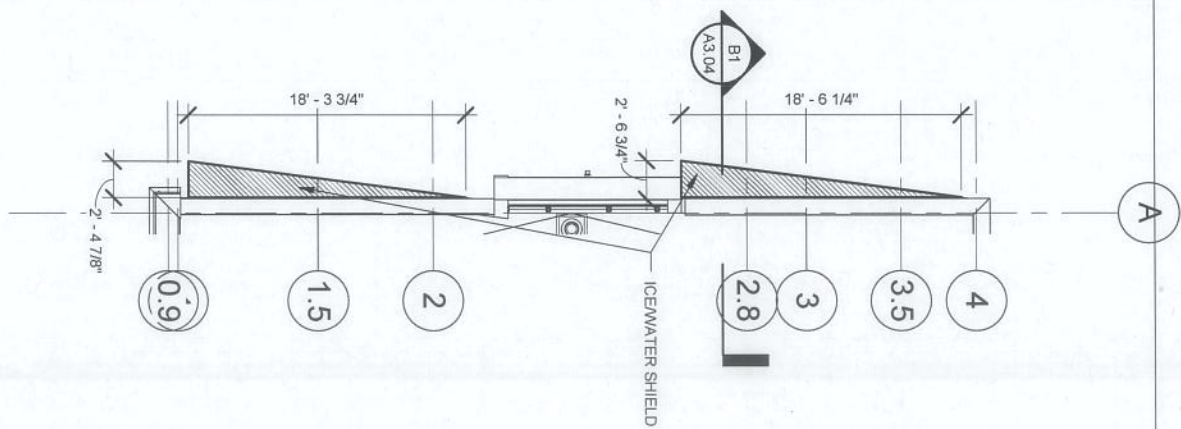

LEXINGTON SENIOR CENTER

195 LIFE LANE LEXINGTON, KY 40502

PR-062

Proj No	201333	Date	03/17/16
Drawn by	Author	Checked by	Checker
No.	REVISION	DATE	
3	CA CHANGES	-	

SKA-118
 As indicated

Nu-Way Roofing Inc.

P.O.BOX 427, Richmond, Ky. 40476
Ph# 859-623-3500/Fax# 859-623-3551

DATE: April 8, 2016

Change Order

To: Travis Harris
Marrillia Design & Construction
259 West Short Street, Suite 325
Lexington, KY 40507
Email: tharris@marrillia.com

RE: Add ice and water shield to the triangular bump outs located on grid lines 1.5 & 3. For PR 62 per architect request. (Providing we can use on the lifts onsite.)

Nu-Way Roofing, Inc. will install new ice and water shield to the above areas.

2 Men – 5 Hrs each = 10 MHrs @ 51.87 per hr.	= \$ 518.70
(2) Rolls of ice and water shield @ 145.33	= \$ 290.66
Material Taxes	= \$ 17.44
<u>Truck Expenses</u>	<u>= \$ 25.00</u>
TOTAL	= \$ 851.80

Total for above change order: \$ 851.80

Offered By,

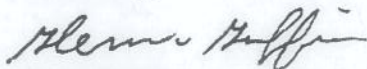

Glenn Griffin
Nu-Way Roofing, Inc.
Ph: 859.358.7386

Nu-Way Roofing Inc.

P.O.BOX 427, Richmond, Ky. 40476
Ph# 859-623-3500/Fax# 859-623-3551

DATE: April 8, 2016

Change Order Alternate

To: Travis Harris
Marrillia Design & Construction
259 West Short Street, Suite 325
Lexington, KY 40507
Email: tharris@marrillia.com

RE: Add ice and water shield to the long wall located on grid line 6.5.

Nu-Way Roofing, Inc. will install new ice and water shield to the above area. (For both areas providing we can use one of the lifts on the job site).

2 Men – 3 Hrs each = 6 MHrs @ 51.87 per hr.	= \$ 311.22
(1) Rolls of ice and water shield @ 145.33	= \$ 145.33
Material Taxes	= \$ 8.72
<u>Truck Expenses</u>	<u>= \$ 40.00</u>
TOTAL	= \$ 505.27

Total for above change order: \$ 505.27

Offered By,



Glenn Griffin
Nu-Way Roofing, Inc.
Ph: 859.358.7386

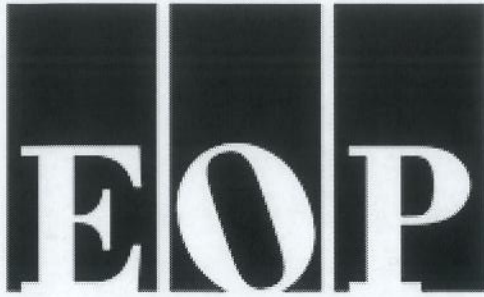

architecture | interiors

Proposal Request Transmittal

EOP Architects | 201 W Short St Suite 700 Lexington KY 40507 United States

PROJECT	LFUCG Senior Citizens' Center 201333	DATE SENT	4/7/2016
SUBJECT	Revision of Roof Coping at North	PROPOSAL REQUEST ID	PR-063
TYPE	Proposal Request	TRANSMITTAL ID	00946
PURPOSE	For Review and Response	VIA	Info Exchange

FROM

NAME	COMPANY	EMAIL	PHONE
Harding Dowell	EOP Architects	hdowell@eopa.com	(859) 231-7538

TO

NAME	COMPANY	EMAIL	PHONE
Travis Harris	Marrillia Design and Construction	tharris@marrillia.com	

REMARKS: **Sent and Closed: Travis Harris (Marrillia Design and Construction)**

Remarks:

Created by: Harding Dowell

Description:

In light of field conditions, some design driven and some the result of subcontractor field adjustments, the termination of the roof coping at the north edge of the building requires revision. Please refer to the attached sketch. Additional costs will not be accepted for adjustments to the gutter and repair of stone veneer, as in-field conditions do not reflect the documents.

Thanks,

Proposal Request Transmittal

DATE: 4/7/2016
ID: 00946

Harding

Reopened (Additional Information) by: Harding Dowell

Remarks:

Please see attached sketch by Marrillia and Nu-Way for an alternate recommended solution. Indication is 1 day of work to complete both instances, and a better end result from a watertightness standpoint.

Thanks,
Harding

DESCRIPTION OF CONTENTS

QTY	DATED	TITLE	NUMBER	SCALE	SIZE	NOTES
1	3/30/2016	160329_PR-063_SKA-121.pdf				
1	4/7/2016	160407_PR-063_Alternate.pdf				

COPIES:

Joyce Thomas (LFUCG)
Jessica Walker (LFUCG)
Martin Woodford (LFUCG)

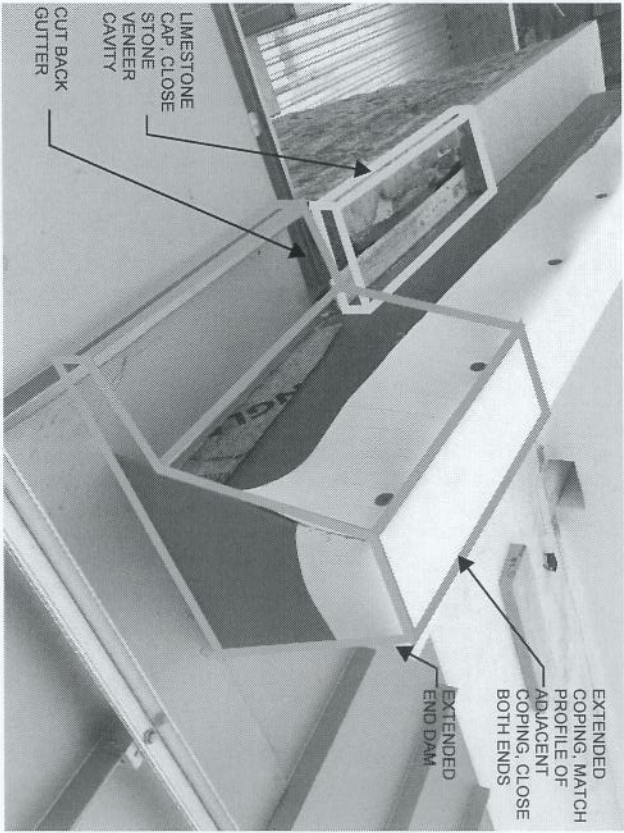

ANNOTATED PHOTO OF IN-FIELD CONDITION

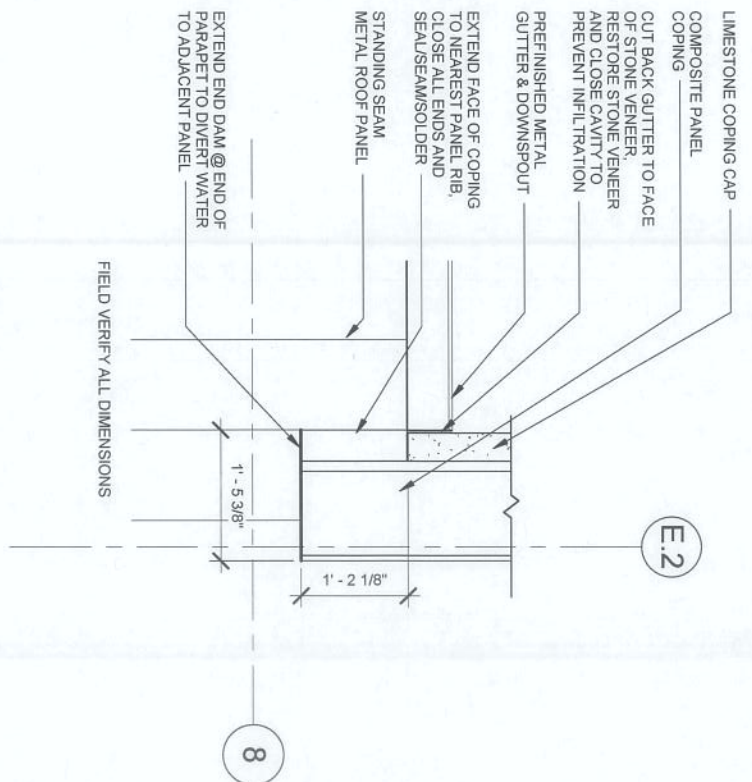

1 Callout of ROOF PLAN
 SKA-121 SCALE: 3/4" = 1'-0"



LEXINGTON SENIOR CENTER
 195 LIFE LANE LEXINGTON, KY 40502

PR-063		SKA-121
Proj. No. 201333	Date 03/17/16	
Drawn by HD	Checked by PO	3/4" = 1'-0"
REVISION	DATE	

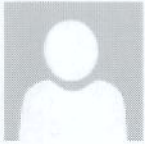

Thu 4/7/2016 2:37 PM

Travis Harris <tharris@marrillia.com>

LFUCG-SC PR 063 Alternate Proposal

To Harding Dowell; Glenn Griffin

Harding,

Please see below alternate proposal from Kenny for PR 063. If this is acceptable please amend and resend the PR.

Thanks,

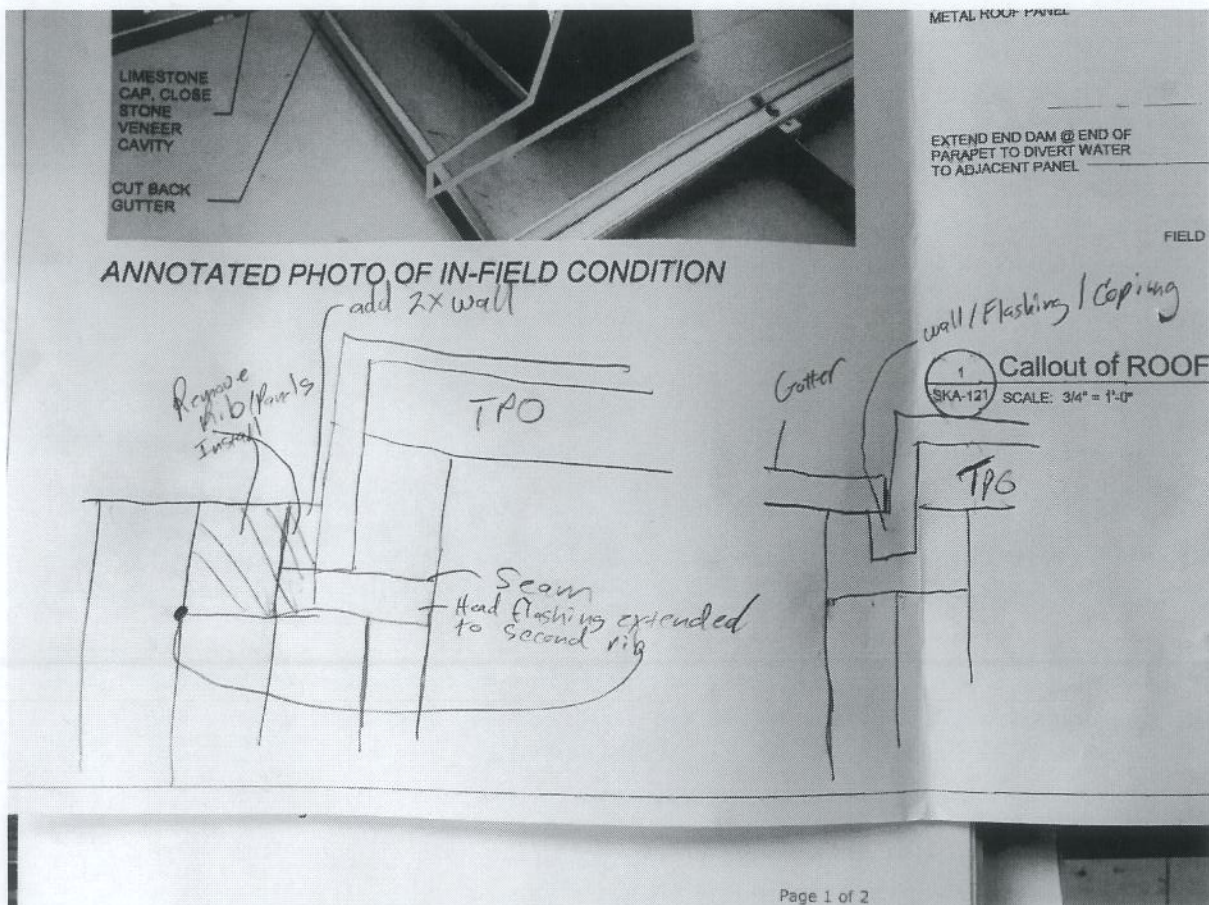

Travis Harris
 Site Manager
 Marrillia Design and Construction
 259 West Short Street, Suite 325
 Lexington, Kentucky 40507

Nu-Way Roofing Inc.

P.O.BOX 427, Richmond, Ky. 40476
Ph# 859-623-3500/Fax# 859-623-3551
Cell# 859-358-7386
Email glenn.nuwayroofing@gmail.com

DATE: April 8, 2016

Change Order

To: Travis Harris
Project Site Manager
Marrillia Design and Construction
259 West Short St, Suite 325
Lexington, KY 40507

RE: Change Order For Wall At Grid Line 8.

Change (2) roofing panels and redo flashing to direct the water to the gutters. (We do no framing work).

(2) Sheets of flat stock @ 69.95 = \$ 139.90
(2) Panels @ 50.00 ea. = \$ 100.00
Fasteners @ 25.00 = \$ 25.00
Sub Total = \$ 264.90
S/T = \$ 15.89
Materials total = \$ 280.79
Labor (2) men (2) days = (32) mhrs @ 48.00 = \$ 1536.00
Total Cost Of Change Order = \$ 1816.00

This is an Allowance
and will be tracked.



Proposed By,

Glenn Griffin
Ph: 859.358.7386
Email: glenn.nuwayroofing@gmail.com

Nu-Way Roofing, Inc.

P.O Box 427, Richmond , KY 40476
Ph: 859-623-3500 / Fax: 859-623-3551
Cell: 859-358-7383
Email: nuwayroofing@gmail.com

April 13, 2016

Aluminum Fabricated Coping Cap Breakdown

To: Travis Harris
Project Site Manager
Marrillia Design And Construction
259 West Short Street , Suite # 325
Lexington, Ky 40507

Re: Proposed Change orders Versus PR- 062 & PR-0 63 Breakdowns

I met with the owners and the architect Thursday morning April 7, 2016. I discussed the two ASI's mentioned above and my (3) proposed change orders regarding additional metal flashings at the back gutter to direct flow of roofing water to gutters and add ice & water shield self adhering underlayment on walls at grid line 6.5 , 1.5 & 3. For PR 0.62 request.

Originally the Englert Company representative (Sean Castleberry) met with all of us at a progress meeting way back last Spring . He recommended using sheet metal coping cap fabricated from 0.040" thick pre finished aluminum (Silversmith color) same profiles shown on the drawings. The concern he had using composite materials were : The composite coping (cap) has not been tested for a high wind up lift . Wall coping using a 0.040 " thick aluminum has is more suited for wall copings necessary for the application shown for this project (See accompanying information from Jeff Barnard with the Englert Company regarding the use of sheet metal coping) given to Harding at our meeting. . Per this on site meeting I agreed with Harding Dowell , Joyce and Jessica (The owners representatives) to provide the three proposed change orders at no added cost to the owners. It was also agreed that we could fabricate copings from the 0.040" thick aluminum in which I was directed to furnish ASAP. I have ordered the 0.040" thick " Silversmith aluminum and have proceeded to fabricate the required coping cap at the exterior stone wall areas. Below is our breakdown for the cost to fabricate this material to compare cost using the 0.40 " pre finished aluminum " Silversmith versus using the composite wall coping per Englert, Inc. written quote.

The Englert Company quote using the Composite metal materials: (See attached quote) for \$ 10,900

Using 0.040" thick aluminum "Silversmith Coping	
(18) sheets 0.040" thick aluminum coping	\$ 1,933.92
Set-Up Charge	312.50
State Sales Tax	116.04
Freight	468.75
Sealant/Rivets/Plates	993.75
Labor Fabrication : (3) Men 32 Hrs. Each @ 45.00	\$ 4,320.00
Labor Installation Same as other	0
Total to fabricate the 0.040" thick " Silversmith " Coping	\$ 8,144.96
Add credit for the (3) proposed change orders incorporated in the work	\$ 3,173.07

Total cost to Fabricate 0.040" thick aluminum coping plus the (3) proposed
Change order credits

\$ 11,318.03

Provided by ,

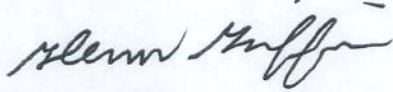

Glenn Griffin

Cell Phone: 859-358-7386

Custom Fabricated .040" Aluminum Coping CRM:0001422

1 message

Jeff Barnard <j.barnard@englertinc.com>

Thu, Apr 7, 2016 at 11:08 AM

To: "nuwayroofing@gmail.com" <nuwayroofing@gmail.com>, "Glenn Griffin (glenn.nuwayroofing@gmail.com)" <glenn.nuwayroofing@gmail.com>

Cc: Joe Tripod <J.Tripod@englertinc.com>, Dorothy Volker <D.Volker@englertinc.com>, Andy Jasani <A.Jasani@englertinc.com>

Hello Jack and Glenn,

Please find the attached FM 1-49 publication regarding perimeter flashing attachment, as we discussed. Paragraph 2.2.11 specifies #10 screws at 20" O. C. maximum to develop an FM Class 1-90 rating.

The coping in question is shown in architectural Detail A4/A4.18. And as a custom fabricated .040" aluminum coping it would be covered under Section 076200 of the project specifications in my opinion.

Additionally, the industry standard SMACNA Architectural Sheet Metal Manual 5th Edition states that .040" aluminum coping with a top width greater than 18" shall use a joint type of J5-J9 or J12. SMACNA also addresses fastener spacing for metal copings specifying 24" O. C.

I hope this information is helpful.

Please let me know if there are any questions or concerns.

Thanks,

Jeff

Jeff Barnard, CSI, CDT | Sr. Applications Specialist

Office: 732-324-3957 | Cell: 303-868-8783 | F: 732-826-8865 | E: j.barnard@englertinc.com |
www.englertinc.com



2 attachments

 **Lexington Coping Image 1.pdf**
281K

 **Lexington Coping Image 2.pdf**
1077K

Glenn Griffin <glenn.nuwayroofing@gmail.com>
To: Jeff Barnard <j.barnard@englertinc.com>

Mon, Mar 28, 2016 at 12:11 PM

Jeff the coping over the corrugated slate grey panels are shown on the shop drawings as regular coping and the shop drawings have been approved. Glenn

[Quoted text hidden]

Jeff Barnard <j.barnard@englertinc.com>
To: Glenn Griffin <glenn.nuwayroofing@gmail.com>
Cc: Joe Tripod <J.Tripod@englertinc.com>, Dorothy Volker <D.Volker@englertinc.com>

Tue, Mar 29, 2016 at 10:50 AM

Hello Glenn,
Your price to add just the 170 LF of composite coping at the masonry walls is \$ 10,900.00. Color to be Silversmith as before.
Please let me know if you have any questions or concerns.
Thanks, Jeff

Sent from my iPad

On Mar 28, 2016, at 12:12 PM, Glenn Griffin <glenn.nuwayroofing@gmail.com> wrote:

Jeff the coping over the corrugated slate grey panels are shown on the shop drawings as regular coping and the shop drawings have been approved. Glenn

On Mon, Mar 28, 2016 at 11:41 AM, Jeff Barnard <j.barnard@englertinc.com> wrote:

Hello Glenn,

Please see the attached takeoff diagrams, showing the added ACM coping in green and blue.

Please let me know if there are any questions or concerns.

Thanks,

Jeff

This message and any attachments are confidential and intended solely for the addressees. If you receive this message in error, please delete it and immediately notify the sender. If the reader of this message is not the intended recipient, you are hereby notified that any unauthorized use, copying or dissemination is prohibited. E-mails are susceptible to alteration. Englert shall not be liable for the message if altered, changed or falsified.



FM Publication 1-49.pdf

358K

Nu-Way Roofing Inc.

P.O.BOX 427, Richmond, Ky. 40476
Ph# 859-623-3500/Fax# 859-623-3551

DATE: April 14, 2016

Requested Response

To: Travis Harris
Marrillia Design & Construction
259 West Short Street, Suite 325
Lexington, KY 40507

RE: Composite Coping Cap & .040 Coping Cap Design Like Composite.

Travis,

The composite coping cap will still apply at all composite wall panel locations. The .040 silversmith aluminum coping cap designed to look like the composite coping cap over the stone walls ONLY. (Detail 1 on A414 & detail C2 on A412 on the west and east wall). The .040 silversmith aluminum coping cap at the top of the stone walls approx. 170 LF is what we gave you the credit back on for PR – 062 & 063 & grid line (6.5, A) at the north west corner. Hope this helps clarify any confusion.

Responded By,

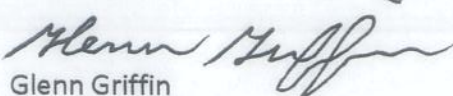

Glenn Griffin
Ph: 859.358.7386



RFI-168-Nu Way Confirmation on .040"

Request # Aluminum Copings Request Date: 04/15/2016
 Project # 99-2014 Project Name: LFUCG-Senior Center
 To: Harding Dowell Project Location: 195 Life Lane

Reason for Request:

- Insufficient Information
- Engineering Conflict
- Alternate Proposal

Probable Effect:

- Increase Cost
- Decrease Cost
- No Cost Change
- Increase Time
- Decrease Time
- No Time Impact

Action Requested:

- Clarification
- Direction
- Approval

Reference: Drawing No. _____ Detail No. _____ Specification _____

In the attached documents Nu Way is confirming their proposal for to the .040" Aluminum Copings at the in lieu of the specified composite coping that is specified at the Masonry walls only. Nu Way informs that they will execute PR's 62, 63, and provide Ice and Water Shield at 6.5 at no additional cost to the owner. Please confirm that this will acceptable.

Design Team Response:

- Proceed with Recommendation
- Proceed with the Following Instructions:

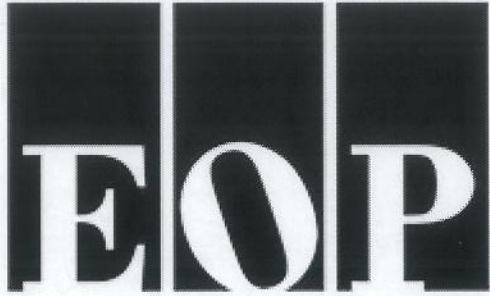

architecture | interiors

Proposal Request Transmittal

EOP Architects | 201 W Short St Suite 700 Lexington KY 40507 United States

PROJECT	LFUCG Senior Citizens' Center 201333	DATE SENT	3/31/2016
SUBJECT	Raise Manhole at Pickleball Court	PROPOSAL REQUEST ID	PR-065
TYPE	Proposal Request	TRANSMITTAL ID	00933
PURPOSE	For Review and Response	VIA	Info Exchange

FROM

NAME	COMPANY	EMAIL	PHONE
Harding Dowell	EOP Architects	hdowell@eopa.com	(859) 231-7538

TO

NAME	COMPANY	EMAIL	PHONE
Travis Harris	Marrillia Design and Construction	tharris@marrillia.com	

REMARKS:

Created by: Harding Dowell

Description:

Please provide pricing to raise the manhole and adjust adjacent conditions at the pickleball court in accordance with the attached sketch. This Proposal Request replaces PR-049. Pricing shall be broken down into materials, labor, equipment, and any overhead and profit claimed by the subcontractor.

Thanks,

Harding

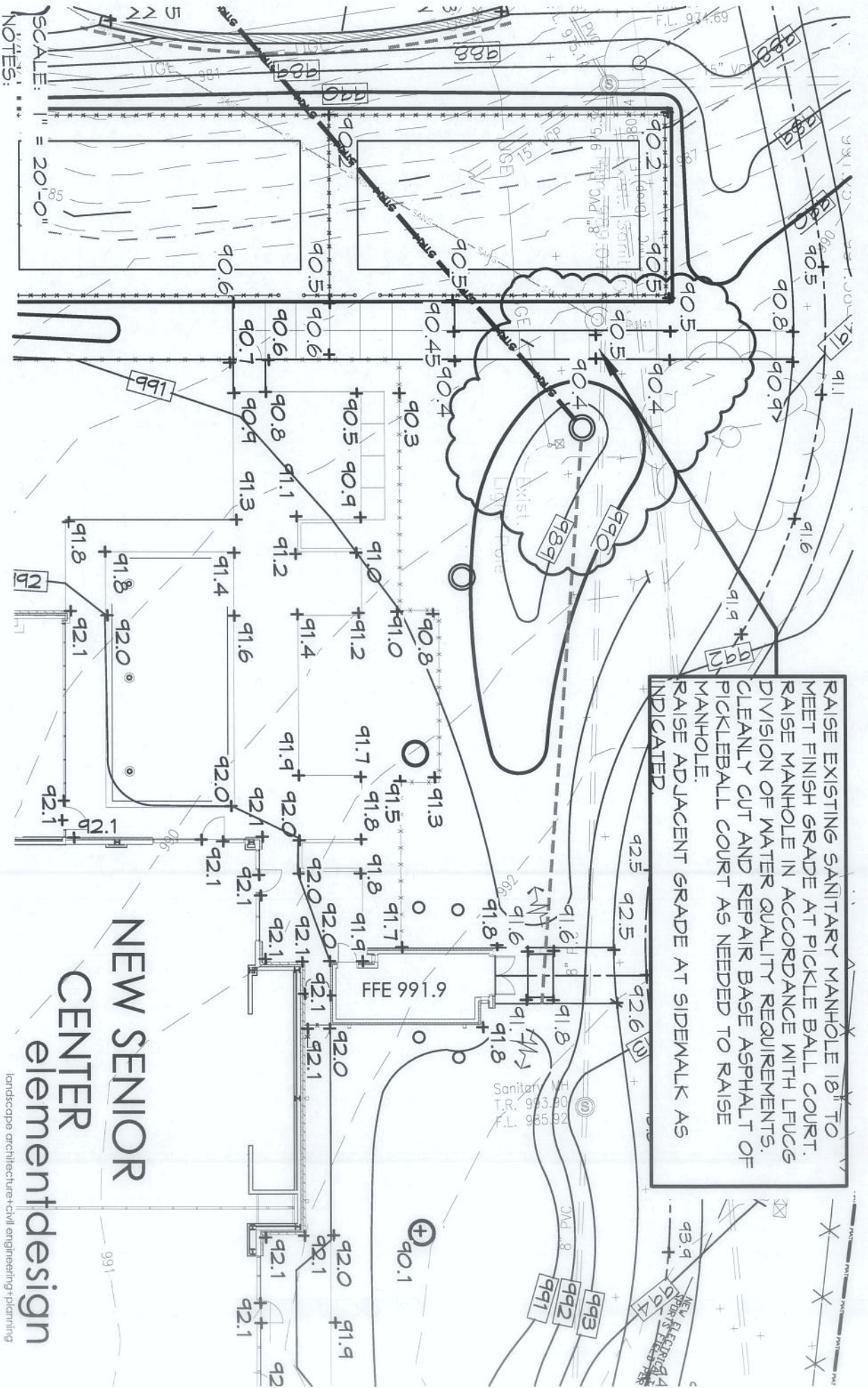

RAISE EXISTING SANITARY MANHOLE 18" TO MEET FINISH GRADE AT PICKLEBALL COURT. RAISE MANHOLE IN ACCORDANCE WITH LFC6 DIVISION OF WATER QUALITY REQUIREMENTS. CLEANLY CUT AND REPAIR BASE ASPHALT OF PICKLEBALL COURT AS NEEDED TO RAISE MANHOLE. RAISE ADJACENT GRADE AT SIDEWALK AS INDICATED

SCALE: 1" = 20'-0"

NOTES:

REVISE SPOT ELEVATIONS / GRADES WHERE INDICATED. NOTE SLOPES SHALL BE MINIMUM 1%, MAXIMUM 2% AT CROSS SLOPES.

SEE L3.0 FOR ADDITIONAL NOTES AND REQUIREMENTS.



LEXINGTON SENIOR CENTER

195 LIFE LANE
LEXINGTON, KY 40502

NEW SENIOR CENTER
element design

landscape architecture+civil engineering+planning

Proj. No. 201333	Date
Drawn by RF	Checked by RF
No.	REVISION DATE
PR REVISION	03/31/16

SHEET L3.0



Alternates
 LFUCG Replacement Senior Citizen Center
 Lexington, KY

4/12/2016
 4:35 PM

Pending Owner Approval
PR-78 Raise the Manhole at the Pickleball Court per Proposal Request No. 65

Raise the Manhole at the Pickleball Court per Proposal Request No. 65

Complete Selective Site Demolition, Raise Manhole and Complete Backfill - Croucher Excavating

Complete Asphalt Paving Replacement - ATS Construction*

*Marrillia cannot guarantee that a line will not be present at the boundaries of the patching

	Quantity	Units	Hr.	Rate	Labor	up	Materials	Subcontractor	Total
	1	ls				6,248.00		6,249	
	1	ls				1,980.00		1,980	
					0			8,229	8,229

Cost of In-Place Construction (Labor, Materials and Equipment) = 8,229
 Marrillia Design and Construction Overhead Percentage = 10.0%
 Overhead - Marrillia Design and Construction = 823
 Marrillia Design and Construction Profit Percentage = 5.0%
 Profit - Marrillia Design and Construction = 411
 General Liability Insurance (Construction) = 13
 Builder's Risk Insurance = 13
 Performance and Payment Bond (Rate of \$9.40 per \$1000 of Cost for \$0 - \$2,500,000) = N/A
 Performance and Payment Bond (Rate of \$8.15 per \$1000 of Cost for \$2,500,000 - \$5,000,000) = N/A
 Performance and Payment Bond (Rate of \$7.20 per \$1000 of Cost for \$5,000,000 and up) = 68
 KY Surcharge on Project Bonds (1.8% of Bond Cost) = 1
 Local Municipality Tax on Project Bonds (5% of Bond Cost) = 3

Total Construction Cost = **9,563**



LFUCG Senior Center PR-65 Manhole Pickle Ball Conflict

Description	Units	Total Price
Croucher	LS	\$6,249.00
ATS	LS	\$1,980.00

Subtotal \$8,229.00

Time Delay

GC's Cost

We have allowed for a 22 SY area to be replaced due getting a roller back in to compact the sub base adequately. ATS and Tennis Tech has informed that due to this patch they cannot guarantee no line will be visible upon completion or will not translate through over time.

Total Cost= \$8,229.00

Croucher Excavating

606-308-3843

Senior Center

Lexington Ky

P.R. # 65

Add 18" barrel extension to sanitary manhole at pickle ball court

Use all stone backfill

Demo asphalt as required(any asphalt repairs **are not** responsibility of Croucher Excavating)

\$6,249.00

Thank you

Joe Croucher

Croucher Excavating



April 11, 2016

Marrillia Design & Construction
259 West Short Street, Suite 325
Lexington, KY 40507
(859) 685-0414
tharris@marrillia.com

RE: Lexington Senior Center - PR-065
Asphalt Paving Quote

ATS Construction is pleased to quote the following pricing for the project referenced above as detailed in RFP-065 and referencing plans developed by EOP Architecture / Interiors, Sheet L10.0 and as further defined in the scope of work listed below:

Scope of Work:

A. PICKEL BALL COURT - ASPHALT PAVING FOR MAN HOLE REPAIR **22 SY**

- 1) Place 6" DGA Base
- 2) Place 2" Asphalt Base
- 3) Place 0.5" Asphalt Surface

LUMP SUM PRICE: \$1,980.00
\$90.00 / SY

LABOR: \$806.24
EQUIPMENT: \$489.71
MATERIAL: \$684.05

NOTES:

- ATS Construction is OMITTING the following items: Site layout / Staking, Excavation / Backfill, Manhole and related items, seeding / erosion control, and any other item not listed under scope of work.
- ATS Construction is quoting the above as a UNIT PRICE PACKAGE.
- The above prices does not include performance and payment bond, add 3/4 of 1 percent performance and payment bond, if required.
- ATS Construction is quoting the above prices based on prevailing wages as found in the project specifications.
- ATS Construction BID QUOTATION LETTER shall be made a part of subcontract agreement.
- Any alterations or deviations from the above specified scope of work involving extra work will be

Page 1 of 2

Equal Opportunity Employer

3009 Atkinson Ave. Suite 400 Lexington, KY 40509
Phone (859) 223 - 7001 Fax (859) 231 - 0946

executed only upon written orders and will be at an extra charge over and above the Lump Sum Price as quoted.

- ATS Construction proposes to furnish all materials, labor, and equipment to complete the work as described above.
- Grading and compaction of the sub grade is the responsibility of others. The site contractor shall place the sub grade to +/- 0.05' from the planned sub grade elevations. Grade errors or poor density conditions shall be corrected prior to start of work by ATS Construction.
- All traffic control shall be the responsibility of others with the exception of flagger personnel during the placement of the items listed in the scope of work above.
- All work will be completed in a workmanlike manner according to the standards of practice.
- All corrective work required for work performed by ATS Construction and damaged by others shall be considered extra work and become an extra charge to the LUMP SUM PRICE.
- All materials and workmanship is guaranteed for a period of one year. Acts of nature are not warranted. Acts of nature include, but are not limited to, damage from earthquakes, tornadoes, floods, uncontrolled vegetation, and cracks caused by hot and dry conditions.
- Payment is due upon completion, net 30. Projects requiring more than 30 days will be invoiced on a percentage of completion basis.
- ATS Construction is a pre-qualified contractor with the Kentucky Transportation Cabinet.
- Quote is good for 30 days beyond the date of this quote letter.

Please contact me with any questions you may have.

Respectfully Submitted,

Bryan Beasley
Engineer Technician